

## **Appendix K**

### **Cultural Resources**

# Appendix K

## Cultural Resources

### K.1 Introduction

This appendix provides details regarding known and potential cultural resources in areas in which the Hanford Solid Waste (HSW) Program activities, as described in Section 3 of this *Hanford Site Solid (Radioactive and Hazardous) Waste Program Environmental Impact Statement* (HSW EIS), may take place. These areas are portions (including Low Level Burial Grounds [LLBGs] and the immobilized low-activity waste [ILAW] disposal area near the PUREX Plant) of the 200 West and 200 East Areas (including the Central Waste Complex [CWC] expansion area), Area C containing borrow pit material, access roads, and a stockpile area north of State Route 240 near the 200 West Area.

Cultural resources reviews, in accordance with the National Historic Preservation Act (16 USC 470), are conducted to ensure that potential impacts to cultural resources and historic properties are considered in advance of federal undertakings. Copies of letters of consultation (for this HSW EIS) with the State of Washington Office of Archaeology and Historic Preservation are attached.

#### K.1.1 200 East and 200 West Areas

Since 1987, a total of 41 cultural resources reviews have been conducted for various projects associated with the LLBGs, surrounding areas in the 200 West and 200 East Areas, and mineral source locations (see Table K.1). New reviews are completed when any change in project scope or location occurs. Thus cultural resources reviews would be initiated for project activities associated with alternative groups considered in this EIS to determine whether or not the proposed activities associated with waste management operations would have the potential to cause effects on historic properties [36 CFR 800.3(a)(1)].

The only buildings and structures that are eligible for listing in the National Register of Historic Places and have the potential to be affected by projects associated with the Hanford Solid Waste (HSW) Program activities in the 200 West and 200 East Areas include certain facilities within the T Plant Complex. Modifications of these facilities, as proposed for all alternative groups (except Alternative Group B and the No Action Alternative), may require additional cultural resources reviews.

**Table K.1.** Previously Conducted Cultural Resources Reviews<sup>(a)</sup>

<b>Hanford Cultural Resource Case Number</b>	<b>Title</b>	<b>Activities Reviewed</b>	<b>Cultural Resources</b>
87-200-016	Cultural Resources Survey of the Proposed 200-West 218-W-3A, 218-W-3AE, and 218-W-5 Waste Trenches.	Trench construction in 218 W-5, 218-W-3A, 218-W-3AE.	No archaeological, historic, paleontological, or Native American cultural sites.
87-200-021	Cultural Resources Survey of the Proposed PCB/PU Storage Facility HCRC# 87-200-021 and of the Proposed Hanford Center Waste Complex HCRC# 88-200-005.	200 East and 200 West Areas. Construction of plutonium/ polychlorinated biphenyl storage facility and the steam tie lines and water system upgrade tie lines between areas.	White Bluffs Road.
88-200-005	Cultural Resources Review of the Hanford CWC.	100 ac tract of land bounded on the south by 19 <sup>th</sup> Street, on the east by Dayton Avenue, and on the north by 23 <sup>rd</sup> Street.	White Bluffs Road, 2 isolated finds, and 1 site.
88-600-001	Cultural Resource Review of Barrier Development Program Fine Soil Borrow Pit at McGee Ranch.	McGee Ranch fine soils borrow pit use.	Review not completed numerous archaeological sites.
89-200-005	Cultural Resources Review of the 218-E-12B Special Naval Disposal Trench Expansion.	218-E-12B. Excavation to the west for 80 ft and to a depth of 30 ft below existing ground surface.	No effect on any historic properties.
89-200-006	Cultural Resources Review of the 218-W-2A and 216-T-18 Cleanup.	218-W-2A, 216-T-18, 218 W-3, 218-W-4, borrow area west of 213-W-3.	No known National Register properties.
89-200-008	Cultural Resources Review of the LLBG Permit Application.	218-E-10, 218-12B, 218-W 3A, 218-W-3AE, 218 W-4B, 218-W-4C, 218-W-5, 218-W-6 LLBGs. Maximum depth of excavation: 3 ft.	White Bluffs Road, historic artifacts.
89-200-023	Cultural Resources Review of the Effluent Retention and Treatment Complex (Effluent Retention and Treatment Complex (ERTC).	84.9 ha to develop facilities and a 26 km pipeline corridor to the Columbia River.	White Bluffs Road, 45BN307, HT-89-029, HT-90-002, HT-89-030, HT-89-031, HI-89-016.
91-600-006	Cultural Resources Review of the Privatization Steam Plant.	Gravel Pit 30. 23 acres at northwest corner of the junction between Route 3 and Route 4 South.	HT-99-007 (recorded in 1999).
91-600-012	Cultural Resources Review of the Action Plan for Characterization of McGee Ranch Oil.	McGee Ranch boring and sampling to select and characterize potential borrow locations for fine-textured soils.	Cultural properties present, survey recommended.
93-200-001	Cultural Resources Review of the Environmental Restoration Disposal Facility (ERDF)	A disposal site for waste exhumed during Hanford Site CERCLA and RCRA cleanup actions. Excavations at the site will be extensive and may be up to 12 meters deep.	Four archaeological sites, one paleontologic site, and nine isolated artifacts.

**Table K.1. (contd)**

<b>Hanford Cultural Resource Case Number</b>	<b>Title</b>	<b>Activities Reviewed</b>	<b>Cultural Resources</b>
93-200-004	Cultural Resources Review of 200-BP-1 Hanford Prototype.	Vernita Basalt Quarry. Total potential volume of McGee Ranch silt - 80,000 yd <sup>3</sup> , basalt riprap - 115,000 yd <sup>3</sup> , and batch plant - 180,000 yd <sup>3</sup> .	No known cultural resources or historic properties in quarry boundary.
93-200-008	Cultural Resources Review of the Transuranic (TRU) Waste Retrieval/Characterization Pilot Program.	LLBG trenches T01, 4C; T04, 4C; T07, 4B; T20, 4C; T24, 4C.	No known cultural resources or historic properties.
93-200-074	Cultural Resources Review of the Solid Waste Retrieval Complex, Phase I (W-113) and Enhanced Radioactive and Mixed waste Storage Facility Project.	200 West Area. Phase I Retrieval complex for retrieving transuranic solid waste including support buildings and facilities. Construction of Phase V Facility for storage of waste containers.	White Bluffs Road, 2 isolated finds, and 1 historic site.
93-200-137	Cultural Resources Review of the W-026, Waste Receiving and Processing 1 Facility (WRAP) Project.	200 West Area. Construction of the WRAP 1 facility in the CWC located southwest of the intersection of 23 <sup>rd</sup> Street and Dayton Avenue.	No known cultural resources or historic properties.
93-200-154	Cultural Resources Review of the CWC and TRU Storage and Assay Facility (TRUSAF) Paving Project.	200 West Area. Paving of 4 gravel and dirt areas.	No known cultural resources or historic properties.
93-600-002	Cultural Resources Review for the Expansion of Gravel Pits 23 and 30 Project.	Gravel Pits 30 and 23 expansion.	No known cultural resources.
94-200-018	Cultural Resources Review of the Geologic Testing of Mixed Waste Trench Project.	218-W-5. Maximum size of excavation: 4 test pits, 17 ft deep.	No known cultural resources or historic properties.
94-200-068	Cultural Resources Review of the 200/Solid Waste/CWC Facility Project.	200 West Area. Service pole holes adjacent to 2403-WB facility. Maximum size of excavation: 2 ft in diameter and 6 ft deep.	No known cultural resources or historic properties.
94-200-077	Cultural Resources Review of the Burial Ground Increase Trench #33 Project.	218-W-4C. Maximum size of excavation: trench enlarged from 6 ft deep to 24 ft deep with base widened to 24 ft.	No known cultural resources or historic properties.
94-200-200	Cultural Resources Review of the Storage of Long Length Radioactive Mixed Waste Project.	200 West Area. 24,000 ft <sup>2</sup> for 2 structures, storage for a crane and rails near the intersection of 19 <sup>th</sup> Street and Dayton Avenue.	No known cultural resources or historic properties.
94-200-097	Cultural Resources Review of the W-236A, Multi-Function Waste Tank Facility, 1994 Project.	Adjacent to Gravel Pit 30. Project modification from previous 93-600-004 cultural review.	HT-99-007 (recorded in 1999).
94-600-001	Cultural Resources Review of the Spent Nuclear Fuel Storage Facility Project.	Survey adjacent to Gravel Pit 30 (northern and eastern boundary).	HI-94-003.



**Table K.1. (contd)**

<b>Hanford Cultural Resource Case Number</b>	<b>Title</b>	<b>Activities Reviewed</b>	<b>Cultural Resources</b>
94-600-032	Survey Narrative for the Topographic Survey of a portion of the ERDF Project	Topographic survey of project area by 4-wheeled off road vehicles that will drive over the entire area; most of which was previously surveyed for ERDF	No known cultural resources or historic properties.
94-600-034	Cultural Resources Review of the ERDF Project W-296, NE Portion Project	Additional 1.126 km <sup>2</sup> added to the original 11.0 km <sup>2</sup> of area surveyed for ERDF.	Two isolated artifacts: an Army (Camp Hanford era) communication line and round metal can.
95-200-066	Cultural Resources Review of the 218-E-12B Trench 94 Project.	218-E-12B. Excavation in bottom of trench to maximum depth of 3 ft.	No known cultural resources or historic properties.
95-200-124	Cultural Resources Review of Removal of Contaminated Soils in and around 218-W-4B Burial Grounds.	218-W-4B.	No known cultural resources or historic properties.
95-200-065	Cultural Resources Review of the 218-W-4C Trench 14 - High Integrity Containers Project.	218-W-4C. Maximum excavation size: 6 holes 36 inches in diameter and 19 ft deep in bottom of trench.	No known cultural resources or historic properties.
95-200-104	Cultural Resources Review of the Solid Waste Retrieval complex, Enhanced Radioactive and Mixed Waste Storage Facility, Infrastructure Upgrades, and Central Waste Support Complex.	200 West Area. Entire area previously reviewed except for future drain field.	White Bluffs Road, 1 site, 2 isolated finds.
96-200-058	200 Area Block Survey.	Remainder of undisturbed ground within 200 East and West Areas not previously surveyed.	HI-96-002, HI-96-003, HI-96-004, HI 96 005, HI-96-006, HI-96-007, HT-96-002, HT-96-010.
96-200-059	Cultural Resources Review of the 218-W-4C Trench 14 - Culvert Containers.	218-W-4C. Maximum excavation size: 25 ft wide by 25 ft long by 8 ft deep.	No known cultural resources or historic properties.
96-200-076	Cultural Resources Review of the Routine Operation of Grouting in the 200 West Burial Grounds.	218-W-5, 218-W-3A, 218-W-3AE, 218-W-4C. Maximum depth of excavation: up to 8 ft below trench floor.	No known cultural resources or historic properties.
96-200-102	Cultural Resources Review of the Widening and Deepening of Trench 36, 218-E-12B	218-E-12B. Maximum size of excavation: 80 ft wide at top, 20 ft wide at bottom, and 20 ft deep.	No known cultural resources or historic properties.
97-200-023	Cultural Resources Review of the Burial Ground 218-W-5 Trench 33 Expansion.	218-W-5. Maximum size of excavation: trench widening to 40 ft for length of trench (1160 ft), excavation to 20 ft.	No known cultural resources or historic properties.
97-200-062	Cultural Resources Review of the Burial Ground 218-W-5 Trench 34 Rain Curtain.	218-W-5. Maximum size of excavation: 1 to 2 ft deep trenches around Trench 34 and down inner edge of truck ramp.	No known cultural resources or historic properties.

**Table K.1. (contd)**

<b>Hanford Cultural Resource Case Number</b>	<b>Title</b>	<b>Activities Reviewed</b>	<b>Cultural Resources</b>
98-200-031	Cultural Resources Review of the Subsidence Repair and Maintenance in the Low Level Burial Grounds.	218-E-10, 218-E-12B, 218 W-3A, 218-W-3AE, 218-W-4B, 218-W-4C, 218-W-5, 218-W-6.	No known National Register properties.
99-200-008	Cultural Resources Review for Widening Trench 36 218-E-12B Burial Ground.	218-E-12B. Maximum size of excavation: 900 ft long, 16 ft deep, and 25 width added.	No known National Register properties.
01-200-006	Cultural Resources Review for the Storage of K Basin Sludge at the 221-T and the 271-T Facilities	221-T and 271-T Facility upgrades to safety and security systems, 221-T modifications to hot cells.	No effect on facility characteristics that make them eligible for National Register.
02-200-050	Cultural Resources Review of Immobilized Low-Activity Waste (ILAW) Disposal Facility	Low-activity waste to be disposed of in six lined trenches southwest of the PUREX Plant in the 200 East Area.	No effect on historic properties.
02-200-051	Cultural Resources Review of Melter Trench	Disposal of melters into a specifically designed trench in 3 alternative locations in the 200 East Area.	No effect on historic properties.
02-200-054	Cultural Resources Review of Groundwater Well Installation	Four groundwater wells to be installed in several locations in the 200 West Area.	No effect on historic properties.
(a) Note that some reviews include areas that are not considered in this HSW EIS, for example the McGee Ranch, which is now within the Hanford Reach National Monument.			

### **K.1.2 Central Waste Complex Expansion Area**

Under the No Action Alternative, the CWC in the 200 West Area would continue to receive and store newly generated wastes. With existing storage capacity reaching its limit, the CWC would be expanded. Expansion would occur in a 36-ha (89-ac) area south of the existing CWC and a 30-ha (74-ac) area west of the CWC and south of the 218-W-5 expansion area. Depth of excavation would be 0.9 m (3 ft) for the CWC buildings.

Staff of the Hanford Cultural Resources Laboratory (HCRL) conducted a records and literature search that revealed the project area had been previously surveyed for cultural resources. Cultural resources identified within the project area are provided in Table K.2

The cultural resources surveys of the project area concluded that no known historic properties are located within the CWC expansion area.

**Table K.2.** Cultural Resources Identified in Project Area

<b>Survey Number/Name</b>	<b>Cultural Resources Identified in the Project Area</b>	<b>Eligible to the National Register</b>
HCRC# 88-200-038, Archaeological Survey of the 200 East and 200 West Areas.	HT-88-009, 1920s/1930s can and bottle scatter - possible sheepherder/cowboy camp.	Determined not eligible.
HCRC# 96-200-058, 200 Area Block Survey.	HT-96-002: sparse scatter of cryptocrystalline silica (ccs) flakes and historic debris. HI-96-004: ccs utilized flake. HI-96-005: ccs flake.	Determined not eligible.
HCRC# 95-200-104, Solid Waste Retrieval Complex (Infrastructure).	No cultural resources located.	NA
HCRC# 2000-600-023, White Bluffs Road Survey.	H3-121, White Bluffs Road and associated features.	Determined eligible to the National Register. The section that runs through the 200 West Area and through the project area, however, has been determined to be non-contributing due to lack of physical integrity.
HCRC = Hanford Cultural Resources Case; see Appendix L for details on source. NA = not applicable.		

### **K.1.3 New Waste Processing Facility**

The location of the new waste processing facility that would be constructed, if Alternative Group B were to be implemented, is directly west of WRAP in the 200 West Area. The previous cultural resources surveys conducted in the CWC expansion area concluded that no known historic properties are located within the footprint of the new waste processing facility.

## **K.2 Area C – Borrow Pits, Stockpile Area, and Access Roads**

Area C borrow pits would be used for excavation of basalt and fine textured material, such as silt loam, gravel, or sand, for the construction of closure covers to be placed over low-level waste (LLW) trenches in Alternative Groups A through E and MLLW trenches in all alternatives. The HCRL conducted a cultural resources review of the 926-ha (2287-ac) Area C borrow pit in February 2002 (see Figure K.1).

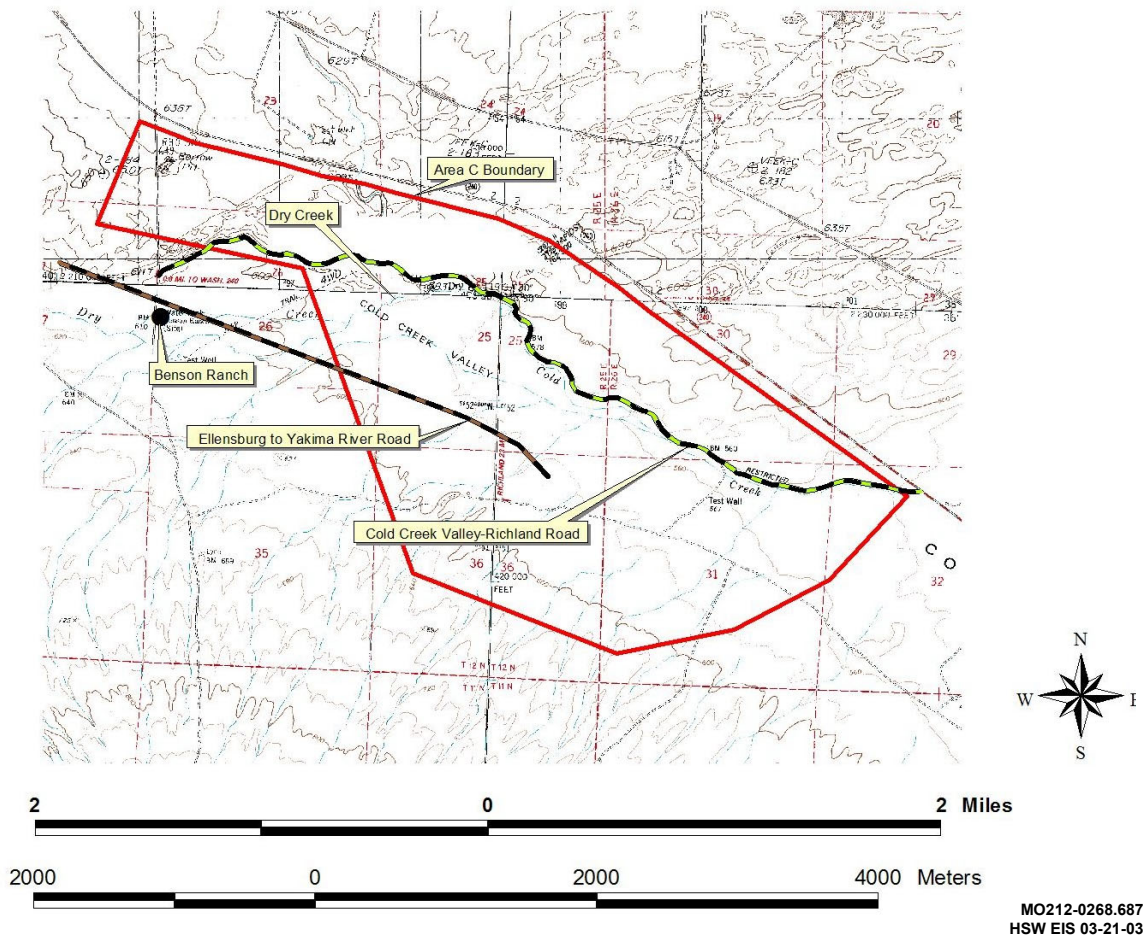

**Figure K.1. Area C - Historical Features**

## **K.2.1 Literature and Record Search – Previous Cultural Resources Surveys**

Staff of HCRL conducted a records and literature search that revealed a small section of Area C had been previously surveyed in 1994 for cultural resources (Duranceau 1995). The survey was conducted in the northwestern portion of Area C. Three isolated finds were recorded in the project area:

<b>ISOLATE NUMBER</b>	<b>DESCRIPTION</b>
HI-94-032	Two white cryptocrystalline silica (ccs) flakes.
HI-94-036	A historic “fence jack”—a rock pile with remains of a split rail.
HI-94-037	A large historic riveted metal collared cylinder.

A previous cultural resources survey three miles west of the project area resulted in the establishment of the Rattlesnake Springs Archaeological District and listing in the National Register of Historic Places (Rice 1968). Sites recorded by the survey include evidence of prehistoric activity near Rattlesnake Springs and Dry Creek. The historic White Bluffs Road, which passed through Rattlesnake Springs was

identified in the survey and is listed in the National Register. The road was an important Native American and Euro-American route from Yakima to the town of White Bluffs on the Columbia River and gives evidence to the fact that the Rattlesnake Springs area was a crossroad for Native Americans as well as early Euro-American settlers in the region.

## **K.2.2 Research Initiatives and Field Reconnaissance**

For the purposes of this EIS, a cultural resources survey of Area C is recommended prior to the commencement of excavation activities. HCRL staff has conducted a variety of research initiatives to assess the potential cultural resources impacts the project may have. These activities are summarized below.

**Historical research.** During the literature and records search, previous cultural resources investigations, historic maps, land records, and local histories were reviewed. Former residents of the Hanford area were also contacted to see what, if any, historic activity they recalled. Results of this research indicated that portions of Area C, located in the Rattlesnake Flats section of Cold Creek Valley, were used for grazing and ranching from the 1880s to 1943 (see Figure K.1). Irrigation was undertaken at ranches west (Benson Ranch) and south (Snively Ranch) of the project area. Large-scale irrigation efforts for the entire Cold Creek Valley were promoted, but they never reached fruition (Van Arsdol 1972).

A review of the 1881 General Land Office map of the Cold Creek Valley revealed that the Ellensburg to Yakima River Road traversed the project area in an east-west direction and was possibly used as an Indian trail prior to Euro-American settlement. The 1943 Real Estate maps depict another road connecting Cold Creek Valley with Richland. The road parallels Dry Creek along the northern section of the project area. The maps also note that at the time of the establishment of the Hanford Site, ownership of the project area was divided among the State of Washington, Northern Pacific Railroad, and United States government.

The Benson Ranch, located on the western boundary of the project area, is an unrecorded archaeological site that is noted on the 1915 U.S. Geological Survey topographic maps. The Benson Ranch obtained its water for irrigation from Rattlesnake Springs in order to grow alfalfa and other crops, and a well-used trail connected the ranch with the springs (Hinds and Rodgers 1991). Rattlesnake Springs was valued by both prehistoric peoples and Euro-American settlers for its year-round water supply and source of plentiful game. Further, Rattlesnake Springs holds prehistoric significance as there is evidence of aboriginal occupation some distance from the Columbia River. Until recently, most prehistoric archaeological investigations of the mid-Columbia Basin have been conducted along major rivers and tributaries. It was noted that surface findings in the vicinity of Rattlesnake Springs indicate possible human presence as far back as 8000 to 10,000 years.

**Photogrammetry.** Aerial photographs from recent decades were analyzed to determine if historic roads still existed and to see if any additional historic activity could be located. The analysis confirmed the location of roads along with various probable cultural features; however, no major sites, such as farmsteads or military encampments (that is, Camp Hanford's forward positions), were observed. In 1963, the U.S. Army conducted maneuvers, called Operation Braveshield, for several weeks in the Cold

Creek Valley. The troops proceeded north to Rattlesnake Springs and followed the Cold Creek drainage to the Yakima Firing Range (DOE-RL 1995). At this point, however, little evidence suggests that Area C was used for Army exercises.

**Ethnographic research.** From previous ethnographic interviews conducted by HCRL with local Native Americans, the area has been identified as a travel route for Native Americans between Rattlesnake Springs and the Yakima and Columbia rivers. The area lies in close proximity to Rattlesnake Mountain, a place considered important by local Native American tribes.

**Archaeological research and field reconnaissance.** Previous archaeological surveys in the area, limited to only one small survey (Duranceau 1995), identified minimal presence of archaeological remains from the prehistoric and historic periods. To gain additional perspective on the likelihood that significant archaeological remains are located in Area C, staff conducted a field reconnaissance of high potential areas identified by a predictive model developed by the HCRL for the Hanford Site (see Figure K.2). The model indicated the areas located along the dry beds of Cold Creek and Dry Creek would have a moderately high chance of containing archaeological sites. Four staff members conducted a field reconnaissance, principally along the creeks, their tributaries, and along the dirt road parallel to Dry Creek. Cultural material observed included one cryptocrystalline silica flake, numerous rusted cans and contemporary beer cans, military telephone wire, and barbwire fence lines that run parallel to Dry Creek and the dirt road. If significant archaeological remains are present in Area C, they are most likely buried under wind blown deposition.

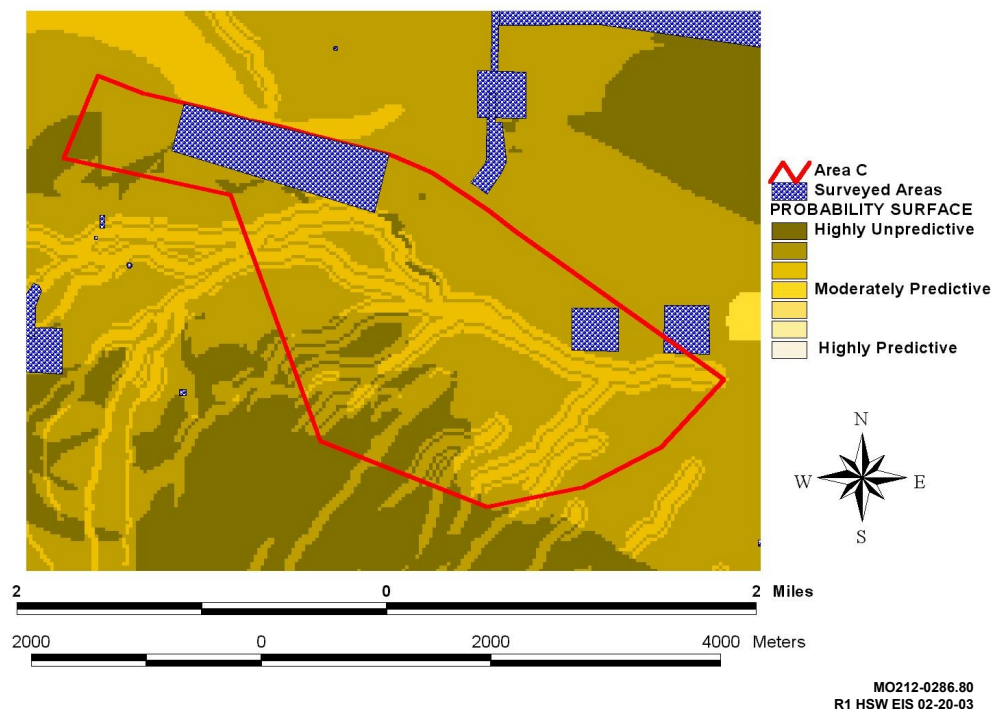

**Figure K.2.** Area C Predictive Model



## Department of Energy

Richland Operations Office  
P.O. Box 550  
Richland, Washington 99352

JAN 24 1994

Ms. Mary M. Thompson  
State Historic Preservation Officer  
Office of Archaeology and  
Historic Preservation  
Department of Community Development  
111 West 21st Avenue, KL-11  
Olympia, Washington 98504-5411

Dear Ms. Thompson:

### POTENTIAL HISTORIC PROPERTIES; ENVIRONMENTAL RESTORATION DISPOSAL FACILITY

Enclosed is a survey report and site forms for the Environmental Restoration Disposal Facility (ERDF) facility project at the U.S. Department of Energy, Richland Operations Office's (RL) Hanford Site. A survey in the proposed project area identified one prehistoric isolated artifact (HI-89-016), a cobble tool. Nine isolated artifacts consisting of three prehistoric and six historic items; and five sites, one paleontologic, one with prehistoric and historic/modern components, and three with historic components were also recorded. We believe that Sites HP-93-001, HT-93-080, and HT-93-081 do not meet any of the criteria necessary for listing on the National Register of Historic Places (Register). The research potential of these sites and of all but one of the isolates has been exhausted through recordation and/or collection. Sites HT-93-083 and HT-93-084 by themselves do not retain nationally significant information. However, viewed in a broader historic context, Euro-American ranching in Southeastern Washington, the sites represent part of the greater archaeological record and may be considered regionally or locally significant. However, since these two sites are outside the proposed ERDF boundaries, the proposed project will have no effect on them.

In accordance with CFR 36, 800.4, RL has made a good faith effort to identify historic properties at this proposed location and to evaluate the eligibility of these properties to the Register. A literature and records review and site surveys, where required, have indicated that no historic properties eligible for the Register will be affected by this undertaking.

If any archaeological or additional historical resources are discovered during project activities, work will be halted and your office consulted immediately. Your office will also be consulted if the site boundaries are modified. Therefore, in accordance with CFR 36, 800.4(d), we are providing documentation supporting these findings to your office.

Ms. Mary M. Thompson

-2-

JAN 24 1994

Your signature below will acknowledge receipt of our notification. Please return a signed copy for our records. If you have any questions or are in need of additional information I can be contacted at (509) 376-6354.

Sincerely,

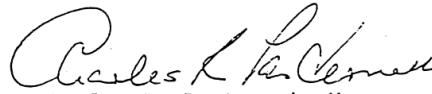

Charles R. Pasternak, Manager  
Cultural Resources Program

SID:CRP

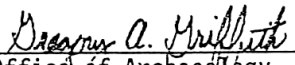
 2/2/94  
Office of Archaeology  
and Historic Preservation

Enclosures:  
ERDF Site Report & 15 Site Forms

cc w/o encls:  
G. V. Last, PNL  
M. K. Wright, PNL  
D. W. Harvey, PNL  
R. H. Engelmann, WHC

012894-10





STATE OF WASHINGTON

DEPARTMENT OF COMMUNITY DEVELOPMENT

OFFICE OF ARCHAEOLOGY AND HISTORIC PRESERVATION

111 21st Avenue S.W. • P.O. Box 48343 • Olympia, Washington 98504-8343 • (206) 753-4011 • SCAN 234-4011

February 4, 1994

Mr. Charles R. Pasternak, Manager  
Cultural Resources Program  
Department of Energy  
Richland Field Office  
P.O. Box 550  
Richland, WA 99352

Log: 012894-10-DOE  
Re: Cultural Resources Survey  
for ERDF

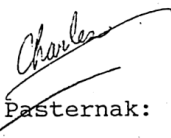
  
Dear Mr. Pasternak:

The Washington State Office of Archaeology and Historic Preservation (OAHP) is in receipt of your letter and documentation regarding the above referenced cultural resources survey in the area proposed for the Environmental Restoration Disposal Facility (ERDF) at the Hanford Reservation. In addition to the survey report, inventory forms were submitted identifying prehistoric and historic sites and one paleontologic site.

OAHP has reviewed the report and the site forms generated by this survey effort. As a result of our review, we agree with your recommendation that sites HT-93-083 and HT-93-084 should remain unevaluated until such time that development of a context on ranching in southeastern Washington can shed more light on the level of significance of these two properties. It is my understanding that these sites will not be affected by the ERDF project. In addition, we concur with your opinion that the remaining sites identified by this survey effort are not eligible for listing in the National Register of Historic Places. Therefore, further contact with OAHP on this project is not necessary. However, in the event the project scope changes or archaeological resources are uncovered during implementation, work should be halted immediately and contact made with OAHP for further consultation.



Mr. Charles R. Pasternak  
February 4, 1994  
Page Two

Charles, thank you for the opportunity to comment on this action.  
Should you have any questions, please feel free to contact me at  
(206) 753-9116.

Sincerely,

  
Gregory A. Griffith  
Comprehensive Planning Specialist

GAG:aa  
Enclosure

cc: Mona Wright



## Department of Energy

Richland Operations Office  
P.O. Box 550  
Richland, Washington 99352

April 15, 1994

Ms. Mary M. Thompson  
State Historic Preservation Officer  
Office of Archaeology and Historic Preservation  
Department of Community Development  
111 West Twenty-first Avenue, KL-11  
Olympia, Washington 98504-5411

Dear Ms. Thompson:

### CHANGE IN SCOPE: ENVIRONMENTAL RESTORATION DISPOSAL FACILITY (ERDF) - NO KNOWN HISTORIC PROPERTIES

Since your concurrence with our January 24, 1994, findings on February 4, 1994, the scope of the above mentioned proposed project has been modified. In response to a cultural resources review for a topographic survey of the proposed area it was noted that the sites boundaries had been expanded. The U.S. Department of Energy, Richland Operations Office (RL) Cultural Resources Laboratory has completed surveying the additional area. In accordance with 36 CFR 800.4, RL has made a good faith effort to identify historic properties at this proposed location and to evaluate the eligibility of these properties to the Register. A literature and records review and a survey have indicated that no historic properties eligible for the Register will be affected by these undertakings.

If any archaeological or additional historical resources are discovered during project activities, work will be halted and your office consulted immediately. If the scope of the proposed undertakings are revised, your office will also be notified immediately. Therefore, in accordance with 36 CFR 800.4(d), we are providing documentation supporting these findings to your office.

Ms. Mary M. Thompson

- 2 -

Your signature below will acknowledge receipt of our notification. Please return a signed copy for our files. If you have any questions or are in need of additional information I can be contacted at (509) 376-6354.

Sincerely,

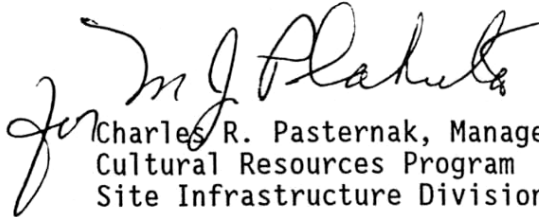
  
for Charles R. Pasternak, Manager  
Cultural Resources Program  
Site Infrastructure Division

SID:CRP

---

Office of Archaeology  
and Historic Preservation

Enclosure: HCRC #94-600-032

cc w/o encl:

P. Nickens, PNL  
D. Harvey, PNL *file*  
M. Wright, PNL  
R. Phillips, PNL  
R. Engelmann, WHC  
J. Van Pelt, CTUIR, w/encl.



Department of Energy  
Richland Operations Office  
P.O. Box 550  
Richland, Washington 99352

FEB 27 2002

02-RCA-0201

Dr. Allyson Brooks  
Office of Archaeology and  
Historic Preservation  
P. O. Box 48343  
Olympia, Washington 98504

Dear Dr. Brooks:

THREE CULTURAL RESOURCE REVIEWS FOR HANFORD SITE SOLID WASTE DRAFT ENVIRONMENTAL IMPACT STATEMENT (EIS): 1) USE OF AREA C, HCRC# 2002-600-012; 2) EXPANSION OF THE CENTRAL WASTE COMPLEX, HCRC# 2002-600-012A; and 3) RAIL SPUR TO THE WASTE RECEIVING AND PROCESSING (WRAP) FACILITY, HCRC# 2002-600-12B

Enclosed are three cultural resource reviews completed by the U.S. Department of Energy, Richland Operations Office (RL). These cultural resource reviews are in support of the Hanford Site Solid Waste EIS analysis. The subject projects are located in the 200 West Area and 600 Area of the Hanford Site, Richland, Washington. The results of the records and literature review conducted by staff at the Hanford Cultural Resources Laboratory (HCRL) are described in the attached cultural resource reviews. The results of the reviews indicate the following:

1. USE OF AREA C, HCRC# 2002-600-012 (Enclosure 1)  
Based on the information collected by the field reconnaissance and research, this project may affect historic properties. HCRL is unable to make a final determination of finding for the purposes of compliance with 36CFR 800 until additional work is completed. This area is adjacent to, but not included in, the Hanford Reach National Monument.
2. EXPANSION OF THE CENTRAL WASTE COMPLEX, HCRC# 2002-600-012A (Enclosure 2)  
Based on the information collected during the records and literature search, the expansion of the Central Waste Complex for the Hanford Site Solid Waste Program will have no affect on historic properties.
3. RAIL SPUR TO THE WRAP FACILITY, HCRC# 2002-600-12B (Enclosure 3)  
Based on the information collected during the records and literature search and the cultural resources survey, that there are no historic properties located within the Area of Potential Effect. This project will have no effect to historic properties.

Dr. Allyson Brooks  
02-RCA-0201

-2-

FEB 27 2002

Pursuant to 36CFR 800.2 (4) we are providing documentation to support these findings and to involve your office as a consulting party in the National Historic Preservation Act, Section 106, Review process. If you have any questions or are in need of additional information, please contact Annabelle Rodriguez, of my staff, on (509) 372-0277 within 30 days of the date of this letter.

Sincerely,



Joel Hebdon, Director  
Regulatory Compliance and Analysis Division

RCA:ALR

Enclosures

cc:w/encls:

A. Fyall, Benton County  
J. Gaston, USFWS  
C. Hulse, EBCHS  
A. Heriford, HWBP  
J. Sonderman, FCHS  
P. Vinther, HRA  
G. Weisskoph, BRMA

cc w/o encls:

E. L. Prendergast, PNNL  
K. Rhoads, PNNL

Dr. Allyson Brooks  
02-RCA-0201

-3-

FEB 27 2002

This letter, cultural resource review and historic inventory forms have been sent to the following individuals:

Washington State Historic Preservation Officer  
Dr. Allyson Brooks

Confederated Tribes of the Umatilla Indian Reservation  
Jeff Van Pelt  
Armand Minthorn  
J. Longenecker (Richland Office)

Confederated Tribes and Bands of the Yakama Nation  
Russell Jim

Confederated Tribes of the Colville Reservation  
Adeline Fredin

Nez Perce Tribe  
Lenora Seelatsee  
Rex Buck, Jr.

U.S. Fish and Wildlife Service  
Jenna Gaston

B Reactor Museum Association  
Gene Weisskoph

Benton County  
Adam Fyall

East Benton County Historical Society  
Corene Hulse

Franklin County Historical Society  
Jaqui Sonderman

Hanford Retirees Association  
Paul Vinther

Hanford White Bluffs Pioneers  
Annette Heriford



STATE OF WASHINGTON

OFFICE OF COMMUNITY DEVELOPMENT  
Office of Archaeology and Historic Preservation

1063 S. Capitol Way, Suite 106 • PO Box 48343 • Olympia, Washington 98504-8343 • (360) 586-3065 Fax Number  
(360) 586-3067 • <http://www.oahp.wa.gov>

March 6, 2002

Mr. Joel Hebdon  
Regulatory Compliance & Analysis Division  
Richland Operations Office  
Department of Energy  
PO Box 550  
Richland, WA 99352

Re: Solid Waste DEIS  
Log No.: 030502-14-DOE  
Code: HCRC # 2002-600-012/2002-600-012A/2002-600-012B

Dear Mr. Hebdon;

Thank you for providing a copy of the cultural resources survey assessment of the proposed Site Waste DEIS analysis in the 200 West Area and 600 Area of the Hanford Site. We concur with their professional recommendations and your finding that no cultural resources are in the identified impact area as of this date. We concur with the recommendation that further survey efforts be undertaken in Area C and we look forward to receiving these reports when available.

We would appreciate receiving any correspondence or comments from concerned tribes or other parties that you receive as you consult under the requirements of 36CFR800.4(a)(4).

These comments are based on the information available at the time of this review and on the behalf of the State Historic Preservation Officer in conformance with Section 106 of the National Historic Preservation Act, as amended, and its implementing regulations 36CFR800. Should additional information become available, our assessment may be revised. In the event that archaeological or historic materials are discovered during project activities, work in the immediate vicinity should be discontinued, the area secured, and this office notified.

Thank you for the opportunity to comment and a copy of these comments should be included in subsequent environmental documents.

Sincerely,

  
Robert G. Whitlam, Ph.D.  
State Archaeologist  
(360) 586-3080  
email: [robw@cted.wa.gov](mailto:robw@cted.wa.gov)

**RECEIVED**

MAR 12 2002  
DOE RL/CCC





STATE OF WASHINGTON

OFFICE OF COMMUNITY DEVELOPMENT

**Office of Archaeology and Historic Preservation**

1063 S. Capitol Way, Suite 106 • PO Box 48343 • Olympia, Washington 98504-8343 • (360) 586-3064  
Fax Number (360) 586-3067 • <http://www.oahp.wa.gov>

January 31, 2002

Ms. Ellen Prendergast  
Cultural and Historic Resources Program  
Richland Operations Office  
PO Box 550  
Richland, WA 99352

Log No.: 013102-10-DOE  
Re: Solid Waste EIS Area C  
HCRC # 2002-600-012

Dear Ms. Prendergast;

We have reviewed the materials forwarded to our office for the above referenced project concerning the proposed evaluation of Area C as a potential source of fine textured materials for the construction of graded surface barriers over waste sites at the Hanford Site. We concur with your determination of the Area of Potential Effect as illustrated in the attached figures. We look forward to receiving the results of your review and on-site surveys.

These comments are based on the information available at the time of this review and on behalf of the State Historic Preservation Officer in compliance with the Section 106 of the National Historic Preservation Act, as amended, and its implementing regulations 36CFR800.4. Should additional information become available, our assessment may be revised, including information regarding historic properties that have not yet been identified. We would also appreciate receiving any correspondence or comments from concerned tribes or other parties that you receive as you consult under the requirements of 36CFR800.4(a)(4).

These comments are based on the information available at the time of this review and on behalf of the State Historic Preservation Officer. Should additional information become available, our assessment may be revised. Thank you for the opportunity to comment and we look forward to receiving the reports on the results of your investigations.

Sincerely,

Robert G. Whitlam, Ph.D.  
State Archaeologist  
(360) 586-3080  
email: [robw@cted.wa.gov](mailto:robw@cted.wa.gov)

---

# Pacific Northwest National Laboratory

February 11, 2002

Operated by Battelle for the  
U.S. Department of Energy

*Preliminary Findings*

Mr. Kent McDonald  
Fluor Hanford, MSIN H8-44  
Richland, Washington 99352

CULTURAL RESOURCES REVIEW FOR SOLID WASTE EIS, AREA C (HCRC#2002-600-012)

Dear Mr. McDonald,

In response to your request received January 25, 2002, staff of the Hanford Cultural Resources Laboratory (HCRL) conducted a cultural resources review of the subject project located in the 600 Area of the Hanford Site, Richland, Washington. As part of the U.S. Department of Energy's (DOE) ongoing efforts to provide for the safe and effective long-term storage of solid waste at Hanford, an area (Area C) measuring 2289 acres is being evaluated as a potential source of fine textured material (silt, loam and basalt) for the construction of graded surface barriers (caps) over waste sites. This project area is located adjacent to the south side of Highway 240 and is centered on the intersection of Beloit Avenue and Highway 240. This area is identified for possible borrow use in the Hanford Site Comprehensive Land Use Plan EIS (DOE 1999).

## 1. Background

This cultural resources review request is part of the larger Solid Waste project being conducted at the Hanford Site. A Draft Environmental Impact Statement (DEIS) is being prepared and will be available for public comment. As part of that effort, the Hanford Cultural Resources Laboratory has been asked to initiate the NHPA Section 106 process for this third part of that project. The other two parts are comprised of the Expansion of the Central Waste Complex (HCRC# 2002-600-012A) and Rail Spur to the WRAP Facility in 200 West Area (HCRC# 2002-600-012B).

## 2. Notifications and Public Involvement

On January 30, 2002:

- Per 36 CFR 800, the State Historic Preservation Officer (SHPO), tribes and interested parties were notified of this cultural resources review request and the Area of Potential Effect (APE). The APE is defined as the project area delineated in the attached map.
- Per 34 Stat. 225, 16 U.S.C. 431, the United States Fish and Wildlife Service (USFWS) were notified of this request for cultural resource review.

## 3. Results of the Identification of Historic Properties Survey (Literature and Records Review)

### Previous Work

A records and literature search conducted by HCRL staff during the week of February 4, 2002, revealed that some of the project area has been surveyed for cultural resources. In 1994, a cultural resources survey was conducted in the northwestern portion of the project area (Bard et. al. 1994) (please see attached map for the location of this survey). Three isolated finds were recorded in the project area and are listed in the table on the next page.

902 Battelle Boulevard • P.O. Box 999 • Richland, WA 99352

---

Telephone (509) 376-4626 ■ Email [ellen.prendergast@pnl.gov](mailto:ellen.prendergast@pnl.gov) ■ Fax (509) 376-2210

ISOLATE NUMBER	DESCRIPTION
HI-94-032	Two white CCS flakes
HI-94-036	A historic "fence jack" - a rock pile with remains of a split rail
HI-94-037	A large historic riveted metal collared cylinder

In 1999, a cultural resources survey was conducted by HCRL approximately 3 miles northwest of the project area in the Rattlesnake Springs Archaeological District (HCRC# 99-600-001). David Rice recorded this district in 1968 and later it was listed in the National Register of Historic Places (National Register) in 1974. Sites recorded in the district and by the survey include the White Bluffs Road (3-121), which is also listed in the National Register. The road was an important Indian and Euro-American road from Yakima to the town of White Bluffs on the Columbia River and indicates that the Rattlesnake Springs area was a cross road for Native American prehistoric and ethnographic peoples as well as early Euro-American settlers in the region (Hale 1999).

#### Research Initiatives and Field Reconnaissance

Although additional work will need to be conducted for the project area prior to excavation, for the purposes of the DEIS, HCRL staff conducted a variety of research initiatives to assess the potential cultural resource impacts that the project may have. These activities are documented in the project files and are summarized below:

- Historical Research - Historic maps, land records, and local histories were reviewed. Former residents of the Hanford area were also contacted to see if they could recall historic activity in the area. Results indicated that portions of Area C were used for grazing and ranching. The Ellensburg to Yakima River Road that dates at least to 1881 traversed the project area east to west, which probably was also used as an Indian trail prior to Euro-American settlement. Benson Ranch located west of the project area is an unrecorded archaeological site which shows up on the 1915 Topographic maps. The 1943 Real Estate maps depict a road connecting Cold Creek Valley with the City of Richland. This road appears to traverse adjacent to Dry Creek.
- Photogrammetry - Aerial photographs from recent decades were analyzed to determine if historic roads still existed and to see if any additional historic activity could be located. The analysis confirmed the location of roads along with various probable cultural features; however, no major sites such as farmsteads or military encampments were observed.
- Ethnographic Research - From previous ethnographic interviews with local Native Americans, we know that ethnohistorically the area was important as a travel route between Rattlesnake Springs and the Yakima River. We also know that the area lies in close proximity to at least two places considered culturally important by local tribes: Rattlesnake Mountain and Goose Egg Hill. Additional interviews will be conducted to better understand the potential that the project could have on religious activities or traditional use areas once the DEIS is released for comment.
- Archaeological Research - Previous archaeological work in the area, limited to the only one small survey (Bard 1994), identified minimal presence of archaeological remains. To gain additional perspective on the likelihood that significant archaeological remains are located in the area, staff conducted two efforts, use of an archaeological predictive model and field reconnaissance of high potential areas identified by the predictive model. The predictive model, recently developed for Hanford, was examined to evaluate the potential of the project area to contain prehistoric sites. The model indicated that the areas located along the dry beds of Cold Creek and Dry Creek would have a moderately high chance of containing

archaeological sites. Four staff members conducted a field reconnaissance principally along the creeks, their tributaries, and also along the old road. One tan CCS flake was geo-referenced and is identified in the attached map. Numerous rusted cans and barbwire were also observed.

#### 4. Findings and Actions Required

It is the finding of HCRL that based on the information collected by the field reconnaissance and research, this project may affect historic properties. HCRL is unable to make a final determination of finding for the purposes of compliance with 36CFR 800 until more work is completed. However, we can provide the following preliminary assessment and recommendations:

##### Preliminary Findings

Historic use of Area C seems to have been centered on sheep and cattle grazing, and travel. Farmsteads (i.e. Benson Ranch) have been identified west of the project area where irrigated water allowed for the cultivation of alfalfa. Ethnohistoric Native American use appears to have been limited to travel. Native American use prior to Euro American contact and extending back as far as 10,000 years probably occurred.

In terms of cultural resource impacts that the Area C excavation may have on Native American spirituality, we do not understand the potential relationships between the project area and Rattlesnake Mountain or Goose Egg Hill well enough to offer an opinion. Those comments will have to come directly from Native Americans during the EIS review process. Since the project area is within the APE of the viewshed from Rattlesnake, we can say that the project may have an indirect effect to the characteristics that contribute to the cultural and religious significance of Rattlesnake Mountain to local tribes. There is a reasonable probability that sites are located within the project boundaries. Any sites, however, are likely to be buried, as the field reconnaissance failed to locate any on the surface. As little is known about the pre-contact use of the Cold Creek Valley, any sites located there would provide an opportunity to gain new knowledge about past life (Criterion D, NHPA). Further, if campsites or village sites are located there, human remains and possible cemeteries may also be located there.

##### Actions Required

Prior to construction, additional work will be needed to address potential cultural impacts. At a minimum, a standard pedestrian archaeological survey will be needed. Given the likelihood for buried deposits, some methodology will be needed to observe the subsurface. Shovel testing or backhoe testing might be appropriate, as might construction monitoring for cultural resources. Before deciding about further work required, we recommend waiting for cultural resource-related input from Native Americans and other interested parties that will be collected during the DEIS review.

RL's Hanford Cultural Resources Program will submit official documentation of our findings to the SHPO and consulting parties. The SHPO will respond within 30 days of receipt of this letter. No project activities can begin until the SHPO has concurred with our findings stated above.

The workers must be directed to watch for cultural materials (e.g., historic artifacts) during all work activities. If any are encountered, work in the vicinity of the discovery must stop until an HCRL staff member has been notified to assess the significance of the find, and, if necessary, arrange for mitigation of the impacts to the find. HCRL must be notified if any changes to project location or scope are anticipated. This project is a Class 5 case, defined as projects that "Involve Undisturbed Ground." If you have any questions, please call me at 376-4626. Please use the HCRC# above for any future.

Kent McDonald  
February 11, 2002  
Page 4

Very truly yours,

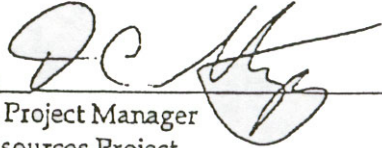

Ellen Prendergast, M. A.  
Research Scientist/Anthropologist  
Cultural Resources Project

Concurrence:   
D. C. Stapp, Project Manager  
Cultural Resources Project

Review and Concurrence:

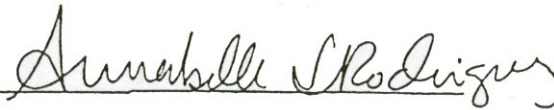

A. L. Rodriguez  
DOE, Richland Operations Office, Hanford Cultural Resources Program

cc: A. L. Rodriguez, A5-58 (2)  
Environmental Portal, A3-01  
K.R. Welsch, N1-25  
File/LB

Kent McDonald  
February 11, 2002  
Page 5

#### References

Bard, JC, Robin McClintock, and JB Cox. 1994. "A Cultural Resources Inventory of Proposed Basalt Quarry Sites at the Department of Energy's Hanford Site, Benton County, Washington." CH2M Hill, Inc. Richland, Washington.

Hale, LL. 1999 "Cultural Resources Report Narrative- The Rattlesnake Springs Survey (HCRC#99-600-001)." Prepared for the U. S. Department of Energy, Richland Operations Office, Richland, Washington.

Rice, D.G. 1968. "Archaeological Reconnaissance: Hanford Atomic Works." Washington State University. Pullman, Washington.



RL-665 (10/00)		<b>REQUEST FOR CULTURAL AND/OR ECOLOGICAL RESOURCES REVIEW FOR THE HANFORD SITE</b>		Review Tracking Number <b>2002-600-012</b>	
<b>ERC Projects (BHI, CH2M Hill)</b> Direct Form and Cultural Resource Questions To: Tom Marceau Phone 372-9289 Fax 372-9654 MSIN H0-23 Direct Form and Ecological Resource Questions To: Ken Gano Phone 372-9316 Fax 372-9654 MSIN H0-23			<b>All Other Hanford Projects (PHMC, PNNL, Other)</b> Direct All Forms and Cultural Resource Questions To: Ellen Prendergast Phone 376-4626 Fax 373-2958 MSIN K6-75 Direct Ecological Resource Questions To: Mike Sackschewsky Phone 376-2554 Fax 372-3515 MSIN K6-85		
Date Sent: <b>1/25/02</b>			Date Findings Requested By: <b>2/15/02</b>		
Primary Contact: Kent McDonald E-mail: kent_m_mcdonald@rl.gov Telephone: 373-4981			Company/Organization: Fluor Hanford Fax: 372-1441 MSIN: H8-44		
Secondary Contact: Ken Hladek Telephone: 372-3201			Company/Organization: Fluor Hanford Fax: 372-1441 MSIN: H8-44		
Project Name: Solid Waste Environmental Impact Statement Project Number/COA: RL Project Manager: Michael Collins					
REQUESTOR SHOULD SUBMIT A COPY OF THIS REQUEST TO THE RL PROJECT MANAGER UNDER WHOM THEIR PROJECT FALLS WITHIN 5 DAYS.					
Project Description, including Time Period over which proposed action will occur: Remove silt/loam and/or larger material to be used in constructing closure covers/caps for the Low-Level Burial Grounds. Material removal would likely occur sometime after 2030.					
Project Dimensions: Area C is a large polygonal area located adjacent to the south side of Highway 240 and is centered approximately on the intersection of Beloit Avenue and Highway 240 and is approximately 368 ha (909 ac). Although this area is on the ALE side of Highway 240, it is clearly identified as a possible borrow use area in the Hanford Site comprehensive land-use plan environmental impact statement. Based upon an assumed average thickness of 1.8 m, the volume of material present is 6.6 million cubic meters.					
Depth of Excavation(s): Minimum 2 m. May excavate to depth of silt/loam as yet undetermined.					
Project Location: <input type="checkbox"/> 100 Area <input type="checkbox"/> 200 East Area <input type="checkbox"/> 200 West Area <input type="checkbox"/> 300 Area <input type="checkbox"/> 400 Area <input type="checkbox"/> 600 Area <input type="checkbox"/> 700 Area <input checked="" type="checkbox"/> Other: Area C conservation/mining Township _____ N, Range _____ E    UTM: Easting: _____ Northing: _____					
Please also provide the following: 1. Overview map showing project location (or other suitable map to assist in finding the project site) 2. Map or scale drawing showing all excavation areas (including water, sewer, and power lines, etc.), parking, topsoil storage areas, equipment staging areas, access roads, and utility corridors.					
Submitted By: <b>K.M. McDonald</b>				Telephone: <b>373-4981</b>	

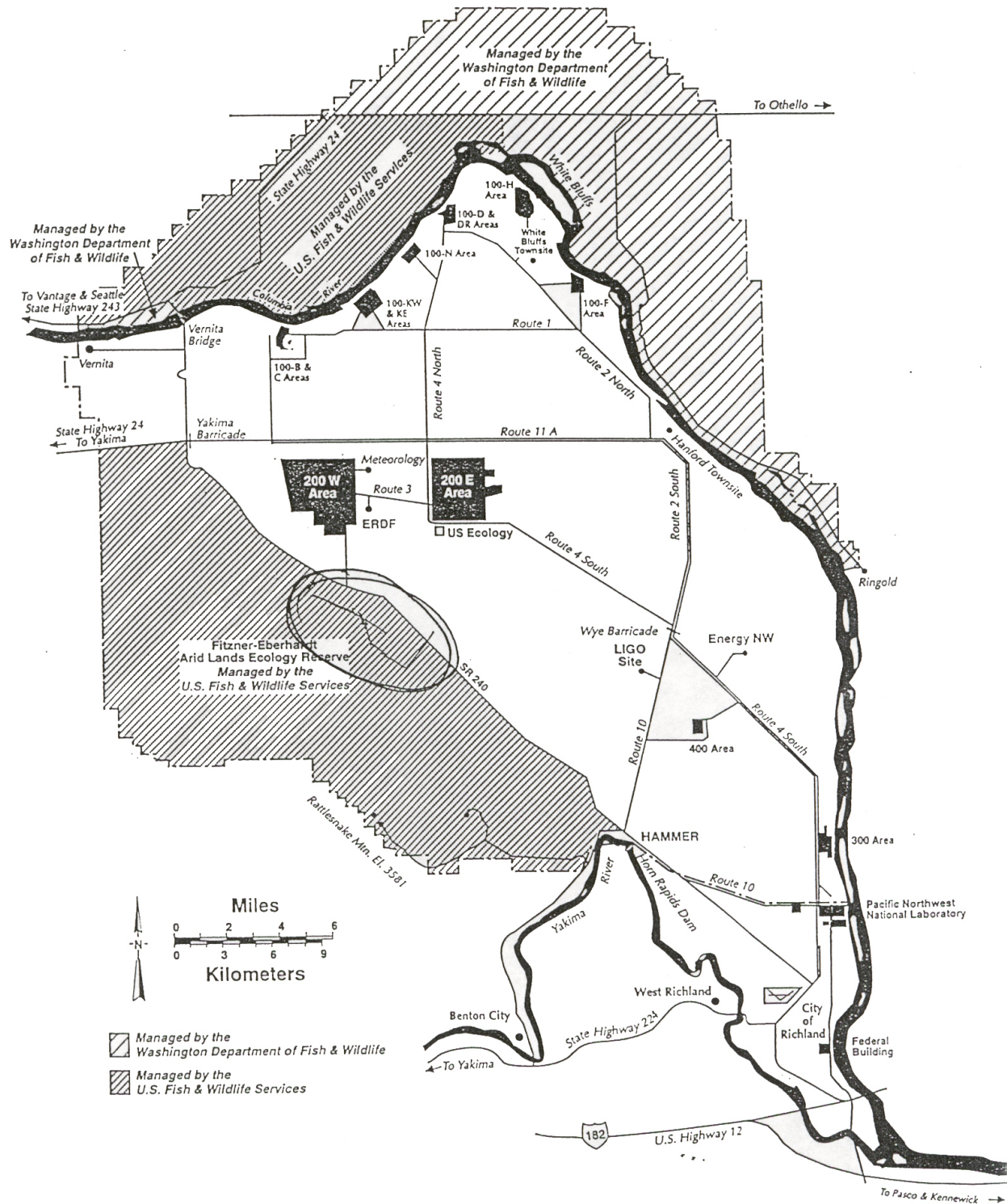

U.S. Department of Energy  
Office of External Affairs  
Richland, Washington 99352  
(509) 376-7501

## Hanford Site U.S. Department of Energy



# HCRC 2002-600-012

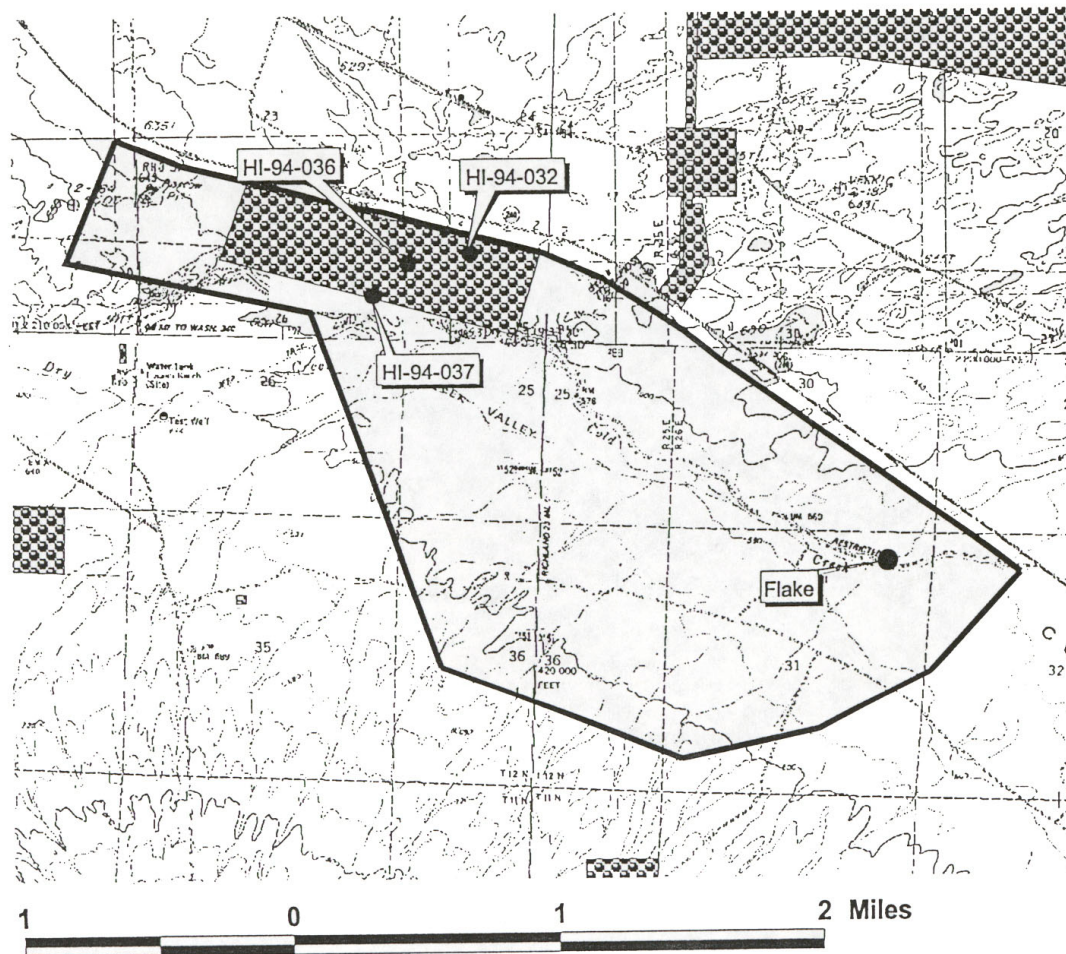

- Sites Within Area C
- ▨ Surveyed Areas
- ▬ Area C Boundary
- Flake

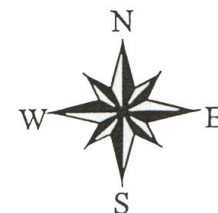





**Department of Energy**  
Richland Operations Office  
P.O. Box 550  
Richland, Washington 99352

**AUG 06 2002**

02-RCA-0479

Dr. Allyson Brooks  
State Historic Preservation Officer  
Office of Archaeology and Historic Preservation  
Washington Department of Community,  
Trade and Economic Development  
P.O. Box 48343  
Olympia, Washington 98504

Dear Dr. Brooks:

TRANSMITTAL OF THREE CULTURAL RESOURCE REVIEWS: IMMOBILIZED LOW-ACTIVITY WASTE (ILAW) DISPOSAL FACILITY (HCRC #2002-200-050), MELTER TRENCH (HCRC #2002-200-051), GROUNDWATER WELL INSTALLATION (HCRC #2002-200-054)

Enclosed are three cultural resource reviews completed by the Hanford Cultural Resources Laboratory (HCRL) for the U.S. Department of Energy, Richland Operations Office for the subject projects located on the Hanford Site, Richland, Washington. The results of the records and literature review conducted by HCRL staff are described in the attached cultural resource reviews. The results indicate that the proposed undertaking will have no effect upon historic properties. Pursuant to 36 CFR 800.2 (4), we are providing documentation to support these findings and to involve your office as a consulting party in the NHPA Section 106 Review process.

If you have any questions, please contact Annabelle L. Rodriguez, of my staff, on (509) 372-0277.

Sincerely,

A handwritten signature in cursive script that reads "Joel Hebdon".

Joel Hebdon, Director  
Regulatory Compliance and Analysis Division

RCA:ALR

Enclosures

cc w/o encls:  
E. L. Prendergast, PNNL





STATE OF WASHINGTON

OFFICE OF COMMUNITY DEVELOPMENT

**Office of Archaeology and Historic Preservation**

1063 S. Capitol Way, Suite 106 • PO Box 48343 • Olympia, Washington 98504-8343 • (360) 586-3065 Fax Number  
(360) 586-3067 • <http://www.oahp.wa.gov>

August 13, 2002

Mr. Joel Hebdon  
Regulatory Compliance & Analysis Division  
Richland Operations Office  
PO Box 550  
Richland, WA 99352

Log No: 081202-14-DOE  
Re: Immobilized Low Activity Waste Disposal & Others  
HCRC # 2002-200-050/2002-200-051/2002-200-054

Dear Mr. Hebdon;

Thank you for providing a copy of the cultural resources survey assessment by the Pacific Northwest National Laboratory for the proposed Immobilized Low Activity Waste Disposal Facility, the proposed Melter Trench and the proposed Groundwater well Installation at the Hanford site.

We concur with their professional recommendations and your finding of no historic properties effected. We would appreciate receiving any correspondence or comments from concerned tribes or other parties that you receive as you consult under the requirements of 36CFR800.4(a)(4).

These comments are based on the information available at the time of this review and on the behalf of the State Historic Preservation Officer in conformance with Section 106 of the National Historic Preservation Act, as amended, and its implementing regulations 36CFR800. Should additional information become available, our assessment may be revised.

In the event that archaeological or historic materials are discovered during project activities, work in the immediate vicinity should be discontinued, the area secured, and this office notified. Thank you for the opportunity to comment and a copy of these comments should be included in subsequent environmental documents.

Sincerely,

Robert G. Whitlam, Ph.D.  
State Archaeologist  
(360) 586-3080  
email: [robw@cted.wa.gov](mailto:robw@cted.wa.gov)

**RECEIVED**

AUG 16 2002

**DOE-RL/RLCC**



RL-665 (10/00)		<b>REQUEST FOR CULTURAL AND/OR ECOLOGICAL RESOURCES REVIEW FOR THE HANFORD SITE</b>		Review Tracking Number 2002-200-050	
<b>ERC Projects</b> (BHI, CH2M Hill) Direct Form and Cultural Resource Questions To: Tom Marceau Phone 372-9289 Fax 372-9654 MSIN H0-23 Direct Form and Ecological Resource Questions To: Ken Gano Phone 372-9316 Fax 372-9654 MSIN H0-23			<b>All Other Hanford Projects</b> (PHMC, PNNL, Other) Direct All Forms and Cultural Resource Questions To: Ellen Prendergast Phone 376-4626 Fax 373-2958 MSIN K6-75 Direct Ecological Resource Questions To: Mike Sackschewsky Phone 376-2554 Fax 372-3515 MSIN K6-85		
Date Sent: 6/28/02			Date Findings Requested By: 7/12/02		
Primary Contact: Ted Wooley E-mail: Theodore_A_Wooley@rl.gov Telephone: 372-1617			Company/Organization: CH2M Hill Hanford Group Fax: 509-376-0175 MSIN: R1-51		
Secondary Contact: Derek Ballinger Telephone: 373-3469			Company/Organization: CH2M Hill Hanford Group Fax: 509-376-0175 MSIN: R1-51		
Project Name: ILAW Disposal Facility Project Number/COA: RL Project Manager:					
REQUESTOR SHOULD SUBMIT A COPY OF THIS REQUEST TO THE RL PROJECT MANAGER UNDER WHOM THEIR PROJECT FALLS WITHIN 5 DAYS.					
Project Description, including Time Period over which proposed action will occur: It has been proposed that immobilized low-activity waste (ILAW) be disposed of in six lined trenches southeast of the PUREX facility in the 200E Area. Each trench will contain three layers of stainless steel ILAW containers separated by 1 m of soil for a total volume of 25 hectare-meters of retrievable disposed waste. The facility is still in the conceptual and design stages but is expected to begin operating in early 2008.					
Project Dimensions: Each trench will be approximately 80 m wide, 260 m long, and 10 m deep.					
Depth of Excavation(s): 10 m					
Project Location: <input type="checkbox"/> 100 Area <input checked="" type="checkbox"/> 200 East Area <input type="checkbox"/> 200 West Area <input type="checkbox"/> 300 Area <input type="checkbox"/> 400 Area <input type="checkbox"/> 600 Area <input type="checkbox"/> 700 Area <input type="checkbox"/> Other:					
Township _____ N, Range _____ E			UTM: Easting: _____ Northing: _____		
Please also provide the following: 1. Overview map showing project location (or other suitable map to assist in finding the project site) 2. Map or scale drawing showing all excavation areas (including water, sewer, and power lines, etc.), parking, topsoil storage areas, equipment staging areas, access roads, and utility corridors.					
Submitted By: Derek Ballinger			Telephone: 373-3469		

AFTILAW

DOE/RL-2001-XX, Rev. 0  
07/2001

Figure 2-1. Immobilized Low-Activity Waste Disposal Facility Site Plan.

010724.1534

F2-1



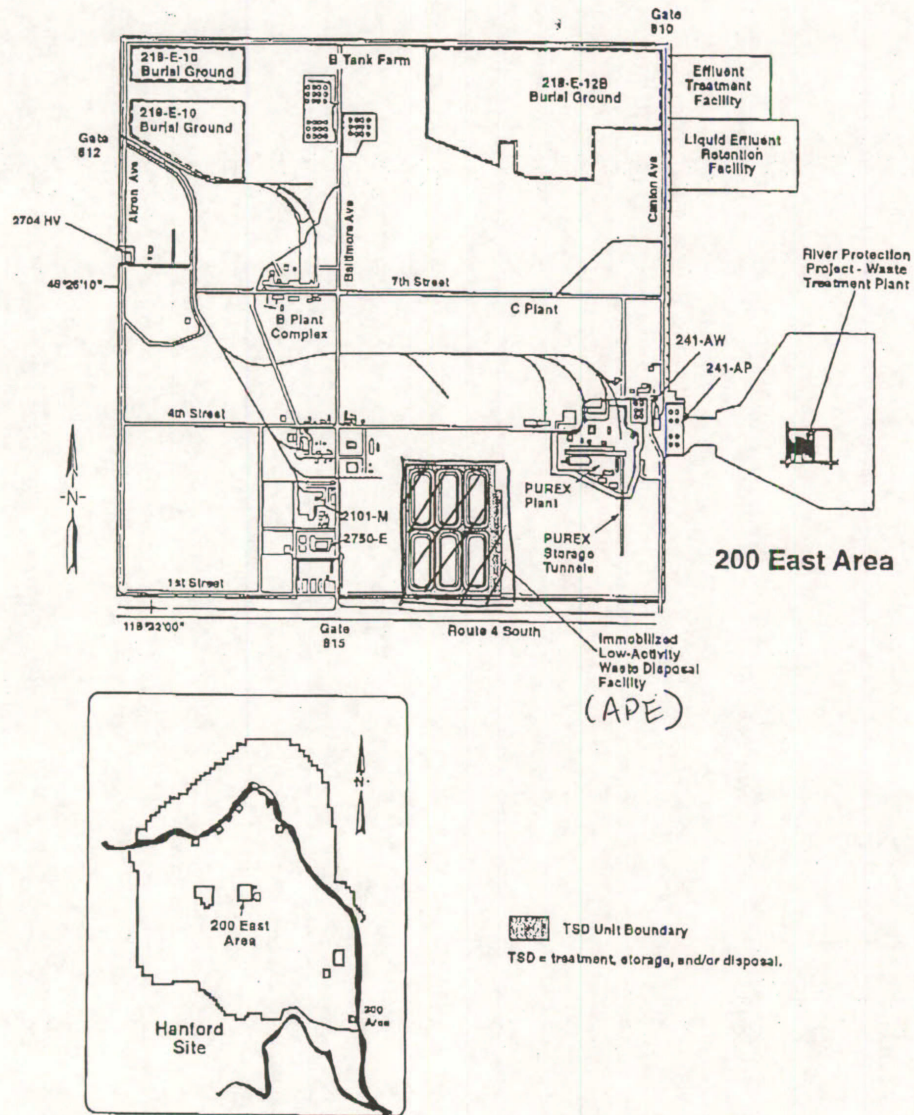

STATE OF WASHINGTON

OFFICE OF COMMUNITY DEVELOPMENT

**Office of Archaeology and Historic Preservation**

1063 S. Capitol Way, Suite 106 • PO Box 48343 • Olympia, Washington 98504-8343 • (360) 586-3064  
Fax Number (360) 586-3067 • <http://www.oahp.wa.gov>

July 9, 2002

Ms. Annabelle Rodriguez  
Cultural and Historic Resources Program  
Richland Operations Office  
PO Box 550  
Richland, WA 99352

Log No.: 070902-10-DOE  
Re: ILAW Disposal Facility  
HCRC # 2002-200-050

Dear Ms. Rodriguez;

We have reviewed the materials forwarded to our office for the above referenced project concerning the proposed Immobilized low-activity waste (ILAW) to be disposed of in six lined trenches in the 200 East Area of the Hanford Site. We concur with your determination of the Area of Potential Effect as illustrated in the attached figure. We look forward to receiving the results of your review and on-site surveys.

These comments are based on the information available at the time of this review and on behalf of the State Historic Preservation Officer in compliance with the Section 106 of the National Historic Preservation Act, as amended, and its implementing regulations 36CFR800.4. Should additional information become available, our assessment may be revised, including information regarding historic properties that have not yet been identified. We would also appreciate receiving any correspondence or comments from concerned tribes or other parties that you receive as you consult under the requirements of 36CFR800.4(a)(4).

These comments are based on the information available at the time of this review and on behalf of the State Historic Preservation Officer. Should additional information become available, our assessment may be revised. Thank you for the opportunity to comment and we look forward to receiving the reports on the results of your investigations.

Sincerely,

Robert G. Whitlam, Ph.D.  
State Archaeologist  
(360) 586-3080  
email: [robw@cted.wa.gov](mailto:robw@cted.wa.gov)

**RECEIVED**  
JUL 15 2002  
**DOE-RL/RLCC**

---

## Pacific Northwest National Laboratory

Operated by Battelle for the  
U.S. Department of Energy

July 9, 2002

*No Affect to Historic Properties  
30-Day SHPO Review Required*

Ted Wooley  
CH2M Hill Hanford Group, R1-51  
Richland, Washington 99352

Subject: Cultural Resources Review of Immobilized Low-Activity Waste (ILAW) Disposal Facility  
(HCRC #2002-200-050)

Dear Mr. Wooley,

In response to your request received July 8, 2002, staff of the Hanford Cultural Resources Laboratory (HCRL) conducted a cultural resources review of the subject project. It has been proposed that Immobilized Low-Activity Waste (ILAW) be disposed of in six lined trenches southwest of the PUREX facility in the 200 East Area of the Hanford Site, Richland, Washington. Each trench will contain three layers of stainless steel ILAW containers separated by 1 m of soil for a total volume of 25 hectare-meters of retrievable disposed waste. The ILAW facility is still in the conceptual and design stages but is expected to begin operation in early 2008. Each trench will be approximately 80 m wide, 260 m long, and 10 m deep.

### Notifications and Public Involvement

On July 9, 2002:

- Per 36 CFR 800, the State Historic Preservation Officer (SHPO) and Tribes were notified of this cultural resources review request and the Area of Potential Effect (APE). The APE is defined as the project area delineated in the attached map.
- Per 34 Stat. 225, 16 U.S.C. 431, the United States Fish and Wildlife Service (USFWS) were notified of this request for cultural resource review.

### Results of the Identification of Historic Properties Survey (Literature and Records Review)

A preliminary records and literature review revealed that the project area was surveyed in the past by HCRC #88-200-028 and two historic isolates were recorded in the vicinity of the project area (HI-88-024 and HI-88-025). In 1994, the project area was surveyed as one of the alternative locations (Area B) for the proposed Tank Waste Remediation Systems Complex (TWRS) by HCRC #94-600-060 and no cultural resources were located. An additional cultural resource review was conducted in 1998 (HCRC #98-200-033) for the ILAW complex for grubbing of the existing surface up to two feet for access roads, creation of three well pads and installation of 3 wells. Cultural resource clearance was given for this project on the basis of previous surveys

902 Battelle Boulevard • P.O. Box 999 • Richland, WA 99352

---

Telephone (509) 376-4626 ■ Email [ellen.prendergast@pnl.gov](mailto:ellen.prendergast@pnl.gov) ■ Fax (509) 376-2210

Ted Wooley  
July 9, 2002  
Page 2

(HCRC #88-200-028 and 94-600-060). An examination of aerial photographs taken in 1987 showed that much of the project area is undisturbed. As few cultural resources have been located within the APE and the vicinity of the APE, this indicates that the project is located in an area of low archaeological sensitivity and the potential for the presence of subsurface archaeological resources is low.

**Findings and Actions Required**

It is the finding of HCRL that this project will not affect historic properties, as no cultural resources are known to be located within the APE.

RL's Hanford Cultural Resources Program will submit official documentation to the SHPO, Tribes and interested parties of our findings. Pursuant to 36CFR Section 800 affording SHPO, ACHP, and tribes 30 days to comment, these parties have 30 days to respond in receipt of this letter. No project activities can begin until the SHPO has concurred with our findings stated above.

The workers must be directed to watch for cultural materials (e.g., historic artifacts) during all work activities. If any are encountered, work in the vicinity of the discovery must stop until an HCRL historian has been notified to assess the significance of the find, and, if necessary, arrange for mitigation of the impacts to the find. HCRL must be notified if any changes to project location or scope are anticipated. This project is a Class 5 case involving construction in an undisturbed area. If you have any questions, please call me at 376-4626. Please use the HCRC# above for any future correspondence concerning this project.

Very truly yours,

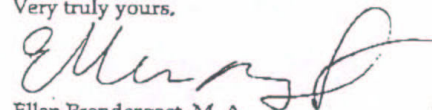
  
Ellen Prendergast, M. A.  
Research Scientist/Anthropologist  
Cultural Resources Project

Concurrence:   
D. C. Stapp, Project Manager  
Cultural Resources Project

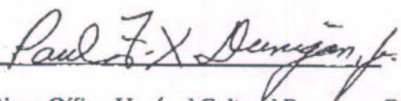
Review and Concurrence:   
A. L. Rodriguez  
DOE, Richland Operations Office, Hanford Cultural Resources Program

cc: A. L. Rodriguez, A5-58 (2)  
Environmental Portal, A3-01  
K.R. Welsch, N1-25  
File/LB



RL-665 (10/00)		<b>REQUEST FOR CULTURAL AND/OR ECOLOGICAL RESOURCES REVIEW FOR THE HANFORD SITE</b>		Review Tracking Number 2002-200-051	
<b>ERC Projects</b> (BHI, CH2M Hill) Direct Form and Cultural Resource Questions To: Tom Marceau Phone 372-9289 Fax 372-9654 MSIN H0-23 Direct Form and Ecological Resource Questions To: Ken Gano Phone 372-9316 Fax 372-9654 MSIN H0-23			<b>All Other Hanford Projects</b> (PHMC, PNNL, Other) Direct All Forms and Cultural Resource Questions To: Ellen Prendergast Phone 376-4626 Fax 373-2958 MSIN K6-75 Direct Ecological Resource Questions To: Mike Sackschewsky Phone 376-2554 Fax 372-3515 MSIN K6-85		
Date Sent: 6/28/02			Date Findings Requested By: 7/12/02		
Primary Contact: Ted Wooley E-mail: Theodore_A_Wooley@rl.gov Telephone: 372-1617			Company/Organization: CH2M Hill Hanford Group Fax: 509-376-0175 MSIN: R1-51		
Secondary Contact: Derek Ballinger Telephone: 373-3469			Company/Organization: CH2M Hill Hanford Group Fax: 509-376-0175 MSIN: R1-51		
Project Name: Melter Trench Project Number/COA: RL Project Manager:					
REQUESTOR SHOULD SUBMIT A COPY OF THIS REQUEST TO THE RL PROJECT MANAGER UNDER WHOM THEIR PROJECT FALLS WITHIN 5 DAYS.					
Project Description, including Time Period over which proposed action will occur: The vitrification plant currently under construction in the Hanford area will use melters that liquify the waste and glass material. It has been proposed that these melters be disposed of after their estimated five-year lifespans into a specially designed trench. This trench will accomodate an estimated volume of 6,825 cubic meters of failed melters and must be operational before 2008.					
Project Dimensions: The melter trench will have a length of 270 m, a width of 120 m, and a depth of 21 m.					
Depth of Excavation(s): 21 m					
Project Location: <input type="checkbox"/> 100 Area <input checked="" type="checkbox"/> 200 East Area <input type="checkbox"/> 200 West Area <input type="checkbox"/> 300 Area <input type="checkbox"/> 400 Area <input type="checkbox"/> 600 Area <input type="checkbox"/> 700 Area <input type="checkbox"/> Other:					
Township _____ N, Range _____ E    UTM: Easting: _____ Northing: _____					
Please also provide the following: 1. Overview map showing project location (or other suitable map to assist in finding the project site) 2. Map or scale drawing showing all excavation areas (including water, sewer, and power lines, etc.), parking, topsoil storage areas, equipment staging areas, access roads, and utility corridors.					
Submitted By: Derek Ballinger			Telephone: 373-3469		



## RPP-XXXX REV G

## 4.1.1 Alternative Description

The following describes each disposal site alternative. Figure 4-3 presents the general location of disposal site alternatives, excluding the multiuse burial trench site (Alternative 1C). As discussed in the Alternative 1C description, the multiuse burial trench program is at such an early stage of development that a site has not been selected.

Figure 4-3. Potential Failed Melter Disposal Sites.

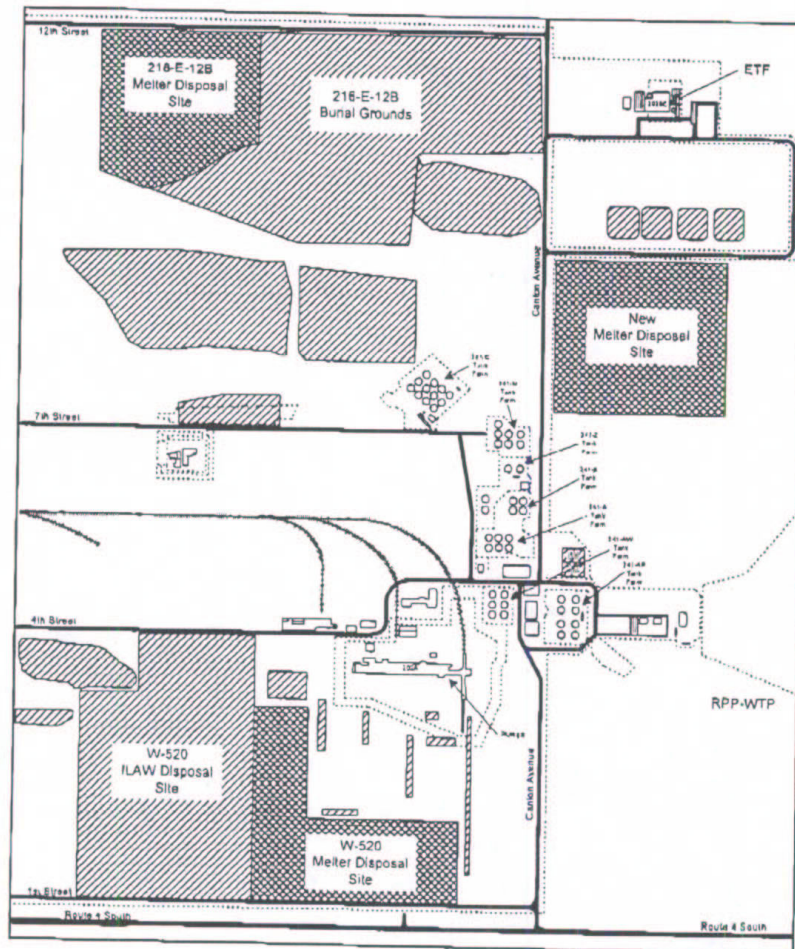







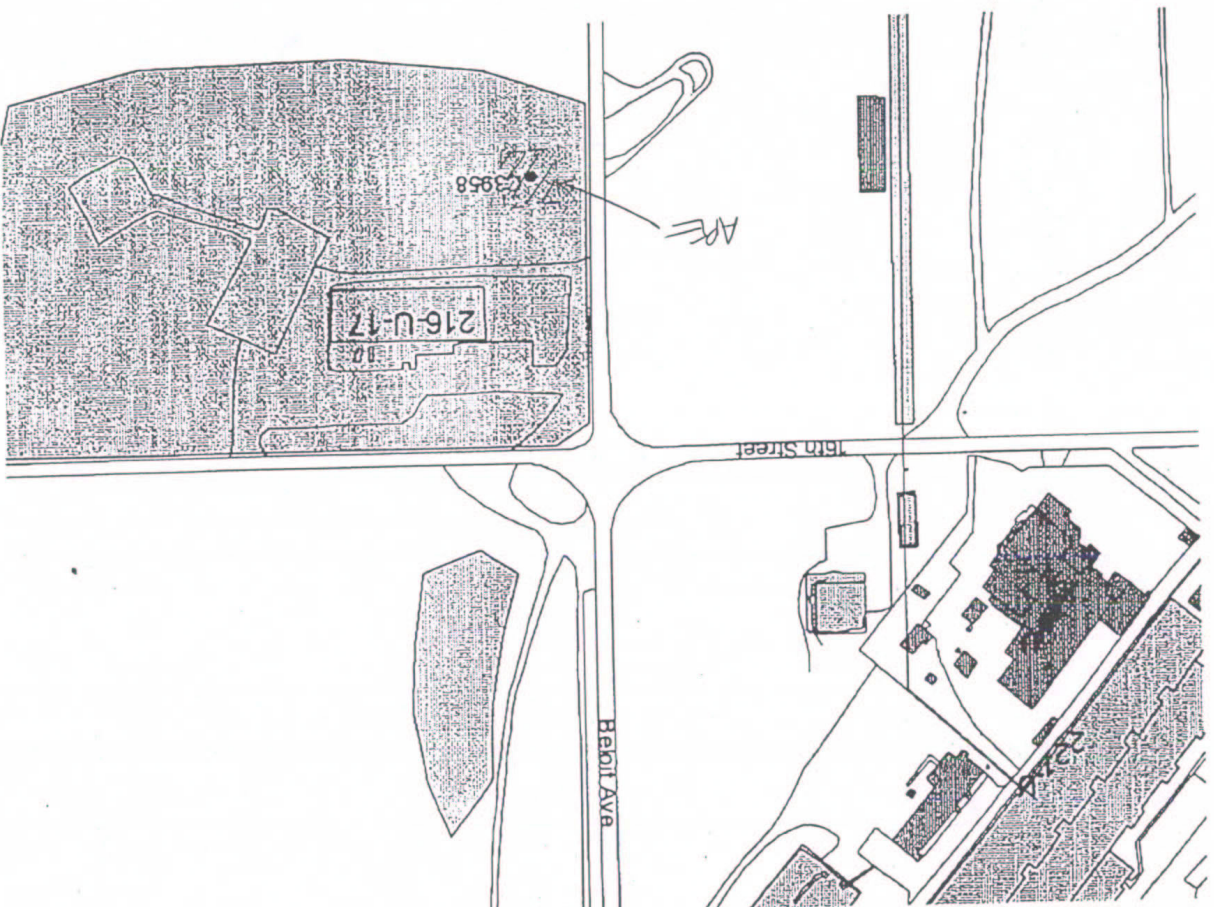

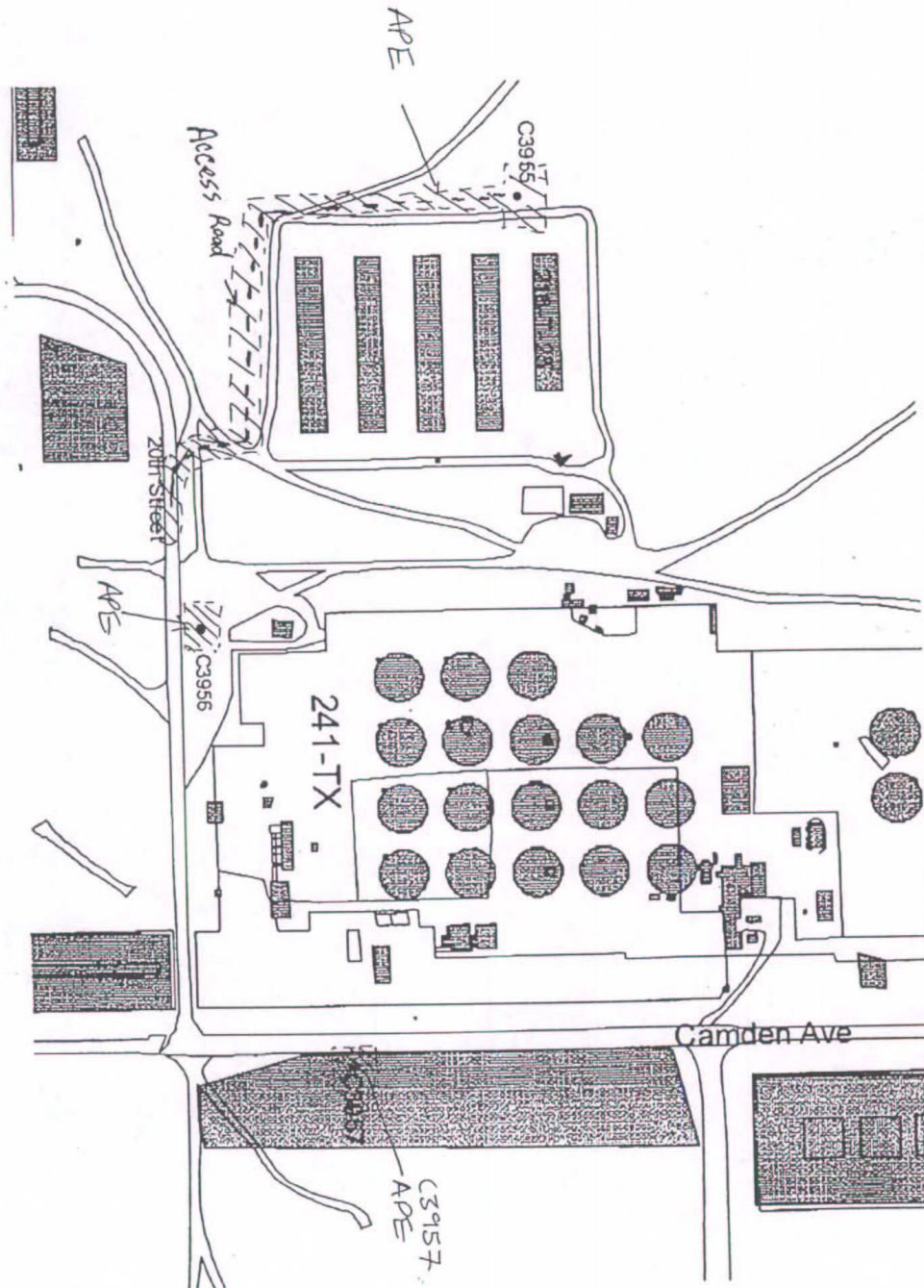

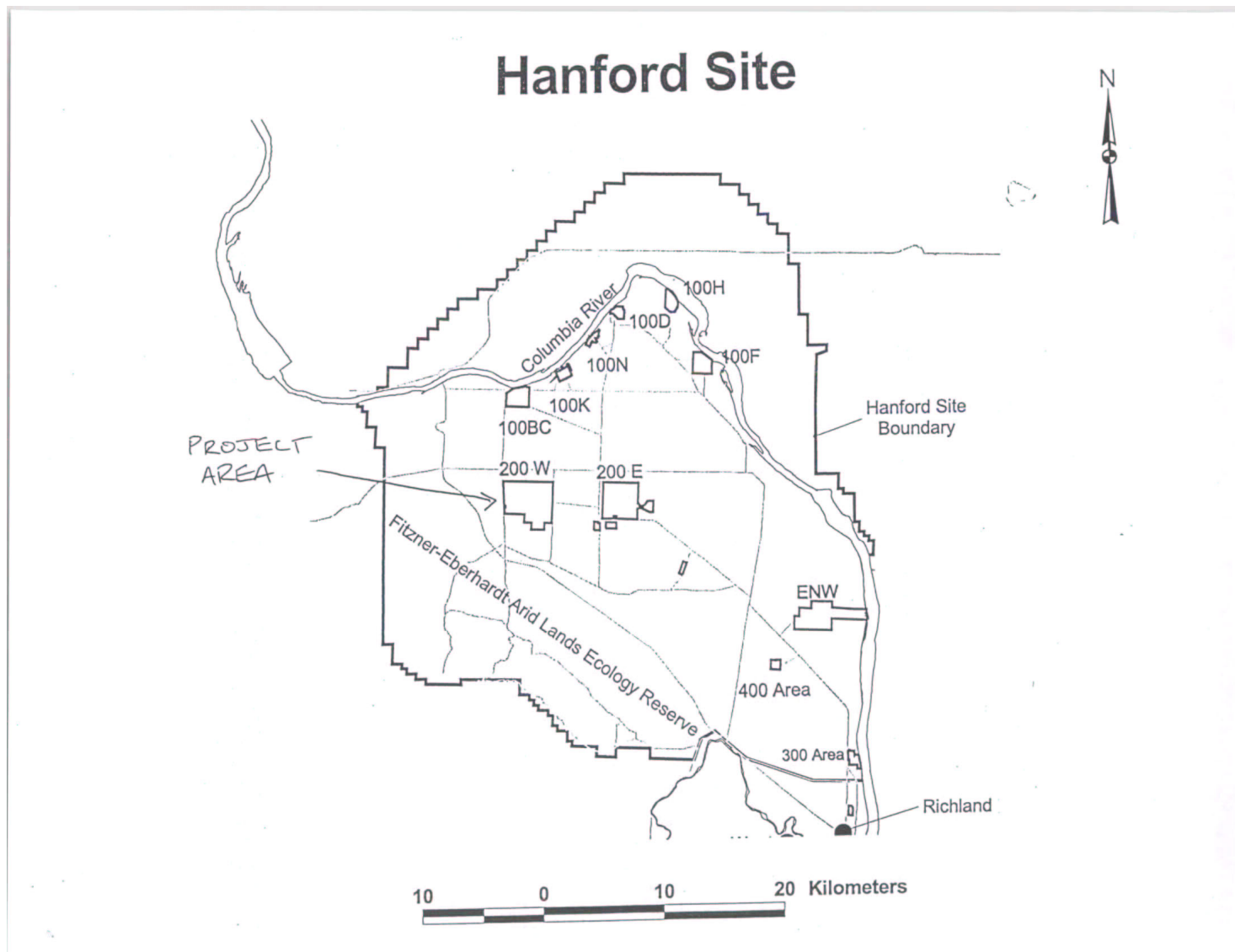



---

## Pacific Northwest National Laboratory

Operated by Battelle for the  
U.S. Department of Energy

July 12, 2002

*No Affect to Historic Properties  
30 Day SHPO Concurrence Required*

Chris Wright  
Fluor Hanford  
E6-35  
Richland, Washington 99352

Subject: Groundwater well installation (HCRC #2002-200-054)

Dear Mr. Wright,

In response to your request received July 11, 2002, staff of the Hanford Cultural Resources Laboratory (HCRL) conducted a cultural resources review of the subject project. This project is located in the 200 West Area of the Hanford Site. Four groundwater wells will be installed in several locations within the 200 West Area (see attached maps). Well C3955 will require a 75 by 75 foot gravel pad and an existing 850 foot dirt road will be graveled over for access. Wells C3956 and C3957 will require only 75 by 75 foot gravel pads. Well C3958 will not require any gravel development areas.

### Notifications and Public Involvement

On July 12, 2002:

- Per 36 CFR 800, the State Historic Preservation Officer (SHPO) and Tribes were notified of this cultural resources review request and the Area of Potential Effect (APE). The APE is defined as the project area delineated in the attached map.
- Per 34 Stat. 225, 16 U.S.C. 431, the United States Fish and Wildlife Service (USFWS) were notified of this request for cultural resource review.

### Results of the Identification of Historic Properties Survey (Literature and Records Review)

A preliminary records and literature review revealed that the C3958 well location area has been surveyed in the past (HCRC#87-200-032) and no cultural resources were identified. Well C3958 is located in the vicinity of a waste site (216-U-17), the construction of which most likely caused the disturbance visible in aerial photos. The areas around the other three well locations, gravel pads and access road have not been surveyed for cultural resources. However, wells C3955, the proposed access road, and well C3956 are all located in close proximity to a waste site, roads, and tank farm 241-TX. Well C3957 is also located close to a road and in a disturbed area, possibly due to road construction or construction of tank farm 241-TX.

902 Battelle Boulevard • P.O. Box 999 • Richland, WA 99352

---

Telephone (509) 376-4626 ■ Email [ellen.prendergast@pnl.gov](mailto:ellen.prendergast@pnl.gov) ■ Fax (509) 376-2210

Chris Wright  
July 12, 2002  
Page 2

archaeological potential. Examination of aerial photographs taken in 1987 shows that all of the well location areas are highly disturbed. Construction of waste sites, tank farm 241-TX, and access roads most likely caused the disturbance visible on the aerial photos (see attached photos).

#### Findings and Actions Required

It is the finding of HCRL that this project will not affect historic properties, as no cultural resources are known to be located within the APE.

RL's Hanford Cultural Resources Program will submit an official letter of documentation to the SHPO, Tribes and interested parties of our findings. Pursuant to 36CFR Section 800, SHPO and tribes have 30 days to respond in receipt of this letter. No project activities can begin until the SHPO has concurred with our findings stated above.

All workers should be directed to watch for cultural materials (e.g. bones, artifacts) during all work activities. If any are encountered, work in the vicinity of the discovery must stop until an HCRL archaeologist has been notified, assessed the significance of the find, and, if necessary arranged for mitigation of the impacts to the find. The HCRL must be notified if any changes to project location or scope are anticipated. This project is a Class 3 case involving new construction in a disturbed, low sensitivity area. If you have any questions, please call me at 376-4626. Please use the HCRC# above for any future correspondence concerning this project.

Very truly yours,

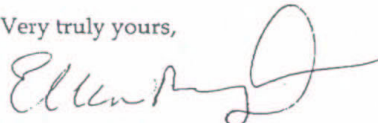

Ellen Prendergast, M. A.  
Research Scientist/ Anthropologist  
Cultural Resources Project

Concurrence:

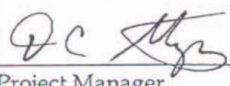
  
D. C. Stapp, Project Manager  
Cultural Resources Project

Review and Concurrence:

  
A. L. Rodriguez  
DOE, Richland Operations Office, Hanford Cultural Resources Program

cc: A. L. Rodriguez, A5-58 (2)  
Environmental Portal, A3-01  
K.R. Welsch, N1-25  
File/LB

RL-655		<b>REQUEST FOR CULTURAL AND/OR ECOLOGICAL RESOURCES REVIEW FOR THE HANFORD SITE</b>		Review Tracking Number <b>2002-200-054</b>	
<b>ERC Projects</b> (BHI, CH2M Hill)			<b>All Other Hanford Projects</b> (PHMC, PNNL, Other)		
Direct Form and Cultural Resource Questions To: Tom Marceau Phone 372-9289 Fax 372-9654 MSIN H0-23			Direct All Forms and Cultural Resource Questions To: Ellen Prendergast Phone 376-4826 Fax 373-2958 MSIN K6-76		
Direct Form and Ecological Resource Questions To: Ken Gano Phone 372-9316 Fax 372-9654 MSIN H0-23			Direct Ecological Resource Questions To: Mike Sackschewsky Phone 376-2664 Fax 372-3615 MSIN K6-85		
<b>Date Sent: 7/10/02</b>			<b>Date Findings Requested By: 7/23/02</b>		
Primary Contact: Chris Wright			Company/Organization: FH		
E-mail:					
Telephone: 373-3994		Fax:		MSIN <b>E6-35</b>	
Secondary Contact: Chris Webb			Company/Organization: FH		
Telephone: 373-5573		Fax: 373-5871		MSIN: A0-21	
Project Name: Groundwater/Vadose					
Project Number/COA: 117599					
RL Project Manager: KM Thompson					
REQUESTOR SHOULD SUBMIT A COPY OF THIS REQUEST TO THE RL PROJECT MANAGER UNDER WHOM THEIR PROJECT FALLS WITHIN 5 DAYS.					
Project Description, including Time Period over which proposed action will occur:					
Four groundwater wells will be installed in 200 West Area (see attached location sketches). Well C3955 will require a 75 by 75 foot gravel pad and a gravel access road measuring approximately 850 feet long. Wells C3956 and C3957 will require only 75 by 75 foot gravel pads. Well C3958 will not require any gravel development areas.					
Project Dimensions:					
Depth of Excavation(s): Well depth = Approx. 370 feet deep					
Project Location:					
<input type="checkbox"/> 100 Area	<input checked="" type="checkbox"/> 200 West Area	<input type="checkbox"/> 400 Area	<input type="checkbox"/> 700 Area	<input type="checkbox"/> Other:	
<input type="checkbox"/> 200 East Area	<input type="checkbox"/> 300 Area	<input type="checkbox"/> 600 Area			
Township 12 N		Range 25 & 26 E		UTM: Easting _____ Northing: _____	
Please also provide the following:					
1. Overview map showing project location (or other suitable map to assist in finding the project site)					
2. Map or scale drawing showing all excavation areas (including water, sewer, and power lines, etc.), parking, topsoil storage areas, equipment staging areas, access roads, and utility corridors.					
Submitted By: CR Webb				Telephone: 373-5573	

2.5/0906e010.doc

(10/00)

2 2 12 2002 3:36/ST. 3:36/NO. 6326709012 P 2 (FRI) JUL 12 2002

FROM



RPP-XXXX REV G

## 4.1.1 Alternative Description

The following describes each disposal site alternative. Figure 4-3 presents the general location of disposal site alternatives, excluding the multiuse burial trench site (Alternative 1C). As discussed in the Alternative 1C description, the multiuse burial trench program is at such an early stage of development that a site has not been selected.

Figure 4-3. Potential Failed Melter Disposal Sites.

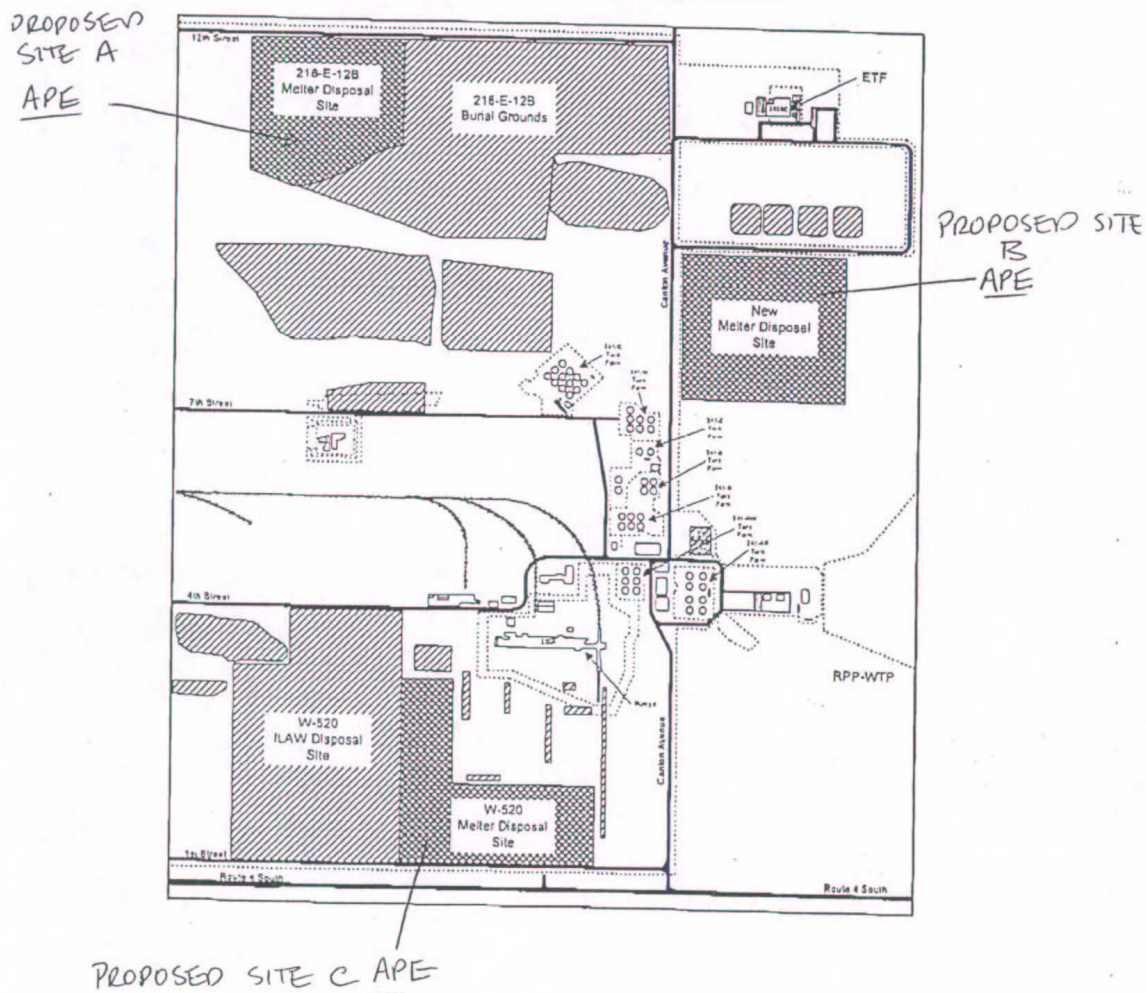

4-3

# Hanford Site

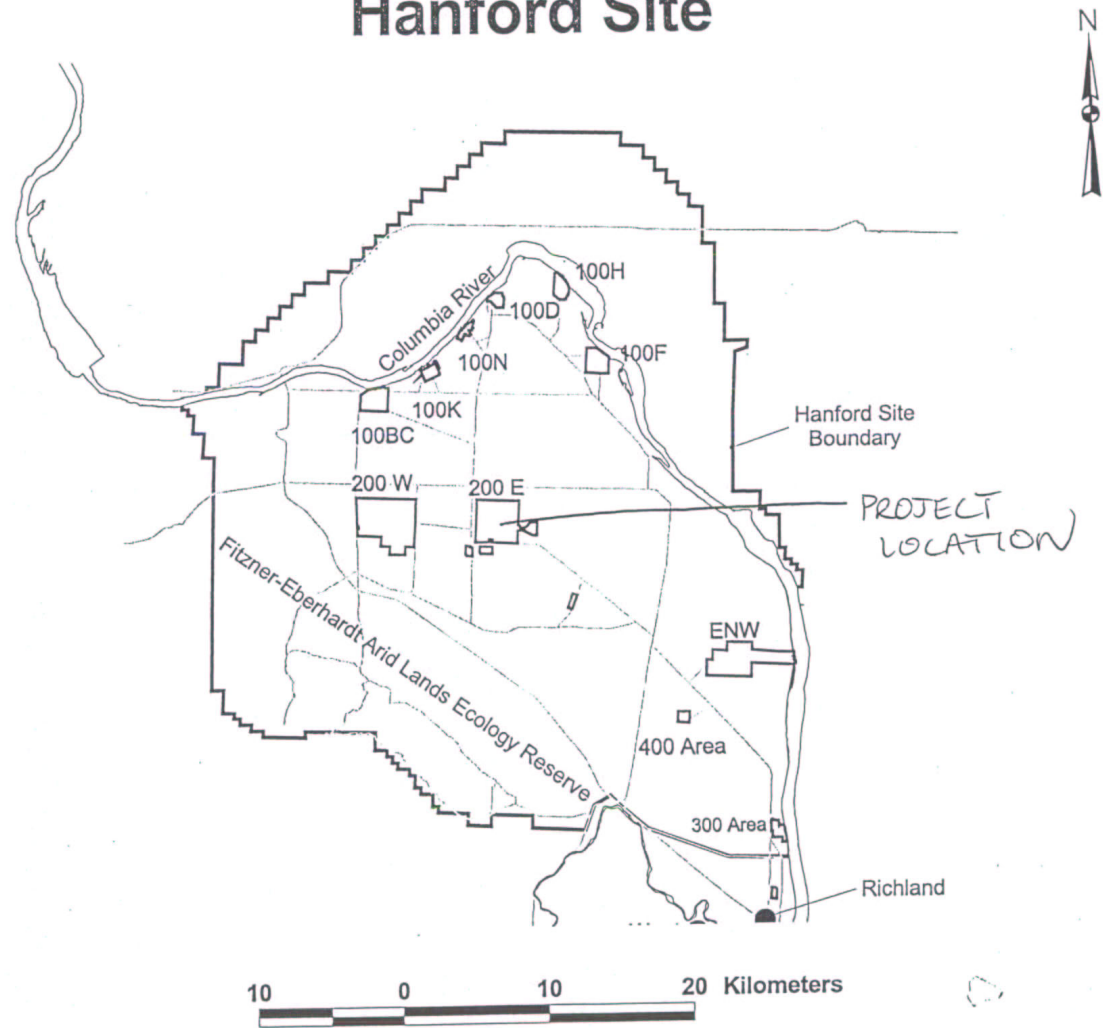

## Pacific Northwest National Laboratory

Operated by Battelle for the  
U.S. Department of Energy

July 9, 2002

*No Affect to Historic Properties  
30-Day SHPO Review Required*

Ted Wooley  
CH2M Hill Hanford Group  
R1-51  
Richland, Washington 99352

Subject: Cultural Resources Review of Melter Trench (HCRC #2002-200-051)

Dear Mr. Wooley,

In response to your request received July 8, 2002, staff of the Hanford Cultural Resources Laboratory (HCRL) conducted a cultural resources review of the subject project. The Vitrification Plant currently under construction in the 200 East Area of the Hanford area will use melters that liquefy the waste and glass material. It has been proposed that these melters be disposed of after their estimated five-year lifespan into a specially designed trench, located in the 200 East area of the Hanford Site, Richland, Washington. This trench will accommodate an estimated volume of 6,825 cubic meters of failed melters and must be operational before 2008. Three alternative locations for the melter trenches are designated on the attached map. The melter trench itself will have a length of 270 meters, a width of 120 meters, and a depth of 21 meters.

### Notifications and Public Involvement

On July 9, 2002:

- Per 36 CFR 800, the State Historic Preservation Officer (SHPO) and Tribes were notified of this cultural resources review request and the Area of Project Effect (APE). The Area of Potential Effect is defined as the project area delineated in the attached map.
- Per 34 Stat. 225, 16 U.S.C. 431, the United States Fish and Wildlife Service (USFWS) were notified of this request for cultural resource review.

### Results of the Identification of Historic Properties Survey (Literature and Records Review)

A preliminary records and literature review revealed that only one of the three proposed melter trench locations has been surveyed for cultural resources in the past. Melter trench location C (W-520) was surveyed (HCRC #88-200-038) and two historic isolates recorded (HI-88-024 and HI-88-025). Aerial photographs indicate that melter trench location C is undisturbed. Proposed melter location A (218-E-12B) has not been surveyed. However, a survey conducted to the southeast of proposed melter site A (HCRC #88-200-038) located no

902 Battelle Boulevard • P.O. Box 999 • Richland, WA 99352

Telephone (509) 376-4626 ■ Email [ellen.prendergast@pnl.gov](mailto:ellen.prendergast@pnl.gov) ■ Fax (509) 376-2210



Tced Wooley  
July 9, 2002  
Page 2

cultural resources. Aerial photographs indicate that melter site A has been disturbed by grubbing and excavation for the 218-E12B Waste Burial ground which lies east of the melter site A. Melter site location B has not been surveyed but cultural resource surveys conducted to the north (HCRC# 89-200-023) and to the west (HCRC #88-200-038) of this proposed melter disposal area did not locate cultural resources. Aerial photographs indicate that melter location B is disturbed by existing water and utility lines.

#### Findings and Actions Required

##### Melter Location A and B:

It is the finding of HCRL that this project will not affect historic properties, as the project areas are located in highly disturbed areas and cultural resource surveys conducted in the vicinity of these project areas indicates that the project area is also located in an area where the potential for subsurface archaeological resources is low.

##### Melter Location C

It is the finding of HCRL that this project will not affect historic properties, as no cultural resources are known to be located within the APE.

RL's Hanford Cultural Resources Program will submit official documentation to the SHPO, Tribes and interested parties of our findings. Pursuant to 36CFR Section 800 affording SHPO, ACHP, and tribes 30 days to comment, these parties have 30 days to respond in receipt of this letter. No project activities can begin until the SHPO has concurred with our findings stated above.

The workers must be directed to watch for cultural materials (e.g., historic artifacts) during all work activities. If any are encountered, work in the vicinity of the discovery must stop until an HCRL historian has been notified to assess the significance of the find, and, if necessary, arrange for mitigation of the impacts to the find. HCRL must be notified if any changes to project location or scope are anticipated. This project is a Class 3 and Class 5 case involving construction in both a disturbed low sensitivity area and construction in an undisturbed area. If you have any questions, please call me at 376-4626. Please use the HCRC# above for any future correspondence concerning this project.

Very truly yours,



Ellen Prendergast, M. A.  
Research Scientist/Anthropologist  
Cultural Resources Project

Concurrence:

  
D. C. Stapp, Project Manager  
Cultural Resources Project

Review and Concurrence:

  
A. L. Rodriguez  
DOE, Richland Operations Office, Hanford Cultural Resources Program



STATE OF WASHINGTON

OFFICE OF COMMUNITY DEVELOPMENT

**Office of Archaeology and Historic Preservation**

1063 S. Capitol Way, Suite 106 • PO Box 48343 • Olympia, Washington 98504-8343 • (360) 586-3064  
Fax Number (360) 586-3067 • <http://www.oahp.wa.gov>

July 9, 2002

Ms. Annabelle Rodriguez  
Cultural and Historic Resources Program  
Richland Operations Office  
PO Box 550  
Richland, WA 99352

Log No.: 070902-11-DOE  
Re: Melter Trench  
HCRC # 2002-200-051

Dear Ms. Rodriguez;

We have reviewed the materials forwarded to our office for the above referenced project concerning the proposed construction of trenches for failed melters in the 200 East Area of the Hanford Site. We concur with your determination of the Area of Potential Effect as illustrated in the attached figure. We look forward to receiving the results of your review and on-site surveys.

These comments are based on the information available at the time of this review and on behalf of the State Historic Preservation Officer in compliance with the Section 106 of the National Historic Preservation Act, as amended, and its implementing regulations 36CFR800.4. Should additional information become available, our assessment may be revised, including information regarding historic properties that have not yet been identified. We would also appreciate receiving any correspondence or comments from concerned tribes or other parties that you receive as you consult under the requirements of 36CFR800.4(a)(4).

These comments are based on the information available at the time of this review and on behalf of the State Historic Preservation Officer. Should additional information become available, our assessment may be revised. Thank you for the opportunity to comment and we look forward to receiving the reports on the results of your investigations.

Sincerely,

Robert G. Whitlam, Ph.D.  
State Archaeologist  
(360) 586-3080  
email: [robw@cted.wa.gov](mailto:robw@cted.wa.gov)

**RECEIVED**  
JUL 15 2002  
DOE-RL/RLCC



STATE OF WASHINGTON

OFFICE OF COMMUNITY DEVELOPMENT

**Office of Archaeology and Historic Preservation**

1063 S. Capitol Way, Suite 106 • PO Box 48343 • Olympia, Washington 98504-8343 • (360) 586-3064  
Fax Number (360) 586-3067 • <http://www.oahp.wa.gov>

July 15, 2002

Ms. Annabelle Rodriguez  
Cultural and Historic Resources Program  
Richland Operations Office  
PO Box 550  
Richland, WA 99352

Log No.: 071202-10-DOE  
Re: Groundwater Well Installation  
HCRC # 2002-200-054

Dear Ms. Rodriguez;

We have reviewed the materials forwarded to our office for the above referenced project concerning the proposed installation of a groundwater well in the 200 Area of the Hanford Site. We concur with your determination of the Area of Potential Effect as illustrated in the attached figure. We look forward to receiving the results of your review and on-site surveys.

These comments are based on the information available at the time of this review and on behalf of the State Historic Preservation Officer in compliance with the Section 106 of the National Historic Preservation Act, as amended, and its implementing regulations 36CFR800.4. Should additional information become available, our assessment may be revised, including information regarding historic properties that have not yet been identified. We would also appreciate receiving any correspondence or comments from concerned tribes or other parties that you receive as you consult under the requirements of 36CFR800.4(a)(4).

These comments are based on the information available at the time of this review and on behalf of the State Historic Preservation Officer. Should additional information become available, our assessment may be revised. Thank you for the opportunity to comment and we look forward to receiving the reports on the results of your investigations.

Sincerely,

Robert G. Whitlam, Ph.D.  
State Archaeologist  
(360) 586-3080  
email: [robw@cted.wa.gov](mailto:robw@cted.wa.gov)

**RECEIVED**  
JUL 18 2002  
**DOE-RL/RLCC**

### K.3 References

36 CFR 800. *Protection of Historic Properties.* Code of Federal Regulations. Online at: [http://www.access.gpo.gov/nara/cfr/waisidx\\_01/36cfr800\\_01.html](http://www.access.gpo.gov/nara/cfr/waisidx_01/36cfr800_01.html)

16 USC 470 et seq. National Historic Preservation Act (NHPA) of 1966. Online at: <http://www4.law.cornell.edu>

DOE-RL. 1995. *Ordnance and Explosive Waste Records Search Report*. DOE/RL-94-07, U.S. Department of Energy, Richland Operations Office, Richland, Washington.

Duranceau, D. A. 1995. *Site Evaluation Report for Candidate Basalt Quarry Sites*. BHI-00005, Rev. 00, Bechtel Hanford, Inc., Richland, Washington.

Hinds, N. R. and L. E. Rodgers. 1991. *Ecological Perspectives of Land Use History: The Arid Lands Ecology (ALE) Reserve*. PNL-7750, UC-702, prepared for the U.S. Department of Energy, Pacific Northwest Laboratory, Richland, Washington.

Rice, D. G. 1968. *Archaeological Reconnaissance: Hanford Atomic Works*. U.S. Atomic Energy Commission, National Park Service, and Washington State University, Pullman, Washington.

Van Arsdol, T. 1972. *Desert Boom and Bust – The Story of Irrigation Efforts and Town-Building in Benton County, Washington, 1888-1904*. Vancouver, Washington.