

APPENDIX G

**SURVEY UNIT CE-FSS-02-07
RESULTS AND DATA EVALUATION**

609300

609350

609400

383600

383550

383500

383450

CT State Plane NAD 27 Feet:

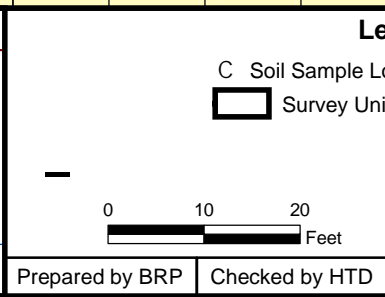
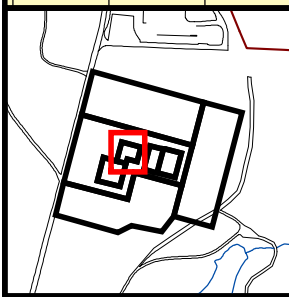
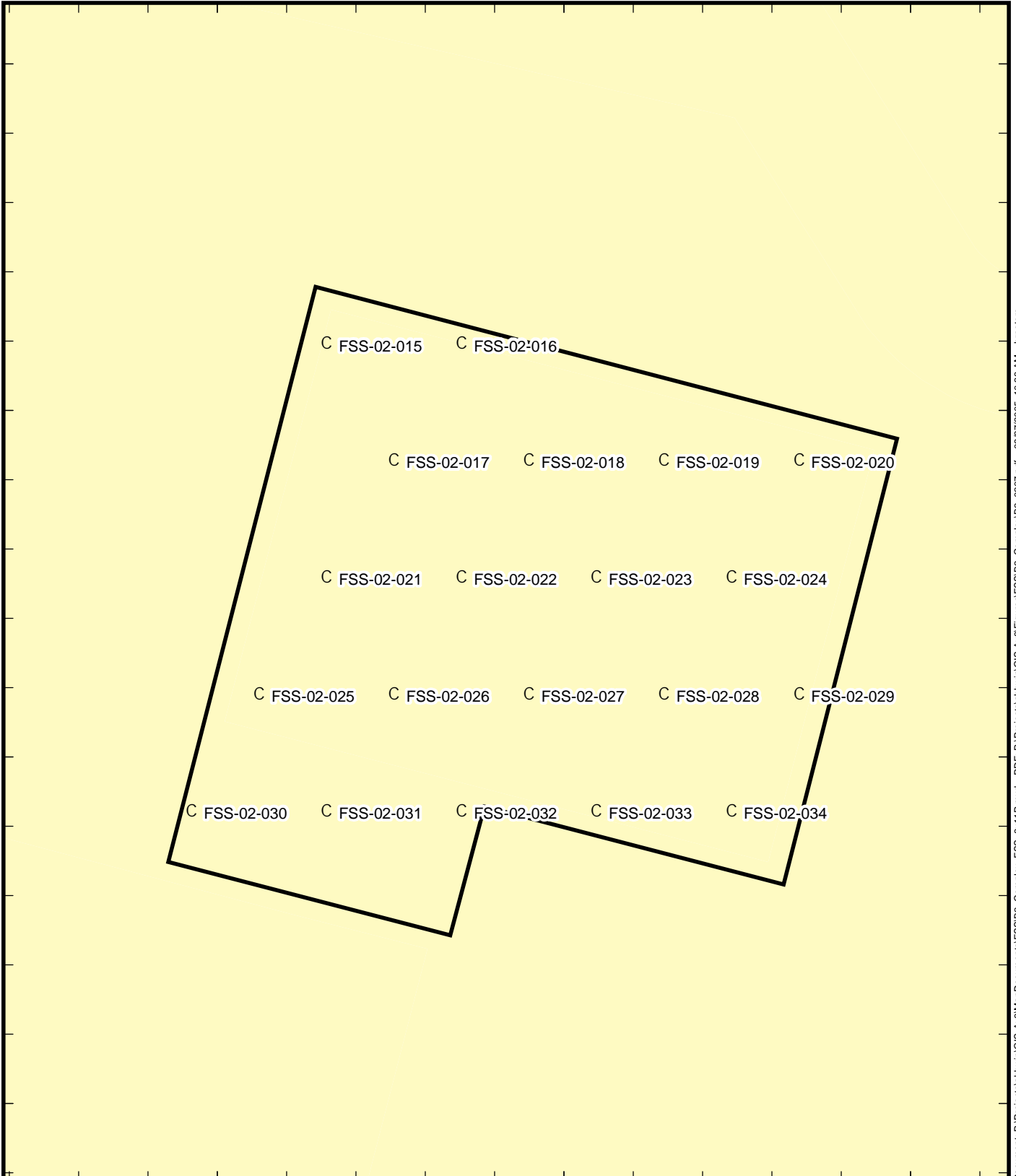

Legend

- C Soil Sample Location
- Survey Unit
- Forest
- Open
- Water
- Road

0 10 20 Feet

Prepared by BRP | Checked by HTD

Sample Locations
Building 2 Complex
Survey Unit CE-FSS-02-07

Final Status Survey
CE Windsor Site
Windsor, Connecticut

Document: P:\Projects\abbwin\GIS-Av8\MapDocuments\FSSB2_Complex_FSS_8x11P.mxd PDF: P:\Projects\abbwin\GIS-Av8\Figures\FSSB2_ComplexB2_0207.pdf 09/27/2005 10:38 AM brceters

609300

609350

609400

383600

383550

383500

383450

CT State Plane NAD 27 Feet:

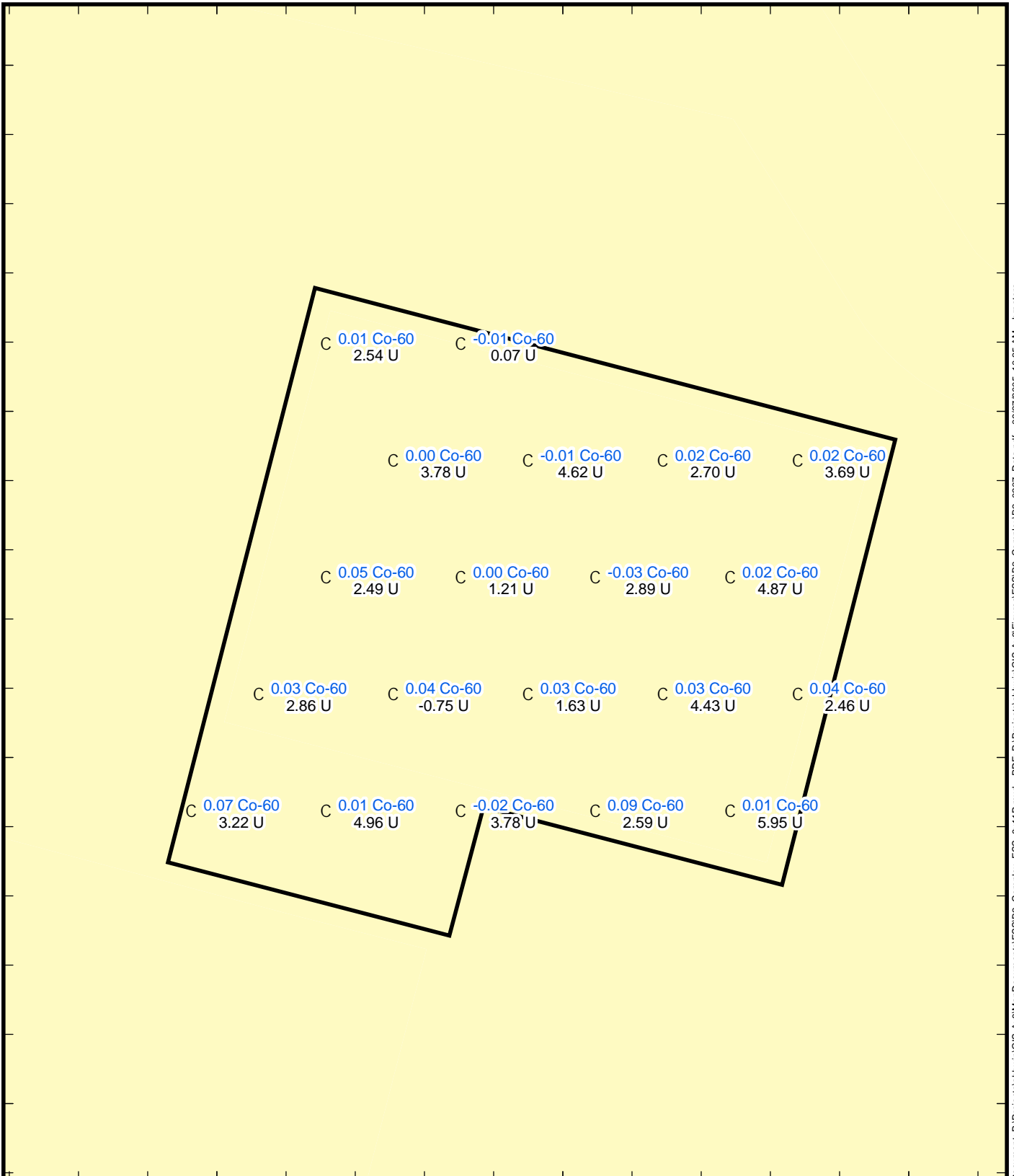

Document: P:\Projects\abbwin\GIS-Av8\MapDocuments\FSSB2_Complex_FSS_8x11P.mxd PDF: P:\Projects\abbwin\GIS-Av8\Figures\FSSB2_ComplexB2_0207_Data.pdf 09/27/2005 10:35 AM bpeters

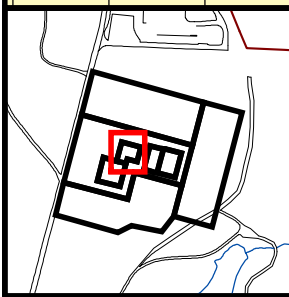

Legend

- Co-60 (pCi/g)
- Total U (pCi/g)
- C Soil Sample Location
- Survey Unit
- Forest
- Open
- Water
- Road

0 10 20 Feet

Prepared by BRP | Checked by HTD

Sample Results
 Building 2 Complex
 Survey Unit CE-FSS-02-07

Final Status Survey
 CE Windsor Site
 Windsor, Connecticut

MACTEC

Survey Unit CE-FSS-02-07

Final Status Survey Volumetric Soil Sample Results

| Sample ID | Co-60 | | | | U-235 | | | | Total U (pCi/g) | Sum of Fraction |
|-----------------|-----------|----------|----------|-----------|-----------|----------|----------|-----------|--------------------|--------------------|
| | Activity | Uncert. | MDC | Qualifier | Activity | Uncert. | MDC | Qualifier | | |
| SS-FSS-02-015 | 1.48E-02 | 7.88E-02 | 1.64E-02 | U | 8.20E-02 | 9.40E-02 | 1.82E-01 | U | 2.5 | 0.008 |
| SS-FSS-02-016 | -8.33E-03 | 8.57E-02 | 1.59E-01 | U | 2.18E-03 | 1.01E-01 | 1.80E-01 | U | 0.1 | -0.002 |
| SS-FSS-02-017 | 4.52E-03 | 7.48E-02 | 1.31E-01 | U | 1.22E-01 | 9.33E-02 | 1.83E-01 | U | 3.8 | 0.008 |
| SS-FSS-02-018 | -1.39E-02 | 5.42E-02 | 1.09E-01 | U | 1.49E-01 | 8.21E-02 | 1.65E-01 | U | 4.6 | 0.006 |
| SS-FSS-02-019 | 2.21E-02 | 7.65E-02 | 1.53E-02 | U | 8.71E-02 | 8.28E-02 | 1.60E-02 | U | 2.7 | 0.009 |
| SS-FSS-02-020 | 2.07E-02 | 6.42E-02 | 1.42E-01 | U | 1.19E-01 | 8.45E-02 | 1.67E-01 | U | 3.7 | 0.011 |
| SS-FSS-02-021 | 5.40E-02 | 5.89E-02 | 1.30E-01 | U | 8.03E-02 | 7.57E-02 | 1.42E-01 | U | 2.5 | 0.015 |
| SS-FSS-02-022 | 7.77E-04 | 5.83E-02 | 1.16E-01 | U | 3.91E-02 | 6.99E-02 | 1.29E-01 | U | 1.2 | 0.002 |
| SS-FSS-02-023 | -3.14E-02 | 5.70E-02 | 9.87E-02 | U | 9.32E-02 | 7.98E-02 | 1.52E-01 | U | 2.9 | -0.001 |
| SS-FSS-02-024 | 1.64E-02 | 7.69E-02 | 1.65E-01 | U | 1.57E-01 | 9.85E-02 | 1.97E-01 | U | 4.9 | 0.012 |
| SS-FSS-02-025 | 3.77E-02 | 4.87E-02 | 1.21E-01 | U | 7.72E-02 | 8.35E-02 | 1.57E-01 | U | 2.4 | |
| SS-FSS-02-025-D | 2.46E-02 | 6.60E-02 | 1.41E-01 | U | 1.07E-01 | 9.59E-02 | 1.87E-01 | U | 3.3 | |
| SS-FSS-02-025-A | 3.12E-02 | | | U | 9.21E-02 | | | U | 2.9 | 0.011 |
| SS-FSS-02-026 | 3.78E-02 | 7.07E-02 | 1.45E-01 | U | -2.43E-02 | 7.93E-02 | 1.40E-01 | U | -0.8 | 0.006 |
| SS-FSS-02-027 | 3.27E-02 | 6.12E-02 | 1.30E-01 | U | 5.25E-02 | 8.13E-02 | 1.54E-01 | U | 1.6 | 0.009 |
| SS-FSS-02-028 | 3.36E-02 | 6.76E-02 | 1.43E-01 | U | 1.43E-01 | 9.03E-02 | 1.78E-01 | U | 4.4 | 0.015 |
| SS-FSS-02-029 | 3.85E-02 | 5.05E-02 | 1.16E-01 | U | 7.95E-02 | 7.24E-02 | 1.37E-01 | U | 2.5 | 0.012 |
| SS-FSS-02-030 | 6.75E-02 | 7.64E-02 | 1.69E-01 | U | 1.04E-01 | 8.23E-02 | 1.62E-01 | U | 3.2 | 0.019 |
| SS-FSS-02-031 | 1.45E-02 | 8.04E-02 | 1.61E-01 | U | 1.60E-01 | 9.19E-02 | 1.83E-01 | U | 5.0 | 0.012 |
| SS-FSS-02-032 | -1.97E-02 | 5.54E-02 | 1.04E-01 | U | 1.22E-01 | 8.30E-02 | 1.64E-01 | U | 3.8 | 0.003 |
| SS-FSS-02-033 | 9.21E-02 | 6.19E-02 | 1.58E-02 | U | 8.37E-02 | 8.49E-02 | 1.62E-01 | U | 2.6 | 0.023 |
| SS-FSS-02-034 | 7.26E-03 | 1.15E-01 | 1.95E-01 | U | 1.92E-01 | 1.02E-01 | 2.07E-01 | U | 6.0 | 0.012 |

Investigation Level Volumetric Soil Sample Results

| Sample ID | Co-60 | | | | U-235 | | | | Total U (pCi/g) | Sum of Fraction |
|--------------|-----------|----------|----------|-----------|-----------|----------|----------|-----------|--------------------|--------------------|
| | Activity | Uncert. | MDC | Qualifier | Activity | Uncert. | MDC | Qualifier | | |
| MAC-0504-540 | 2.37E-02 | 7.44E-02 | 1.91E-01 | U | 1.09E-01 | 1.40E-01 | 2.70E-01 | U | 3.4 | 0.011 |
| MAC-0504-541 | -2.39E-02 | 7.93E-02 | 1.67E-01 | U | -1.79E-02 | 1.46E-01 | 2.63E-01 | U | -0.6 | -0.006 |

Survey Unit CE-FSS-02-07

One-Minute Static Field Measurement Results

| Sample ID | Static Count Rate (cpm) | Ambient Background (cpm) | Net (cpm) | pCi/g |
|---------------|-------------------------|--------------------------|-----------|-------|
| SS-FSS-02-015 | 3,000 | 2,400 | 600 | 2.0 |
| SS-FSS-02-016 | 3,080 | 2,400 | 680 | 2.3 |
| SS-FSS-02-017 | 2,701 | 2,400 | 301 | 1.0 |
| SS-FSS-02-018 | 2,984 | 2,400 | 584 | 1.9 |
| SS-FSS-02-019 | 2,604 | 2,400 | 204 | 0.7 |
| SS-FSS-02-020 | 2,794 | 2,400 | 394 | 1.3 |
| SS-FSS-02-021 | 2,566 | 2,400 | 166 | 0.6 |
| SS-FSS-02-022 | 2,333 | 2,400 | -67 | -0.2 |
| SS-FSS-02-023 | 2,284 | 2,400 | -116 | -0.4 |
| SS-FSS-02-024 | 2,901 | 2,400 | 501 | 1.7 |
| SS-FSS-02-025 | 2,772 | 2,400 | 372 | 1.2 |
| SS-FSS-02-026 | 2,654 | 2,400 | 254 | 0.8 |
| SS-FSS-02-027 | 2,813 | 2,400 | 413 | 1.4 |
| SS-FSS-02-028 | 2,881 | 2,400 | 481 | 1.6 |
| SS-FSS-02-029 | 2,400 | 2,400 | 0 | 0.0 |
| SS-FSS-02-030 | 2,233 | 2,400 | -167 | -0.6 |
| SS-FSS-02-031 | 2,619 | 2,400 | 219 | 0.7 |
| SS-FSS-02-032 | 2,834 | 2,400 | 434 | 1.4 |
| SS-FSS-02-033 | 2,619 | 2,400 | 219 | 0.7 |
| SS-FSS-02-034 | 2,716 | 2,400 | 316 | 1.1 |

Survey Unit CE-FSS-02-07

Final Status Survey Sample GPS Coordinates

| Sample ID | X Coord | Y Coord |
|---------------|--------------------|--------------------|
| SS-FSS-02-015 | 609315.76862800000 | 383559.73503699900 |
| SS-FSS-02-016 | 609335.24120299900 | 383559.73503699900 |
| SS-FSS-02-017 | 609325.50491599900 | 383542.87129200000 |
| SS-FSS-02-018 | 609344.97749099900 | 383542.87129200000 |
| SS-FSS-02-019 | 609364.45006599900 | 383542.87129200000 |
| SS-FSS-02-020 | 609383.92264200000 | 383542.87129200000 |
| SS-FSS-02-021 | 609315.76862800000 | 383526.00754700000 |
| SS-FSS-02-022 | 609335.24120299900 | 383526.00754700000 |
| SS-FSS-02-023 | 609354.71377899900 | 383526.00754700000 |
| SS-FSS-02-024 | 609374.18635400000 | 383526.00754700000 |
| SS-FSS-02-025 | 609306.03234100000 | 383509.14380199900 |
| SS-FSS-02-026 | 609325.50491599900 | 383509.14380199900 |
| SS-FSS-02-027 | 609344.97749099900 | 383509.14380199900 |
| SS-FSS-02-028 | 609364.45006599900 | 383509.14380199900 |
| SS-FSS-02-029 | 609383.92264200000 | 383509.14380199900 |
| SS-FSS-02-030 | 609296.29605300000 | 383492.28005800000 |
| SS-FSS-02-031 | 609315.76862800000 | 383492.28005800000 |
| SS-FSS-02-032 | 609335.24120299900 | 383492.28005800000 |
| SS-FSS-02-033 | 609354.71377899900 | 383492.28005800000 |
| SS-FSS-02-034 | 609374.18635400000 | 383492.28005800000 |

Descriptive Statistics Report

Page/Date/Time 1 9/7/2005 1:39:11 PM
 Database C:\MACTEC\PROJECTS\WINDSOR\F ... COMPLEX\STATS INFO\ALL SU.S0

Summary Section of SU7_Tot_U

| Count | Mean | Standard Deviation | Standard Error | Minimum | Maximum | Range |
|-------|-------|--------------------|----------------|---------|---------|-------|
| 20 | 3.005 | 1.654492 | 0.3699555 | -0.8 | 6 | 6.8 |

Counts Section of SU7_Tot_U

| Rows | Sum of Frequencies | Missing Values | Distinct Values | Sum | Total Sum Squares | Adjusted Sum Squares |
|------|--------------------|----------------|-----------------|------|-------------------|----------------------|
| 130 | 20 | 110 | 16 | 60.1 | 232.61 | 52.0095 |

Means Section of SU7_Tot_U

| Parameter | Mean | Median | Geometric Mean | Harmonic Mean | Sum | Mode |
|------------|-----------|--------|----------------|---------------|----------|------|
| Value | 3.005 | 2.9 | 2.622216 | 1.335339 | 60.1 | 2.5 |
| Std Error | 0.3699555 | | | | 7.399111 | |
| 95% LCL | 2.230674 | 2.5 | | | 44.61348 | |
| 95% UCL | 3.779326 | 3.8 | | | 75.58652 | |
| T-Value | 8.1226 | | | | | |
| Prob Level | 0.000000 | | | | | |
| Count | 20 | | 19 | 20 | | 3 |

Variation Section of SU7_Tot_U

| Parameter | Variance | Standard Deviation | Unbiased Std Dev | Std Error of Mean | Interquartile Range | Range |
|-----------|-----------|--------------------|------------------|-------------------|---------------------|-------|
| Value | 2.737342 | 1.654492 | 1.676395 | 0.3699555 | 1.75 | 6.8 |
| Std Error | 0.8819732 | 0.3769432 | | 8.428705E-02 | | |
| 95% LCL | 1.58313 | 1.258225 | | 0.2813476 | | |
| 95% UCL | 5.839489 | 2.416503 | | 0.5403466 | | |

Skewness and Kurtosis Section of SU7_Tot_U

| Parameter | Skewness | Kurtosis | Fisher's g1 | Fisher's g2 | Coefficient of Variation | Coefficient of Dispersion |
|-----------|------------|-----------|-------------|-------------|--------------------------|---------------------------|
| Value | -0.4651357 | 3.076264 | -0.5037313 | 0.4719917 | 0.5505795 | 0.4224138 |
| Std Error | 0.3349392 | 0.7611905 | | | 0.1265529 | |

Trimmed Section of SU7_Tot_U

| Parameter | 5% Trimmed | 10% Trimmed | 15% Trimmed | 25% Trimmed | 35% Trimmed | 45% Trimmed |
|--------------|------------|-------------|-------------|-------------|-------------|--------------|
| Trim-Mean | 3.05 | 3.1125 | 3.121428 | 3.06 | 3 | 2.9 |
| Trim-Std Dev | 1.295354 | 1.031423 | 0.8368242 | 0.5316641 | 0.4 | 3.869194E-08 |
| Count | 18 | 16 | 14 | 10 | 6 | 2 |

Mean-Deviation Section of SU7_Tot_U

| Parameter | X-Mean | X-Median | (X-Mean)^2 | (X-Mean)^3 | (X-Mean)^4 |
|-----------|-----------|----------|------------|------------|------------|
| Average | 1.2355 | 1.225 | 2.600475 | -1.950557 | 20.80315 |
| Std Error | 0.2223216 | | 0.8378746 | 1.68168 | 9.928052 |

Descriptive Statistics Report

Page/Date/Time 2 9/7/2005 1:39:11 PM
 Database C:\MACTEC\PROJECTS\WINDSOR\F ... COMPLEX\STATS INFO\ALL SU.S0

Quartile Section of SU7_Tot_U

| | 10th | 25th | 50th | 75th | 90th |
|-----------|------------|------------|------------|------------|------------|
| Parameter | Percentile | Percentile | Percentile | Percentile | Percentile |
| Value | 0.21 | 2.5 | 2.9 | 4.25 | 4.99 |
| 95% LCL | | -0.8 | 2.5 | 2.9 | |
| 95% UCL | | 2.7 | 3.8 | 5 | |

Normality Test Section of SU7_Tot_U

| Test Name | Test Value | Prob Level | 10% Critical Value | 5% Critical Value | Decision (5%) |
|---------------------|------------|------------|--------------------|-------------------|------------------|
| Shapiro-Wilk W | 0.967027 | 0.691279 | | | Accept Normality |
| Anderson-Darling | 0.3190844 | 0.534686 | | | Accept Normality |
| Martinez-Iglewicz | 1.032226 | | 1.216194 | 1.357297 | Accept Normality |
| Kolmogorov-Smirnov | 0.1300956 | | 0.176 | 0.192 | Accept Normality |
| D'Agostino Skewness | -1.0240 | 0.305824 | 1.645 | 1.960 | Accept Normality |
| D'Agostino Kurtosis | 0.6968 | 0.485956 | 1.645 | 1.960 | Accept Normality |
| D'Agostino Omnibus | 1.5341 | 0.464382 | 4.605 | 5.991 | Accept Normality |

Plots Section of SU7_Tot_U

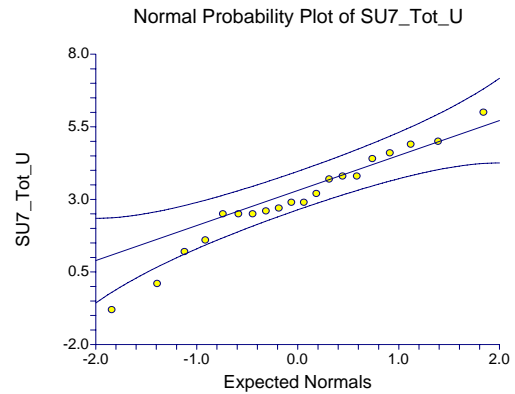
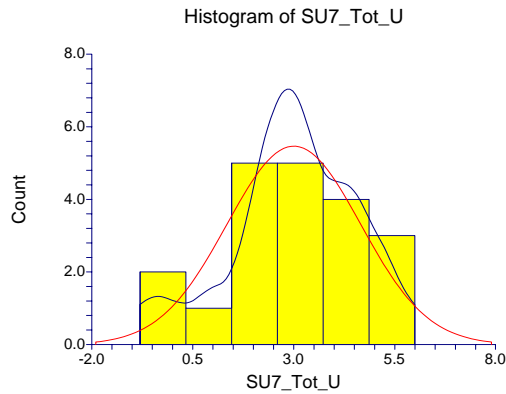

Descriptive Statistics Report

Page/Date/Time 3 9/7/2005 1:39:11 PM
 Database C:\MACTEC\PROJECTS\WINDSOR\F ... COMPLEX\STATS INFO\ALL SU.S0

Percentile Section of SU7_Tot_U

| Percentile | Value | 95% LCL | 95% UCL | Exact Conf. Level |
|------------|--------|---------|---------|-------------------|
| 99.0 | 6 | | | |
| 95.0 | 5.95 | | | |
| 90.0 | 4.99 | | | |
| 85.0 | 4.855 | 3.7 | 6 | 95.5319 |
| 80.0 | 4.56 | 3.7 | 6 | 95.6328 |
| 75.0 | 4.25 | 2.9 | 5 | 96.1823 |
| 70.0 | 3.8 | 2.9 | 5 | 97.5218 |
| 65.0 | 3.765 | 2.7 | 4.9 | 96.8303 |
| 60.0 | 3.5 | 2.6 | 4.6 | 96.3010 |
| 55.0 | 3.065 | 2.5 | 4.4 | 97.4703 |
| 50.0 | 2.9 | 2.5 | 3.8 | 97.3396 |
| 45.0 | 2.79 | 2.5 | 3.8 | 95.9722 |
| 40.0 | 2.64 | 1.2 | 3.7 | 97.5360 |
| 35.0 | 2.535 | 1.2 | 3.2 | 96.8303 |
| 30.0 | 2.5 | 0.1 | 2.9 | 97.5218 |
| 25.0 | 2.5 | -0.8 | 2.7 | 95.5904 |
| 20.0 | 1.78 | -0.8 | 2.6 | 95.6328 |
| 15.0 | 1.26 | -0.8 | 2.6 | 95.5319 |
| 10.0 | 0.21 | | | |
| 5.0 | -0.755 | | | |
| 1.0 | -0.8 | | | |

Percentile Formula: Ave X(p[n+1])

Stem-Leaf Plot Section of SU7_Tot_U

| Depth | Stem | Leaves |
|-------|------|---------|
| Low | | -8,1 |
| 3 | 1* | 2 |
| 4 | . | 6 |
| 4 | 2* | |
| (7) | . | 5556799 |
| 9 | 3* | 2 |
| 8 | . | 788 |
| 5 | 4* | 4 |
| 4 | . | 69 |
| 2 | 5* | 0 |
| 1 | . | |
| 1 | 6* | 0 |

Unit = .1 Example: 1 |2 Represents 1.2

Descriptive Statistics Report

Page/Date/Time 4 9/7/2005 1:39:11 PM
 Database C:\MACTEC\PROJECTS\WINDSOR\F ... COMPLEX\STATS INFO\ALL SU.S0

Summary Section of SU7_Co_60

| Count | Mean | Standard Deviation | Standard Error | Minimum | Maximum | Range |
|-------|--------------|--------------------|----------------|---------|---------|--------|
| 20 | 2.075635E-02 | 2.968826E-02 | 6.638496E-03 | -0.0314 | 0.0921 | 0.1235 |

Counts Section of SU7_Co_60

| Rows | Sum of Frequencies | Missing Values | Distinct Values | Sum | Total Sum Squares | Adjusted Sum Squares |
|------|--------------------|----------------|-----------------|----------|-------------------|----------------------|
| 130 | 20 | 110 | 20 | 0.415127 | 2.536298E-02 | 1.674646E-02 |

Means Section of SU7_Co_60

| Parameter | Mean | Median | Geometric Mean | Harmonic Mean | Sum | Mode |
|------------|--------------|----------|----------------|---------------|-----------|------|
| Value | 2.075635E-02 | 0.01855 | 2.005997E-02 | 1.080227E-02 | 0.415127 | |
| Std Error | 6.638496E-03 | | | | 0.1327699 | |
| 95% LCL | 6.861818E-03 | 0.000777 | | | 0.1372364 | |
| 95% UCL | 3.465088E-02 | 0.0336 | | | 0.6930177 | |
| T-Value | 3.1267 | | | | | |
| Prob Level | 0.005555 | | | | | |
| Count | 20 | | 16 | 20 | | |

Variation Section of SU7_Co_60

| Parameter | Variance | Standard Deviation | Unbiased Std Dev | Std Error of Mean | Interquartile Range | Range |
|-----------|--------------|--------------------|------------------|-------------------|---------------------|--------|
| Value | 8.813926E-04 | 2.968826E-02 | 3.008129E-02 | 6.638496E-03 | 3.503725E-02 | 0.1235 |
| Std Error | 2.912657E-04 | 6.937287E-03 | | 1.551225E-03 | | |
| 95% LCL | 5.097496E-04 | 2.257763E-02 | | 5.048512E-03 | | |
| 95% UCL | 1.880248E-03 | 4.336183E-02 | | 9.695999E-03 | | |

Skewness and Kurtosis Section of SU7_Co_60

| Parameter | Skewness | Kurtosis | Fisher's g1 | Fisher's g2 | Coefficient of Variation | Coefficient of Dispersion |
|-----------|-----------|-----------|-------------|-------------|--------------------------|---------------------------|
| Value | 0.4703544 | 3.184087 | 0.509383 | 0.6125838 | 1.430322 | 1.200197 |
| Std Error | 0.358756 | 0.7633475 | | | 0.4331097 | |

Trimmed Section of SU7_Co_60

| Parameter | 5% Trimmed | 10% Trimmed | 15% Trimmed | 25% Trimmed | 35% Trimmed | 45% Trimmed |
|--------------|--------------|--------------|--------------|--------------|-------------|--------------|
| Trim-Mean | 1.969039E-02 | 1.916419E-02 | 1.903764E-02 | 0.019778 | 0.01995 | 0.01855 |
| Trim-Std Dev | 2.290107E-02 | 1.839205E-02 | 1.458929E-02 | 1.026475E-02 | 6.33364E-03 | 3.040559E-03 |
| Count | 18 | 16 | 14 | 10 | 6 | 2 |

Mean-Deviation Section of SU7_Co_60

| Parameter | X-Mean | X-Median | (X-Mean)^2 | (X-Mean)^3 | (X-Mean)^4 |
|-----------|--------------|--------------|--------------|--------------|--------------|
| Average | 2.226928E-02 | 2.226365E-02 | 8.37323E-04 | 1.139632E-05 | 2.232394E-06 |
| Std Error | 3.989346E-03 | | 2.767024E-04 | 1.111486E-05 | 1.177093E-06 |

Descriptive Statistics Report

Page/Date/Time 5 9/7/2005 1:39:11 PM
 Database C:\MACTEC\PROJECTS\WINDSOR\F ... COMPLEX\STATS INFO\ALL SU.S0

Quartile Section of SU7_Co_60

| | 10th | 25th | 50th | 75th | 90th |
|-----------|------------|-------------|------------|------------|------------|
| Parameter | Percentile | Percentile | Percentile | Percentile | Percentile |
| Value | -0.01912 | 1.71275E-03 | 0.01855 | 0.03675 | 0.06615 |
| 95% LCL | | -0.0314 | 0.000777 | 0.0207 | |
| 95% UCL | | 0.0148 | 0.0336 | 0.0675 | |

Normality Test Section of SU7_Co_60

| Test Name | Test Value | Prob Level | 10% Critical Value | 5% Critical Value | Decision (5%) |
|---------------------|------------|------------|--------------------|-------------------|------------------|
| Shapiro-Wilk W | 0.9768388 | 0.887111 | | | Accept Normality |
| Anderson-Darling | 0.2050034 | 0.873011 | | | Accept Normality |
| Martinez-Iglewicz | 1.081772 | | 1.216194 | 1.357297 | Accept Normality |
| Kolmogorov-Smirnov | 0.1250315 | | 0.176 | 0.192 | Accept Normality |
| D'Agostino Skewness | 1.0350 | 0.300646 | 1.645 | 1.960 | Accept Normality |
| D'Agostino Kurtosis | 0.8171 | 0.413853 | 1.645 | 1.960 | Accept Normality |
| D'Agostino Omnibus | 1.7390 | 0.419155 | 4.605 | 5.991 | Accept Normality |

Plots Section of SU7_Co_60

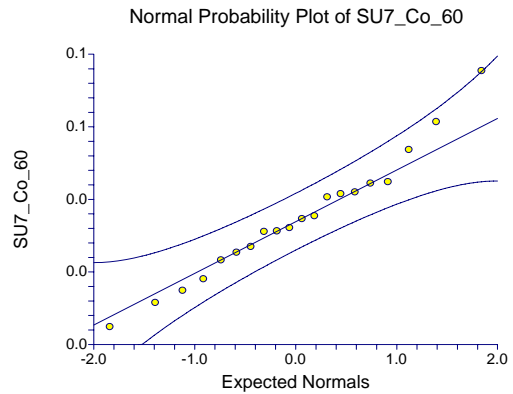
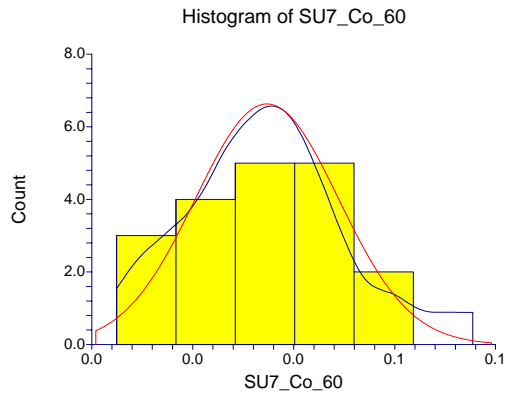

Descriptive Statistics Report

Page/Date/Time 6 9/7/2005 1:39:11 PM
 Database C:\MACTEC\PROJECTS\WINDSOR\F ... COMPLEX\STATS INFO\ALL SU.S0

Percentile Section of SU7_Co_60

| Percentile | Value | 95% LCL | 95% UCL | Exact Conf. Level |
|------------|-------------|----------|---------|-------------------|
| 99.0 | 0.0921 | | | |
| 95.0 | 0.09087 | | | |
| 90.0 | 0.06615 | | | |
| 85.0 | 0.051675 | 0.0312 | 0.0921 | 95.5319 |
| 80.0 | 0.03836 | 0.0312 | 0.0921 | 95.6328 |
| 75.0 | 0.03675 | 0.0207 | 0.0675 | 96.1823 |
| 70.0 | 0.03333 | 0.0164 | 0.0675 | 97.5218 |
| 65.0 | 0.032175 | 0.0148 | 0.054 | 96.8303 |
| 60.0 | 0.02756 | 0.0145 | 0.0385 | 96.3010 |
| 55.0 | 0.02147 | 0.00452 | 0.0378 | 97.4703 |
| 50.0 | 0.01855 | 0.000777 | 0.0336 | 97.3396 |
| 45.0 | 0.01552 | 0.000777 | 0.0327 | 95.9722 |
| 40.0 | 0.01462 | -0.0139 | 0.0312 | 97.5360 |
| 35.0 | 0.009794 | -0.0139 | 0.0221 | 96.8303 |
| 30.0 | 0.005342 | -0.0197 | 0.0207 | 97.5218 |
| 25.0 | 1.71275E-03 | -0.0314 | 0.0148 | 95.5904 |
| 20.0 | -0.0065086 | -0.0314 | 0.0145 | 95.6328 |
| 15.0 | -0.0130645 | -0.0314 | 0.0145 | 95.5319 |
| 10.0 | -0.01912 | | | |
| 5.0 | -0.030815 | | | |
| 1.0 | -0.0314 | | | |

Percentile Formula: Ave X(p[n+1])

Stem-Leaf Plot Section of SU7_Co_60

| Depth | Stem | Leaves |
|-------|------|--------|
| 1 | -3 | 1 |
| 1 | -2 | |
| 3 | -1 | 93 |
| 4 | -0 | 8 |
| 7 | 0 | 047 |
| 10 | 1 | 446 |
| 10 | 2 | 02 |
| 8 | 3 | 12378 |
| 3 | 4 | |
| 3 | 5 | 4 |
| 2 | 6 | 7 |
| High | | 92 |

Unit = .001 Example: 1 |2 Represents 0.012

Descriptive Statistics Report

Page/Date/Time 7 9/7/2005 1:39:11 PM
 Database C:\MACTEC\PROJECTS\WINDSOR\F ... COMPLEX\STATS INFO\ALL SU.S0

Summary Section of SOF_SU7

| Count | Mean | Standard Deviation | Standard Error | Minimum | Maximum | Range |
|-------|---------|--------------------|----------------|---------|---------|-------|
| 20 | 0.00955 | 6.227908E-03 | 1.392603E-03 | -0.002 | 0.023 | 0.025 |

Counts Section of SOF_SU7

| Rows | Sum of Frequencies | Missing Values | Distinct Values | Sum | Total Sum Squares | Adjusted Sum Squares |
|------|--------------------|----------------|-----------------|-------|-------------------|----------------------|
| 130 | 20 | 110 | 12 | 0.191 | 0.002561 | 7.3695E-04 |

Means Section of SOF_SU7

| Parameter | Mean | Median | Geometric Mean | Harmonic Mean | Sum | Mode |
|------------|--------------|--------|----------------|---------------|--------------|-------|
| Value | 0.00955 | 0.01 | 9.355351E-03 | 2.283345E-02 | 0.191 | 0.012 |
| Std Error | 1.392603E-03 | | | | 2.785205E-02 | |
| 95% LCL | 6.635249E-03 | 0.006 | | | 0.132705 | |
| 95% UCL | 1.246475E-02 | 0.012 | | | 0.249295 | |
| T-Value | 6.8577 | | | | | |
| Prob Level | 0.000002 | | | | | |
| Count | 20 | | 18 | 20 | | 5 |

Variation Section of SOF_SU7

| Parameter | Variance | Standard Deviation | Unbiased Std Dev | Std Error of Mean | Interquartile Range | Range |
|-----------|--------------|--------------------|------------------|-------------------|---------------------|-------|
| Value | 3.878684E-05 | 6.227908E-03 | 6.310358E-03 | 1.392603E-03 | 0.006 | 0.025 |
| Std Error | 1.189738E-05 | 1.350809E-03 | | 3.020502E-04 | | |
| 95% LCL | 2.24322E-05 | 4.736264E-03 | | 1.059061E-03 | | |
| 95% UCL | 8.274279E-05 | 9.096306E-03 | | 2.033996E-03 | | |

Skewness and Kurtosis Section of SOF_SU7

| Parameter | Skewness | Kurtosis | Fisher's g1 | Fisher's g2 | Coefficient of Variation | Coefficient of Dispersion |
|-----------|--------------|-----------|--------------|-------------|--------------------------|---------------------------|
| Value | 3.435943E-02 | 2.881758 | 3.721048E-02 | 0.2183704 | 0.652137 | 0.475 |
| Std Error | 0.3415649 | 0.6262091 | | | 0.1346484 | |

Trimmed Section of SOF_SU7

| Parameter | 5% Trimmed | 10% Trimmed | 15% Trimmed | 25% Trimmed | 35% Trimmed | 45% Trimmed |
|--------------|--------------|--------------|--------------|-------------|--------------|--------------|
| Trim-Mean | 9.444444E-03 | 0.0095 | 9.642857E-03 | 0.0099 | 1.016667E-02 | 0.01 |
| Trim-Std Dev | 4.984945E-03 | 3.847077E-03 | 3.225073E-03 | 2.18327E-03 | 1.722401E-03 | 1.414214E-03 |
| Count | 18 | 16 | 14 | 10 | 6 | 2 |

Mean-Deviation Section of SOF_SU7

| Parameter | X-Mean | X-Median | (X-Mean)^2 | (X-Mean)^3 | (X-Mean)^4 |
|-----------|--------------|----------|--------------|--------------|--------------|
| Average | 0.00475 | 0.00475 | 3.68475E-05 | 7.68525E-09 | 3.912673E-09 |
| Std Error | 8.368724E-04 | | 1.130251E-05 | 7.762709E-08 | 1.806586E-09 |

Descriptive Statistics Report

Page/Date/Time 8 9/7/2005 1:39:11 PM
 Database C:\MACTEC\PROJECTS\WINDSOR\F ... COMPLEX\STATS INFO\ALL SU.S0

Quartile Section of SOF_SU7

| | 10th | 25th | 50th | 75th | 90th |
|-----------|------------|------------|------------|------------|------------|
| Parameter | Percentile | Percentile | Percentile | Percentile | Percentile |
| Value | -0.0007 | 0.006 | 0.01 | 0.012 | 0.0186 |
| 95% LCL | | -0.002 | 0.006 | 0.011 | |
| 95% UCL | | 0.009 | 0.012 | 0.019 | |

Normality Test Section of SOF_SU7

| Test Name | Test Value | Prob Level | 10% Critical Value | 5% Critical Value | Decision (5%) |
|---------------------|------------|------------|--------------------|-------------------|------------------|
| Shapiro-Wilk W | 0.9711025 | 0.777974 | | | Accept Normality |
| Anderson-Darling | 0.3098324 | 0.556132 | | | Accept Normality |
| Martinez-Iglewicz | 1.014322 | | 1.216194 | 1.357297 | Accept Normality |
| Kolmogorov-Smirnov | 0.1470155 | | 0.176 | 0.192 | Accept Normality |
| D'Agostino Skewness | 0.0772 | 0.938442 | 1.645 | 1.960 | Accept Normality |
| D'Agostino Kurtosis | 0.4602 | 0.645359 | 1.645 | 1.960 | Accept Normality |
| D'Agostino Omnibus | 0.2178 | 0.896836 | 4.605 | 5.991 | Accept Normality |

Plots Section of SOF_SU7

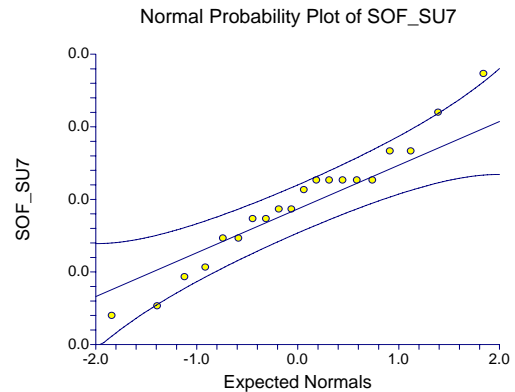
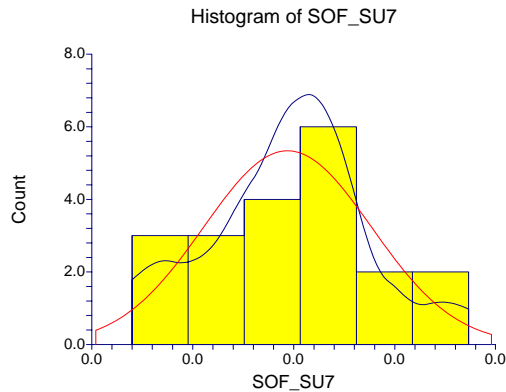

Descriptive Statistics Report

Page/Date/Time 9 9/7/2005 1:39:11 PM
 Database C:\MACTEC\PROJECTS\WINDSOR\F ... COMPLEX\STATS INFO\ALL SU.S0

Percentile Section of SOF_SU7

| Percentile | Value | 95% LCL | 95% UCL | Exact Conf. Level |
|------------|----------|---------|---------|-------------------|
| 99.0 | 0.023 | | | |
| 95.0 | 0.0228 | | | |
| 90.0 | 0.0186 | | | |
| 85.0 | 0.015 | 0.012 | 0.023 | 95.5319 |
| 80.0 | 0.0144 | 0.012 | 0.023 | 95.6328 |
| 75.0 | 0.012 | 0.011 | 0.019 | 96.1823 |
| 70.0 | 0.012 | 0.009 | 0.019 | 97.5218 |
| 65.0 | 0.012 | 0.009 | 0.015 | 96.8303 |
| 60.0 | 0.012 | 0.008 | 0.015 | 96.3010 |
| 55.0 | 0.01155 | 0.006 | 0.012 | 97.4703 |
| 50.0 | 0.01 | 0.006 | 0.012 | 97.3396 |
| 45.0 | 0.009 | 0.006 | 0.012 | 95.9722 |
| 40.0 | 0.0084 | 0.002 | 0.012 | 97.5360 |
| 35.0 | 0.008 | 0.002 | 0.012 | 96.8303 |
| 30.0 | 0.0066 | -0.001 | 0.011 | 97.5218 |
| 25.0 | 0.006 | -0.002 | 0.009 | 95.5904 |
| 20.0 | 0.0036 | -0.002 | 0.008 | 95.6328 |
| 15.0 | 0.00215 | -0.002 | 0.008 | 95.5319 |
| 10.0 | -0.0007 | | | |
| 5.0 | -0.00195 | | | |
| 1.0 | -0.002 | | | |

Percentile Formula: Ave X(p[n+1])

Stem-Leaf Plot Section of SOF_SU7

| Depth | Stem | Leaves |
|-------|------|--------|
| 2 | -0* | 21 |
| 2 | 0* | |
| 4 | T | 23 |
| 4 | F | |
| 6 | S | 66 |
| 10 | . | 8899 |
| 10 | 1* | 1 |
| 9 | T | 22222 |
| 4 | F | 55 |
| 2 | S | |
| 2 | . | 9 |
| 1 | 2* | |
| High | | 23 |

Unit = .001 Example: 1 |2 Represents 0.012

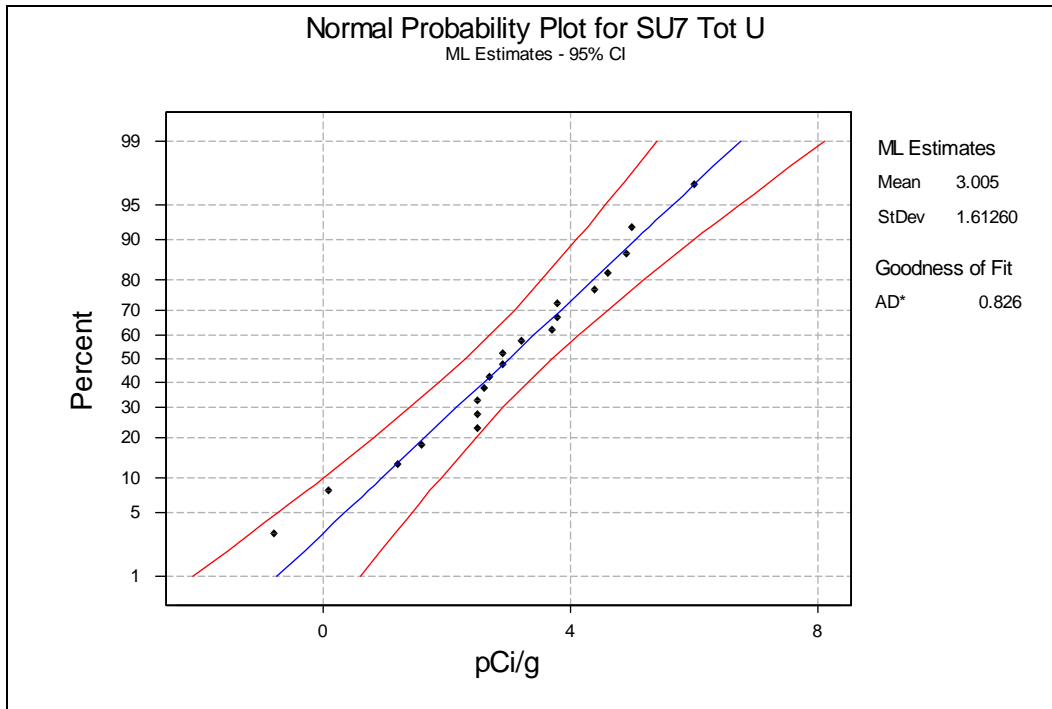

Normal Probability Plot, Survey Unit 7, Total Uranium

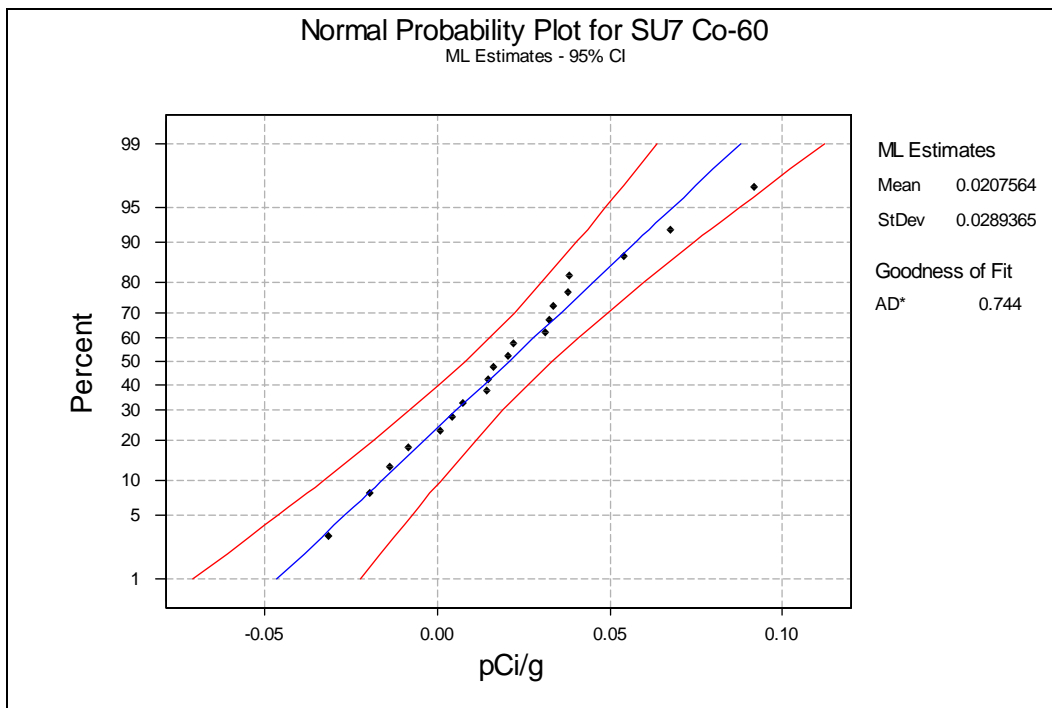

Normal Probability Plot, Survey Unit 7, Co-60

Descriptive Statistics

Variable: SOF SU_7

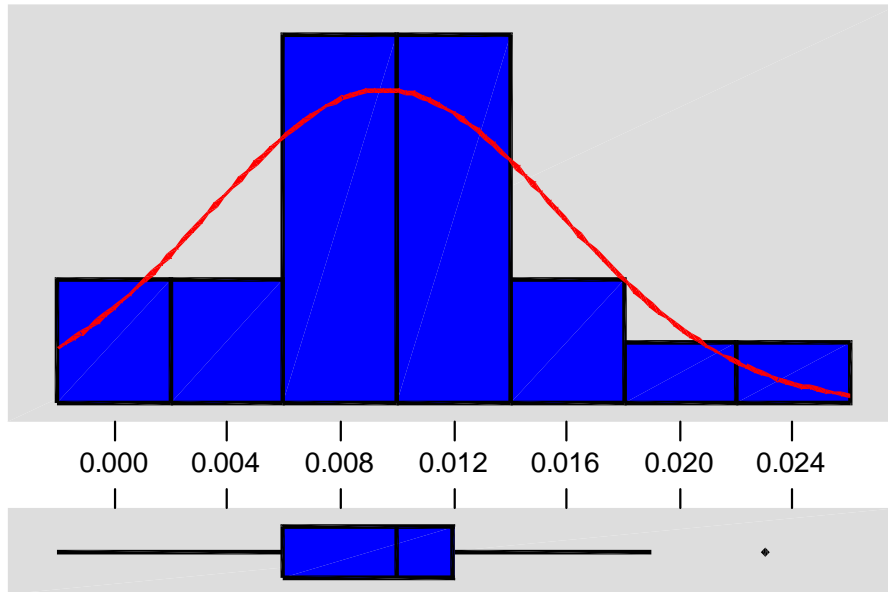

Anderson-Darling Normality Test

A-Squared: 0.308
P-Value: 0.530

Mean 9.55E-03
StDev 6.23E-03
Variance 3.88E-05
Skewness 3.72E-02
Kurtosis 0.218370
N 20

Minimum -2.0E-03
1st Quartile 6.00E-03
Median 1.00E-02
3rd Quartile 1.20E-02
Maximum 2.30E-02

95% Confidence Interval for Mu

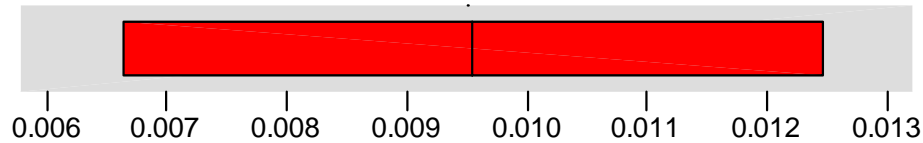

95% Confidence Interval for Mu

6.64E-03 1.25E-02

95% Confidence Interval for Sigma

4.74E-03 9.10E-03

95% Confidence Interval for Median

6.47E-03 1.20E-02

95% Confidence Interval for Median



One-Sample T-Test Report

Page/Date/Time 1 9/6/2005 12:25:39 PM
 Database C:\MACTEC\Projects\Windsor\F ... Complex\Stats Info\All SU.S0
 Variable SOF_SU7

Descriptive Statistics Section

| Variable | Count | Mean | Standard Deviation | Standard Error | 95% LCL of Mean | 95% UCL of Mean |
|----------|-------|---------|--------------------|----------------|-----------------|-----------------|
| SOF_SU7 | 20 | 0.00955 | 6.227908E-03 | 1.392603E-03 | 6.635249E-03 | 1.246475E-02 |

T for Confidence Limits = 2.0930

Tests of Assumptions Section

| Assumption | Value | Probability | Decision(5%) |
|-------------------------|--------|-------------|-------------------------|
| Skewness Normality | 0.0772 | 0.938442 | Cannot reject normality |
| Kurtosis Normality | 0.4602 | 0.645359 | Cannot reject normality |
| Omnibus Normality | 0.2178 | 0.896836 | Cannot reject normality |
| Correlation Coefficient | | | |

T-Test For Difference Between Mean and Value Section

| Alternative Hypothesis | T-Value | Prob Level | Decision (5%) | Power (Alpha=.05) | Power (Alpha=.01) |
|------------------------|-----------|------------|---------------|-------------------|-------------------|
| SOF_SU7<>1 | -711.2223 | 0.000000 | Reject Ho | 1.000000 | 1.000000 |
| SOF_SU7<1 | -711.2223 | 0.000000 | Reject Ho | 1.000000 | 1.000000 |
| SOF_SU7>1 | -711.2223 | 1.000000 | Accept Ho | 0.000000 | 0.000000 |

Nonparametric Tests Section

Quantile (Sign) Test

| Hypothesized Value | Quantile | Number Lower | Number Higher | Prob Lower | Prob Higher | Prob Both |
|--------------------|----------|--------------|---------------|------------|-------------|-----------|
| 1 | 0.5 | 20 | 0 | 1.000000 | 0.000001 | 0.000002 |

Wilcoxon Signed-Rank Test for Difference in Medians

| W Sum Ranks | Mean of W | Std Dev of W | Number of Zeros | Number Sets of Ties | Multiplicity Factor |
|-------------|-----------|--------------|-----------------|---------------------|---------------------|
| 0 | 105 | 26.73013 | 0 | 5 | 144 |

| Alternative Hypothesis | Exact Probability | | Approximation Without Continuity Correction | | Approximation With Continuity Correction | | Decision (5%) | |
|------------------------|-------------------|---------------|---|------------|--|---------|---------------|------------|
| | Prob Level | Decision (5%) | Z-Value | Prob Level | Decision (5%) | Z-Value | | Prob Level |
| Median<>1 | | | 3.9282 | 0.000086 | Reject Ho | 3.9094 | 0.000093 | Reject Ho |
| Median<1 | | | -3.9282 | 0.000043 | Reject Ho | -3.9094 | 0.000046 | Reject Ho |
| Median>1 | | | -3.9282 | 0.999957 | Accept Ho | -3.9469 | 0.999960 | Accept Ho |

One-Sample T-Test Report

Page/Date/Time 2 9/6/2005 12:25:39 PM
Database C:\MACTEC\Projects\Windsor\F ... Complex\Stats Info\All SU.S0
Variable SOF_SU7

Plots Section

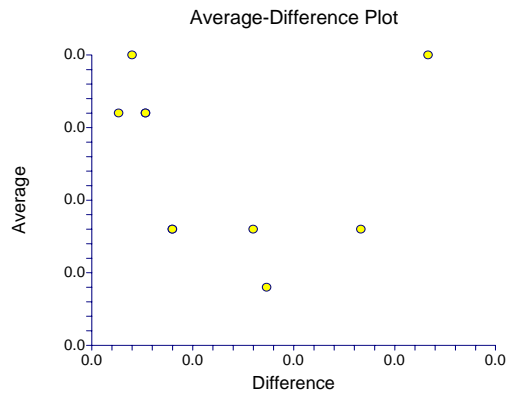
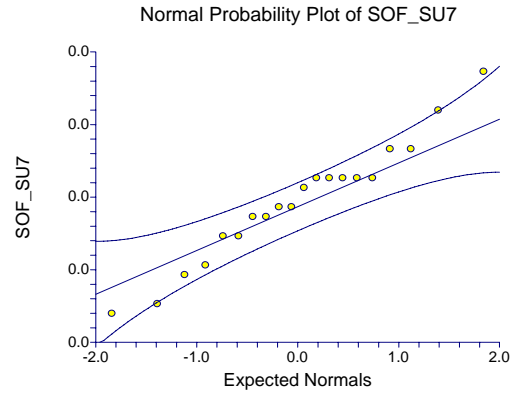
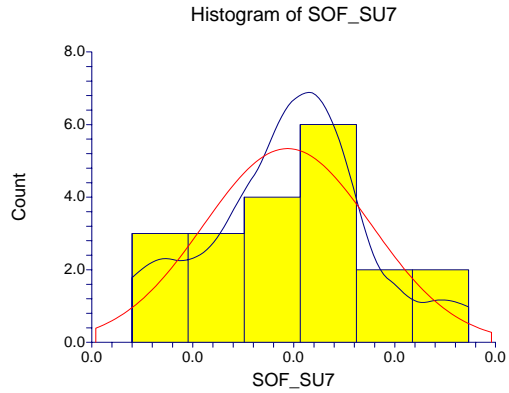

Retrospective Power of the Sign Test

Surface Soil Volumetric Measurements SOF Values

Survey Unit CE-FSS-02-07

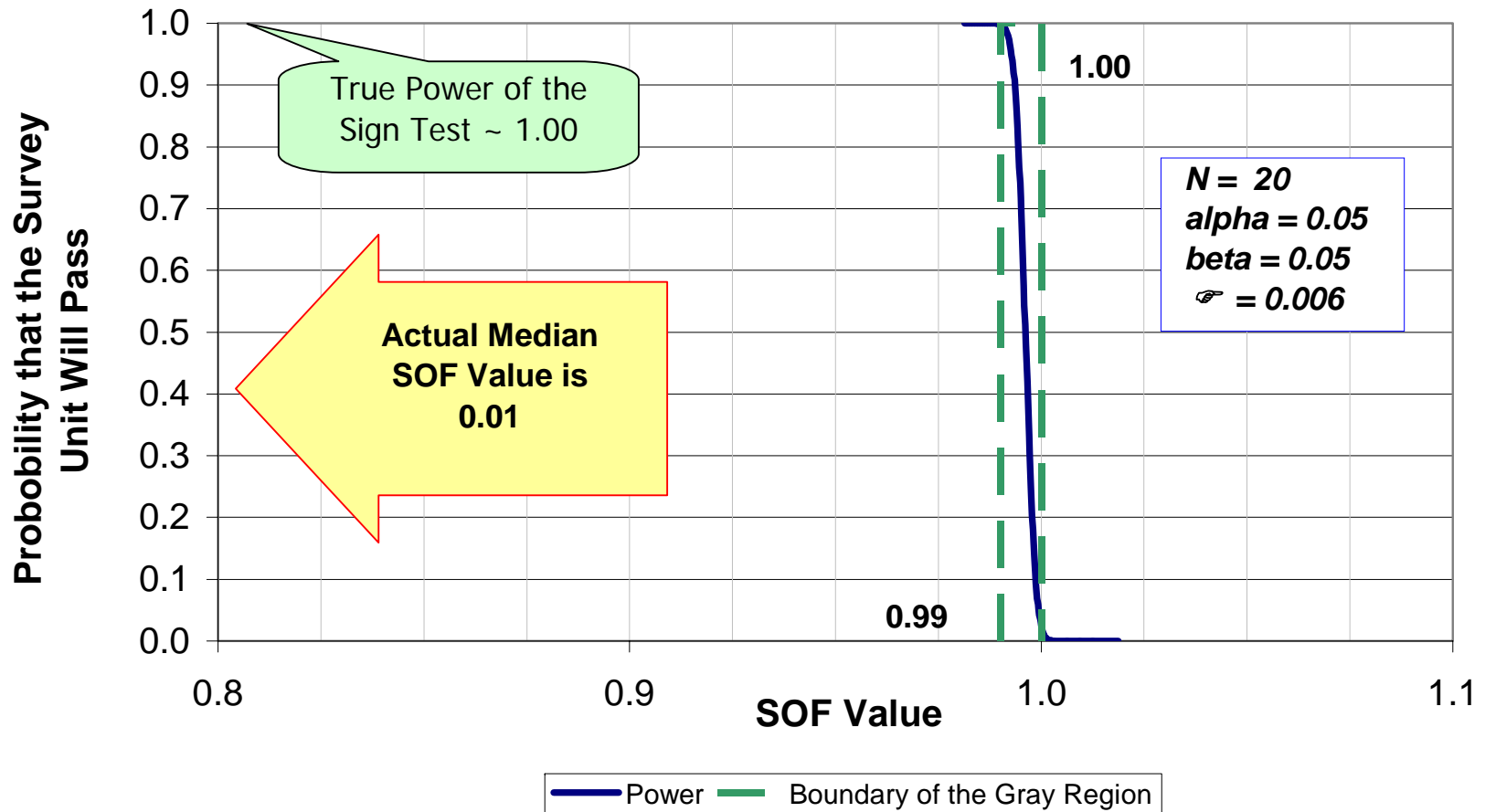

RADIOLOGICAL SURVEY MAP

Survey Unit NO: **CE-FSS-02-07** Surveyor Team (print names): **Ron Como, James Wilson, Jeff Tweeddale** Page **1** of **1**

| Location | Static Count | cpm |
|------------------|--------------|-----|
| SS-FSS-02-015-00 | 3000 | |
| 016-00 | 3080 | |
| 017-00 | 2701 | |
| 018-00 | 2984 | |
| 019-00 | 2604 | |
| 020-00 | 2794 | |
| 021-00 | 2566 | |
| 022-00 | 2333 | |
| 023-00 | 2284 | |
| 024-00 | 2901 | |
| 025-00 | 2772 | |
| 026-00 | 2654 | |
| 027-00 | 2813 | |
| 028-00 | 2881 | |
| 029-00 | 2400 | |
| 030-00 | 2233 | |
| 031-00 | 2619 | |
| 032-00 | 2834 | |
| 033-00 | 2619 | |
| 034-00 | 2716 | |

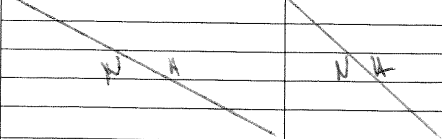

Comments

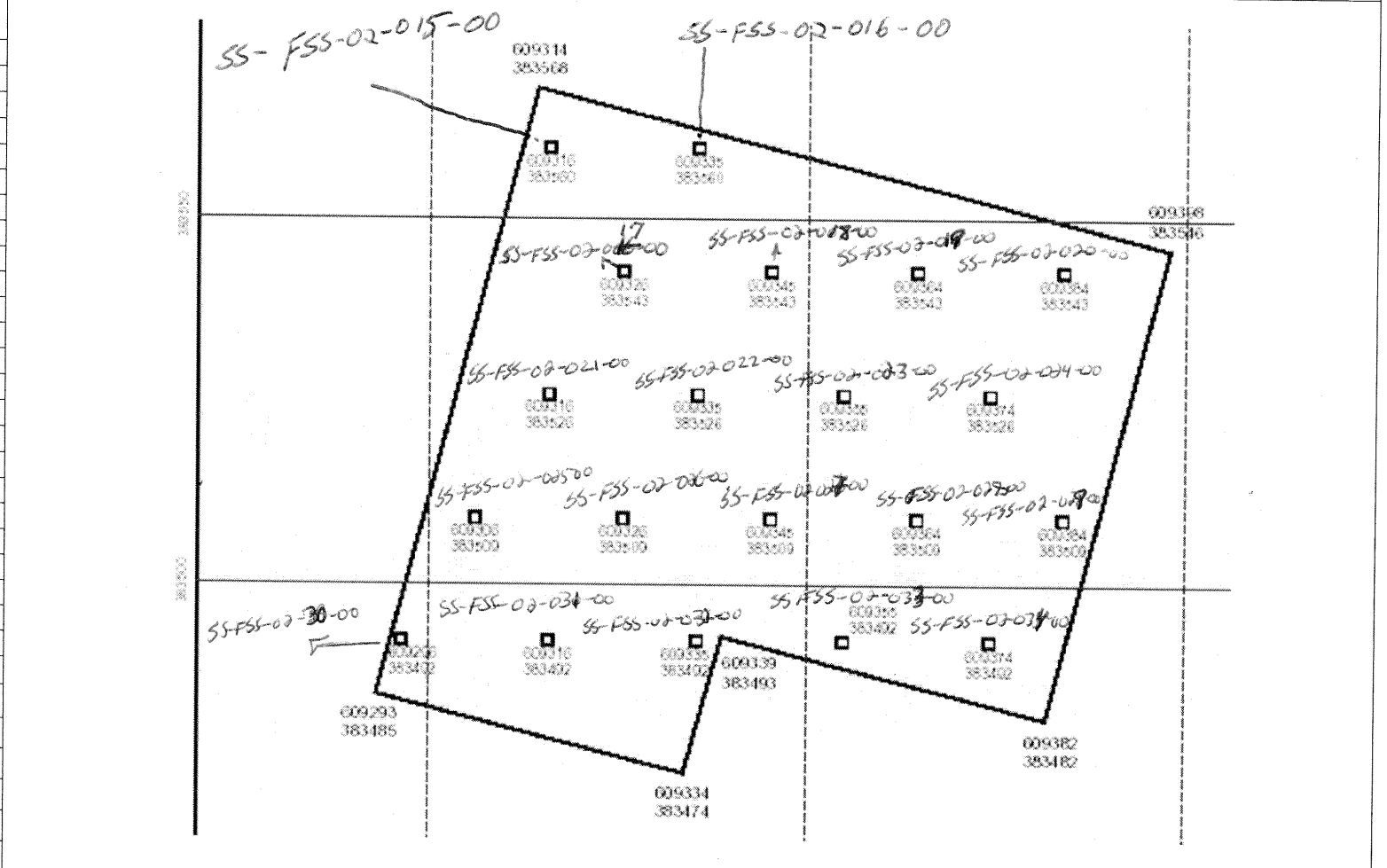

| | | | |
|---|------------------------------|---------------------------------|-----------------------|
| Instrument: L12350-1 | Ser. No: 175852 | Background (cpm): 240 | Key |
| Technician Signature & Date: Ron Como 1-17-05 | Technician Signature & Date: | | ≈ - Direct Scan |
| | | | Δ - Volumetric Sample |

RADIOLOGICAL SURVEY MAP

| | | | | | | |
|--|--------------|--|-------------------|-----------------------|-----------------|----|
| Survey Unit N0:CE-FSS-02-07 | | Surveyor Team (print names): <i>ALAN D SMITH</i> | | | Page | of |
| Location | Static Count | | | | | |
| △ W side 2A | 3.17kcpm | | | | | |
| △ E side 2A | 3.04kcpm | | | | | |
| | | | | | | |
| | | | | | | |
| | | | | | | |
| | | | | | | |
| | | | | | | |
| | | | | | | |
| | | | | | | |
| | | | | | | |
| | | | | | | |
| | | | | | | |
| | | | | | | |
| Comments | | | | | | |
| Walk-over Survey Area based on interface between building and adjacent areas - contamination on surfaces in building only found in areas 10' bgs | | | | | | |
| Instrument: | | Ser. No: | Background (cpm): | | Key | |
| <i>Ludlum 2221 W 44-10</i> | | <i>97833</i> | <i>2770</i> | | □ - Direct Scan | |
| Technician Signature & Date: | | Technician Signature & Date: | | △ - Volumetric Sample | | |
| <i>Alan D Smith 4-29-05</i> | | <i>Alan D Smith 4-29-05</i> | | | | |

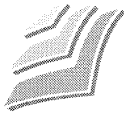

MACTEC, Inc.

| Project Info | | Laboratory Info | | INVOICE (if other than MACTEC contact) | |
|----------------|--------------------|-----------------|-------|--|-------|
| MACTEC Contact | Project No | Laboratory Name | Phone | Company Name | Phone |
| Project Title | Purchase Order No. | Lab Contact | Fax | Company Contact | Fax |
| Address | | Address | | Address | |
| City/State/Zip | | City/State/Zip | | City/State/Zip | |

Special Handling Instructions

Analysis

| Sample ID No. | Date Collected | Time | Type ¹ | Media | Volume | Description if necessary | | | | | | |
|----------------------|----------------|------|-------------------|-------|--------|--------------------------|--|--|--|--|--|--|
| SS-FSS-02-015-00 | 1/19/2005 | 800 | Rad | Soil | 1 Pint | | | | | | | |
| SS-FSS-02-016-00 | 1/19/2005 | 810 | Rad | Soil | 1 Pint | | | | | | | |
| SS-FSS-02-017-00 | 1/19/2005 | 820 | Rad | Soil | 1 Pint | | | | | | | |
| SS-FSS-02-018-00 | 1/19/2005 | 830 | Rad | Soil | 1 Pint | | | | | | | |
| SS-FSS-02-019-00 | 1/19/2005 | 840 | Rad | Soil | 1 Pint | | | | | | | |
| SS-FSS-02-020-00 | 1/19/2005 | 850 | Rad | Soil | 1 Pint | | | | | | | |
| SS-FSS-02-021-00 | 1/19/2005 | 900 | Rad | Soil | 1 Pint | | | | | | | |
| SS-FSS-02-022-00 | 1/19/2005 | 910 | Rad | Soil | 1 Pint | | | | | | | |
| SS-FSS-02-023-00 | 1/19/2005 | 920 | Rad | Soil | 1 Pint | | | | | | | |
| SS-FSS-02-024-00 | 1/19/2005 | 930 | Rad | Soil | 1 Pint | | | | | | | |
| SS-FSS-02-025-00 | 1/19/2005 | 940 | Rad | Soil | 1 Pint | | | | | | | |
| SS-FSS-02-025-00-Dup | 1/19/2005 | 940 | Rad | Soil | 1 Pint | | | | | | | |
| SS-FSS-02-026-00 | 1/19/2005 | 950 | Rad | Soil | 1 Pint | | | | | | | |
| SS-FSS-02-027-00 | 1/19/2005 | 1000 | Rad | Soil | 1 Pint | | | | | | | |
| SS-FSS-02-028-00 | 1/19/2005 | 1010 | Rad | Soil | 1 Pint | | | | | | | |

| | | | | |
|------------------|------------------------|------------------|--|------------------|
| Relinquished By: | <i>Jeff Tucceddule</i> | Received By: | | Type |
| Signed/Date/Time | <i>1/22/05/900</i> | Signed/Date/Time | | RS-Radioactive |
| Received By: | <i>STEVEN KAPETAN</i> | Relinquished By: | | Chem-Chemical |
| Signed/Date/Time | <i>1/22/05/0900</i> | Signed/Date/Time | | Mix-Rad+Chemical |
| Relinquished By: | | Received By: | | Chem-Chemical |
| Signed/Date/Time | | Signed/Date/Time | | Mix-Rad+Chemical |



MACTEC, Inc.

| Project Info | | Laboratory Info | | INVOICE (if other than MACTEC contact) | | | | | | | | |
|-------------------------------|-----------------------------|-----------------|-------------------|--|--------|--------------------------|-------|--|--|--|--|--|
| MACTEC Contact | Project No | Laboratory Name | Phone | Company Name | Phone | | | | | | | |
| Project Title | Purchase Order No. | Lab Contact | Fax | Company Contact | Fax | | | | | | | |
| Address | | Address | | Address | | | | | | | | |
| City/State/Zip | | City/State/Zip | | City/State/Zip | | | | | | | | |
| Special Handling Instructions | | | | | | | | | | | | |
| Analysis | | | | | | | | | | | | |
| Sample ID No. | Date Collected | Time | Type ¹ | Media | Volume | Description if necessary | | | | | | |
| SS-FSS-02-029-00 | 1/19/2005 | 1020 | Rad | Soil | 1 Pint | | | | | | | |
| SS-FSS-02-030-00 | 1/19/2005 | 800 | Rad | Soil | 1 Pint | 1030 | } HTD | | | | | |
| SS-FSS-02-031-00 | 1/19/2005 | 810 | Rad | Soil | 1 Pint | 1040 | | | | | | |
| SS-FSS-02-032-00 | 1/19/2005 | 820 | Rad | Soil | 1 Pint | 1050 | | | | | | |
| SS-FSS-02-033-00 | 1/19/2005 | 830 | Rad | Soil | 1 Pint | 1100 | | | | | | |
| SS-FSS-02-034-00 | 1/19/2005 | 840 | Rad | Soil | 1 Pint | 1110 | | | | | | |
| Relinquished By: | Jeff Tweeddale | | Received By: | | | ¹ Type | | | | | | |
| Signed/Date/Time | [Signature] 1/23/05 / 900 | | Signed/Date/Time | | | RS-Radioactive | | | | | | |
| Received By: | STEVEN KAPETAN | | Relinquished By: | | | Chem-Chemical | | | | | | |
| Signed/Date/Time | Steven Kapetan 1/22/05 0900 | | Signed/Date/Time | | | Mix-Rad+Chemical | | | | | | |
| Relinquished By: | | | Received By: | | | Chem-Chemical | | | | | | |
| Signed/Date/Time | | | Signed/Date/Time | | | Mix-Rad+Chemical | | | | | | |

 ***** CERTIFICATE OF ANALYSIS *****

Site Location: CE Windsor
 Sample ID: SS-FSS-02-015-00
 Sample Title: FSS 02 015 00
 Detector Name: 30%HPGE
 Nuclide Library Used: C:\GENIE2K\CAMFILES\FSS.NLB
 Sample Size: 8.130E+002 g
 Sample Taken On: 1/19/2005 8:00:00 AM
 Acquisition Started: 1/31/2005 8:45:21 AM
 Live Time: 900.0 seconds
 Real Time: 901.5 seconds
 Dead Time: 0.16 %
 Efficiency ID: srs035

| Nuclide Name | IDENTIFIED RADIONUCLIDES | | | UNIDENTIFIED RADIONUCLIDES | | |
|--------------|---------------------------|---------------------------|----------------------|----------------------------|---------------------------|-------------------|
| | Nuclide Activity (pCi/g) | Activity Uncert. (pCi/g) | Nuclide MDA (pCi/g) | Line Activity (pCi/g) | Line Act Uncert. (pCi/g) | Line MDA (pCi/g) |
| K-40 | 1.68E+001 | 2.66E+000 | 2.15E+000 | FOUND | | |
| MN-54 | NOT FOUND/DATA | for | 834.83 keV | 2.16E-002 | 6.47E-002 | 1.37E-001 |
| CO-57 | NOT FOUND/DATA | for | 122.06 keV | 5.01E-002 | 6.81E-002 | 1.23E-001 |
| CO-60 | NOT FOUND/DATA | for | 1173.24 keV | 1.48E-002 | 7.88E-002 | 1.64E-001 |
| ZN-65 | NOT FOUND/DATA | for | 1115.55 keV | -5.50E-002 | 2.07E-001 | 3.64E-001 |
| AG-110m | NOT FOUND/DATA | for | 657.76 keV | -2.21E-002 | 7.34E-002 | 1.30E-001 |
| SB-125 | NOT FOUND/DATA | for | 427.89 keV | -1.18E-001 | 1.75E-001 | 2.98E-001 |
| CS-134 | NOT FOUND/DATA | for | 604.70 keV | -7.97E-002 | 6.98E-002 | 1.07E-001 |
| CS-137 | NOT FOUND/DATA | for | 661.66 keV | 7.70E-002 | 8.80E-002 | 1.84E-001 |
| TL-208 | 1.85E-001 | 8.63E-002 | 1.71E-001 | FOUND | | |
| PB-212 | 6.58E-001 | 1.46E-001 | 2.73E-001 | FOUND | | |
| BI-214 | 7.37E-001 | 1.98E-001 | 2.39E-001 | FOUND | | |
| PB-214 | 6.31E-001 | 1.89E-001 | 3.91E-001 | FOUND | | |
| RA-226 | NOT FOUND/DATA | for | 186.10 keV | 2.24E+000 | 1.54E+000 | 3.10E+000 |
| AC-228 | NOT FOUND/DATA | for | 911.21 keV | 3.78E-001 | 3.89E-001 | 8.27E-001 |
| TH-230 | NOT FOUND/DATA | for | 67.67 keV | 3.03E+000 | 3.03E+001 | 5.56E+001 |
| PA-231 | NOT FOUND/DATA | for | 300.02 keV | -4.22E-001 | 2.48E+000 | 4.18E+000 |
| PA-234 | NOT FOUND/DATA | for | 131.20 keV | 5.33E-002 | 2.58E-001 | 4.48E-001 |
| PA-234M | NOT FOUND/DATA | for | 1001.03 keV | 5.42E+000 | 1.19E+001 | 2.59E+001 |
| TH-234 | NOT FOUND/DATA | for | 92.60 keV | 1.35E+000 | 1.21E+000 | 2.27E+000 |
| U-234 | NOT FOUND/DATA | for | 53.20 keV | -8.45E+001 | 2.15E+002 | 3.85E+002 |
| U-235 | NOT FOUND/DATA | for | 185.71 keV | 8.20E-002 | 9.40E-002 | 1.82E-001 |
| U-238 | NOT FOUND/DATA | for | 92.60 keV | 1.35E+000 | 1.21E+000 | 2.27E+000 |
| AM-241 | NOT FOUND/DATA | for | 59.54 keV | -1.91E-001 | 4.05E-001 | 7.15E-001 |

Uncertainty reported at 2.0 sigma

 ***** CERTIFICATE OF ANALYSIS *****

Site Location: CE Windsor
 Sample ID: SS-FSS-02-016-00
 Sample Title: FSS 02 016 00
 Detector Name: 30%HPGE
 Nuclide Library Used: C:\GENIE2K\CAMFILES\FSS.NLB
 Sample Size: 8.726E+002 g
 Sample Taken On: 1/19/2005 8:10:00 AM
 Acquisition Started: 1/31/2005 3:57:10 PM
 Live Time: 900.0 seconds
 Real Time: 901.4 seconds
 Dead Time: 0.15 %
 Efficiency ID: srs035

| Nuclide Name | IDENTIFIED RADIONUCLIDES | | | UNIDENTIFIED RADIONUCLIDES | | |
|--------------|---------------------------|---------------------------|----------------------|----------------------------|---------------------------|-------------------|
| | Nuclide Activity (pCi/g) | Activity Uncert. (pCi/g) | Nuclide MDA (pCi/g) | Line Activity (pCi/g) | Line Act Uncert. (pCi/g) | Line MDA (pCi/g) |
| K-40 | 1.76E+001 | 7.10E+000 | 1.45E+000 | FOUND | | |
| MN-54 | NOT FOUND/DATA | for | 834.83 keV | -1.90E-004 | 6.79E-002 | 1.33E-001 |
| CO-57 | NOT FOUND/DATA | for | 122.06 keV | 4.88E-003 | 6.43E-002 | 1.11E-001 |
| CO-60 | NOT FOUND/DATA | for | 1332.50 keV | -8.33E-003 | 8.57E-002 | 1.59E-001 |
| ZN-65 | NOT FOUND/DATA | for | 1115.55 keV | 4.47E-002 | 1.75E-001 | 3.51E-001 |
| AG-110m | NOT FOUND/DATA | for | 657.76 keV | -1.73E-002 | 7.70E-002 | 1.38E-001 |
| SB-125 | NOT FOUND/DATA | for | 427.89 keV | 2.57E-002 | 1.78E-001 | 3.35E-001 |
| CS-134 | NOT FOUND/DATA | for | 604.70 keV | -6.19E-002 | 6.98E-002 | 1.11E-001 |
| CS-137 | NOT FOUND/DATA | for | 661.66 keV | 4.66E-002 | 8.68E-002 | 1.75E-001 |
| TL-208 | 2.37E-001 | 3.52E-001 | 1.51E-001 | FOUND | | |
| PB-212 | NOT FOUND/DATA | for | 238.63 keV | 7.41E-001 | 2.02E-001 | 4.11E-001 |
| BI-214 | 8.85E-001 | 7.20E-001 | 3.12E-001 | FOUND | | |
| PB-214 | 8.09E-001 | 2.67E-001 | 3.02E-001 | FOUND | | |
| RA-226 | NOT FOUND/DATA | for | 186.10 keV | 8.30E-001 | 1.62E+000 | 3.01E+000 |
| AC-228 | NOT FOUND/DATA | for | 968.97 keV | 2.80E-001 | 4.61E-001 | 9.90E-001 |
| TH-230 | NOT FOUND/DATA | for | 67.67 keV | -1.82E+000 | 2.83E+001 | 5.13E+001 |
| PA-231 | NOT FOUND/DATA | for | 300.02 keV | 6.19E-001 | 2.32E+000 | 4.15E+000 |
| PA-234 | NOT FOUND/DATA | for | 131.20 keV | -1.29E-002 | 2.68E-001 | 4.51E-001 |
| PA-234M | NOT FOUND/DATA | for | 1001.03 keV | 1.98E-001 | 1.06E+001 | 2.08E+001 |
| TH-234 | NOT FOUND/DATA | for | 92.60 keV | 7.45E-001 | 1.22E+000 | 2.18E+000 |
| U-234 | NOT FOUND/DATA | for | 53.20 keV | 2.28E+002 | 2.50E+002 | 4.86E+002 |
| U-235 | NOT FOUND/DATA | for | 185.71 keV | 2.18E-003 | 1.01E-001 | 1.80E-001 |
| U-238 | NOT FOUND/DATA | for | 92.60 keV | 7.45E-001 | 1.22E+000 | 2.18E+000 |
| AM-241 | NOT FOUND/DATA | for | 59.54 keV | -2.43E-001 | 4.40E-001 | 7.69E-001 |

Uncertainty reported at 2.0 sigma

 ***** CERTIFICATE OF ANALYSIS *****

Site Location: CE Windsor
 Sample ID: SS-FSS-02-017-00
 Sample Title: FSS 02 017 00
 Detector Name: 30%HPGE
 Nuclide Library Used: C:\GENIE2K\CAMFILES\FSS.NLB
 Sample Size: 9.163E+002 g
 Sample Taken On: 1/19/2005 8:20:00 AM
 Acquisition Started: 1/31/2005 4:16:11 PM
 Live Time: 900.0 seconds
 Real Time: 901.4 seconds
 Dead Time: 0.15 %
 Efficiency ID: srs035

| Nuclide Name | IDENTIFIED RADIONUCLIDES | | | UNIDENTIFIED RADIONUCLIDES | | |
|--------------|--------------------------|--------------------------|---------------------|----------------------------|--------------------------|------------------|
| | Nuclide Activity (pCi/g) | Activity Uncert. (pCi/g) | Nuclide MDA (pCi/g) | Line Activity (pCi/g) | Line Act Uncert. (pCi/g) | Line MDA (pCi/g) |
| K-40 | 2.24E+001 | 7.46E+000 | 1.75E+000 | FOUND | | |
| MN-54 | NOT FOUND/DATA | for | 834.83 keV | -2.79E-002 | 6.52E-002 | 1.16E-001 |
| CO-57 | NOT FOUND/DATA | for | 122.06 keV | -3.21E-002 | 6.57E-002 | 1.04E-001 |
| CO-60 | NOT FOUND/DATA | for | 1173.24 keV | 4.52E-003 | 7.48E-002 | 1.31E-001 |
| ZN-65 | NOT FOUND/DATA | for | 1115.55 keV | 1.76E-003 | 1.77E-001 | 3.11E-001 |
| AG-110m | NOT FOUND/DATA | for | 657.76 keV | -6.23E-002 | 6.48E-002 | 9.76E-002 |
| SB-125 | NOT FOUND/DATA | for | 427.89 keV | 1.29E-001 | 1.66E-001 | 3.46E-001 |
| CS-134 | NOT FOUND/DATA | for | 604.70 keV | 4.42E-003 | 6.62E-002 | 1.25E-001 |
| CS-137 | NOT FOUND/DATA | for | 661.66 keV | 8.78E-002 | 7.96E-002 | 1.69E-001 |
| TL-208 | 3.50E-001 | 2.31E-001 | 1.23E-001 | FOUND | | |
| PB-212 | 8.46E-001 | 2.58E-001 | 2.69E-001 | FOUND | | |
| BI-214 | 7.13E-001 | 2.03E-001 | 3.21E-001 | FOUND | | |
| PB-214 | 6.69E-001 | 5.22E-001 | 3.56E-001 | FOUND | | |
| RA-226 | NOT FOUND/DATA | for | 186.10 keV | 1.75E+000 | 1.52E+000 | 2.94E+000 |
| AC-228 | NOT FOUND/DATA | for | 911.21 keV | 9.36E-001 | 3.71E-001 | 8.78E-001 |
| TH-230 | NOT FOUND/DATA | for | 67.67 keV | 2.64E+001 | 2.38E+001 | 4.84E+001 |
| PA-231 | NOT FOUND/DATA | for | 300.02 keV | 2.72E-001 | 2.23E+000 | 3.95E+000 |
| PA-234 | NOT FOUND/DATA | for | 98.44 keV | 3.26E-003 | 2.45E-001 | 4.19E-001 |
| PA-234M | NOT FOUND/DATA | for | 1001.03 keV | 1.10E+001 | 1.16E+001 | 2.65E+001 |
| TH-234 | NOT FOUND/DATA | for | 92.60 keV | 1.34E+000 | 1.16E+000 | 2.13E+000 |
| U-234 | NOT FOUND/DATA | for | 53.20 keV | 2.33E+001 | 2.16E+002 | 4.07E+002 |
| U-235 | NOT FOUND/DATA | for | 185.71 keV | 1.22E-001 | 9.33E-002 | 1.83E-001 |
| U-238 | NOT FOUND/DATA | for | 92.60 keV | 1.34E+000 | 1.16E+000 | 2.13E+000 |
| AM-241 | NOT FOUND/DATA | for | 59.54 keV | -5.28E-001 | 4.29E-001 | 6.34E-001 |

Uncertainty reported at 2.0 sigma

 ***** C E R T I F I C A T E O F A N A L Y S I S *****

Site Location: CE Windsor
 Sample ID: SS-FSS-02-018-00
 Sample Title: FSS 02 018 00
 Detector Name: 30%HPGE
 Nuclide Library Used: C:\GENIE2K\CAMFILES\FSS.NLB
 Sample Size: 1.046E+003 g
 Sample Taken On: 1/19/2005 8:30:00 AM
 Acquisition Started: 1/31/2005 4:35:15 PM
 Live Time: 900.0 seconds
 Real Time: 901.4 seconds
 Dead Time: 0.16 %
 Efficiency ID: srs035

| Nuclide Name | IDENTIFIED RADIONUCLIDES | | | UNIDENTIFIED RADIONUCLIDES | | |
|--------------|---------------------------|---------------------------|----------------------|----------------------------|---------------------------|-------------------|
| | Nuclide Activity (pCi/g) | Activity Uncert. (pCi/g) | Nuclide MDA (pCi/g) | Line Activity (pCi/g) | Line Act Uncert. (pCi/g) | Line MDA (pCi/g) |
| K-40 | 1.70E+001 | 6.34E+000 | 1.61E+000 | FOUND | | |
| MN-54 | NOT FOUND/DATA | for | 834.83 keV | 4.03E-002 | 5.86E-002 | 1.27E-001 |
| CO-57 | NOT FOUND/DATA | for | 122.06 keV | -3.67E-002 | 6.20E-002 | 9.91E-002 |
| CO-60 | NOT FOUND/DATA | for | 1332.50 keV | -1.39E-002 | 5.42E-002 | 1.09E-001 |
| ZN-65 | NOT FOUND/DATA | for | 1115.55 keV | -1.46E-002 | 1.32E-001 | 2.51E-001 |
| AG-110m | NOT FOUND/DATA | for | 657.76 keV | -7.44E-003 | 6.76E-002 | 1.21E-001 |
| SB-125 | NOT FOUND/DATA | for | 427.89 keV | 7.90E-002 | 1.51E-001 | 3.03E-001 |
| CS-134 | NOT FOUND/DATA | for | 604.70 keV | -3.77E-002 | 6.71E-002 | 1.14E-001 |
| CS-137 | NOT FOUND/DATA | for | 661.66 keV | 8.90E-002 | 7.37E-002 | 1.59E-001 |
| TL-208 | 1.95E-001 | 2.54E-001 | 1.35E-001 | FOUND | | |
| PB-212 | 7.79E-001 | 1.58E-001 | 2.60E-001 | FOUND | | |
| BI-214 | 7.67E-001 | 5.11E-001 | 2.59E-001 | FOUND | | |
| PB-214 | 9.28E-001 | 1.77E-001 | 3.03E-001 | FOUND | | |
| RA-226 | NOT FOUND/DATA | for | 186.10 keV | 9.57E-001 | 1.35E+000 | 2.54E+000 |
| AC-228 | NOT FOUND/DATA | for | 911.21 keV | 7.49E-001 | 3.33E-001 | 7.69E-001 |
| TH-230 | NOT FOUND/DATA | for | 67.67 keV | -2.93E+000 | 2.38E+001 | 4.28E+001 |
| PA-231 | NOT FOUND/DATA | for | 300.02 keV | 3.60E+000 | 2.55E+000 | 4.21E+000 |
| PA-234 | NOT FOUND/DATA | for | 98.44 keV | 1.39E-001 | 2.27E-001 | 4.01E-001 |
| PA-234M | NOT FOUND/DATA | for | 1001.03 keV | -5.29E-001 | 8.05E+000 | 1.63E+001 |
| TH-234 | NOT FOUND/DATA | for | 92.60 keV | 8.59E-001 | 1.09E+000 | 1.96E+000 |
| U-234 | NOT FOUND/DATA | for | 53.20 keV | -2.83E+001 | 1.81E+002 | 3.32E+002 |
| U-235 | NOT FOUND/DATA | for | 185.71 keV | 1.49E-001 | 8.21E-002 | 1.65E-001 |
| U-238 | NOT FOUND/DATA | for | 92.60 keV | 8.59E-001 | 1.09E+000 | 1.96E+000 |
| AM-241 | NOT FOUND/DATA | for | 59.54 keV | -4.14E-002 | 3.60E-001 | 6.58E-001 |

Uncertainty reported at 2.0 sigma

 C E R T I F I C A T E O F A N A L Y S I S

Site Location: CE Windsor
 Sample ID: SS-FSS-02-019-00
 Sample Title: FSS 02 019 00
 Detector Name: 30%HPGE
 Nuclide Library Used: C:\GENIE2K\CAMFILES\FSS.NLB
 Sample Size: 9.914E+002 g
 Sample Taken On: 1/19/2005 8:40:00 AM
 Acquisition Started: 2/1/2005 6:45:19 AM
 Live Time: 900.0 seconds
 Real Time: 901.4 seconds
 Dead Time: 0.15 %
 Efficiency ID: srs035

| Nuclide Name | IDENTIFIED RADIONUCLIDES | | | UNIDENTIFIED RADIONUCLIDES | | |
|--------------|--------------------------|--------------------------|---------------------|----------------------------|--------------------------|------------------|
| | Nuclide Activity (pCi/g) | Activity Uncert. (pCi/g) | Nuclide MDA (pCi/g) | Line Activity (pCi/g) | Line Act Uncert. (pCi/g) | Line MDA (pCi/g) |
| K-40 | 2.24E+001 | 6.88E+000 | 2.37E-001 | FOUND | | |
| MN-54 | NOT FOUND/DATA | for | 834.83 keV | 4.45E-003 | 5.90E-002 | 1.17E-001 |
| CO-57 | NOT FOUND/DATA | for | 122.06 keV | 5.94E-002 | 6.11E-002 | 1.11E-001 |
| CO-60 | NOT FOUND/DATA | for | 1332.50 keV | 2.21E-002 | 7.65E-002 | 1.53E-001 |
| ZN-65 | NOT FOUND/DATA | for | 1115.55 keV | -5.81E-002 | 1.65E-001 | 2.88E-001 |
| AG-110m | NOT FOUND/DATA | for | 657.76 keV | -6.33E-002 | 6.36E-002 | 9.04E-002 |
| SB-125 | NOT FOUND/DATA | for | 427.89 keV | -2.97E-002 | 1.53E-001 | 2.82E-001 |
| CS-134 | NOT FOUND/DATA | for | 604.70 keV | -2.74E-003 | 6.67E-002 | 1.23E-001 |
| CS-137 | NOT FOUND/DATA | for | 661.66 keV | 2.45E-002 | 7.54E-002 | 1.48E-001 |
| TL-208 | 3.35E-001 | 9.65E-002 | 1.58E-001 | FOUND | | |
| PB-212 | 1.11E+000 | 2.97E-001 | 3.22E-001 | FOUND | | |
| BI-214 | 8.21E-001 | 1.93E-001 | 2.98E-001 | FOUND | | |
| PB-214 | 8.30E-001 | 6.28E-001 | 2.91E-001 | FOUND | | |
| RA-226 | NOT FOUND/DATA | for | 186.10 keV | 2.67E-001 | 1.39E+000 | 2.54E+000 |
| AC-228 | NOT FOUND/DATA | for | 911.21 keV | 7.48E-001 | 3.70E-001 | 8.29E-001 |
| TH-230 | NOT FOUND/DATA | for | 67.67 keV | -3.47E+001 | 2.58E+001 | 3.97E+001 |
| PA-231 | NOT FOUND/DATA | for | 300.02 keV | -9.45E-001 | 2.27E+000 | 3.70E+000 |
| PA-234 | NOT FOUND/DATA | for | 131.20 keV | -2.56E-001 | 2.95E-001 | 3.89E-001 |
| PA-234M | NOT FOUND/DATA | for | 1001.03 keV | 1.98E+000 | 1.10E+001 | 2.21E+001 |
| TH-234 | NOT FOUND/DATA | for | 92.60 keV | 1.62E+000 | 1.16E+000 | 2.16E+000 |
| U-234 | NOT FOUND/DATA | for | 53.20 keV | -1.09E+001 | 2.17E+002 | 3.96E+002 |
| U-235 | NOT FOUND/DATA | for | 185.71 keV | 8.71E-002 | 8.28E-002 | 1.60E-001 |
| U-238 | NOT FOUND/DATA | for | 92.60 keV | 1.62E+000 | 1.16E+000 | 2.16E+000 |
| AM-241 | NOT FOUND/DATA | for | 59.54 keV | 1.87E-001 | 4.12E-001 | 7.87E-001 |

Uncertainty reported at 2.0 sigma

 C E R T I F I C A T E O F A N A L Y S I S

Site Location: CE Windsor
 Sample ID: SS-FSS-02-020-00
 Sample Title: FSS 02 020 00
 Detector Name: 30%HPGE
 Nuclide Library Used: C:\GENIE2K\CAMFILES\FSS.NLB
 Sample Size: 9.737E+002 g
 Sample Taken On: 1/19/2005 8:50:00 AM
 Acquisition Started: 2/1/2005 7:03:55 AM
 Live Time: 900.0 seconds
 Real Time: 901.4 seconds
 Dead Time: 0.16 %
 Efficiency ID: srs035

| Nuclide Name | IDENTIFIED RADIONUCLIDES | | | UNIDENTIFIED RADIONUCLIDES | | |
|--------------|---------------------------|---------------------------|----------------------|----------------------------|---------------------------|-------------------|
| | Nuclide Activity (pCi/g) | Activity Uncert. (pCi/g) | Nuclide MDA (pCi/g) | Line Activity (pCi/g) | Line Act Uncert. (pCi/g) | Line MDA (pCi/g) |
| K-40 | 1.80E+001 | 2.51E+000 | 1.91E+000 | FOUND | | |
| MN-54 | NOT FOUND/DATA | for | 834.83 keV | -1.79E-002 | 6.23E-002 | 1.10E-001 |
| CO-57 | NOT FOUND/DATA | for | 122.06 keV | 4.59E-002 | 6.58E-002 | 1.16E-001 |
| CO-60 | NOT FOUND/DATA | for | 1332.50 keV | 2.07E-002 | 6.42E-002 | 1.42E-001 |
| ZN-65 | NOT FOUND/DATA | for | 1115.55 keV | -1.38E-001 | 1.58E-001 | 2.43E-001 |
| AG-110m | NOT FOUND/DATA | for | 657.76 keV | -3.82E-002 | 6.55E-002 | 1.13E-001 |
| SB-125 | NOT FOUND/DATA | for | 427.89 keV | 6.30E-002 | 1.65E-001 | 3.20E-001 |
| CS-134 | NOT FOUND/DATA | for | 604.70 keV | -7.30E-002 | 7.57E-002 | 1.09E-001 |
| CS-137 | NOT FOUND/DATA | for | 661.66 keV | 9.18E-002 | 8.24E-002 | 1.74E-001 |
| TL-208 | 3.28E-001 | 9.91E-002 | 1.68E-001 | FOUND | | |
| PB-212 | 1.28E+000 | 2.98E-001 | 3.35E-001 | FOUND | | |
| BI-214 | 9.09E-001 | 6.68E-001 | 2.88E-001 | FOUND | | |
| PB-214 | 6.72E-001 | 1.83E-001 | 2.96E-001 | FOUND | | |
| RA-226 | NOT FOUND/DATA | for | 186.10 keV | 2.32E+000 | 1.39E+000 | 2.78E+000 |
| AC-228 | 9.53E-001 | 7.20E-001 | 5.27E-001 | FOUND | | |
| TH-230 | NOT FOUND/DATA | for | 67.67 keV | -2.75E+000 | 2.45E+001 | 4.47E+001 |
| PA-231 | NOT FOUND/DATA | for | 300.02 keV | -3.32E-001 | 2.19E+000 | 3.76E+000 |
| PA-234 | NOT FOUND/DATA | for | 98.44 keV | -7.71E-002 | 2.34E-001 | 3.85E-001 |
| PA-234M | NOT FOUND/DATA | for | 1001.03 keV | 4.19E+000 | 1.00E+001 | 2.16E+001 |
| TH-234 | NOT FOUND/DATA | for | 92.60 keV | 8.46E-001 | 1.19E+000 | 2.11E+000 |
| U-234 | NOT FOUND/DATA | for | 53.20 keV | -5.19E+001 | 2.10E+002 | 3.78E+002 |
| U-235 | NOT FOUND/DATA | for | 185.71 keV | 1.19E-001 | 8.45E-002 | 1.67E-001 |
| U-238 | NOT FOUND/DATA | for | 92.60 keV | 8.46E-001 | 1.19E+000 | 2.11E+000 |
| AM-241 | NOT FOUND/DATA | for | 59.54 keV | 3.83E-002 | 4.02E-001 | 7.52E-001 |

Uncertainty reported at 2.0 sigma

 C E R T I F I C A T E O F A N A L Y S I S

Site Location: CE Windsor
 Sample ID: SS-FSS-02-021-00
 Sample Title: FSS-02-021-00
 Detector Name: 30%HPGE
 Nuclide Library Used: C:\GENIE2K\CAMFILES\FSS.NLB
 Sample Size: 1.024E+003 g
 Sample Taken On: 1/19/2005 9:00:00 AM
 Acquisition Started: 3/10/2005 9:51:40 AM
 Live Time: 1200.0 seconds
 Real Time: 1202.0 seconds
 Dead Time: 0.17 %
 Efficiency ID: srs035

| Nuclide Name | IDENTIFIED RADIONUCLIDES | | | UNIDENTIFIED RADIONUCLIDES | | |
|--------------|--------------------------|--------------------------|---------------------|----------------------------|--------------------------|------------------|
| | Nuclide Activity (pCi/g) | Activity Uncert. (pCi/g) | Nuclide MDA (pCi/g) | Line Activity (pCi/g) | Line Act Uncert. (pCi/g) | Line MDA (pCi/g) |
| K-40 | 1.87E+001 | 5.47E+000 | 1.85E+000 | FOUND | | |
| MN-54 | NOT FOUND/DATA | for | 834.83 keV | 2.03E-002 | 5.51E-002 | 1.11E-001 |
| CO-57 | NOT FOUND/DATA | for | 122.06 keV | -7.47E-003 | 5.77E-002 | 9.49E-002 |
| CO-60 | NOT FOUND/DATA | for | 1332.50 keV | 5.40E-002 | 5.89E-002 | 1.30E-001 |
| ZN-65 | NOT FOUND/DATA | for | 1115.55 keV | -9.88E-002 | 1.49E-001 | 2.41E-001 |
| AG-110m | NOT FOUND/DATA | for | 657.76 keV | -1.41E-002 | 6.04E-002 | 1.10E-001 |
| SB-125 | NOT FOUND/DATA | for | 427.89 keV | -4.60E-002 | 1.53E-001 | 2.71E-001 |
| CS-134 | NOT FOUND/DATA | for | 604.70 keV | -5.40E-003 | 5.48E-002 | 9.63E-002 |
| CS-137 | NOT FOUND/DATA | for | 661.66 keV | 1.67E-002 | 6.63E-002 | 1.22E-001 |
| TL-208 | 3.19E-001 | 2.72E-001 | 1.34E-001 | FOUND | | |
| PB-212 | 9.43E-001 | 2.33E-001 | 2.44E-001 | FOUND | | |
| BI-214 | 6.11E-001 | 3.95E-001 | 2.50E-001 | FOUND | | |
| PB-214 | 6.67E-001 | 1.20E-001 | 2.24E-001 | FOUND | | |
| RA-226 | NOT FOUND/DATA | for | 186.10 keV | 1.05E+000 | 1.25E+000 | 2.30E+000 |
| AC-228 | 1.18E+000 | 8.10E-001 | 3.90E-001 | FOUND | | |
| TH-230 | NOT FOUND/DATA | for | 67.67 keV | -1.20E+001 | 2.11E+001 | 3.60E+001 |
| PA-231 | NOT FOUND/DATA | for | 300.02 keV | 1.14E+000 | 2.01E+000 | 3.52E+000 |
| PA-234 | NOT FOUND/DATA | for | 883.24 keV | -3.18E-001 | 4.31E-001 | 4.15E-001 |
| PA-234M | NOT FOUND/DATA | for | 1001.03 keV | -1.05E+001 | 1.07E+001 | 1.66E+001 |
| TH-234 | NOT FOUND/DATA | for | 92.60 keV | 9.33E-001 | 1.02E+000 | 1.81E+000 |
| U-234 | NOT FOUND/DATA | for | 53.20 keV | -9.04E+001 | 1.72E+002 | 2.97E+002 |
| U-235 | NOT FOUND/DATA | for | 185.71 keV | 8.03E-002 | 7.57E-002 | 1.42E-001 |
| U-238 | NOT FOUND/DATA | for | 92.60 keV | 9.33E-001 | 1.02E+000 | 1.81E+000 |
| AM-241 | NOT FOUND/DATA | for | 59.54 keV | 3.44E-002 | 3.63E-001 | 6.56E-001 |

Uncertainty reported at 2.0 sigma

 ***** CERTIFICATE OF ANALYSIS *****

Site Location: CE Windsor
 Sample ID: SS-FSS-02-022-00
 Sample Title: FSS-02-022-00
 Detector Name: 30%HPGE
 Nuclide Library Used: C:\GENIE2K\CAMFILES\FSS.NLB
 Sample Size: 1.034E+003 g
 Sample Taken On: 1/19/2005 9:10:00 AM
 Acquisition Started: 3/10/2005 10:15:02 AM
 Live Time: 1200.0 seconds
 Real Time: 1201.9 seconds
 Dead Time: 0.15 %
 Efficiency ID: srs035

| Nuclide Name | IDENTIFIED RADIONUCLIDES | | | UNIDENTIFIED RADIONUCLIDES | | |
|--------------|--------------------------|--------------------------|---------------------|----------------------------|--------------------------|------------------|
| | Nuclide Activity (pCi/g) | Activity Uncert. (pCi/g) | Nuclide MDA (pCi/g) | Line Activity (pCi/g) | Line Act Uncert. (pCi/g) | Line MDA (pCi/g) |
| K-40 | 1.84E+001 | 5.61E+000 | 1.33E+000 | FOUND | | |
| MN-54 | NOT FOUND/DATA | for | 834.83 keV | 4.93E-003 | 4.97E-002 | 9.83E-002 |
| CO-57 | NOT FOUND/DATA | for | 122.06 keV | 1.06E-002 | 5.53E-002 | 9.40E-002 |
| CO-60 | NOT FOUND/DATA | for | 1332.50 keV | 7.77E-004 | 5.83E-002 | 1.16E-001 |
| ZN-65 | NOT FOUND/DATA | for | 1115.55 keV | -1.35E-001 | 1.42E-001 | 2.21E-001 |
| AG-110m | NOT FOUND/DATA | for | 657.76 keV | -2.90E-002 | 6.73E-002 | 1.11E-001 |
| SB-125 | NOT FOUND/DATA | for | 427.89 keV | 2.38E-001 | 1.42E-001 | 2.97E-001 |
| CS-134 | NOT FOUND/DATA | for | 604.70 keV | -8.87E-003 | 4.61E-002 | 8.19E-002 |
| CS-137 | NOT FOUND/DATA | for | 661.66 keV | 9.95E-002 | 6.67E-002 | 1.42E-001 |
| TL-208 | 2.63E-001 | 7.18E-002 | 1.05E-001 | FOUND | | |
| PB-212 | 8.24E-001 | 1.26E-001 | 2.39E-001 | FOUND | | |
| BI-214 | 7.88E-001 | 1.67E-001 | 2.56E-001 | FOUND | | |
| PB-214 | 6.83E-001 | 1.55E-001 | 2.45E-001 | FOUND | | |
| RA-226 | NOT FOUND/DATA | for | 186.10 keV | 8.11E-001 | 1.12E+000 | 2.09E+000 |
| AC-228 | 9.36E-001 | 3.17E-001 | 3.66E-001 | FOUND | | |
| TH-230 | NOT FOUND/DATA | for | 67.67 keV | -1.03E+001 | 2.06E+001 | 3.57E+001 |
| PA-231 | NOT FOUND/DATA | for | 300.02 keV | 1.58E+000 | 1.85E+000 | 3.24E+000 |
| PA-234 | NOT FOUND/DATA | for | 131.20 keV | 4.50E-002 | 2.09E-001 | 3.51E-001 |
| PA-234M | NOT FOUND/DATA | for | 1001.03 keV | 5.47E-001 | 9.49E+000 | 1.82E+001 |
| TH-234 | NOT FOUND/DATA | for | 92.60 keV | 1.37E-001 | 9.57E-001 | 1.62E+000 |
| U-234 | NOT FOUND/DATA | for | 53.20 keV | 7.91E+000 | 1.81E+002 | 3.20E+002 |
| U-235 | NOT FOUND/DATA | for | 185.71 keV | 3.91E-002 | 6.99E-002 | 1.29E-001 |
| U-238 | NOT FOUND/DATA | for | 92.60 keV | 1.37E-001 | 9.57E-001 | 1.62E+000 |
| AM-241 | NOT FOUND/DATA | for | 59.54 keV | 1.12E-001 | 3.62E-001 | 6.69E-001 |

Uncertainty reported at 2.0 sigma

 ***** CERTIFICATE OF ANALYSIS *****

Site Location: CE Windsor
 Sample ID: SS-FSS-02-023-00
 Sample Title: FSS-02-023-00
 Detector Name: 30%HPGE
 Nuclide Library Used: C:\GENIE2K\CAMFILES\FSS.NLB
 Sample Size: 9.476E+002 g
 Sample Taken On: 1/19/2005 9:20:00 AM
 Acquisition Started: 3/10/2005 11:03:24 AM
 Live Time: 1200.0 seconds
 Real Time: 1201.9 seconds
 Dead Time: 0.16 %
 Efficiency ID: srs035

| Nuclide Name | IDENTIFIED RADIONUCLIDES | | | UNIDENTIFIED RADIONUCLIDES | | |
|--------------|--------------------------|--------------------------|---------------------|----------------------------|--------------------------|------------------|
| | Nuclide Activity (pCi/g) | Activity Uncert. (pCi/g) | Nuclide MDA (pCi/g) | Line Activity (pCi/g) | Line Act Uncert. (pCi/g) | Line MDA (pCi/g) |
| K-40 | 1.68E+001 | 2.20E+000 | 1.55E+000 | FOUND | | |
| MN-54 | NOT FOUND/DATA | for | 834.83 keV | 3.07E-002 | 5.66E-002 | 1.17E-001 |
| CO-57 | NOT FOUND/DATA | for | 122.06 keV | -3.22E-002 | 6.06E-002 | 9.77E-002 |
| CO-60 | NOT FOUND/DATA | for | 1332.50 keV | -3.14E-002 | 5.70E-002 | 9.87E-002 |
| ZN-65 | NOT FOUND/DATA | for | 1115.55 keV | -1.56E-001 | 1.55E-001 | 2.08E-001 |
| AG-110m | NOT FOUND/DATA | for | 657.76 keV | -5.99E-002 | 7.05E-002 | 1.03E-001 |
| SB-125 | NOT FOUND/DATA | for | 427.89 keV | 1.19E-001 | 1.53E-001 | 3.01E-001 |
| CS-134 | NOT FOUND/DATA | for | 604.70 keV | -3.22E-002 | 5.63E-002 | 9.39E-002 |
| CS-137 | NOT FOUND/DATA | for | 661.66 keV | 5.31E-002 | 6.33E-002 | 1.30E-001 |
| TL-208 | 3.34E-001 | 8.23E-002 | 1.49E-001 | FOUND | | |
| PB-212 | 9.94E-001 | 4.40E-001 | 2.54E-001 | FOUND | | |
| BI-214 | 7.66E-001 | 1.74E-001 | 2.85E-001 | FOUND | | |
| PB-214 | 7.23E-001 | 1.58E-001 | 2.31E-001 | FOUND | | |
| RA-226 | NOT FOUND/DATA | for | 186.10 keV | 2.50E+000 | 1.31E+000 | 2.58E+000 |
| AC-228 | 9.63E-001 | 2.06E-001 | 4.47E-001 | FOUND | | |
| TH-230 | NOT FOUND/DATA | for | 67.67 keV | 1.07E+001 | 2.37E+001 | 4.40E+001 |
| PA-231 | NOT FOUND/DATA | for | 300.02 keV | -4.98E-003 | 1.77E+000 | 3.07E+000 |
| PA-234 | NOT FOUND/DATA | for | 98.44 keV | 2.46E-002 | 2.13E-001 | 3.63E-001 |
| PA-234M | NOT FOUND/DATA | for | 1001.03 keV | 1.35E+001 | 1.17E+001 | 2.53E+001 |
| TH-234 | NOT FOUND/DATA | for | 92.60 keV | 9.92E-001 | 1.07E+000 | 1.90E+000 |
| U-234 | NOT FOUND/DATA | for | 53.20 keV | -1.34E+002 | 1.91E+002 | 3.21E+002 |
| U-235 | NOT FOUND/DATA | for | 185.71 keV | 9.32E-002 | 7.98E-002 | 1.52E-001 |
| U-238 | NOT FOUND/DATA | for | 92.60 keV | 9.92E-001 | 1.07E+000 | 1.90E+000 |
| AM-241 | NOT FOUND/DATA | for | 59.54 keV | 9.92E-002 | 3.72E-001 | 6.88E-001 |

Uncertainty reported at 2.0 sigma

 C E R T I F I C A T E O F A N A L Y S I S *****

Site Location: CE Windsor
 Sample ID: SS-FSS-02-024-00
 Sample Title: FSS 02 024 00
 Detector Name: 30%HPGE
 Nuclide Library Used: C:\GENIE2K\CAMFILES\FSS.NLB
 Sample Size: 8.409E+002 g
 Sample Taken On: 1/19/2005 9:30:00 AM
 Acquisition Started: 2/1/2005 8:31:22 AM
 Live Time: 900.0 seconds
 Real Time: 901.5 seconds
 Dead Time: 0.16 %
 Efficiency ID: srs035

| Nuclide Name | IDENTIFIED RADIONUCLIDES | | | UNIDENTIFIED RADIONUCLIDES | | |
|--------------|--------------------------------|--------------------------|---------------------|----------------------------|--------------------------|------------------|
| | Nuclide Activity (pCi/g) | Activity Uncert. (pCi/g) | Nuclide MDA (pCi/g) | Line Activity (pCi/g) | Line Act Uncert. (pCi/g) | Line MDA (pCi/g) |
| K-40 | 2.47E+001 | 7.36E+000 | 9.79E-001 | FOUND | | |
| MN-54 | NOT FOUND/DATA for 834.83 keV | | | -4.17E-003 | 7.52E-002 | 1.43E-001 |
| CO-57 | NOT FOUND/DATA for 122.06 keV | | | 1.23E-002 | 7.11E-002 | 1.21E-001 |
| CO-60 | NOT FOUND/DATA for 1332.50 keV | | | 1.64E-002 | 7.69E-002 | 1.65E-001 |
| ZN-65 | NOT FOUND/DATA for 1115.55 keV | | | -1.01E-001 | 1.81E-001 | 3.12E-001 |
| AG-110m | NOT FOUND/DATA for 884.68 keV | | | -3.01E-002 | 8.09E-002 | 1.45E-001 |
| SB-125 | NOT FOUND/DATA for 427.89 keV | | | 6.98E-002 | 1.83E-001 | 3.63E-001 |
| CS-134 | NOT FOUND/DATA for 604.70 keV | | | -1.46E-002 | 7.44E-002 | 1.36E-001 |
| CS-137 | NOT FOUND/DATA for 661.66 keV | | | 3.53E-002 | 8.01E-002 | 1.62E-001 |
| TL-208 | 3.96E-001 | 3.07E-001 | 1.65E-001 | FOUND | | |
| PB-212 | 1.29E+000 | 3.37E-001 | 3.63E-001 | FOUND | | |
| BI-214 | 8.72E-001 | 7.12E+000 | 3.41E-001 | FOUND | | |
| PB-214 | 1.00E+000 | 2.79E-001 | 3.59E-001 | FOUND | | |
| RA-226 | NOT FOUND/DATA for 186.10 keV | | | 1.92E+000 | 1.65E+000 | 3.20E+000 |
| AC-228 | 1.07E+000 | 4.64E-001 | 6.02E-001 | FOUND | | |
| TH-230 | NOT FOUND/DATA for 67.67 keV | | | -2.25E+000 | 3.09E+001 | 5.52E+001 |
| PA-231 | NOT FOUND/DATA for 300.02 keV | | | 2.23E+000 | 2.86E+000 | 5.06E+000 |
| PA-234 | NOT FOUND/DATA for 131.20 keV | | | 8.18E-002 | 2.65E-001 | 4.55E-001 |
| PA-234M | NOT FOUND/DATA for 1001.03 keV | | | -4.25E+000 | 1.47E+001 | 2.70E+001 |
| TH-234 | NOT FOUND/DATA for 92.60 keV | | | 1.53E+000 | 1.31E+000 | 2.42E+000 |
| U-234 | NOT FOUND/DATA for 53.20 keV | | | 1.08E+002 | 2.57E+002 | 4.88E+002 |
| U-235 | NOT FOUND/DATA for 185.71 keV | | | 1.57E-001 | 9.85E-002 | 1.97E-001 |
| U-238 | NOT FOUND/DATA for 92.60 keV | | | 1.53E+000 | 1.31E+000 | 2.42E+000 |
| AM-241 | NOT FOUND/DATA for 59.54 keV | | | 1.20E-001 | 4.91E-001 | 9.19E-001 |

Uncertainty reported at 2.0 sigma

 ***** CERTIFICATE OF ANALYSIS *****

Site Location: CE Windsor
 Sample ID: SS-FSS-02-025-00
 Sample Title: FSS 02 025 00
 Detector Name: 30%HPGE
 Nuclide Library Used: C:\GENIE2K\CAMFILES\FSS.NLB
 Sample Size: 1.086E+003 g
 Sample Taken On: 1/19/2005 9:40:00 AM
 Acquisition Started: 2/1/2005 8:50:49 AM
 Live Time: 900.0 seconds
 Real Time: 901.5 seconds
 Dead Time: 0.17 %
 Efficiency ID: srs035

| Nuclide Name | IDENTIFIED RADIONUCLIDES | | | UNIDENTIFIED RADIONUCLIDES | | |
|--------------|--------------------------|--------------------------|---------------------|----------------------------|--------------------------|------------------|
| | Nuclide Activity (pCi/g) | Activity Uncert. (pCi/g) | Nuclide MDA (pCi/g) | Line Activity (pCi/g) | Line Act Uncert. (pCi/g) | Line MDA (pCi/g) |
| K-40 | 1.74E+001 | 6.50E+000 | 1.33E+000 | FOUND | | |
| MN-54 | NOT FOUND/DATA | for | 834.83 keV | -6.93E-003 | 5.08E-002 | 9.83E-002 |
| CO-57 | NOT FOUND/DATA | for | 122.06 keV | -8.23E-003 | 5.52E-002 | 9.20E-002 |
| CO-60 | NOT FOUND/DATA | for | 1332.50 keV | 3.77E-002 | 4.87E-002 | 1.21E-001 |
| ZN-65 | NOT FOUND/DATA | for | 1115.55 keV | -5.92E-002 | 1.47E-001 | 2.63E-001 |
| AG-110m | NOT FOUND/DATA | for | 657.76 keV | -1.55E-002 | 5.34E-002 | 9.79E-002 |
| SB-125 | NOT FOUND/DATA | for | 427.89 keV | -5.24E-002 | 1.53E-001 | 2.69E-001 |
| CS-134 | NOT FOUND/DATA | for | 604.70 keV | -4.42E-002 | 4.22E-002 | 6.47E-002 |
| CS-137 | NOT FOUND/DATA | for | 661.66 keV | 3.02E-003 | 6.74E-002 | 1.23E-001 |
| TL-208 | 2.34E-001 | 7.81E-002 | 1.39E-001 | FOUND | | |
| PB-212 | 7.17E-001 | 2.35E-001 | 2.77E-001 | FOUND | | |
| BI-214 | 9.78E-001 | 3.51E-001 | 1.94E-001 | FOUND | | |
| PB-214 | 7.69E-001 | 4.41E-001 | 2.71E-001 | FOUND | | |
| RA-226 | NOT FOUND/DATA | for | 186.10 keV | 1.74E+000 | 1.36E+000 | 2.63E+000 |
| AC-228 | 7.28E-001 | 2.30E-001 | 4.43E-001 | FOUND | | |
| TH-230 | NOT FOUND/DATA | for | 67.67 keV | 1.74E+001 | 1.98E+001 | 3.92E+001 |
| PA-231 | NOT FOUND/DATA | for | 300.02 keV | -3.79E-001 | 2.05E+000 | 3.45E+000 |
| PA-234 | NOT FOUND/DATA | for | 98.44 keV | -2.75E-002 | 2.13E-001 | 3.59E-001 |
| PA-234M | NOT FOUND/DATA | for | 1001.03 keV | 1.72E+000 | 1.00E+001 | 2.02E+001 |
| TH-234 | NOT FOUND/DATA | for | 92.60 keV | 6.39E-001 | 9.47E-001 | 1.71E+000 |
| U-234 | NOT FOUND/DATA | for | 53.20 keV | 1.55E+002 | 1.81E+002 | 3.61E+002 |
| U-235 | NOT FOUND/DATA | for | 185.71 keV | 7.72E-002 | 8.35E-002 | 1.57E-001 |
| U-238 | NOT FOUND/DATA | for | 92.60 keV | 6.39E-001 | 9.47E-001 | 1.71E+000 |
| AM-241 | NOT FOUND/DATA | for | 59.54 keV | -5.77E-002 | 3.42E-001 | 6.26E-001 |

Uncertainty reported at 2.0 sigma

 ***** CERTIFICATE OF ANALYSIS *****

Site Location: CE Windsor
 Sample ID: SS-FSS-02-025DUP
 Sample Title: FSS 02 025 00 DUP
 Detector Name: 30%HPGE
 Nuclide Library Used: C:\GENIE2K\CAMFILES\FSS.NLB
 Sample Size: 8.497E+002 g
 Sample Taken On: 1/19/2005 9:40:00 AM
 Acquisition Started: 2/1/2005 3:51:05 PM
 Live Time: 900.0 seconds
 Real Time: 901.5 seconds
 Dead Time: 0.16 %
 Efficiency ID: srs035

| Nuclide Name | IDENTIFIED RADIONUCLIDES | | | UNIDENTIFIED RADIONUCLIDES | | |
|--------------|--------------------------|--------------------------|---------------------|----------------------------|--------------------------|------------------|
| | Nuclide Activity (pCi/g) | Activity Uncert. (pCi/g) | Nuclide MDA (pCi/g) | Line Activity (pCi/g) | Line Act Uncert. (pCi/g) | Line MDA (pCi/g) |
| K-40 | 1.99E+001 | 7.40E+000 | 1.36E+000 | FOUND | | |
| MN-54 | NOT FOUND/DATA | for | 834.83 keV | 8.03E-002 | 7.82E-002 | 1.73E-001 |
| CO-57 | NOT FOUND/DATA | for | 122.06 keV | 3.56E-002 | 6.40E-002 | 1.12E-001 |
| CO-60 | NOT FOUND/DATA | for | 1173.24 keV | 2.46E-002 | 6.60E-002 | 1.41E-001 |
| ZN-65 | NOT FOUND/DATA | for | 1115.55 keV | -1.83E-001 | 1.78E-001 | 2.79E-001 |
| AG-110m | NOT FOUND/DATA | for | 884.68 keV | -1.01E-001 | 8.96E-002 | 1.18E-001 |
| SB-125 | NOT FOUND/DATA | for | 427.89 keV | 4.58E-003 | 1.62E-001 | 3.12E-001 |
| CS-134 | NOT FOUND/DATA | for | 604.70 keV | -4.65E-002 | 7.96E-002 | 1.25E-001 |
| CS-137 | NOT FOUND/DATA | for | 661.66 keV | 3.81E-002 | 9.80E-002 | 1.86E-001 |
| TL-208 | 2.79E-001 | 9.59E-002 | 1.67E-001 | FOUND | | |
| PB-212 | 1.02E+000 | 4.94E-001 | 3.51E-001 | FOUND | | |
| BI-214 | 7.58E-001 | 7.33E-001 | 3.22E-001 | FOUND | | |
| PB-214 | 7.06E-001 | 1.61E-001 | 3.83E-001 | FOUND | | |
| RA-226 | NOT FOUND/DATA | for | 186.10 keV | 1.25E+000 | 1.60E+000 | 3.04E+000 |
| AC-228 | 6.83E-001 | 2.49E-001 | 4.49E-001 | FOUND | | |
| TH-230 | NOT FOUND/DATA | for | 67.67 keV | 1.41E+001 | 2.93E+001 | 5.56E+001 |
| PA-231 | NOT FOUND/DATA | for | 300.02 keV | 2.24E+000 | 2.71E+000 | 4.84E+000 |
| PA-234 | NOT FOUND/DATA | for | 131.20 keV | 9.76E-003 | 2.47E-001 | 4.25E-001 |
| PA-234M | NOT FOUND/DATA | for | 1001.03 keV | 3.20E+000 | 1.33E+001 | 2.68E+001 |
| TH-234 | NOT FOUND/DATA | for | 92.60 keV | 1.14E+000 | 1.31E+000 | 2.37E+000 |
| U-234 | NOT FOUND/DATA | for | 53.20 keV | -3.36E+002 | 2.77E+002 | 4.15E+002 |
| U-235 | NOT FOUND/DATA | for | 185.71 keV | 1.07E-001 | 9.59E-002 | 1.87E-001 |
| U-238 | NOT FOUND/DATA | for | 92.60 keV | 1.14E+000 | 1.31E+000 | 2.37E+000 |
| AM-241 | NOT FOUND/DATA | for | 59.54 keV | -8.52E-002 | 4.98E-001 | 8.81E-001 |

Uncertainty reported at 2.0 sigma

 ***** CERTIFICATE OF ANALYSIS *****

Site Location: CE Windsor
 Sample ID: SS-FSS-02-026-00
 Sample Title: FSS 02 026 00
 Detector Name: 30%HPGE
 Nuclide Library Used: C:\GENIE2K\CAMFILES\FSS.NLB
 Sample Size: 1.051E+003 g
 Sample Taken On: 1/19/2005 9:50:00 AM
 Acquisition Started: 2/1/2005 9:11:35 AM
 Live Time: 900.0 seconds
 Real Time: 901.3 seconds
 Dead Time: 0.15 %
 Efficiency ID: srs035

| Nuclide Name | IDENTIFIED RADIONUCLIDES | | | UNIDENTIFIED RADIONUCLIDES | | |
|--------------|--------------------------|--------------------------|---------------------|----------------------------|--------------------------|------------------|
| | Nuclide Activity (pCi/g) | Activity Uncert. (pCi/g) | Nuclide MDA (pCi/g) | Line Activity (pCi/g) | Line Act Uncert. (pCi/g) | Line MDA (pCi/g) |
| K-40 | 1.93E+001 | 7.47E+000 | 1.67E+000 | FOUND | | |
| MN-54 | NOT FOUND/DATA | for | 834.83 keV | -5.22E-003 | 6.63E-002 | 1.23E-001 |
| CO-57 | NOT FOUND/DATA | for | 122.06 keV | 1.91E-002 | 5.50E-002 | 9.45E-002 |
| CO-60 | NOT FOUND/DATA | for | 1332.50 keV | 3.78E-002 | 7.07E-002 | 1.45E-001 |
| ZN-65 | NOT FOUND/DATA | for | 1115.55 keV | -9.42E-002 | 1.42E-001 | 2.38E-001 |
| AG-110m | NOT FOUND/DATA | for | 657.76 keV | 2.06E-002 | 5.73E-002 | 1.11E-001 |
| SB-125 | NOT FOUND/DATA | for | 427.89 keV | -2.96E-002 | 1.28E-001 | 2.38E-001 |
| CS-134 | NOT FOUND/DATA | for | 604.70 keV | -7.49E-002 | 5.74E-002 | 8.60E-002 |
| CS-137 | NOT FOUND/DATA | for | 661.66 keV | 6.59E-002 | 6.79E-002 | 1.45E-001 |
| TL-208 | 2.61E-001 | 8.07E-002 | 1.40E-001 | FOUND | | |
| PB-212 | NOT FOUND/DATA | for | 238.63 keV | 6.48E-001 | 1.67E-001 | 3.41E-001 |
| BI-214 | 7.99E-001 | 2.78E-001 | 2.65E-001 | FOUND | | |
| PB-214 | 6.24E-001 | 2.20E-001 | 3.20E-001 | FOUND | | |
| RA-226 | NOT FOUND/DATA | for | 186.10 keV | 4.84E-001 | 1.28E+000 | 2.36E+000 |
| AC-228 | 1.00E+000 | 2.46E-001 | 4.03E-001 | FOUND | | |
| TH-230 | NOT FOUND/DATA | for | 67.67 keV | -7.93E+000 | 2.18E+001 | 3.88E+001 |
| PA-231 | NOT FOUND/DATA | for | 300.02 keV | -1.14E+000 | 2.16E+000 | 3.45E+000 |
| PA-234 | NOT FOUND/DATA | for | 98.44 keV | 1.29E-002 | 2.26E-001 | 3.78E-001 |
| PA-234M | NOT FOUND/DATA | for | 1001.03 keV | -2.30E-001 | 1.02E+001 | 2.00E+001 |
| TH-234 | NOT FOUND/DATA | for | 92.60 keV | 1.33E+000 | 1.08E+000 | 2.00E+000 |
| U-234 | NOT FOUND/DATA | for | 53.20 keV | -3.83E+001 | 1.98E+002 | 3.59E+002 |
| U-235 | NOT FOUND/DATA | for | 185.71 keV | -2.43E-002 | 7.93E-002 | 1.40E-001 |
| U-238 | NOT FOUND/DATA | for | 92.60 keV | 1.33E+000 | 1.08E+000 | 2.00E+000 |
| AM-241 | NOT FOUND/DATA | for | 59.54 keV | 1.57E-001 | 4.11E-001 | 7.79E-001 |

Uncertainty reported at 2.0 sigma

 ***** CERTIFICATE OF ANALYSIS *****

Site Location: CE Windsor
 Sample ID: SS-FSS-02-027-00
 Sample Title: FSS 02 027 00
 Detector Name: 30%HPGE
 Nuclide Library Used: C:\GENIE2K\CAMFILES\FSS.NLB
 Sample Size: 9.790E+002 g
 Sample Taken On: 1/19/2005 10:00:00 AM
 Acquisition Started: 2/1/2005 9:32:18 AM
 Live Time: 900.0 seconds
 Real Time: 901.4 seconds
 Dead Time: 0.15 %
 Efficiency ID: srs035

| Nuclide Name | IDENTIFIED RADIONUCLIDES | | | UNIDENTIFIED RADIONUCLIDES | | |
|--------------|---------------------------|---------------------------|----------------------|----------------------------|---------------------------|-------------------|
| | Nuclide Activity (pCi/g) | Activity Uncert. (pCi/g) | Nuclide MDA (pCi/g) | Line Activity (pCi/g) | Line Act Uncert. (pCi/g) | Line MDA (pCi/g) |
| K-40 | 1.87E+001 | 7.39E+000 | 2.27E+000 | FOUND | | |
| MN-54 | NOT FOUND/DATA | for | 834.83 keV | 3.66E-002 | 5.26E-002 | 1.19E-001 |
| CO-57 | NOT FOUND/DATA | for | 122.06 keV | -3.49E-002 | 6.54E-002 | 1.05E-001 |
| CO-60 | NOT FOUND/DATA | for | 1173.24 keV | 3.27E-002 | 6.12E-002 | 1.30E-001 |
| ZN-65 | NOT FOUND/DATA | for | 1115.55 keV | -2.55E-002 | 1.68E-001 | 3.14E-001 |
| AG-110m | NOT FOUND/DATA | for | 657.76 keV | -7.69E-004 | 7.21E-002 | 1.20E-001 |
| SB-125 | NOT FOUND/DATA | for | 427.89 keV | -8.71E-002 | 1.67E-001 | 2.92E-001 |
| CS-134 | NOT FOUND/DATA | for | 604.70 keV | -4.79E-002 | 5.63E-002 | 8.49E-002 |
| CS-137 | NOT FOUND/DATA | for | 661.66 keV | 5.16E-002 | 8.49E-002 | 1.61E-001 |
| TL-208 | 2.99E-001 | 8.99E-002 | 1.37E-001 | FOUND | | |
| PB-212 | 9.63E-001 | 2.93E-001 | 3.23E-001 | FOUND | | |
| BI-214 | 9.39E-001 | 6.14E-001 | 2.48E-001 | FOUND | | |
| PB-214 | 8.46E-001 | 1.54E-001 | 2.50E-001 | FOUND | | |
| RA-226 | NOT FOUND/DATA | for | 186.10 keV | 1.81E+000 | 1.36E+000 | 2.69E+000 |
| AC-228 | NOT FOUND/DATA | for | 911.21 keV | 6.13E-001 | 3.28E-001 | 7.52E-001 |
| TH-230 | NOT FOUND/DATA | for | 67.67 keV | -1.55E+001 | 2.46E+001 | 4.21E+001 |
| PA-231 | NOT FOUND/DATA | for | 300.02 keV | -7.43E-001 | 2.19E+000 | 3.61E+000 |
| PA-234 | NOT FOUND/DATA | for | 98.44 keV | -1.84E-001 | 2.42E-001 | 3.71E-001 |
| PA-234M | NOT FOUND/DATA | for | 1001.03 keV | -5.40E+000 | 1.40E+001 | 2.24E+001 |
| TH-234 | NOT FOUND/DATA | for | 92.60 keV | 1.77E+000 | 1.07E+000 | 2.06E+000 |
| U-234 | NOT FOUND/DATA | for | 53.20 keV | 3.03E+001 | 1.95E+002 | 3.70E+002 |
| U-235 | NOT FOUND/DATA | for | 185.71 keV | 5.25E-002 | 8.13E-002 | 1.54E-001 |
| U-238 | NOT FOUND/DATA | for | 92.60 keV | 1.77E+000 | 1.07E+000 | 2.06E+000 |
| AM-241 | NOT FOUND/DATA | for | 59.54 keV | 3.96E-003 | 4.51E-001 | 8.29E-001 |

Uncertainty reported at 2.0 sigma

 C E R T I F I C A T E O F A N A L Y S I S

Site Location: CE Windsor
 Sample ID: SS-FSS-02-028-00
 Sample Title: FSS 02 028 00
 Detector Name: 30%HPGE
 Nuclide Library Used: C:\GENIE2K\CAMFILES\FSS.NLB
 Sample Size: 1.016E+003 g
 Sample Taken On: 1/19/2005 10:10:00 AM
 Acquisition Started: 2/1/2005 9:53:11 AM
 Live Time: 900.0 seconds
 Real Time: 901.5 seconds
 Dead Time: 0.16 %
 Efficiency ID: srs035

| Nuclide Name | IDENTIFIED RADIONUCLIDES | | | UNIDENTIFIED RADIONUCLIDES | | |
|--------------|---------------------------|---------------------------|----------------------|----------------------------|---------------------------|-------------------|
| | Nuclide Activity (pCi/g) | Activity Uncert. (pCi/g) | Nuclide MDA (pCi/g) | Line Activity (pCi/g) | Line Act Uncert. (pCi/g) | Line MDA (pCi/g) |
| K-40 | 1.98E+001 | 2.62E+000 | 1.66E+000 | FOUND | | |
| MN-54 | NOT FOUND/DATA | for | 834.83 keV | 4.07E-002 | 6.36E-002 | 1.34E-001 |
| CO-57 | NOT FOUND/DATA | for | 122.06 keV | -1.92E-002 | 5.72E-002 | 9.30E-002 |
| CO-60 | NOT FOUND/DATA | for | 1173.24 keV | 3.36E-002 | 6.76E-002 | 1.43E-001 |
| ZN-65 | NOT FOUND/DATA | for | 1115.55 keV | 2.29E-002 | 1.33E-001 | 2.70E-001 |
| AG-110m | NOT FOUND/DATA | for | 657.76 keV | 3.08E-003 | 6.50E-002 | 1.22E-001 |
| SB-125 | NOT FOUND/DATA | for | 427.89 keV | -2.96E-002 | 1.86E-001 | 3.34E-001 |
| CS-134 | NOT FOUND/DATA | for | 604.70 keV | -1.53E-002 | 6.16E-002 | 1.07E-001 |
| CS-137 | NOT FOUND/DATA | for | 661.66 keV | 2.92E-002 | 6.17E-002 | 1.28E-001 |
| TL-208 | 2.98E-001 | 8.54E-002 | 1.32E-001 | FOUND | | |
| PB-212 | 8.55E-001 | 1.43E-001 | 2.20E-001 | FOUND | | |
| BI-214 | 8.94E-001 | 2.02E-001 | 2.71E-001 | FOUND | | |
| PB-214 | 5.40E-001 | 3.63E-001 | 3.16E-001 | FOUND | | |
| RA-226 | NOT FOUND/DATA | for | 186.10 keV | 1.82E+000 | 1.52E+000 | 2.91E+000 |
| AC-228 | NOT FOUND/DATA | for | 911.21 keV | 7.67E-001 | 3.39E-001 | 7.82E-001 |
| TH-230 | NOT FOUND/DATA | for | 67.67 keV | -3.06E+000 | 2.46E+001 | 4.40E+001 |
| PA-231 | NOT FOUND/DATA | for | 300.02 keV | 8.32E-001 | 2.21E+000 | 3.93E+000 |
| PA-234 | NOT FOUND/DATA | for | 131.20 keV | -5.47E-002 | 2.25E-001 | 3.67E-001 |
| PA-234M | NOT FOUND/DATA | for | 1001.03 keV | -7.77E-001 | 1.26E+001 | 2.32E+001 |
| TH-234 | NOT FOUND/DATA | for | 92.60 keV | 1.01E+000 | 1.07E+000 | 1.93E+000 |
| U-234 | NOT FOUND/DATA | for | 53.20 keV | -1.43E+001 | 2.08E+002 | 3.76E+002 |
| U-235 | NOT FOUND/DATA | for | 185.71 keV | 1.43E-001 | 9.03E-002 | 1.78E-001 |
| U-238 | NOT FOUND/DATA | for | 92.60 keV | 1.01E+000 | 1.07E+000 | 1.93E+000 |
| AM-241 | NOT FOUND/DATA | for | 59.54 keV | 2.33E-001 | 4.15E-001 | 7.98E-001 |

Uncertainty reported at 2.0 sigma

 ***** CERTIFICATE OF ANALYSIS *****

Site Location: CE Windsor
 Sample ID: SS-FSS-02-029-00
 Sample Title: FSS-02-029-00
 Detector Name: 30%HPGE
 Nuclide Library Used: C:\GENIE2K\CAMFILES\FSS.NLB
 Sample Size: 1.034E+003 g
 Sample Taken On: 1/19/2005 10:20:00 AM
 Acquisition Started: 3/10/2005 10:38:41 AM
 Live Time: 1200.0 seconds
 Real Time: 1202.0 seconds
 Dead Time: 0.16 %
 Efficiency ID: srs035

| Nuclide Name | IDENTIFIED RADIONUCLIDES | | | UNIDENTIFIED RADIONUCLIDES | | |
|--------------|---------------------------|---------------------------|----------------------|----------------------------|---------------------------|-------------------|
| | Nuclide Activity (pCi/g) | Activity Uncert. (pCi/g) | Nuclide MDA (pCi/g) | Line Activity (pCi/g) | Line Act Uncert. (pCi/g) | Line MDA (pCi/g) |
| K-40 | 1.95E+001 | 4.68E+000 | 9.04E-001 | FOUND | | |
| MN-54 | NOT FOUND/DATA | for | 834.83 keV | 1.54E-003 | 5.68E-002 | 1.05E-001 |
| CO-57 | NOT FOUND/DATA | for | 122.06 keV | -3.35E-002 | 5.65E-002 | 8.95E-002 |
| CO-60 | NOT FOUND/DATA | for | 1332.50 keV | 3.85E-002 | 5.05E-002 | 1.16E-001 |
| ZN-65 | NOT FOUND/DATA | for | 1115.55 keV | -1.46E-001 | 1.59E-001 | 2.30E-001 |
| AG-110m | NOT FOUND/DATA | for | 657.76 keV | 1.84E-002 | 6.08E-002 | 1.18E-001 |
| SB-125 | NOT FOUND/DATA | for | 427.89 keV | -3.21E-002 | 1.20E-001 | 2.18E-001 |
| CS-134 | NOT FOUND/DATA | for | 604.70 keV | -1.27E-002 | 5.58E-002 | 9.36E-002 |
| CS-137 | NOT FOUND/DATA | for | 661.66 keV | -2.42E-002 | 6.57E-002 | 1.11E-001 |
| TL-208 | 2.69E-001 | 2.24E-001 | 1.23E-001 | FOUND | | |
| PB-212 | 7.06E-001 | 1.20E-001 | 2.38E-001 | FOUND | | |
| BI-214 | 7.04E-001 | 1.58E-001 | 2.34E-001 | FOUND | | |
| PB-214 | 8.20E-001 | 2.09E-001 | 3.09E-001 | FOUND | | |
| RA-226 | NOT FOUND/DATA | for | 186.10 keV | 1.72E+000 | 1.15E+000 | 2.23E+000 |
| AC-228 | 9.54E-001 | 3.24E-001 | 3.79E-001 | FOUND | | |
| TH-230 | NOT FOUND/DATA | for | 67.67 keV | 7.91E-002 | 2.04E+001 | 3.68E+001 |
| PA-231 | NOT FOUND/DATA | for | 300.02 keV | 6.49E-001 | 2.03E+000 | 3.48E+000 |
| PA-234 | NOT FOUND/DATA | for | 98.44 keV | -2.31E-001 | 2.08E-001 | 3.04E-001 |
| PA-234M | NOT FOUND/DATA | for | 1001.03 keV | -1.03E+001 | 1.01E+001 | 1.46E+001 |
| TH-234 | NOT FOUND/DATA | for | 92.60 keV | 1.16E+000 | 9.60E-001 | 1.74E+000 |
| U-234 | NOT FOUND/DATA | for | 53.20 keV | 8.83E+001 | 1.82E+002 | 3.43E+002 |
| U-235 | NOT FOUND/DATA | for | 185.71 keV | 7.95E-002 | 7.24E-002 | 1.37E-001 |
| U-238 | NOT FOUND/DATA | for | 92.60 keV | 1.16E+000 | 9.60E-001 | 1.74E+000 |
| AM-241 | NOT FOUND/DATA | for | 59.54 keV | -6.79E-002 | 3.36E-001 | 5.94E-001 |

Uncertainty reported at 2.0 sigma

 ***** CERTIFICATE OF ANALYSIS *****

Site Location: CE Windsor
 Sample ID: SS-FSS-02-030-00
 Sample Title: FSS 02 030 00
 Detector Name: 30%HPGE
 Nuclide Library Used: C:\GENIE2K\CAMFILES\FSS.NLB
 Sample Size: 1.008E+003 g
 Sample Taken On: 1/19/2005 10:30:00 AM
 Acquisition Started: 2/1/2005 10:41:14 AM
 Live Time: 900.0 seconds
 Real Time: 901.4 seconds
 Dead Time: 0.16 %
 Efficiency ID: srs035

| Nuclide Name | IDENTIFIED RADIONUCLIDES | | | UNIDENTIFIED RADIONUCLIDES | | |
|--------------|---------------------------|---------------------------|----------------------|----------------------------|---------------------------|-------------------|
| | Nuclide Activity (pCi/g) | Activity Uncert. (pCi/g) | Nuclide MDA (pCi/g) | Line Activity (pCi/g) | Line Act Uncert. (pCi/g) | Line MDA (pCi/g) |
| K-40 | 1.73E+001 | 6.49E+000 | 1.86E+000 | FOUND | | |
| MN-54 | NOT FOUND/DATA | for | 834.83 keV | -8.69E-003 | 4.91E-002 | 9.54E-002 |
| CO-57 | 5.25E-002 | 3.64E-002 | 9.48E-002 | FOUND | | |
| CO-60 | NOT FOUND/DATA | for | 1173.24 keV | 6.75E-002 | 7.64E-002 | 1.69E-001 |
| ZN-65 | NOT FOUND/DATA | for | 1115.55 keV | -1.11E-001 | 1.73E-001 | 2.20E-001 |
| AG-110m | NOT FOUND/DATA | for | 884.68 keV | -6.73E-002 | 7.42E-002 | 1.21E-001 |
| SB-125 | NOT FOUND/DATA | for | 427.89 keV | 3.94E-002 | 1.66E-001 | 3.15E-001 |
| CS-134 | NOT FOUND/DATA | for | 604.70 keV | 3.36E-002 | 6.72E-002 | 1.31E-001 |
| CS-137 | NOT FOUND/DATA | for | 661.66 keV | 7.51E-003 | 6.80E-002 | 1.32E-001 |
| TL-208 | 3.63E-001 | 3.19E-001 | 1.49E-001 | FOUND | | |
| PB-212 | 1.04E+000 | 3.81E-001 | 3.18E-001 | FOUND | | |
| BI-214 | 7.75E-001 | 1.96E-001 | 2.88E-001 | FOUND | | |
| PB-214 | 8.07E-001 | 1.82E-001 | 3.01E-001 | FOUND | | |
| RA-226 | NOT FOUND/DATA | for | 186.10 keV | 1.92E+000 | 1.33E+000 | 2.64E+000 |
| AC-228 | NOT FOUND/DATA | for | 911.21 keV | 1.37E-001 | 1.72E-001 | 8.67E-001 |
| TH-230 | NOT FOUND/DATA | for | 67.67 keV | -9.50E-002 | 2.54E+001 | 4.61E+001 |
| PA-231 | NOT FOUND/DATA | for | 300.02 keV | 6.88E-001 | 1.98E+000 | 3.59E+000 |
| PA-234 | NOT FOUND/DATA | for | 131.20 keV | -7.69E-002 | 2.48E-001 | 4.02E-001 |
| PA-234M | NOT FOUND/DATA | for | 1001.03 keV | 8.87E+000 | 9.69E+000 | 2.26E+001 |
| TH-234 | NOT FOUND/DATA | for | 92.60 keV | 1.23E+000 | 1.13E+000 | 2.06E+000 |
| U-234 | NOT FOUND/DATA | for | 53.20 keV | -3.84E+001 | 2.09E+002 | 3.60E+002 |
| U-235 | NOT FOUND/DATA | for | 185.71 keV | 1.04E-001 | 8.23E-002 | 1.62E-001 |
| U-238 | NOT FOUND/DATA | for | 92.60 keV | 1.23E+000 | 1.13E+000 | 2.06E+000 |
| AM-241 | NOT FOUND/DATA | for | 59.54 keV | -9.61E-002 | 4.00E-001 | 7.18E-001 |

Uncertainty reported at 2.0 sigma

 C E R T I F I C A T E O F A N A L Y S I S

Site Location: CE Windsor
 Sample ID: SS-FSS-02-031-00
 Sample Title: FSS 02 031 00
 Detector Name: 30%HPGE
 Nuclide Library Used: C:\GENIE2K\CAMFILES\FSS.NLB
 Sample Size: 9.674E+002 g
 Sample Taken On: 1/19/2005 10:40:00 AM
 Acquisition Started: 2/1/2005 10:58:45 AM
 Live Time: 900.0 seconds
 Real Time: 901.4 seconds
 Dead Time: 0.15 %
 Efficiency ID: srs035

| Nuclide Name | IDENTIFIED RADIONUCLIDES | | | UNIDENTIFIED RADIONUCLIDES | | |
|--------------|--------------------------|--------------------------|---------------------|----------------------------|--------------------------|------------------|
| | Nuclide Activity (pCi/g) | Activity Uncert. (pCi/g) | Nuclide MDA (pCi/g) | Line Activity (pCi/g) | Line Act Uncert. (pCi/g) | Line MDA (pCi/g) |
| K-40 | 2.23E+001 | 7.89E+000 | 1.03E+000 | FOUND | | |
| MN-54 | NOT FOUND/DATA | for | 834.83 keV | 5.34E-003 | 6.93E-002 | 1.33E-001 |
| CO-57 | NOT FOUND/DATA | for | 122.06 keV | -1.88E-003 | 6.04E-002 | 1.03E-001 |
| CO-60 | NOT FOUND/DATA | for | 1173.24 keV | 1.45E-002 | 8.04E-002 | 1.61E-001 |
| ZN-65 | NOT FOUND/DATA | for | 1115.55 keV | -6.77E-002 | 1.44E-001 | 2.58E-001 |
| AG-110m | NOT FOUND/DATA | for | 657.76 keV | -3.64E-002 | 7.66E-002 | 1.24E-001 |
| SB-125 | NOT FOUND/DATA | for | 427.89 keV | -1.45E-002 | 1.80E-001 | 3.22E-001 |
| CS-134 | NOT FOUND/DATA | for | 604.70 keV | -5.18E-002 | 7.27E-002 | 1.13E-001 |
| CS-137 | NOT FOUND/DATA | for | 661.66 keV | 7.57E-002 | 7.76E-002 | 1.63E-001 |
| TL-208 | 3.21E-001 | 9.32E-002 | 1.63E-001 | FOUND | | |
| PB-212 | 7.23E-001 | 1.41E-001 | 2.78E-001 | FOUND | | |
| BI-214 | 6.29E-001 | 1.83E-001 | 3.06E-001 | FOUND | | |
| PB-214 | 7.46E-001 | 5.57E-001 | 3.10E-001 | FOUND | | |
| RA-226 | NOT FOUND/DATA | for | 186.10 keV | 3.03E+000 | 1.51E+000 | 3.04E+000 |
| AC-228 | NOT FOUND/DATA | for | 338.32 keV | 6.05E-001 | 4.62E-001 | 9.47E-001 |
| TH-230 | NOT FOUND/DATA | for | 67.67 keV | -9.60E+000 | 2.56E+001 | 4.50E+001 |
| PA-231 | NOT FOUND/DATA | for | 300.02 keV | -5.07E-002 | 2.41E+000 | 4.17E+000 |
| PA-234 | NOT FOUND/DATA | for | 98.44 keV | 1.15E-001 | 2.48E-001 | 4.31E-001 |
| PA-234M | NOT FOUND/DATA | for | 1001.03 keV | -6.32E+000 | 1.30E+001 | 2.17E+001 |
| TH-234 | NOT FOUND/DATA | for | 92.60 keV | 1.19E+000 | 1.20E+000 | 2.18E+000 |
| U-234 | NOT FOUND/DATA | for | 53.20 keV | -9.14E+001 | 2.42E+002 | 4.15E+002 |
| U-235 | NOT FOUND/DATA | for | 185.71 keV | 1.60E-001 | 9.19E-002 | 1.83E-001 |
| U-238 | NOT FOUND/DATA | for | 92.60 keV | 1.19E+000 | 1.20E+000 | 2.18E+000 |
| AM-241 | NOT FOUND/DATA | for | 59.54 keV | -6.85E-004 | 4.26E-001 | 7.82E-001 |

Uncertainty reported at 2.0 sigma

 C E R T I F I C A T E O F A N A L Y S I S

Site Location: CE Windsor
 Sample ID: SS-FSS-02-032-00
 Sample Title: FSS 02 032 00
 Detector Name: 30%HPGE
 Nuclide Library Used: C:\GENIE2K\CAMFILES\FSS.NLB
 Sample Size: 1.009E+003 g
 Sample Taken On: 1/19/2005 10:50:00 AM
 Acquisition Started: 2/1/2005 11:16:23 AM
 Live Time: 900.0 seconds
 Real Time: 901.4 seconds
 Dead Time: 0.15 %
 Efficiency ID: srs035

| Nuclide Name | IDENTIFIED RADIONUCLIDES | | | UNIDENTIFIED RADIONUCLIDES | | |
|--------------|---------------------------|---------------------------|----------------------|----------------------------|---------------------------|-------------------|
| | Nuclide Activity (pCi/g) | Activity Uncert. (pCi/g) | Nuclide MDA (pCi/g) | Line Activity (pCi/g) | Line Act Uncert. (pCi/g) | Line MDA (pCi/g) |
| K-40 | 1.73E+001 | 2.40E+000 | 1.46E+000 | FOUND | | |
| MN-54 | NOT FOUND/DATA | for | 834.83 keV | 1.78E-002 | 7.14E-002 | 1.39E-001 |
| CO-57 | NOT FOUND/DATA | for | 122.06 keV | 4.04E-002 | 5.62E-002 | 1.01E-001 |
| CO-60 | NOT FOUND/DATA | for | 1332.50 keV | -1.97E-002 | 5.54E-002 | 1.04E-001 |
| ZN-65 | NOT FOUND/DATA | for | 1115.55 keV | -8.43E-002 | 1.70E-001 | 2.94E-001 |
| AG-110m | NOT FOUND/DATA | for | 657.76 keV | -2.88E-003 | 6.18E-002 | 1.16E-001 |
| SB-125 | NOT FOUND/DATA | for | 427.89 keV | 1.30E-002 | 1.59E-001 | 3.03E-001 |
| CS-134 | NOT FOUND/DATA | for | 604.70 keV | -6.96E-002 | 6.19E-002 | 9.63E-002 |
| CS-137 | NOT FOUND/DATA | for | 661.66 keV | -6.16E-002 | 7.34E-002 | 1.05E-001 |
| TL-208 | 2.28E-001 | 2.27E-001 | 1.32E-001 | FOUND | | |
| PB-212 | 7.03E-001 | 1.32E-001 | 2.42E-001 | FOUND | | |
| BI-214 | 5.65E-001 | 5.13E-001 | 2.44E-001 | FOUND | | |
| PB-214 | 6.57E-001 | 5.55E-001 | 3.13E-001 | FOUND | | |
| RA-226 | NOT FOUND/DATA | for | 186.10 keV | 1.20E+000 | 1.35E+000 | 2.58E+000 |
| AC-228 | 8.82E-001 | 3.29E-001 | 5.66E-001 | FOUND | | |
| TH-230 | NOT FOUND/DATA | for | 67.67 keV | -2.59E+001 | 2.37E+001 | 3.85E+001 |
| PA-231 | NOT FOUND/DATA | for | 300.02 keV | 4.52E-001 | 2.19E+000 | 3.68E+000 |
| PA-234 | NOT FOUND/DATA | for | 98.44 keV | -5.34E-002 | 2.27E-001 | 3.74E-001 |
| PA-234M | NOT FOUND/DATA | for | 1001.03 keV | 6.36E+000 | 9.34E+000 | 2.09E+001 |
| TH-234 | NOT FOUND/DATA | for | 92.60 keV | 1.03E+000 | 1.17E+000 | 2.09E+000 |
| U-234 | NOT FOUND/DATA | for | 53.20 keV | 3.64E+001 | 1.97E+002 | 3.74E+002 |
| U-235 | NOT FOUND/DATA | for | 185.71 keV | 1.22E-001 | 8.30E-002 | 1.64E-001 |
| U-238 | NOT FOUND/DATA | for | 92.60 keV | 1.03E+000 | 1.17E+000 | 2.09E+000 |
| AM-241 | NOT FOUND/DATA | for | 59.54 keV | 2.37E-001 | 3.71E-001 | 7.26E-001 |

Uncertainty reported at 2.0 sigma

 ***** CERTIFICATE OF ANALYSIS *****

Site Location: CE Windsor
 Sample ID: SS-FSS-02-033-00
 Sample Title: FSS 02 033 00
 Detector Name: 30%HPGE
 Nuclide Library Used: C:\GENIE2K\CAMFILES\FSS.NLB
 Sample Size: 1.073E+003 g
 Sample Taken On: 1/19/2005 11:00:00 AM
 Acquisition Started: 2/1/2005 12:35:40 PM
 Live Time: 900.0 seconds
 Real Time: 901.6 seconds
 Dead Time: 0.18 %
 Efficiency ID: srs035

| Nuclide Name | IDENTIFIED RADIONUCLIDES | | | UNIDENTIFIED RADIONUCLIDES | | |
|--------------|---------------------------|---------------------------|----------------------|----------------------------|---------------------------|-------------------|
| | Nuclide Activity (pCi/g) | Activity Uncert. (pCi/g) | Nuclide MDA (pCi/g) | Line Activity (pCi/g) | Line Act Uncert. (pCi/g) | Line MDA (pCi/g) |
| K-40 | 1.80E+001 | 3.77E+000 | 1.76E+000 | FOUND | | |
| MN-54 | NOT FOUND/DATA for | 834.83 keV | | 6.22E-002 | 5.50E-002 | 1.27E-001 |
| CO-57 | NOT FOUND/DATA for | 122.06 keV | | -7.89E-002 | 5.65E-002 | 8.34E-002 |
| CO-60 | NOT FOUND/DATA for | 1332.50 keV | | 9.21E-002 | 6.19E-002 | 1.58E-001 |
| ZN-65 | NOT FOUND/DATA for | 1115.55 keV | | -4.98E-002 | 1.63E-001 | 2.86E-001 |
| AG-110m | NOT FOUND/DATA for | 657.76 keV | | -4.50E-002 | 5.78E-002 | 8.77E-002 |
| SB-125 | NOT FOUND/DATA for | 427.89 keV | | 8.97E-002 | 1.36E-001 | 2.78E-001 |
| CS-134 | NOT FOUND/DATA for | 604.70 keV | | -9.30E-002 | 8.96E-002 | 8.42E-002 |
| CS-137 | NOT FOUND/DATA for | 661.66 keV | | 1.61E-002 | 6.34E-002 | 1.24E-001 |
| TL-208 | 2.99E-001 | 8.55E-002 | 1.45E-001 | FOUND | | |
| PB-212 | 1.08E+000 | 2.41E-001 | 2.65E-001 | FOUND | | |
| BI-214 | 9.36E-001 | 1.98E-001 | 3.14E-001 | FOUND | | |
| PB-214 | 8.60E-001 | 2.34E-001 | 2.93E-001 | FOUND | | |
| RA-226 | NOT FOUND/DATA for | 186.10 keV | | 1.80E+000 | 1.36E+000 | 2.65E+000 |
| AC-228 | NOT FOUND/DATA for | 911.21 keV | | 1.10E+000 | 3.85E-001 | 8.82E-001 |
| TH-230 | NOT FOUND/DATA for | 67.67 keV | | 1.74E+001 | 2.35E+001 | 4.55E+001 |
| PA-231 | NOT FOUND/DATA for | 300.02 keV | | 2.03E-001 | 1.87E+000 | 3.33E+000 |
| PA-234 | NOT FOUND/DATA for | 98.44 keV | | -1.07E-001 | 2.15E-001 | 3.46E-001 |
| PA-234M | NOT FOUND/DATA for | 1001.03 keV | | 4.10E+000 | 1.10E+001 | 2.26E+001 |
| TH-234 | NOT FOUND/DATA for | 92.60 keV | | 1.37E-001 | 1.08E+000 | 1.85E+000 |
| U-234 | NOT FOUND/DATA for | 53.20 keV | | 1.27E+002 | 1.95E+002 | 3.78E+002 |
| U-235 | NOT FOUND/DATA for | 185.71 keV | | 8.37E-002 | 8.49E-002 | 1.62E-001 |
| U-238 | NOT FOUND/DATA for | 92.60 keV | | 1.37E-001 | 1.08E+000 | 1.85E+000 |
| AM-241 | NOT FOUND/DATA for | 59.54 keV | | -3.92E-002 | 3.82E-001 | 6.66E-001 |

Uncertainty reported at 2.0 sigma

 ***** CERTIFICATE OF ANALYSIS *****

Site Location: CE Windsor
 Sample ID: SS-FSS-02-034-00
 Sample Title: FSS 02 034 00
 Detector Name: 30%HPGE
 Nuclide Library Used: C:\GENIE2K\CAMFILES\FSS.NLB
 Sample Size: 8.270E+002 g
 Sample Taken On: 1/19/2005 11:10:00 AM
 Acquisition Started: 2/1/2005 12:58:38 PM
 Live Time: 900.0 seconds
 Real Time: 901.4 seconds
 Dead Time: 0.15 %
 Efficiency ID: srs035

| Nuclide Name | IDENTIFIED RADIONUCLIDES | | | UNIDENTIFIED RADIONUCLIDES | | |
|--------------|---------------------------|---------------------------|----------------------|----------------------------|---------------------------|-------------------|
| | Nuclide Activity (pCi/g) | Activity Uncert. (pCi/g) | Nuclide MDA (pCi/g) | Line Activity (pCi/g) | Line Act Uncert. (pCi/g) | Line MDA (pCi/g) |
| K-40 | 1.95E+001 | 2.88E+000 | 2.07E+000 | FOUND | | |
| MN-54 | NOT FOUND/DATA | for | 834.83 keV | 3.65E-002 | 7.38E-002 | 1.56E-001 |
| CO-57 | NOT FOUND/DATA | for | 122.06 keV | 4.25E-002 | 6.75E-002 | 1.22E-001 |
| CO-60 | NOT FOUND/DATA | for | 1173.24 keV | 7.26E-003 | 1.15E-001 | 1.95E-001 |
| ZN-65 | NOT FOUND/DATA | for | 1115.55 keV | 4.29E-002 | 2.11E-001 | 4.06E-001 |
| AG-110m | NOT FOUND/DATA | for | 657.76 keV | 1.45E-002 | 7.61E-002 | 1.50E-001 |
| SB-125 | NOT FOUND/DATA | for | 427.89 keV | 2.80E-002 | 1.82E-001 | 3.46E-001 |
| CS-134 | NOT FOUND/DATA | for | 604.70 keV | -3.19E-002 | 6.66E-002 | 1.13E-001 |
| CS-137 | NOT FOUND/DATA | for | 661.66 keV | 1.77E-002 | 9.60E-002 | 1.84E-001 |
| TL-208 | 4.10E-001 | 2.24E-001 | 1.69E-001 | FOUND | | |
| PB-212 | 1.02E+000 | 1.94E-001 | 3.37E-001 | FOUND | | |
| BI-214 | 7.65E-001 | 2.07E-001 | 2.67E-001 | FOUND | | |
| PB-214 | 7.97E-001 | 1.72E-001 | 3.61E-001 | FOUND | | |
| RA-226 | NOT FOUND/DATA | for | 186.10 keV | 2.76E+000 | 1.66E+000 | 3.29E+000 |
| AC-228 | NOT FOUND/DATA | for | 911.21 keV | 9.63E-001 | 4.50E-001 | 1.02E+000 |
| TH-230 | NOT FOUND/DATA | for | 67.67 keV | 8.17E+000 | 2.98E+001 | 5.56E+001 |
| PA-231 | NOT FOUND/DATA | for | 300.02 keV | 2.56E+000 | 2.76E+000 | 4.92E+000 |
| PA-234 | NOT FOUND/DATA | for | 131.20 keV | -3.73E-002 | 2.83E-001 | 4.73E-001 |
| PA-234M | NOT FOUND/DATA | for | 1001.03 keV | -2.19E+000 | 1.51E+001 | 2.75E+001 |
| TH-234 | NOT FOUND/DATA | for | 92.60 keV | 1.78E+000 | 1.30E+000 | 2.44E+000 |
| U-234 | NOT FOUND/DATA | for | 53.20 keV | 3.04E+002 | 2.58E+002 | 5.07E+002 |
| U-235 | NOT FOUND/DATA | for | 185.71 keV | 1.92E-001 | 1.02E-001 | 2.07E-001 |
| U-238 | NOT FOUND/DATA | for | 92.60 keV | 1.78E+000 | 1.30E+000 | 2.44E+000 |
| AM-241 | NOT FOUND/DATA | for | 59.54 keV | 4.51E-001 | 5.02E-001 | 9.90E-001 |

Uncertainty reported at 2.0 sigma

 C E R T I F I C A T E O F A N A L Y S I S

Site Location: CE Windsor
 Sample ID: MAC-0504-540
 Sample Title: B2A SOIL - #1
 Detector Name: 30%HPGE
 Nuclide Library Used: C:\GENIE2K\CAMFILES\FSS.NLB
 Sample Size: 7.350E+002 g
 Sample Taken On: 4/29/2005 11:15:00 AM
 Acquisition Started: 5/3/2005 1:37:32 PM
 Live Time: 600.0 seconds
 Real Time: 601.0 seconds
 Dead Time: 0.16 %
 Efficiency ID: srs035

| Nuclide Name | IDENTIFIED RADIONUCLIDES | | | UNIDENTIFIED RADIONUCLIDES | | |
|--------------|--------------------------|--------------------------|---------------------|----------------------------|--------------------------|------------------|
| | Nuclide Activity (pCi/g) | Activity Uncert. (pCi/g) | Nuclide MDA (pCi/g) | Line Activity (pCi/g) | Line Act Uncert. (pCi/g) | Line MDA (pCi/g) |
| K-40 | 2.46E+001 | 3.96E+000 | 1.92E+000 | FOUND | | |
| MN-54 | NOT FOUND/DATA | for | 834.83 keV | 6.48E-002 | 8.88E-002 | 2.03E-001 |
| CO-57 | NOT FOUND/DATA | for | 122.06 keV | -2.42E-002 | 9.25E-002 | 1.51E-001 |
| CO-60 | NOT FOUND/DATA | for | 1332.50 keV | 2.37E-002 | 7.44E-002 | 1.91E-001 |
| ZN-65 | NOT FOUND/DATA | for | 1115.55 keV | 1.06E-001 | 2.37E-001 | 5.23E-001 |
| AG-110m | NOT FOUND/DATA | for | 657.76 keV | 7.23E-003 | 9.15E-002 | 1.78E-001 |
| SB-125 | NOT FOUND/DATA | for | 427.89 keV | -1.17E-001 | 2.89E-001 | 5.08E-001 |
| CS-134 | NOT FOUND/DATA | for | 604.70 keV | 2.54E-002 | 9.87E-002 | 1.97E-001 |
| CS-137 | NOT FOUND/DATA | for | 661.66 keV | 9.76E-003 | 9.60E-002 | 1.97E-001 |
| TL-208 | 3.77E-001 | 3.51E-001 | 1.94E-001 | FOUND | | |
| PB-212 | NOT FOUND/DATA | for | 238.63 keV | 9.39E-001 | 2.85E-001 | 6.00E-001 |
| BI-214 | 5.68E-001 | 2.43E-001 | 3.47E-001 | FOUND | | |
| PB-214 | 7.39E-001 | 2.78E-001 | 4.54E-001 | FOUND | | |
| RA-226 | NOT FOUND/DATA | for | 186.10 keV | 1.62E+000 | 2.25E+000 | 4.36E+000 |
| AC-228 | NOT FOUND/DATA | for | 911.21 keV | 1.14E+000 | 6.51E-001 | 1.48E+000 |
| TH-230 | NOT FOUND/DATA | for | 67.67 keV | -1.54E+001 | 3.78E+001 | 6.73E+001 |
| PA-231 | NOT FOUND/DATA | for | 300.02 keV | 3.22E+000 | 3.67E+000 | 6.84E+000 |
| PA-234 | NOT FOUND/DATA | for | 98.44 keV | -1.75E-001 | 3.47E-001 | 5.61E-001 |
| PA-234M | NOT FOUND/DATA | for | 1001.03 keV | -8.32E+000 | 1.90E+001 | 2.29E+001 |
| TH-234 | NOT FOUND/DATA | for | 92.60 keV | 1.62E+000 | 1.64E+000 | 3.14E+000 |
| U-234 | NOT FOUND/DATA | for | 53.20 keV | -1.82E+002 | 3.87E+002 | 6.86E+002 |
| U-235 | NOT FOUND/DATA | for | 185.71 keV | 1.09E-001 | 1.40E-001 | 2.70E-001 |
| U-238 | NOT FOUND/DATA | for | 92.60 keV | 1.62E+000 | 1.64E+000 | 3.14E+000 |
| AM-241 | NOT FOUND/DATA | for | 59.54 keV | 2.83E-001 | 6.83E-001 | 1.33E+000 |

Uncertainty reported at 2.0 sigma

 C E R T I F I C A T E O F A N A L Y S I S

Site Location: CE Windsor
 Sample ID: MAC-0504-541
 Sample Title: B2A @ Elevated 2X2 - #2
 Detector Name: 30%HPGE
 Nuclide Library Used: C:\GENIE2K\CAMFILES\FSS.NLB
 Sample Size: 7.274E+002 g
 Sample Taken On: 4/29/2005 11:15:00 AM
 Acquisition Started: 5/3/2005 12:26:46 PM
 Live Time: 600.0 seconds
 Real Time: 600.9 seconds
 Dead Time: 0.14 %
 Efficiency ID: srs035

| Nuclide Name | IDENTIFIED RADIONUCLIDES | | | UNIDENTIFIED RADIONUCLIDES | | |
|--------------|--------------------------|--------------------------|---------------------|----------------------------|--------------------------|------------------|
| | Nuclide Activity (pCi/g) | Activity Uncert. (pCi/g) | Nuclide MDA (pCi/g) | Line Activity (pCi/g) | Line Act Uncert. (pCi/g) | Line MDA (pCi/g) |
| K-40 | 2.04E+001 | 3.84E+000 | 3.51E+000 | FOUND | | |
| MN-54 | NOT FOUND/DATA | for | 834.83 keV | 7.22E-002 | 9.60E-002 | 2.16E-001 |
| CO-57 | NOT FOUND/DATA | for | 122.06 keV | -9.89E-002 | 9.88E-002 | 1.47E-001 |
| CO-60 | NOT FOUND/DATA | for | 1332.50 keV | -2.39E-002 | 7.93E-002 | 1.67E-001 |
| ZN-65 | NOT FOUND/DATA | for | 1115.55 keV | -5.94E-002 | 1.80E-001 | 3.41E-001 |
| AG-110m | NOT FOUND/DATA | for | 1384.30 keV | 0.00E+000 | 0.00E+000 | 2.07E-001 |
| SB-125 | NOT FOUND/DATA | for | 427.89 keV | -3.99E-002 | 2.43E-001 | 4.44E-001 |
| CS-134 | NOT FOUND/DATA | for | 604.70 keV | -2.54E-002 | 9.55E-002 | 1.70E-001 |
| CS-137 | NOT FOUND/DATA | for | 661.66 keV | 4.42E-002 | 1.10E-001 | 2.28E-001 |
| TL-208 | NOT FOUND/DATA | for | 583.19 keV | 3.77E-001 | 1.67E-001 | 3.79E-001 |
| PB-212 | 9.75E-001 | 2.23E-001 | 5.04E-001 | FOUND | | |
| BI-214 | 1.13E+000 | 9.85E-001 | 3.81E-001 | FOUND | | |
| PB-214 | 8.47E-001 | 2.97E-001 | 5.75E-001 | FOUND | | |
| RA-226 | NOT FOUND/DATA | for | 186.10 keV | 1.57E+000 | 2.37E+000 | 4.57E+000 |
| AC-228 | NOT FOUND/DATA | for | 911.21 keV | 7.48E-001 | 5.31E-001 | 1.24E+000 |
| TH-230 | NOT FOUND/DATA | for | 67.67 keV | -9.46E+000 | 4.08E+001 | 7.15E+001 |
| PA-231 | NOT FOUND/DATA | for | 300.02 keV | 6.87E-001 | 3.58E+000 | 6.40E+000 |
| PA-234 | NOT FOUND/DATA | for | 98.44 keV | 7.14E-003 | 3.62E-001 | 6.31E-001 |
| PA-234M | NOT FOUND/DATA | for | 1001.03 keV | 8.09E+000 | 1.35E+001 | 3.27E+001 |
| TH-234 | NOT FOUND/DATA | for | 92.60 keV | 2.31E+000 | 1.91E+000 | 3.63E+000 |
| U-234 | NOT FOUND/DATA | for | 53.20 keV | 2.08E+002 | 3.76E+002 | 7.37E+002 |
| U-235 | NOT FOUND/DATA | for | 185.71 keV | -1.79E-002 | 1.46E-001 | 2.63E-001 |
| U-238 | NOT FOUND/DATA | for | 92.60 keV | 2.31E+000 | 1.91E+000 | 3.63E+000 |
| AM-241 | NOT FOUND/DATA | for | 59.54 keV | 1.66E-001 | 7.00E-001 | 1.32E+000 |

Uncertainty reported at 2.0 sigma