



consulting
scientists and
engineers

MFG, Inc.
A TETRA TECH COMPANY
3801 Automation Way, Suite 100
Fort Collins, CO 80525-3434
970.223.9600
Fax: 970.223.7171

August 17, 2005

MFG Project No. 180888

Robert A. Nelson
Captain, USNR (Ret)
Chief, Uranium Processing Section
Division of Fuel Cycle Safety and Safeguards
U.S. Nuclear Regulatory Commission
MS T8 A33
Washington DC 20555

SUBJECT: WNI Split Rock Site, Long-Term Groundwater Monitoring; Source Material License SUA-56

Dear Mr. Nelson:

We recently met with the U. S. Department of Energy (DOE) to transmit site information and to discuss details of the site for their preparation of the long-term surveillance plan (LTSP). Part of that discussion included groundwater monitoring wells that would be part of the LTSP. The DOE indicated in their letter to you dated July 13, 2005 that they were concerned about wells outside the long-term care boundary that might be required for the LTSP.

Figure 1 presents the location of the wells used in the current groundwater monitoring system. As we discussed during our meeting in Denver at the NMA conference, we believe that the current system should provide necessary information to adequately monitor groundwater and to determine the adequacy of the groundwater model until the site is transferred to the DOE. The LTSP monitoring program should consist of fewer wells than are in the current network. The proposed well locations for the monitoring system for the LTSP are also shown on Figure 1.

We have discussed the proposed LTSP groundwater monitoring network with the DOE. They are satisfied that this network addresses the concerns raised in their July 13, 2005 letter. The proposed wells are all inside the long-term care boundary and the DOE would have the ability to access and maintain the wells. They also stated that the proposed number and location of the wells is in general conformance with their monitoring programs at other sites.

We trust that this will assist you in addressing the DOE concerns. Please let me know if there is any additional information you or you staff might need to regarding this matter.

Sincerely,

MFG, Inc.



Louis Miller,
Senior Consultant

Robert A. Nelson, U.S. NRC

August 17, 2005

Page 2 of 2

cc L. J. Corte, WNI
 H. W. Shaver
 Stephen Cohen, USNRC
 Thomas Pauling, USDOE

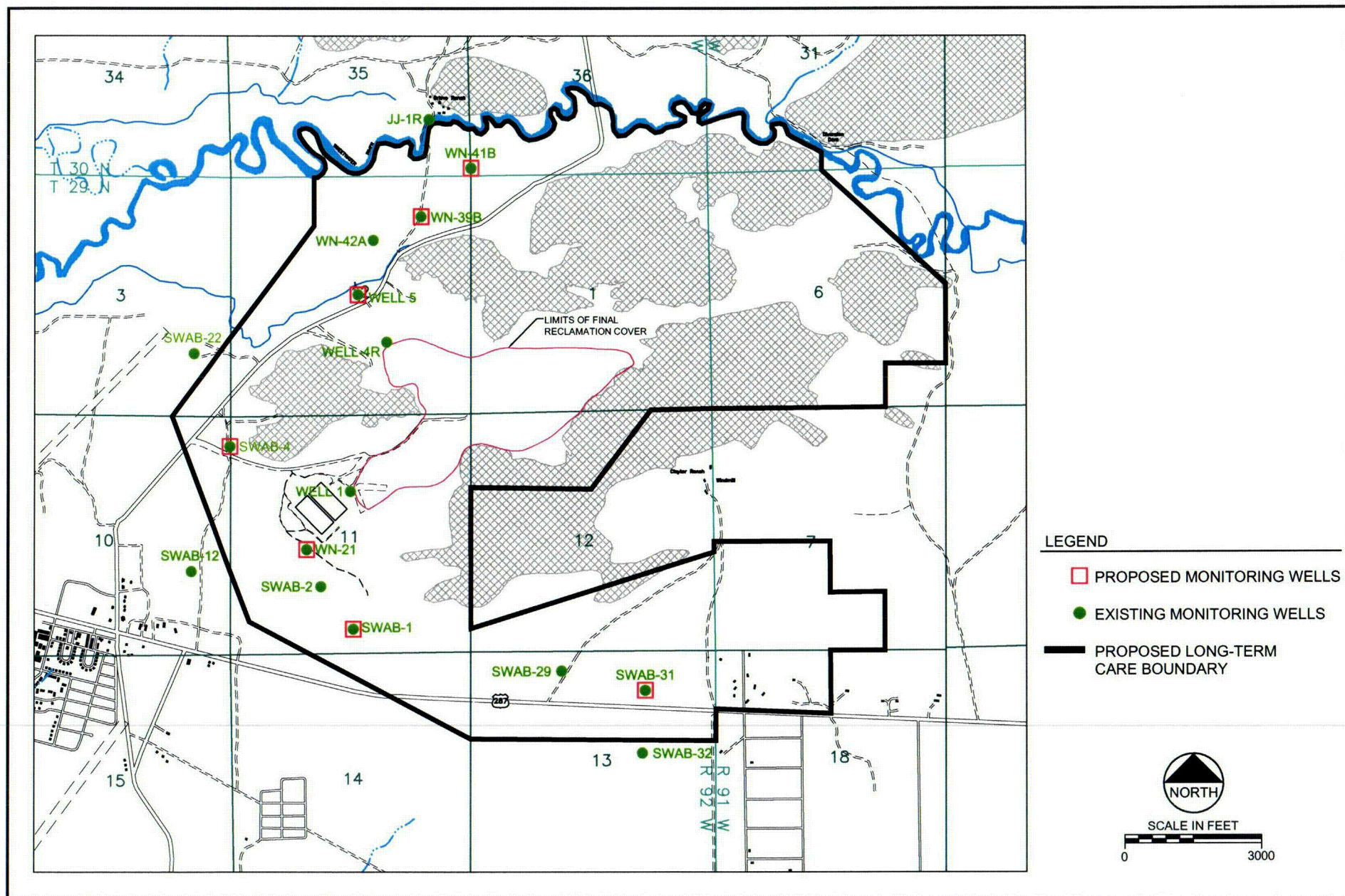

MFG, Inc.
consulting scientists and engineers

FIGURE 1
PROPOSED LONG-TERM MONITORING WELLS

Date: AUGUST 2005

Project: 003-347/2005

File: LONGTERM-2.DWG

C01