



May 12, 2005

U.S. Nuclear Regulatory Commission
Region I Office
475 Allendale Road
King of Prussia, PA 19406-1415

03033224

RE: Request for Termination of License 04-26507-01MD, Cardinal Health, Huntington, WV.

Attention Licensing:

We wish to terminate the above referenced license and request the release of the facility formerly used as a nuclear pharmacy located at 449 Adams Avenue, Suite 1, Huntington, WV. The facility ceased operations in December 2004 and does not intend to continue business at this location. All radioactive materials were removed from the facility prior to the commencement of the decommissioning. No detectable radioactive contamination was found as a result of the decommissioning surveys. Please see the detailed Facility Decommissioning Report attached to this letter.

Please also note the mailing address for the corporate office of Cardinal Health has changed from Woodland Hills, CA, to the following address:

Cardinal Health
Nuclear Pharmacy Services
7000 Cardinal Place
Dublin, Ohio 43017

Once we receive a termination letter from your office, we will release the area for unrestricted public use. If you have any questions pertaining to this request, please contact David Breuning at (614) 757-3116.

Sincerely,

A handwritten signature in black ink, appearing to read "K. Kodimer".

Kory Kodimer, Ph.D.
Manager, Health Physics

Cc: License File 201 (3)

Encl: Facility Decommissioning Report

05 MAY 14 11:08

RECEIVED
REGION 1

137043

NMCC/RCNI MATERIALS-002

Cardinal Health
6464 Canoga Avenue
Woodland Hills, CA 91367
tel 818.737.4000

www.cardinal.com



FACILITY DECOMMISSIONING REPORT

**Cardinal Health
Nuclear Pharmacy Services**

**449 Adams Ave., Suite 1
Huntington, WV 25701**

Report by:

**Chris Walters
Health Physicist
Quality & Regulatory
Cardinal Health
Nuclear Pharmacy Services**

Facility and Operations

The nuclear pharmacy licensed by the NRC resided at the location listed below. Use of radioactive materials was conducted under the license referenced below.

Pharmacy Location: 449 Adams Ave., Suite 1
Huntington, WV 25701

Radioactive Materials License: 04-26507-01MD

Sources of Radiation

The information presented below addresses the requirements presented by the NRC in NUREG 1757.

1. Please see Attachment C for the *Certificate of Disposition of Radioactive Materials*.
2. The facility used radioactive materials for nuclear pharmacy operations and instrument calibrations or constancy checks. The facility ceased using the materials on December 31, 2004. Sealed sources were transferred to another location listed on License No. 04-26507-01MD prior to the decommissioning surveys. Radioactive waste was either decayed or transferred to a certified waste broker prior to the decommissioning surveys.
3. The table below lists all isotopes used at the facility over the span of the licensed activities, and includes the date of last use for each.

Isotope	Date Last Handled	Physical Form (S,G,L or Sealed)	Quantities (μCi, mCi or Ci)
Barium-133	12/31/04	Sealed	250 μ Ci
Cesium-137	12/31/04	Sealed	250 μ Ci
Chromium-51	12/31/04	L	250 μ Ci
Cobalt-57	12/31/04	Sealed	5 mCi
Gallium-67	12/31/04	L	20 mCi
Indium-111	12/31/04	L	5 mCi
Iodine-123	12/31/04	S	10 mCi
Iodine-131	12/31/04	L	150 mCi
Molybdenum-99	12/31/04	S	30 Ci
Samarium-153	12/31/04	L	100 mCi
Strontium-89	8/6/04	L	5 mCi
Technetium-99m	12/31/04	L	20 Ci
Thallium-201	12/31/04	L	75 mCi
Xenon-133	12/31/04	G	100 mCi

There have been no major radiological spills of any licensed material (e.g., greater than 100 mCi of Tc-99m or 1 mCi of I-131) requiring assistance in clean-up and monitoring from persons other than the user.

During the life of the license, no sealed sources have been determined to be leaking.

Surveys and Monitoring

Surveys were conducted in both the restricted and unrestricted areas. All surfaces were surveyed for contamination in the restricted areas. Wipe tests for removable contamination were taken over a 100 cm² area every square meter in the restricted areas. In the unrestricted area, wipes and contamination surveys were taken on a larger grid and in areas of most probability for finding contamination (e.g., door handles, walkways from the restricted areas, etc.). The locations are identified on the diagram in Attachment A.

Contamination surveys were taken with the instrument listed below. Wipes were taken dry, unless otherwise indicated, with absorbent paper. Each wipe was counted on the analytical detector listed below. Operating specifications, efficiencies, and minimum detectable activities are also provided below.

EQUIPMENT		
Surveys	Make and Model of Survey Meter	Ludlum 2350-1
	Serial Number	193712
	Last Calibration Date	5/4/2004
	Background	mR/hr (44-38) cpm (44-89)
	Make and Model Number of Probe	Ludlum 44-38 Ludlum 44-89
Wipes	Make and Model Number	Ludlum 2200
	Serial Number	101364
	Window (should be open, this is usually 20 to 400 keV)	20 to 400 keV
	Efficiency of Well Counter (for I-131 or Ba-133 open window)	0.8947
	Date of Efficiency	04/26/05
	Region of Interest (should be the same as for efficiency)	20 to 400 keV
	Count Time	1 min.
	Background	214 cpm
	MDA (must be <200 dpm)	71

Please see Attachment A for the impacted area map with wipe test locations indicated.

Please see Attachment B for the results of the wipe test survey of the impacted area.

A reference background was established for the portable survey meter in the non-impacted area, where there is similar construction to the materials encountered the impacted area. This was determined to be 30 $\mu\text{R/hr}$ for the facility.

Waste and RAM Disposition

A search for radioactive materials and radioactive waste was performed, resulting in none found. All materials were transferred to another licensee prior to the survey.

During the life of the license, no underground piping or sink/sewer piping was used for disposal of radioactive materials (*excluding excreta*).

Please see Attachment C for a copy the Certificate of Disposition of Radioactive Materials and Surveyor Certification.

Please see Attachment D for a copy of the packing list showing receipt of sealed sources by an authorized licensee.

ATTACHMENT A

Survey Map

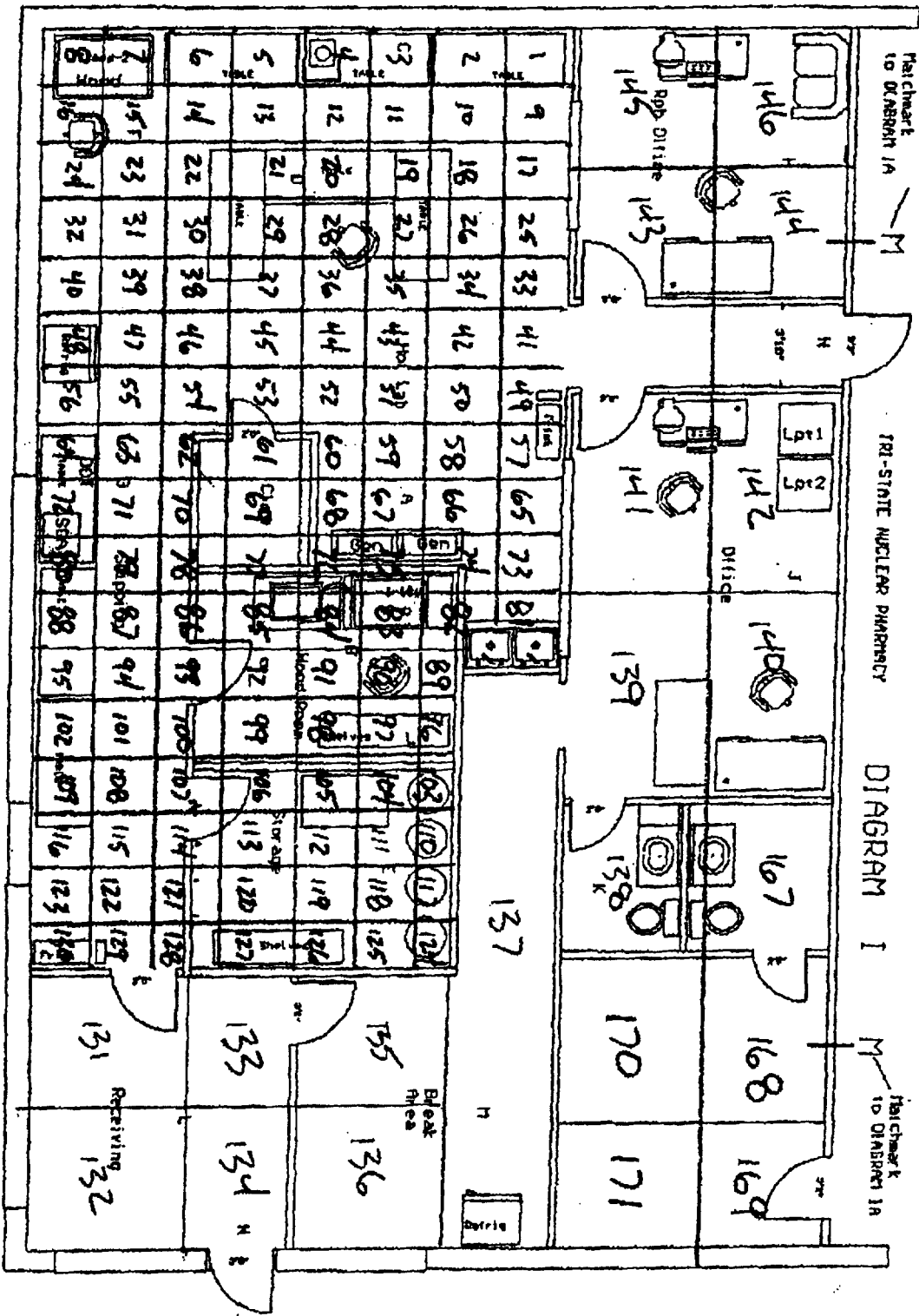

TRI-STATE NUCLEAR PHARMACY

DIAGRAM IA

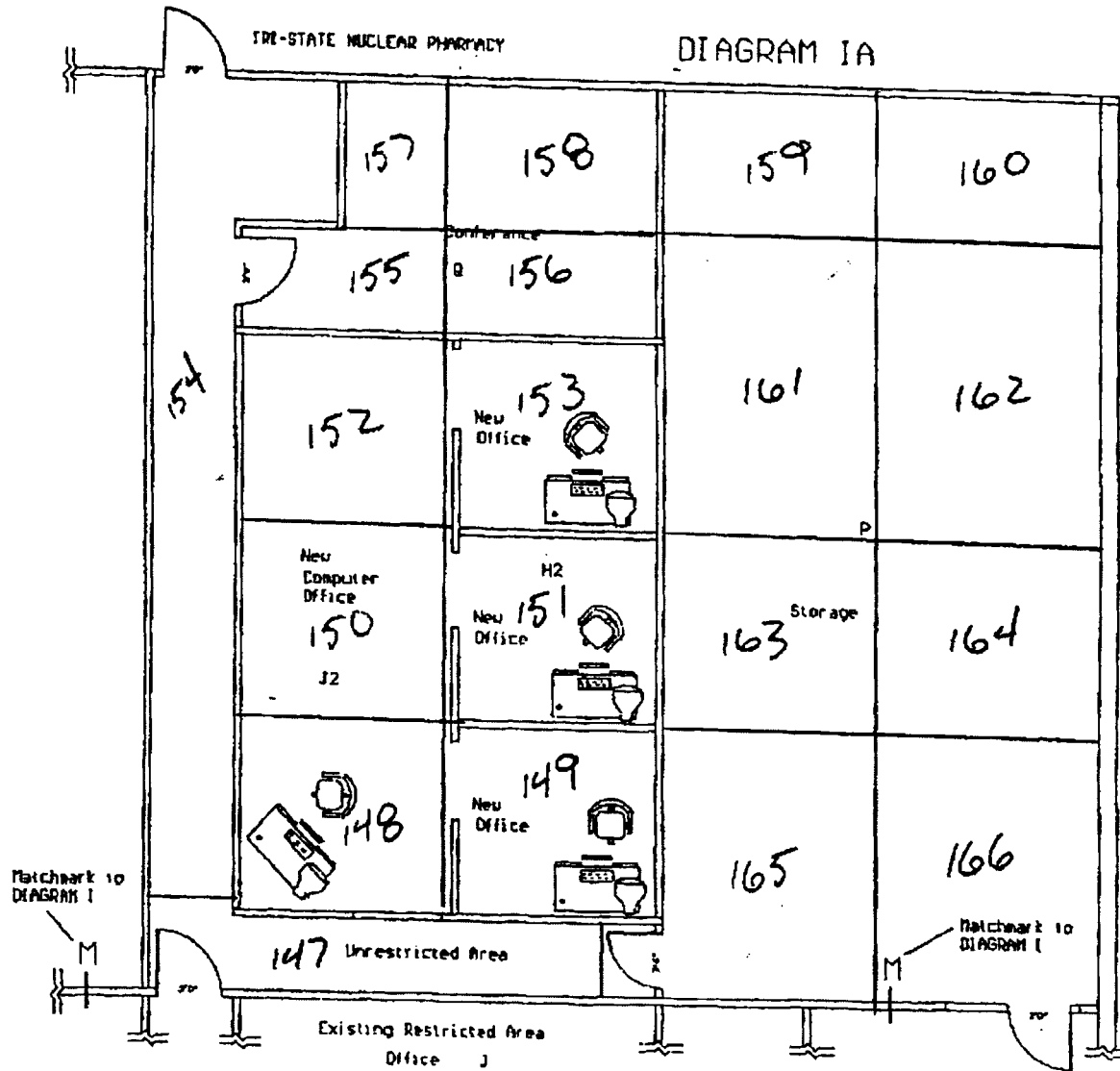

ATTACHMENT B

Wipe Test Surveys Results

Unrestricted Area Wipes

SCA Serial Number: 101364

Efficiency Date: 04/26/05

Window: 20-400

Efficiency: 89.47% c/d for Ba-133

Count time (minutes): 1.0 minute

Background (cpm): 169 cpm

MDA (dpm): 71 dpm

Area on Map		Location surveyed	Area Survey 44-38	Contamination Survey 44-89	Wipe (gross cpm)	Wipe (net cpm)	Wipe (dpm)	Flags
Description	Loc#		μ R/h	cpm				
Background			14	142		0	0	
Receiving	131	Floor	11	156	170	1	1	OK
Receiving	132	Floor	12	140	170	1	1	OK
Receiving	133	Floor	7	148	170	1	1	OK
Receiving	134	Floor	5	143	170	1	1	OK
Break Area	135	Floor	4	128	170	1	1	OK
Break Area	136	Floor	7	142	170	1	1	OK
Hallway	137	Floor	9	158	170	1	1	OK
Bathroom	138	Floor	5	145	130	0	0	OK
Office	139	Floor	3	127	130	0	0	OK
Office	140	Floor	2	125	130	0	0	OK
Office	141	Floor	2	149	130	0	0	OK
Office	142	Floor	1	143	130	0	0	OK
Rph Office	143	Floor	1	149	130	0	0	OK
Rph Office	144	Floor	9	139	130	0	0	OK
Rph Office	145	Floor	19	147	118	0	0	OK
Rph Office	146	Floor	13	143	118	0	0	OK
Hallway	147	Floor	28	135	120	0	0	OK
Office	148	Floor	19	142	120	0	0	OK
Office	149	Floor	12	143	160	0	0	OK
Office	150	Floor	9	167	170	1	1	OK
Office	151	Floor	17	192	170	1	1	OK
Office	152	Floor	11	191	172	3	3	OK
Office	153	Floor	6	190	172	3	3	OK
Hallway	154	Floor	3	211	172	3	3	OK
Conference	155	Floor	2	170	160	0	0	OK
Conference	156	Floor	5	172	160	0	0	OK
Conference	157	Floor	3	151	170	1	1	OK
Conference	158	Floor	13	119	170	1	1	OK
Storage	159	Floor	12	114	170	1	1	OK
Storage	160	Floor	8	108	160	0	0	OK
Storage	161	Floor	5	131	130	0	0	OK
Storage	162	Floor	3	151	130	0	0	OK
Storage	163	Floor	10	140	130	0	0	OK
Storage	164	Floor	26	139	170	1	1	OK
Storage	165	Floor	33	133	170	1	1	OK
Storage	166	Floor	22	131	160	0	0	OK
Bathroom	167	Floor	14	126	160	0	0	OK
Storage	168	Floor	15	134	170	1	1	OK

Area on Map		Location surveyed	Area Survey 44-38	Contamination Survey 44-89	Wipe (gross cpm)	Wipe (net cpm)	Wipe (dpm)	Flags
Description	Loc#		μ R/h	cpm				
Storage	169	Floor	20	143	160	0	0	OK
Storage	170	Floor	19	131	160	0	0	OK
Storage	171	Floor	18	135	160	0	0	OK

Restricted Area Wipes

SCA Serial Number: 101364

Efficiency Date: 04/26/05

Window: 20-400

Efficiency: 89.47% c/d for Ba-133

Count time (minutes): 1.0 minute

Background (cpm): 169 cpm

MDA (dpm): 71 dpm

Area on Map		Location surveyed	Area Survey 44-38	Contamination Survey 44-89	Wipe (gross cpm)	Wipe (net cpm)	Wipe (dpm)	Flags
Description	Loc#		μ R/h	cpm				
Background			18	160	154	0	0	OK
Hot Lab	1	Floor	3	138	154	0	0	OK
Hot Lab	2	Floor	9	144	154	0	0	OK
Hot Lab	3	Floor	9	206	154	0	0	OK
Hot Lab	4	Floor	21	207	154	0	0	OK
Hot Lab	5	Floor	19	179	156	0	0	OK
Hot Lab	6	Floor	15	166	160	0	0	OK
Hot Lab	7	Floor	10	139	162	0	0	OK
Hot Lab	8	Floor	6	166	162	0	0	OK
Hot Lab	9	Floor	3	198	162	0	0	OK
Hot Lab	10	Floor	15	170	162	0	0	OK
Hot Lab	11	Floor	10	146	162	0	0	OK
Hot Lab	12	Floor	10	150	162	0	0	OK
Hot Lab	13	Floor	15	187	162	0	0	OK
Hot Lab	14	Floor	26	161	174	5	6	OK
Hot Lab	15	Floor	19	167	176	7	8	OK
Hot Lab	16	Floor	17	141	162	0	0	OK
Hot Lab	17	Floor	18	136	178	9	10	OK
Hot Lab	18	Floor	15	126	160	0	0	OK
Hot Lab	19	Floor	8	146	156	0	0	OK
Hot Lab	20	Floor	9	130	156	0	0	OK
Hot Lab	21	Floor	10	132	172	3	3	OK
Hot Lab	22	Floor	10	158	160	0	0	OK
Hot Lab	23	Floor	8	176	148	0	0	OK
Hot Lab	24	Floor	8	159	166	0	0	OK
Hot Lab	25	Floor	11	161	168	0	0	OK
Hot Lab	26	Floor	6	172	172	3	3	OK
Hot Lab	27	Floor	7	157	170	1	1	OK
Hot Lab	28	Floor	19	139	160	0	0	OK
Hot Lab	29	Floor	19	157	160	0	0	OK
Hot Lab	30	Floor	18	167	166	0	0	OK
Hot Lab	31	Floor	25	164	174	5	6	OK
Hot Lab	32	Floor	28	216	164	0	0	OK
Hot Lab	33	Floor	19	154	160	0	0	OK
Hot Lab	34	Floor	14	157	148	0	0	OK
Hot Lab	35	Floor	18	196	140	0	0	OK
Hot Lab	36	Floor	12	204	156	0	0	OK
Hot Lab	37	Floor	10	170	155	0	0	OK
Hot Lab	38	Floor	12	161	167	0	0	OK

Area on Map		Location surveyed	Area Survey 44-38 μR/h	Contamination Survey 44-89 cpm	Wipe (gross cpm)	Wipe (net cpm)	Wipe (dpm)	Flags
Description	Loc#							
Hot Lab	39	Floor	12	199	158	0	0	OK
Hot Lab	40	Floor	13	197	162	0	0	OK
Hot Lab	41	Floor	13	212	174	5	6	OK
Hot Lab	42	Floor	10	212	160	0	0	OK
Hot Lab	43	Floor	12	186	172	3	3	OK
Hot Lab	44	Floor	8	220	172	3	3	OK
Hot Lab	45	Floor	5	184	172	3	3	OK
Hot Lab	46	Floor	3	172	160	0	0	OK
Hot Lab	47	Floor	7	151	169	0	0	OK
Hot Lab	48	Floor	5	138	171	2	2	OK
Hot Lab	49	Floor	7	145	150	0	0	OK
Hot Lab	50	Floor	22	143	164	0	0	OK
Hot Lab	51	Floor	20	159	148	0	0	OK
Hot Lab	52	Floor	15	184	168	0	0	OK
Hot Lab	53	Floor	15	163	160	0	0	OK
Hot Lab	54	Floor	17	185	160	0	0	OK
Hot Lab	55	Floor	12	172	168	0	0	OK
Hot Lab	56	Floor	16	161	172	3	3	OK
Hot Lab	57	Floor	15	151	140	0	0	OK
Hot Lab	58	Floor	15	149	158	0	0	OK
Hot Lab	59	Floor	7	150	170	1	1	OK
Hot Lab	60	Floor	14	167	164	0	0	OK
Hot Lab	61	Floor	9	141	164	0	0	OK
Hot Lab	62	Floor	10	143	158	0	0	OK
Hot Lab	63	Floor	6	142	160	0	0	OK
Hot Lab	64	Floor	11	167	160	0	0	OK
Hot Lab	65	Floor	16	176	168	0	0	OK
Hot Lab	66	Floor	14	178	173	4	4	OK
Hot Lab	67	Floor	19	168	146	0	0	OK
Hot Lab	68	Floor	14	170	148	0	0	OK
Hot Lab	69	Floor	10	160	152	0	0	OK
Hot Lab	70	Floor	5	247	158	0	0	OK
Hot Lab	71	Floor	3	248	156	0	0	OK
Hot Lab	72	Floor	2	181	170	1	1	OK
Hot Lab	73	Floor	6	152	160	0	0	OK
Hot Lab	74	Floor	12	156	170	1	1	OK
Hot Lab	75	Floor	13	162	160	0	0	OK
Hot Lab	76	Floor	7	161	162	0	0	OK
Hot Lab	77	Floor	4	190	160	0	0	OK
Hot Lab	78	Floor	26	165	160	0	0	OK
Hot Lab	79	Floor	16	182	162	0	0	OK
Hot Lab	80	Floor	14	154	160	0	0	OK
Hot Lab	81	Floor	15	170	168	0	0	OK
Hot Lab	82	Floor	16	143	170	1	1	OK
Hood Room	83	Floor	23	128	174	5	6	OK
Hood Room	84	Floor	13	158	160	0	0	OK
Hood Room	85	Floor	26	144	166	0	0	OK

Area on Map		Location surveyed	Area Survey 44-38	Contamination Survey 44-89	Wipe (gross cpm)	Wipe (net cpm)	Wipe (dpm)	Flags
Description	Loc#		μ R/h	cpm				
Shipping	86	Floor	17	133	162	0	0	OK
Shipping	87	Floor	9	120	170	1	1	OK
Shipping	88	Floor	6	134	169	0	0	OK
Hood Room	89	Floor	4	152	171	2	2	OK
Hood Room	90	Floor	6	175	170	1	1	OK
Hood Room	91	Floor	4	160	160	0	0	OK
Hood Room	92	Floor	6	172	168	0	0	OK
Shipping	93	Floor	13	162	158	0	0	OK
Shipping	94	Floor	13	134	152	0	0	OK
Shipping	95	Floor	7	106	160	0	0	OK
Hood Room	96	Floor	17	147	160	0	0	OK
Hood Room	97	Floor	14	155	170	1	1	OK
Hood Room	98	Floor	15	161	158	0	0	OK
Hood Room	99	Floor	12	165	160	0	0	OK
Shipping	100	Floor	19	151	160	0	0	OK
Shipping	101	Floor	10	183	168	0	0	OK
Shipping	102	Floor	7	210	154	0	0	OK
Storage	103	Floor	6	193	168	0	0	OK
Storage	104	Floor	4	163	150	0	0	OK
Storage	105	Floor	2	171	170	1	1	OK
Storage	106	Floor	6	177	164	0	0	OK
Shipping	107	Floor	31	240	166	0	0	OK
Shipping	108	Floor	14	263	167	0	0	OK
Shipping	109	Floor	23	210	172	3	3	OK
Storage	110	Floor	15	169	164	0	0	OK
Storage	111	Floor	12	180	148	0	0	OK
Storage	112	Floor	10	149	160	0	0	OK
Storage	113	Floor	5	184	163	0	0	OK
Shipping	114	Floor	7	183	168	0	0	OK
Shipping	115	Floor	4	179	142	0	0	OK
Shipping	116	Floor	2	215	149	0	0	OK
Storage	117	Floor	11	187	170	1	1	OK
Storage	118	Floor	6	194	162	0	0	OK
Storage	119	Floor	10	176	169	0	0	OK
Storage	120	Floor	6	137	153	0	0	OK
Shipping	121	Floor	4	129	171	2	2	OK
Shipping	122	Floor	13	122	163	0	0	OK
Shipping	123	Floor	13	139	170	1	1	OK
Storage	124	Floor	9	135	171	2	2	OK
Storage	125	Floor	9	146	166	0	0	OK
Storage	126	Floor	16	173	157	0	0	OK
Storage	127	Floor	11	193	160	0	0	OK
Shipping	128	Floor	7	168	165	0	0	OK
Shipping	129	Floor	10	173	171	2	2	OK
Shipping	130	Floor	11	150	164	0	0	OK

Residual Activities

The table below includes all isotopes used at the facility over the span of the licensed activities. Sealed sources are not included since no source has ever been determined to be leaking over the lifetime of the facility.

A thorough wipe survey of the facility's restricted area was performed on 4/26/05. No contamination was discovered above the MDA (minimum detectable activity) for this counting system, which was $3.20\text{E-}5 \mu\text{Ci}$. A conservative residual activity estimate of $1.00\text{E-}4 \mu\text{Ci}$ was therefore made for all isotopes previously handled in this facility. Those activities were then divided by the lowest ALI values, and the fractions summated.

Isotope	Residual Activity (μCi)	ALI ^a (μCi)	Fraction of ALI Value ^b
Cr-51	1.00E-04	4.00E+04	2.50E-09
Ga-67	1.00E-04	7.00E+03	1.43E-08
In-111	1.00E-04	4.00E+03	2.50E-08
I-123	1.00E-04	3.00E+03	3.33E-08
I-131	1.00E-04	3.00E+01	3.33E-06
Mo-99	1.00E-04	1.00E+03	1.00E-07
Sm-153	1.00E-04	2.00E+03	5.00E-08
Sr-89	1.00E-04	5.00E+02	2.00E-07
Tc-99m	1.00E-04	8.00E+04	1.25E-09
Tl-201	1.00E-04	2.00E+04	5.00E-09
Xe-133	1.00E-04	2.00E+04	5.00E-09
Sum of Fractions^c			3.77E-06

^a Values taken from 10CFR20 Appendix B.

^b Residual Activity/Appendix B Value

^c Σ Fraction of Appendix B Values

ALI fraction: 3.77E-06
Multiplied by TEDE per ALI: 5000 mrem
Total dose to public: **0.019 mrem**

ATTACHMENT C

Certificate of Disposition of Materials

Surveyor Certification

LICENSEE NAME AND ADDRESS	LICENSE NUMBER	DOCKET NUMBER
	LICENSE EXPIRATION DATE	

This license has expired. This license has not yet expired; please terminate it.

A. LICENSE STATUS (Check the appropriate box)

B. DISPOSAL OF RADIOACTIVE MATERIAL

(Check the appropriate boxes and complete as necessary. If additional space is needed, provide attachments)

The licensee, or any individual executing this certificate on behalf of the licensee, certifies that:

1. No radioactive materials have ever been procured or possessed by the licensee under this license.

2. All activities authorized by this license have ceased, and all radioactive materials procured and/or possessed by the licensee under this license number cited above have been disposed of in the following manner:

a. Transfer of radioactive materials to the licensee listed below:

b. Disposal of radioactive materials:

1. Directly by the licensee:

2. By licensed disposal site:

3. By waste contractor:

c. All radioactive materials have been removed such that any remaining residual radioactivity is within the limits of 10 CFR Part 20, Subpart E, and is ALARA.

C. SURVEYS PERFORMED AND REPORTED

1. A radiation survey was conducted by the licensee. The survey confirms:

a. the absence of licensed radioactive materials

b. that any remaining residual radioactivity is within the limits of 10 CFR 20, Subpart E, and is ALARA.

2. A copy of the radiation survey results:

a. is attached; or b. is not attached (Provide explanation); or c. was forwarded to NRC on: _____ Date _____

3. A radiation survey is not required as only sealed sources were ever possessed under this license, and

a. The results of the latest leak test are attached; and/or b. No leaking sources have ever been identified.

The person to be contacted regarding the information provided on this form:

NAME <i>Bryon A. Alfrey</i>	TITLE <i>Pharmacy Manager</i>	TELEPHONE (Include Area Code) <i>804-522-1317</i>	E-MAIL ADDRESS <i>bryon.alfrey@cardinal.com</i>
--------------------------------	----------------------------------	--	--

Mail all NRC correspondence regarding this license to:

C. CERTIFYING OFFICIAL

I CERTIFY UNDER PENALTY OF PERJURY THAT THE FOREGOING IS TRUE AND CORRECT

PRINTED NAME AND TITLE <i>Bryon Alfrey Pharmacy Manager</i>	SIGNATURE <i>Bryon A. Alfrey</i>	DATE <i>4/29/05</i>
--	-------------------------------------	------------------------

WARNING: FALSE STATEMENTS IN THIS CERTIFICATE MAY BE SUBJECT TO CIVIL AND/OR CRIMINAL PENALTIES. NRC REGULATIONS REQUIRE THAT SUBMISSIONS TO THE NRC BE COMPLETE AND ACCURATE IN ALL MATERIAL RESPECT. 18 U.S.C. SECTION 1001 MAKES IT A CRIMINAL OFFENSE TO MAKE A WILLFULLY FALSE STATEMENT OR REPRESENTATION TO ANY DEPARTMENT OR AGENCY OF THE UNITED STATES AS TO ANY MATTER WITHIN ITS JURISDICTION.

Surveyor Certification

Surveyor: **Byron A. Alfrey** Pharmacy Manager/RSO
Authorized User, License No. 5485
Cardinal Health
Nuclear Pharmacy Services

Survey Location: **449 Adams Ave., Suite #1**
Huntington, WV 25701

Survey Date: 04-26-05

Certification Statements:

1. All non-exempt radioactive material and waste was removed from the facility prior to performing the decommission surveys.
2. A gross search for radioactive material was performed and no material was present.
3. The background radiation levels measured at several locations in the non-impacted area of the facility measured 0.03 mR/hr, therefore the readings listed as "Survey gross mR/h" in the closeout survey data form are background at all locations measured in the impacted area of the facility.
4. The wipe test results on the Closeout Survey data sheet are shown in dpm per 100 cm². All wipe measurement results were less than the MDA and less than 200 dpm per 100 cm².

I certify the above data and statements to be true.

Print: Byron A. Alfrey

Sign:

Byron A. Alfrey

Date:

4/29/05

ATTACHMENT D

SEALED SOURCE TRANSFER LOG

DATE OF TRANSFER: 02-05-05

TRANSFER FROM: Cardinal Health Location # 2225
Formerly Tri State Area Nuclear Pharmacy
449 Adams Ave., Suite #1
Huntington, WV 25701

TRANSFER TO: Cardinal Health Location # 109
1 Syncor Dr.
Huntington, WV 25705

Nuclide	Type	Serial Number	Assay Activity	Assay Date	Leak Test Date	Leak Test Results* (Pass/Fail)
Ba-133	E-vial	CK910	264 uCi	09-02-92	02-05-05	Pass
Ba-133	Rod	DH125	90.5 nCi	01-20-93	02-05-05	Pass
Ba-133	Rod	32425	115.6 nCi	01-01-03	02-05-05	Pass
Cs-137	E-vial	DA375	364 uCi	09-14-92	02-05-05	Pass
Cs-137	Rod	35854	116.0 nCi	04-01-03	02-05-05	Pass
Co-57	E-vial	48467	5099 uCi	02-01-04	02-05-05	Pass
Co-57	Rod	GE947	107.8 nCi	10-08-98	02-05-05	Pass
Co-57	Rod	36096	116.0 nCi	05-01-03	02-05-05	Pass

*Pass=Removable contamination less than 0.005 uCi.



RSO Signature

Byron A. Alfrey

Print Name

Radiation Safety Officer

ORIGIN ID: JTOA (818) 737-4450
CARLOS CISNERO
CARDINAL HEALTH
6464 CANOGA AVE.

Ship Date: 12MAY05
Actual Wgt: 1.0 LB MAN
System#: 0733970/CAFE2246
Account: 6 *****

WOODLAND HILLS, CA 91367
UNITED STATES US

TO U.S. NUCLEAR REGULATORY COMMISSION
REGION 1 OFFICE
475 ALLENDALE ROAD

FedEx
Express

KING OF PRUSSIA, PA 194061415



REF: 4218

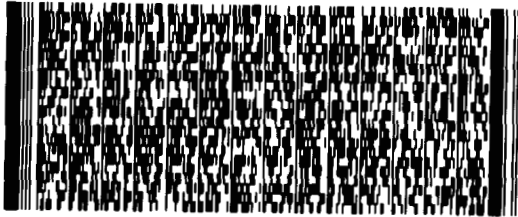

Delivery Address
Barcode

BILL SENDER

Th

ME

** 2DAY **

MON

Deliver By:
16MAY05

TRK# 8605 1761 7253 Form 0201

PHL A2

Part # 156146-434 NHITA 1/2 04:
19406 -PA-US

SF KPDA

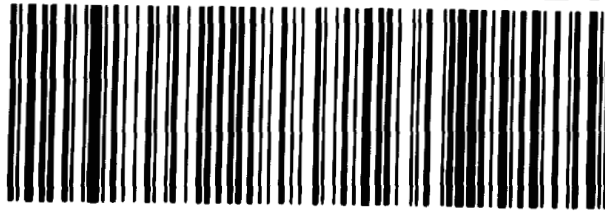

137043

This is to acknowledge the receipt of your letter/application dated

5/12/2005, and to inform you that the initial processing which includes an administrative review has been performed.

TEAM 04-26507-01MD
There were no administrative omissions. Your application was assigned to a technical reviewer. Please note that the technical review may identify additional omissions or require additional information.

Please provide to this office within 30 days of your receipt of this card

A copy of your action has been forwarded to our License Fee & Accounts Receivable Branch, who will contact you separately if there is a fee issue involved.

Your action has been assigned **Mail Control Number** 137043.
When calling to inquire about this action, please refer to this control number.
You may call us on (610) 337-5398, or 337-5260.

NRC FORM 532 (RI)
(6-96)

Sincerely,
Licensing Assistance Team Leader

BETWEEN: : (FOR LFMS USE)
 : INFORMATION FROM LTS
 : -----
 :
 License Fee Management Branch, ARM : Program Code: 02500
 and : Status Code: 0
 Regional Licensing Sections : Fee Category: 3C 3P 2B
 : Exp. Date: 20110831
 : Fee Comments: 3P = SERVICE FOR OTHERS
 : Decom Fin Assur Reqd: N
 : ::

LICENSE FEE TRANSMITTAL

A. REGION I

1. APPLICATION ATTACHED
 Applicant/Licensee: CARDINAL HEALTH
 Received Date: 20050512
 Docket No: 3033224
 Control No.: 137043
 License No.: 04-26507-01MD
 Action Type: Termination

2. FEE ATTACHED
 Amount: /
 Check No.: /

3. COMMENTS

Signed M. A. Perlino
 Date 5/17/2005

B. LICENSE FEE MANAGEMENT BRANCH (Check when milestone 03 is entered /_/)

1. Fee Category and Amount: _____

2. Correct Fee Paid. Application may be processed for:
 Amendment _____
 Renewal _____
 License _____

3. OTHER _____

Signed _____
 Date _____