



BON SECOURS COTTAGE HEALTH SERVICES



**CONFIDENTIAL**  
**PATIENT HEALTH INFORMATION ENCLOSED**

Health Information is personal and sensitive information related to a person's health care. It is being faxed to you after appropriate authorization from the patient or under circumstances that don't require patient authorization. You, the recipient, are obligated to maintain it in a safe, secure and confidential manner. Re-disclosure without additional patient consent or as permitted by law prohibited. Unauthorized re-disclosure or failure to maintain confidentiality could subject you to penalties described in federal and state law.

Date: Oct 8, 04 # of pages sent including cover sheet: \_\_\_\_\_  
Time: 14:05 Fax Number: 630-515-1259  
To: Patty Poike Recipient's Phone Number: \_\_\_\_\_

**NOTIFY BSCHS IMMEDIATELY WITH ANY CHANGES TO YOUR FAX #**

FROM: Bon Secours Cottage Health Services  
Medical Record Department (Bon Secours Campus)  
468 Cadieux Rd.  
Grosse Pointe, MI 48230  
313-343-1625

Sender: Gary Stoykovich Fax Number: 313-886-3028

Message: Please accept document folder  
for the Certificate of Disposition of Materials  
Thank you!

Gary Stoykovich  
SITE MAN

**IMPORTANT WARNING:**

This message is intended for the use of the person or entity to which it is addressed and may contain information that is privileged and confidential, the disclosure of which is governed by applicable law. If the reader of this message is not the intended recipient, or the employee or agent responsible to deliver it to the intended recipient, you are hereby notified that any dissemination, distribution or copying of this information is **STRICTLY PROHIBITED**. If you have received this message by error, please notify us immediately and return or destroy the documents received.

<b>NRC FORM 314</b> (7-2001) 10 CFR 30.380(k); 40.420(k); 70.380(k); and 72.540(k)	<b>U.S. NUCLEAR REGULATORY COMMISSION</b>	<b>APPROVED BY OMB: NO. 3150-0028</b> <b>EXPIRES: 07/31/2004</b> <small>Estimated burden per response to comply with this mandatory collection request: 30 minutes.          This material is used by NRC as part of the basis for its determination that the facility is released for unrestricted use. Send comments regarding burden estimate to the Records Management Branch (T-5 E6), U.S. Nuclear Regulatory Commission, Washington, DC 20555-0001, or by internet e-mail to <a href="mailto:hs1@nrc.gov">hs1@nrc.gov</a>, and to the Desk Officer, Office of Information and Regulatory Affairs, NE08-10202, (3150-0028), Office of Management and Budget, Washington, DC 20503. If a means used to impose an information collection does not display a currently valid OMB control number, the NRC may not conduct or sponsor, and a person is not required to respond to, the information collection.</small>
<b>CERTIFICATE OF DISPOSITION OF MATERIALS</b>		
<b>LICENSEE NAME AND ADDRESS</b> Bon Secours Cottage Health Diagnostic Center 21400 Eleven Mile Rd. St Clair Shores, Michigan	<b>LICENSE NUMBER</b> 21-16868-01	<b>DOCKET NUMBER</b>  
<b>LICENSE EXPIRATION DATE</b> October 31, 2011		
<input type="checkbox"/> This license has expired. <input checked="" type="checkbox"/> <b>A. LICENSE STATUS (Check the appropriate box)</b> This license has not yet expired; please terminate it.		
<b>B. DISPOSAL OF RADIOACTIVE MATERIAL</b>		
(Check the appropriate boxes and complete as necessary. If additional space is needed, provide attachments) The licensee, or any individual executing this certificate on behalf of the licensee, certifies that:		
<input type="checkbox"/> 1. No radioactive materials have ever been procured or possessed by the licensee under this license.		
<input checked="" type="checkbox"/> 2. All activities authorized by this license have ceased, and all radioactive materials procured and/or possessed by the licensee under this license number cited above have been disposed of in the following manner:		
<input checked="" type="checkbox"/> a. Transfer of radioactive materials to the licensee listed below:		
<input type="checkbox"/> b. Disposal of radioactive materials:		
<input type="checkbox"/> 1. Directly by the licensee:		
<input type="checkbox"/> 2. By licensed disposal site:		
<input type="checkbox"/> 3. By waste contractor:		
<input type="checkbox"/> c. All radioactive materials have been removed such that any remaining residual radioactivity is within the limits of 10 CFR Part 20, Subpart E, and is ALARA.		
<b>C. SURVEYS PERFORMED AND REPORTED</b>		
<input checked="" type="checkbox"/> 1. A radiation survey was conducted by the licensee. The survey confirms:		
<input type="checkbox"/> a. the absence of licensed radioactive materials		
<input checked="" type="checkbox"/> b. that any remaining residual radioactivity is within the limits of 10 CFR 20, Subpart E, and is ALARA.		
<input checked="" type="checkbox"/> 2. A copy of the radiation survey results:		
<input checked="" type="checkbox"/> a. is attached; or <input type="checkbox"/> b. is not attached (Provide explanation); or <input checked="" type="checkbox"/> c. was forwarded to NRC on: <u>8/13/04</u>		
<input type="checkbox"/> 3. A radiation survey is not required as only sealed sources were ever possessed under this license, and		
<input type="checkbox"/> a. The results of the latest leak test are attached; and/or <input type="checkbox"/> b. No leaking sources have ever been identified.		
<b>The person to be contacted regarding the information provided on this form:</b>		
<b>NAME</b> Laura T. Smith, MS	<b>TITLE</b> Physicist	<b>TELEPHONE (Include Area Code)</b> 586 215 5947 586 716 8885
<b>E-MAIL ADDRESS</b>  		
Mail all future correspondence regarding this license to:		
<b>I CERTIFY UNDER PENALTY OF PERJURY THAT THE FOREGOING IS TRUE AND CORRECT</b>		
<b>PRINTED NAME AND TITLE</b> RICHARD G. WATSON, D.O.	<b>SIGNATURE</b> Richard G. Watson	<b>DATE</b> 10-6-04
<b>WARNING: FALSE STATEMENTS IN THIS CERTIFICATE MAY BE SUBJECT TO CIVIL AND/OR CRIMINAL PENALTIES. NRC REGULATIONS REQUIRE THAT SUBMISSIONS TO THE NRC BE COMPLETE AND ACCURATE IN ALL MATERIAL RESPECT. 18 U.S.C. SECTION 1001 MAKES IT A CRIMINAL OFFENSE TO MAKE A WILLFULLY FALSE STATEMENT OR REPRESENTATION TO ANY DEPARTMENT OR AGENCY OF THE UNITED STATES AS TO ANY MATTER WITHIN ITS JURISDICTION.</b>		

August 13, 2004

Nuclear Regulatory Commission  
Region III  
Materials Licensing Branch  
801 Warrenville Road  
Lisle, IL 60532-4351

RE: Licenses Amendments for #21-16868-01 and 21-1642501

This letter is to notify you of the decommission of the Bon Secours Cottage Diagnostic Center Nuclear facility located at, 21400 Eleven Mile Road, St. Clair Shores, Michigan. The decommission was performed by Laura T. Smith MS, DABR, on July 23, 2004 – see attached.

The second request of this letter is for a license amendment to combine licenses #21-16425-01 (Bon Secours Cottage Health Services) into license #21-16868-01 (Bon Secours Cottage Health Services). The 21-16868-01 license should be the primary license, incorporating the secondary 21-16425-01. Both licenses are under the same management, administration and ownership.

Dr. Richard Walton will remain the RSO at both site and please merge so there is assurance of the completion of Authorized Users from both site on the single license.

If there are any questions regarding please contact Laura T. Smith, at 586-716-8885 or cell phone 586 215-5947, or me Gary Stoykovich of Bon Secours Cottage Health at 313 640-2182.

Sincerely,

A handwritten signature in black ink, appearing to read "Richard Walton", with a stylized flourish at the end.

Richard Walton  
Radiation Safety Officer

*Handwritten signature: J. Smith*

**Radiological Physics Service, Inc.**

**3839 Napier Road – Plymouth, Michigan 48170 (734) 455-4730 fax: (734) 453-8851**

Date: July 26, 2004

RE: Bon Secours Cottage Diagnostic Center – SCS  
21400 11 Mile Road, St Clair Shores, MI 48081, Close-out Survey

A close-out survey for the Nuclear facility located Bon Secours Cottage Diagnostic Center - SCS was performed by Laura T. Smith MS, DABR, on July 23, 2004. Tc-99m and Tl-201 were the only indicated isotopes ever used for the facility. All surveys and wipes tests were proven to be below background measurements. It is noted that no radioactive material patients were injected at this facility since 6/8/2004.

The following decommission methodology was performed:

1. A comprehensive survey of the entire Nuclear Medicine Imaging/Hot Lab Area and Stress Lab area was performed using a Geiger Muller end window survey meters. A battery, background, check-source, survey method was used, at the most sensitive setting. All survey results proved to be at or below background measurements (Background = 0.03 mR/Hr). A map of the area is attached. The following meter were used:

a. Biodex 14C #051-014 SN 141921

Special survey attention was noted to Hot Lab area, trash containers, keyboards, phone, treadmill, EKG machine, desk, patient tables, floor, door knobs, light switches and a countertops.

2. Wipe tests were performed on fourteen locations (indicated on attached map). Wipe tests were counted per departmental wipe test procedures in Capintec Caprac Well counter. All wipe tests results were proven to be below background measurements. Special survey attention was noted to Hot Lab area, trash containers, keyboards, phone, treadmill, EKG machine, desk, patient tables, floor, door knobs, light switches and a countertops.

3. Waste Disposal of syringes survey at 0.02 mR/hour, with the Biodex GM meters, Background = 0.03 mR/Hr. The sharpe container waste receptacle was demarcated, documented in log book and disposed of in the Facilities Biomedical Waste receptacle.

4. All of the departments nine sealed sources (including the spot source on the meter -- see attached list) were accounted for and wipe tested. All sealed sources were below background levels. All sealed sources were then transferred to Cottage Hospital, (License # 21-16425-01) which is affiliated with the Bon Secours Cottage Health System.

Map is attached

1. Hot Lab – Dose Prep Area Floor = -142 cpm = 0
2. Hot Lab – Dose Prep Area Countertop = -190 cpm = 0
3. Hot Lab - Radioactive storage Area = -280 cpm = 0
4. Hot Lab – Floor = -199cpm = 0
5. Hot Lab - Injection Stand, Chair and Countertop = -196cpm = 0
6. Imaging Room Camera and Patient Table= -42cpm = 0
7. Imaging Room Computer and Camera Console= -281 cpm = 0
8. Imaging Room Camera Floor = -190 cpm = 0
9. Imaging Room Counter Top= -44cpm = 0
10. Imaging Room Floor= -268 cpm = 0
11. Stress Room -Treadmill and Floor area= -163cpm = 0
12. Stress Room - Patient Table= -226 cpm = 0
13. Stress Romm – EKG and room equipment= -238cpm = 0

This concludes the close-out survey for Bon Secours Cottage Diagnostic Center – SCS  
21400 11 Mile Road, St Clair Shores, MI 48081 Nuclear Facility.

If there are any further questions please contact survey nuclear medical physicist Laura  
T. Smith, MS, DABR at (586) 716-8885 or BSCHS Cottage Radiology manager – Gary  
Stoykovich (313) 640-2182

Sincerely,

Dr. Richard Walton  
BSCHS Radiation Safety Officer

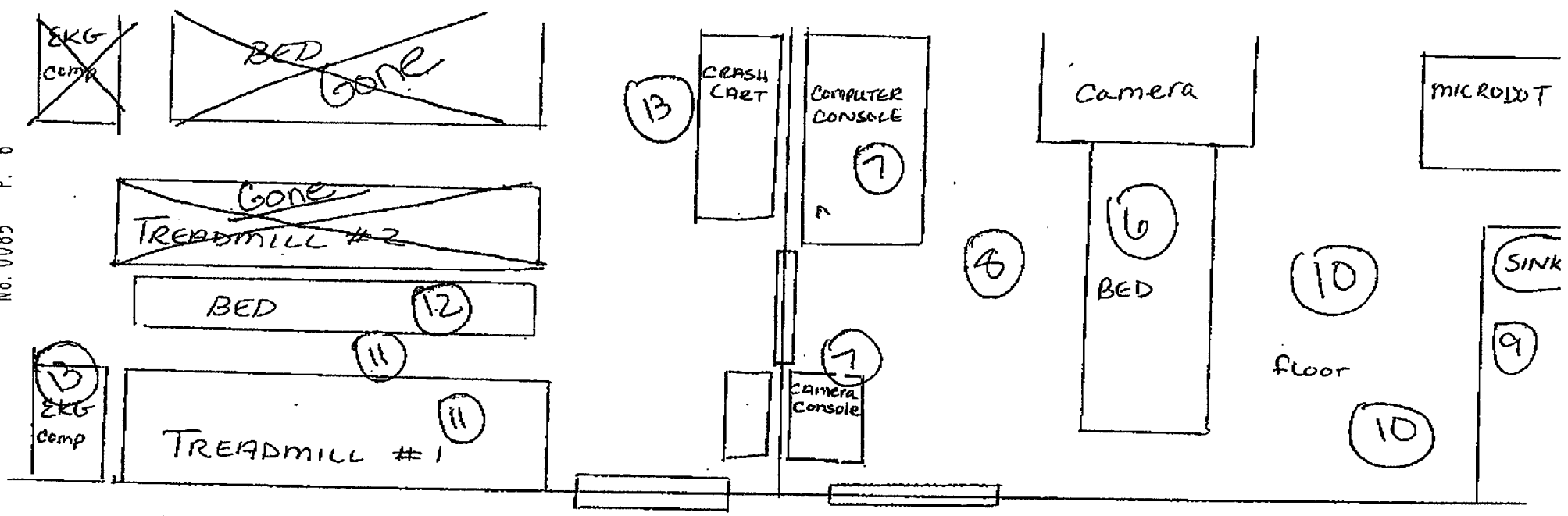

NUCLEAR MEDICINE + STRESS LAB

HOME INFUSION  
NURSES

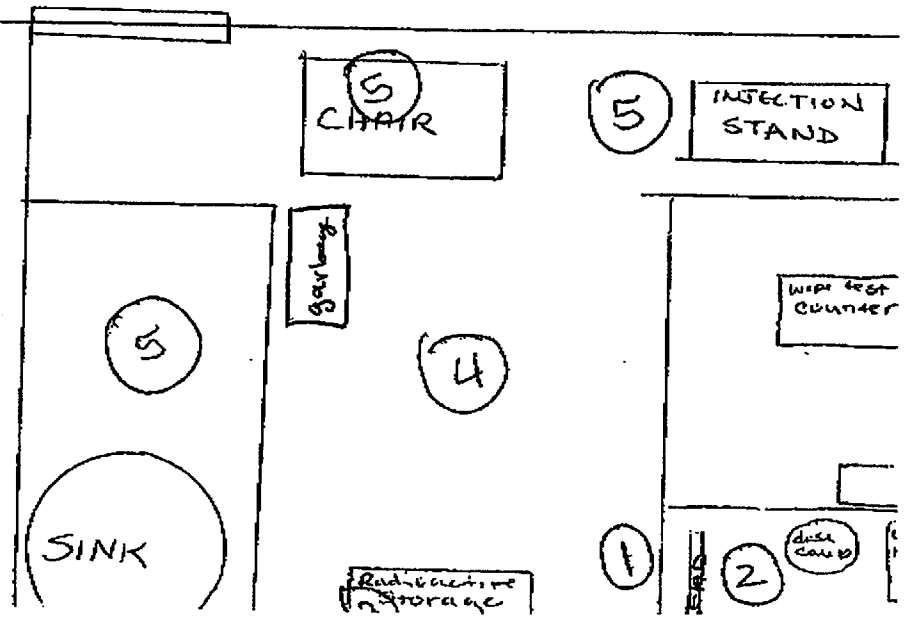

Location: Bon Secours Cottage Diagnostic Center - SCS

Date of Inspection: June 4, 2004

## SEALED SOURCE INVENTORY

Naclide	Type	Location	Calibration Activity	Calibration Date	Mfgr.	M/N	S/N
✓ Co-57	flood	Hot Lab	10 mCi	01/01/03		NES-392	939-164
✓ Cs-137	vial	Hot Lab	276.2 uCi	03/01/83		CDC.VI	3363 MA
✓ Ba-133	vial	Hot Lab	291.3 uCi	08/01/83		BDC.VI	2239 MA
✓ Co-57	flood	Scan	10 mCi	02/28/98		NES-392	S39270904
✓ * Co-57	vial	Storage	10.8 mCi	02/06/98		NES-8206	S8206034003
✓ Cs-137	button	Meter	1 uCi	11/97			3104
✓ Cs-137	<del>button</del>	Hot Lab	500 nCi	04/01/98			587-63-1
✓ Co-57	button	Storage	50 uCi (4)	04/15/97			Lot 56139
✓ Co-57	button	Hot Lab	50 uCi (4)	10/01/00			Lot 710173

\* Placed in storage. Activity too low for valid regulatory accuracy.

RSO: \_\_\_\_\_

7/23/04 275mR Physicist transferred  
all inventory to Cottage # 2116425-01  
MAB