



**CENTRAL VIRGINIA
LABORATORIES & CONSULTANTS, INC.**

November 9, 2004

US Nuclear Regulatory Commission, Region II
Division of Nuclear Materials
61 Forsyth Street, S.W. Suite 23T85
Atlanta, Georgia 30303-8931

Attn.: **Mr. Bryan A. Parker**
Health Physicist

03032741

04 NOV 26 P2:32
RECEIVED
REGION I

RE: Materials License # 45-25198-01

Central Virginia Laboratories & Consultants, Inc. (CVLC) has been conducting toxicity testing at its facility at 503 Central Drive East, Suite 101, Virginia Beach, Virginia 23454, since March of 2003. CVLC has analyzed samples from various DOE facilities. Materials license #45-25198-01 was obtained in the event that any of the DOE samples contained minute amounts of radioactive materials.

Immediately, upon arrival, all such samples were carefully screened with a Geiger Muller system to detect any radioactivity. None of the samples arriving from the DOE showed any indication of radiation above background.

CVLC will no longer be conducting such business at this location as it has made arrangements for another commercial enterprise to take over the operations. It is our intention to have our location released for unrestricted use. Despite the lack of evidence of any radioactive samples entering into the facility, we are supplying NRC Region II a survey of any and all areas they could have been potentially affected to prove the absence of radioactive contamination.

Nelson DaCruz, QA/QC Officer and CVLC Radiation Protection Officer conducted such a survey on October 29, 2004. The attached report contains the results of the survey, which found no evidence of radioactive contamination. CVLC is submitting the report to permit the release of the facility for unrestricted use.

If you have any questions regarding this matter and the report please phone me at (434) 847-2852.

Sincerely,

Adrian K. Mood
President / General Manager

136049

NMSS/RGNI MATERIALS-002

REPORT OF RADIATION SURVEY OF RECEIVING AREA AT
503 Central Drive East, Suite 101, Virginia Beach, VA 23454

Nelson DaCruz

The survey was carried out by Nelson DaCruz on October 29, 2004. A laboratory layout is supplied in Diagram 1.0. The background testing was conducted in the Aquaculture area. The sample receipt area was used for all cooler receipt and was therefore the area measured for radioactivity. (see Diagram 2.1 & 2.2).

Radiation Surveys

The area surveyed were a) the back wall and baseboard, b) two doors and two thresholds, and c) the floor. The wall is plaster stucco, the baseboard is smooth synthetic plastic, the doors are made of wood, and both thresholds are metal.

Scanning Surveys

Scanning dose rate surveys were conducted using a Ludlum Survey Meter (Model 3), with a pancake probe to look for hotspots in the area. The scans were executed at a rate of 5 cm per second. Proper operation of the system was verified periodically by taking a reading of the check source.

Background measurements were taken in a non-impacted area of the facility, 40 feet and two rooms over from the log-in location. Background readings ranged from 0.1 to 0.4 mr/hr. Survey readings varied from 0.1 to 0.4. Ninety-second counts were taken at the pre-determined locations operating in the scalar mode. Response was logged every 5 seconds. Readings are listed below in Chart 1.0 in mr/Hr.

CVLC Laboratory Layout (Diagram 1.0)

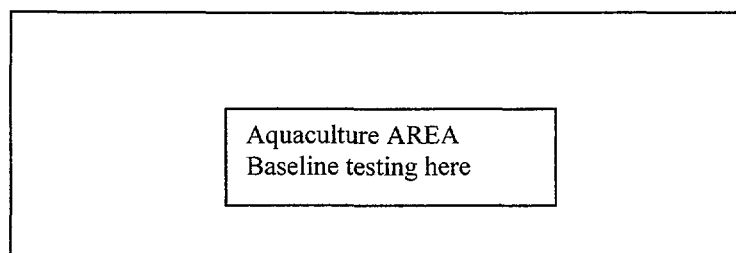

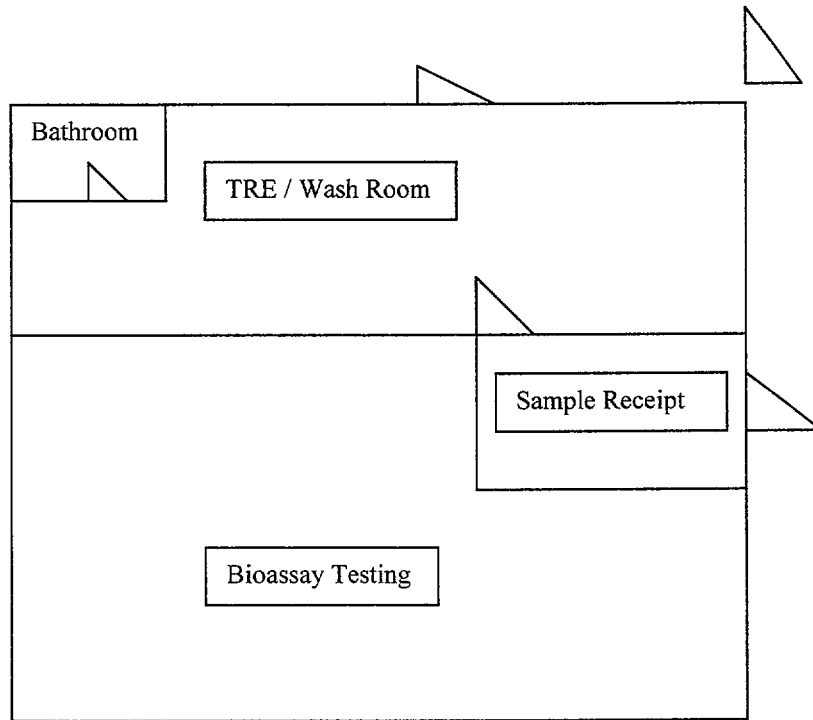

Sample Receipt Area Layout & Sample Points (Diagram 2.1)

Door #1		Wall Area In Sample Receipt				Door # 2	
D10	D11	W1	W2	W3	W4	D20	D21
D12	D13	W5	W6	W7	W8	D22	D23
D14	D15	W9	W10	W11	W12	D24	D25

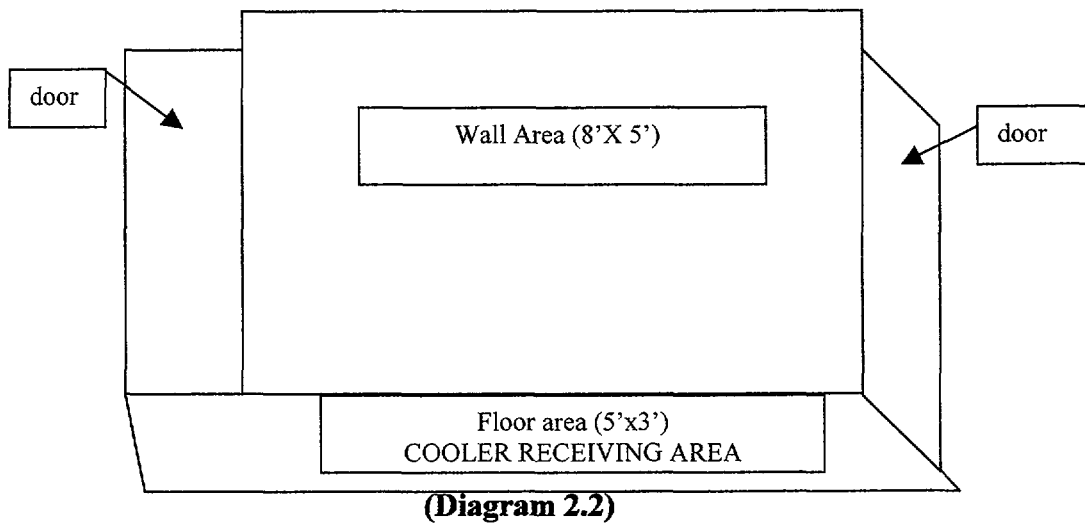
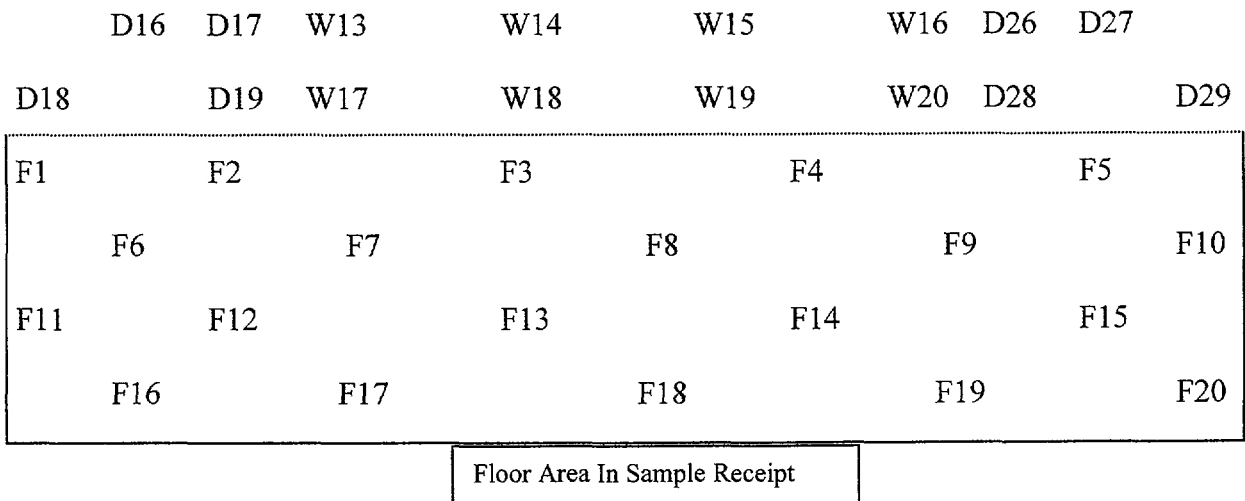

SURVEY RESULTS (mr/Hr)-(Chart-1)

<u>Background Area</u>	<u>Door # 1</u>	<u>Door #2</u>	<u>Wall</u>	<u>Floor</u>
0.1	D10-0.2	D20-0.2	W1-0.1	F1-0.2
0.2	D11-0.3	D21-0.2	W2-0.1	F2-0.2
0.2	D12-0.3	D22-0.2	W3-0.2	F3-0.2
0.2	D13-0.2	D23-0.4	W4-0.3	F4-0.3
0.2	D14-0.2	D24-0.3	W5-0.3	F5-0.3
0.4	D15-0.2	D25-0.3	W6-0.2	F6-0.2
0.2	D16-0.1	D26-0.3	W7-0.2	F7-0.2
0.2	D17-0.3	D27-0.2	W8-0.1	F8-0.1
0.1	D18-0.3	D28-0.2	W9-0.1	F9-0.1
0.2	D19-0.2	D29-0.2	W10-0.2	F10-0.2
			W11-0.1	F11-0.2
			W12-0.1	F12-0.3

W13-0.3 F13-0.1
W14-0.2 F14-0.2
W15-0.2 F15-0.1
W16-0.2 F16-0.2
W17-0.3 F17-0.1
W18-0.3 F18-0.2
W19-0.2 F19-0.2
W20-0.2 F20-0.1

Mean readings (+ 0.2):
0.2 0.23

0.25 0.18 0.185

This is to acknowledge the receipt of your letter/application dated

11/9/2009, and to inform you that the initial processing which includes an administrative review has been performed.

AMEND. 45-25198-01
There were no administrative omissions. Your application was assigned to a technical reviewer. Please note that the technical review may identify additional omissions or require additional information.

Please provide to this office within 30 days of your receipt of this card

A copy of your action has been forwarded to our License Fee & Accounts Receivable Branch, who will contact you separately if there is a fee issue involved.

Your action has been assigned Mail Control Number 136049.
When calling to inquire about this action, please refer to this control number.
You may call us on (610) 337-5398, or 337-5260.

BETWEEN: : (FOR LFMS USE)
 : INFORMATION FROM LTS
 : -----
 :
 License Fee Management Branch, ARM : Program Code: 03225
 and : Status Code: 0
 Regional Licensing Sections : Fee Category: 3P
 : Exp. Date: 20071231
 : Fee Comments: _____
 : Decom Fin Assur Reqd: N
 : ::

LICENSE FEE TRANSMITTAL

A. REGION I

1. APPLICATION ATTACHED
 Applicant/Licensee: CENTRAL VIRGINIA LABS.&CONSULT., INC
 Received Date: 20041126
 Docket No: 3032741
 Control No.: 136049
 License No.: 45-25198-01
 Action Type: Amendment

2. FEE ATTACHED
 Amount: _____
 Check No.: _____

3. COMMENTS

Signed W. A. Perkins
 Date 12/31/04

B. LICENSE FEE MANAGEMENT BRANCH (Check when milestone 03 is entered /___/)

1. Fee Category and Amount: _____

2. Correct Fee Paid. Application may be processed for:
 Amendment _____
 Renewal _____
 License _____

3. OTHER _____

Signed _____
 Date _____