

BENDING SCHED. BY FIELD

MARK	NO.	SIZE	LENGTH	TYPE	A	B	C	D	E	F	G	H	K
5820	6	5	6.4	510	2.3	1.10	2.3						
5821	12	5	6.0	510	2.3	1.6	2.3						
5825	42	5	5.7	510	2.3	1.1	2.3						
5829	24	5	5.7	510	2.3	1.3	2.3						
5830	66	5	5.3	510	2.3	1.2	2.3						
5831	60	5	5.11	510	2.3	1.5	2.3						

PART PLAN AT EL. 656-42  
(REINFORCING SHOWN X 2)

NOTES:  
REFER TO DESIGN DRAWING NO. 1-2 - 5156C, 2156N AND 3156P  
REFER TO BENT AND STRAIGHT BAR LISTS  
RS-2073 SHEETS 1 THRU 8

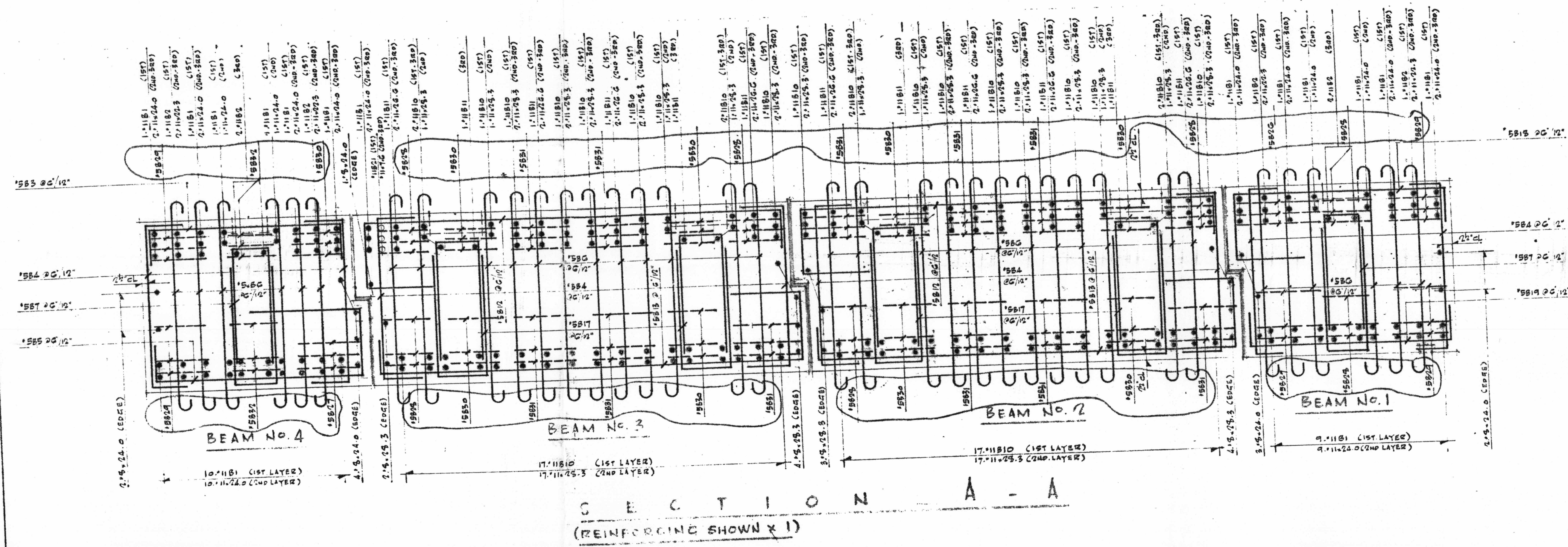

SECTION A-A  
(REINFORCING SHOWN X 1)

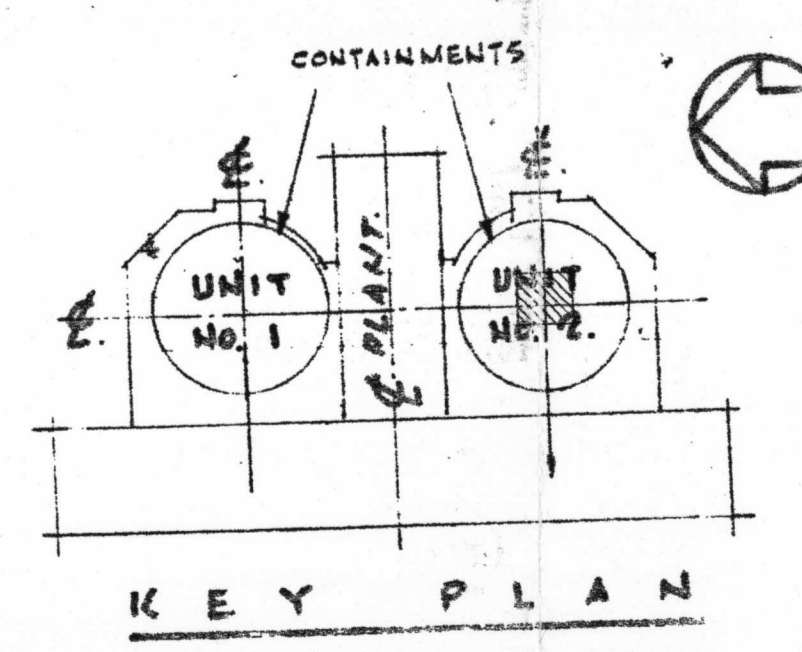

American Electric Power Corp.  
Donald C. Cook Nuclear Plant  
Unit 2 APPROVED IN GENERAL  
Per VDR 84-0008  
BY G.E. Shute / G.E. Shute DATE 3/10/04

Call No. SD-000303 001, Rev. 0  
Attachment 3  
Page 6 of 9

INDIANA & MICHIGAN ELECTRIC CO.  
DONALD C. COOK NUCLEAR PLANT  
BRIDGMAN, MICHIGAN

NO.	DATE	DESCRIPTION	BY	FOR
1	9.14.72	JOB USE		
2	9.8.72	JOB USE		
3	9.30.72	APPROVAL		

United Detailers Inc.  
Structure: DONALD C. COOK NUCLEAR PLANT  
Location: BRIDGMAN, MICHIGAN

Architect: AMERICAN ELECT. POWER SVC. CORP.  
Engineer: AMERICAN ELECT. POWER SVC. CORP.  
Customer: AMERICAN ELECT. POWER SVC. CORP.

Made by: BOOLEY Date: 9.30.72  
Checked by: GR  
Quality of Steel: A315-40  
DRAWING NO.: 2093

REV. NO.	DATE	DESCRIPTION
2	9.19.72	ADDED ANCHOR TIES BY FIELD
1	9.8.72	GEN. ENGR. CORRECT.

UNIT No. 2 CONTAINMENT BLDG.  
MISSILE SHIELD

D02 DC-110153