

BENDING SCHED. BY FIELD

B. C. D.
S10

MARK	No.	SIZE	LENGTH	TYPE	A	B	C	D	E	F	G	H	K
5826	6	5	6.4	S10	2.3	1.0	2.3						
5827	12	5	6.0	S10	2.3	1.6	2.3						
5828	42	5	5.7	S10	2.3	1.1	2.3						
5829	24	5	5.9	S10	2.3	1.3	2.3						
5830	66	5	5.8	S10	2.3	1.2	2.3						
5831	66	5	5.11	S10	2.3	1.5	2.3						

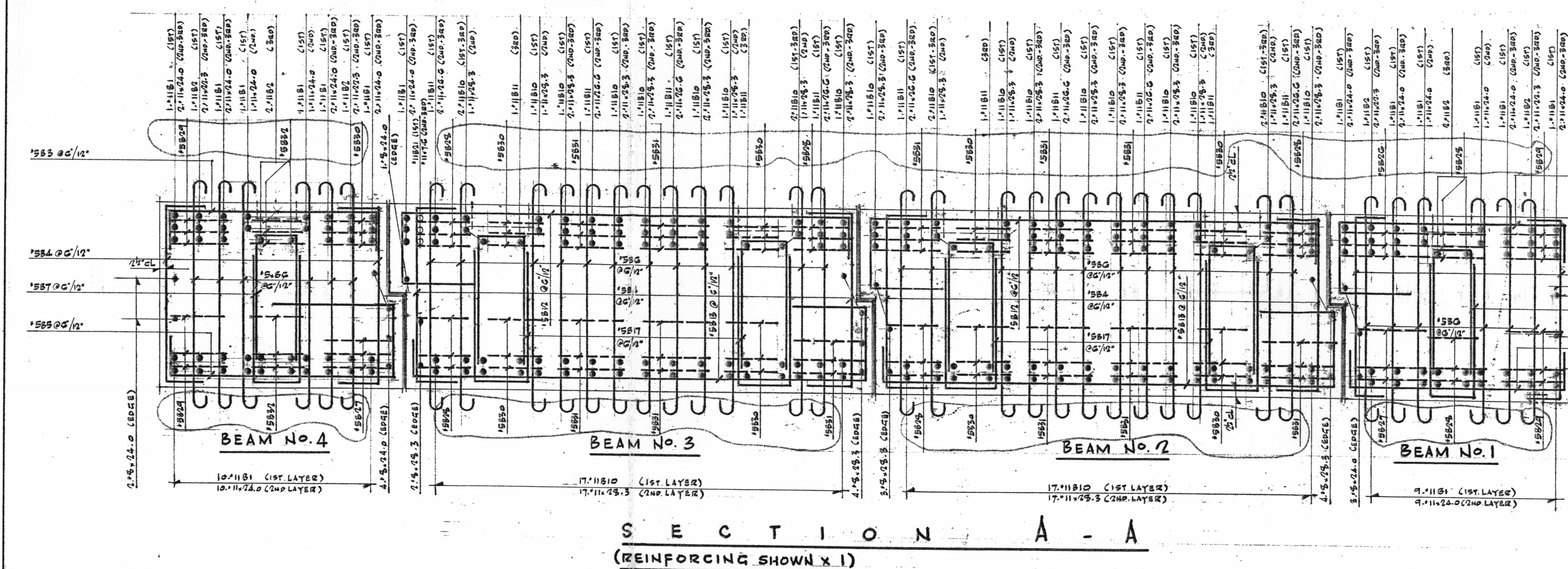

NOTES:
 REFER TO DESIGN DRAWING NO. 1-2 - 51500,
 31504 AND 31507
 REFER TO BENT AND STRAIGHT BAR LISTS
 RS-1095 SHEETS 1 THRU 3

INDIANA & MICHIGAN ELECTRIC CO.
 DONALD C. COOK NUCLEAR PLANT
 BRIDGMAN, MICHIGAN

1	9.19.72	JOB USE
2	9.5.72	JOB USE
3	9.30.72	APPROVAL

United Detailers Inc.
 Structure: DONALD C. COOK NUCLEAR PLANT
 Location: BRIDGMAN - MICHIGAN
 Architect: AMERICAN ELECT. POWER SVC. CORP.
 Engineer: AMERICAN ELECT. POWER SVC. CORP.
 Designer: AMERICAN ELECT. POWER SVC. CORP.

Made by: DOOLEY Date: 9.30.72
 Ckd by: GR

UNIT NO. 1 CONTAINMENT BLOC
 MISSILE SHIELD

DRAWING NO. 1093

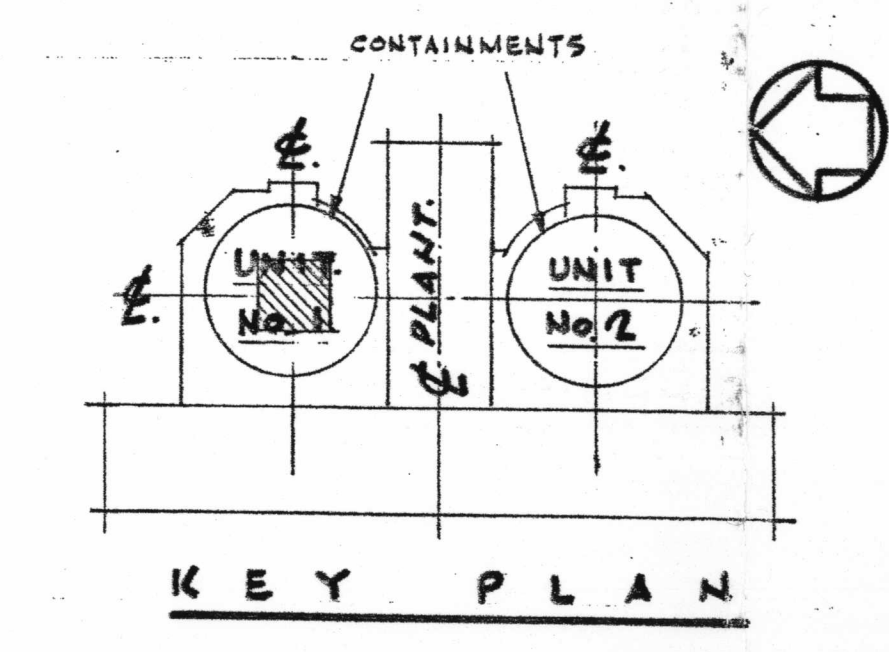

American Electric Power Corp.
 Donald C. Cook Nuclear Plant
 Unit 1 APPROVED IN GENERAL
 Per 102-10-008
 BY C.E. Shute / C.E. Shute DATE 3-10-04

Calc No: SD-04033-001, Rev. 0
 Attachment 3
 Page 2 of 9

REV. NO.	DATE	DESCRIPTION
2	9.19.72	ADDED HANGING TIES BY FIELD
1	9.5.72	GEN. ENGR. CORRECT.