

G:\PROJECT\PSE&G\Salem\NP000571.0003 - Remedial Investigation\RWP Addendum\Final v2\cadd\FIG-11 BORING LOCATIONS SUPPLEMENTAL GROUNDWATER INVESTIGATION (AUGUST 2003).dwg, 12/ 1/2004 5:41pm

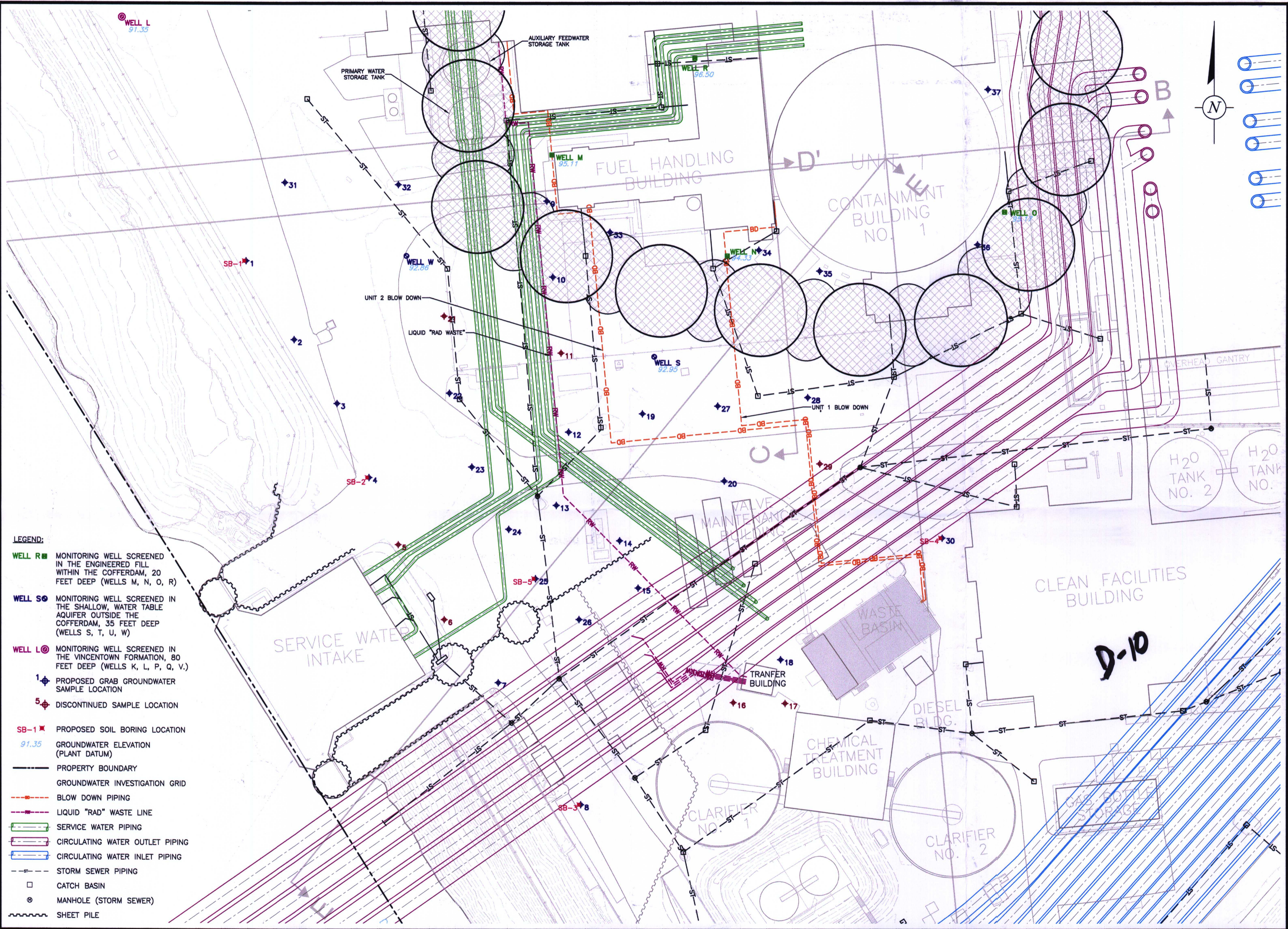

- LEGEND:**
- WELL R** MONITORING WELL SCREENED IN THE ENGINEERED FILL WITHIN THE COFFERDAM, 20 FEET DEEP (WELLS M, N, O, R)
 - WELL S** MONITORING WELL SCREENED IN THE SHALLOW, WATER TABLE AQUIFER OUTSIDE THE COFFERDAM, 35 FEET DEEP (WELLS S, T, U, W)
 - WELL L** MONITORING WELL SCREENED IN THE VINCENOTOWN FORMATION, 80 FEET DEEP (WELLS K, L, P, Q, V.)
 - 1** PROPOSED GRAB GROUNDWATER SAMPLE LOCATION
 - 5** DISCONTINUED SAMPLE LOCATION
 - SB-1** PROPOSED SOIL BORING LOCATION
 - 91.35** GROUNDWATER ELEVATION (PLANT DATUM)
 - PROPERTY BOUNDARY
 - GROUNDWATER INVESTIGATION GRID
 - BLOW DOWN PIPING
 - LIQUID "RAD" WASTE LINE
 - SERVICE WATER PIPING
 - CIRCULATING WATER OUTLET PIPING
 - CIRCULATING WATER INLET PIPING
 - STORM SEWER PIPING
 - CATCH BASIN
 - MANHOLE (STORM SEWER)
 - SHEET PILE

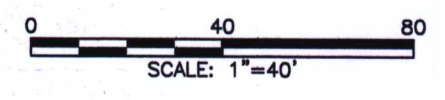

ARCADIS

6 Terry Drive
Suite 300, Newtown, PA 18940
Tel: 267/685-1800 Fax: 267/685-1801



PSEG NUCLEAR, LLC
SALEM GENERATING STATION
ARTIFICIAL ISLAND
HANCOCK'S BRIDGE, NEW JERSEY

DRAWN M. WASILEWSKI	DATE 9/26/03	PROJECT MANAGER P. MILJONIS	DEPARTMENT MANAGER D. FULTON
BORING LOCATIONS SUPPLEMENTAL GROUNDWATER INVESTIGATION (AUGUST 2003)		LEAD DESIGN PROF. S. POTTER	CHECKED B. PIERCE
		PROJECT NUMBER NP000571.0003	DRAWING NUMBER 11

NO.	DATE	REVISION DESCRIPTION	BY
			CKD