

APPENDIX A
FIGURES

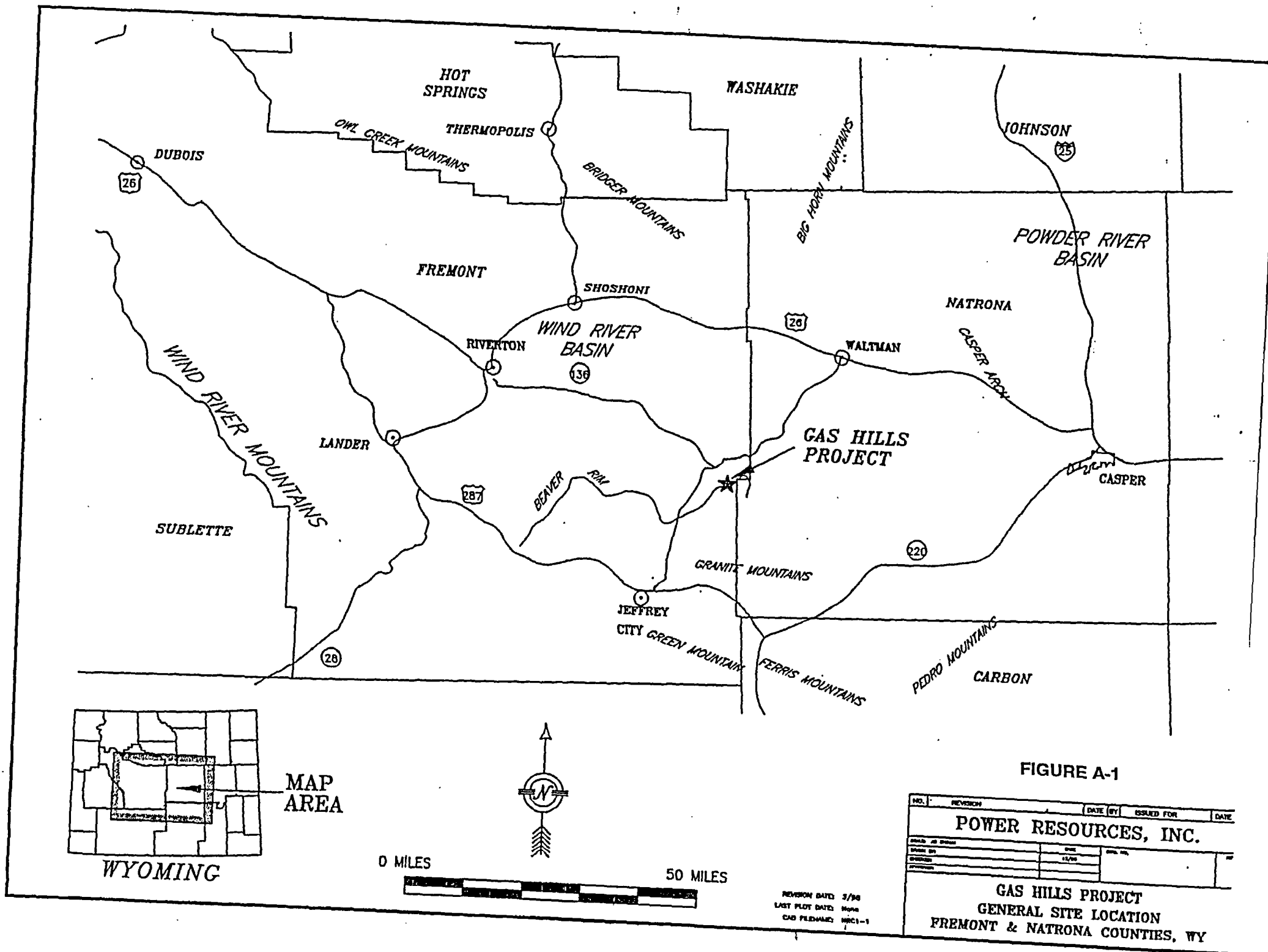
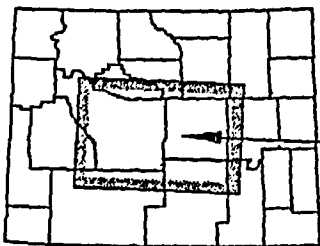

FIGURE A-1



MAP AREA

WYOMING



0 MILES

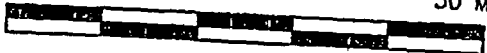

50 MILES

REVISION DATED: 3/78
 LAST PLOT DATE: None
 CAD FILENAME: MRC1-1

NO.	REVISION	DATE BY	ISSUED FOR	DATE
POWER RESOURCES, INC.				
SCALE AS SHOWN	DATE	DATE		
PROJECT NO.	12/78			
DESCRIPTION				
GAS HILLS PROJECT GENERAL SITE LOCATION FREMONT & NATRONA COUNTIES, WY				

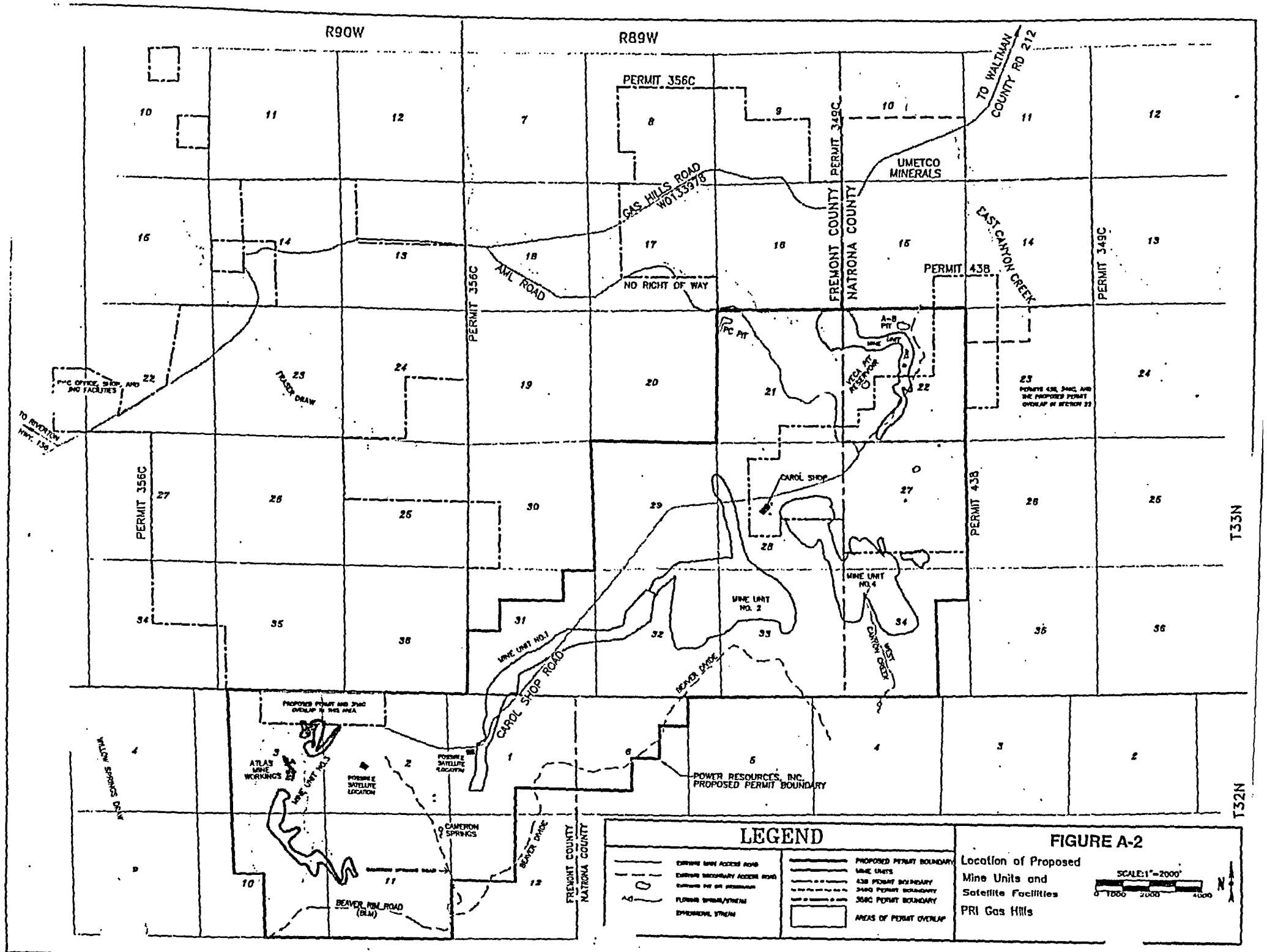

LEGEND

	EXISTING MINE ACCESS ROAD		PROPOSED PERMIT BOUNDARY
	EXISTING SECONDARY ACCESS ROAD		MINE UNITS
	EXISTING HWY OR HIGHWAY		438 PERMIT BOUNDARY
	FURNACE SPRING/STREAM		349C PERMIT BOUNDARY
	SPRINGHEAD STREAM		356C PERMIT BOUNDARY
			AREAS OF PERMIT OVERLAP

FIGURE A-2

Location of Proposed Mine Units and Satellite Facilities
PRI Gas Hills

SCALE: 1"=2000'

0 1000 2000 4000

N

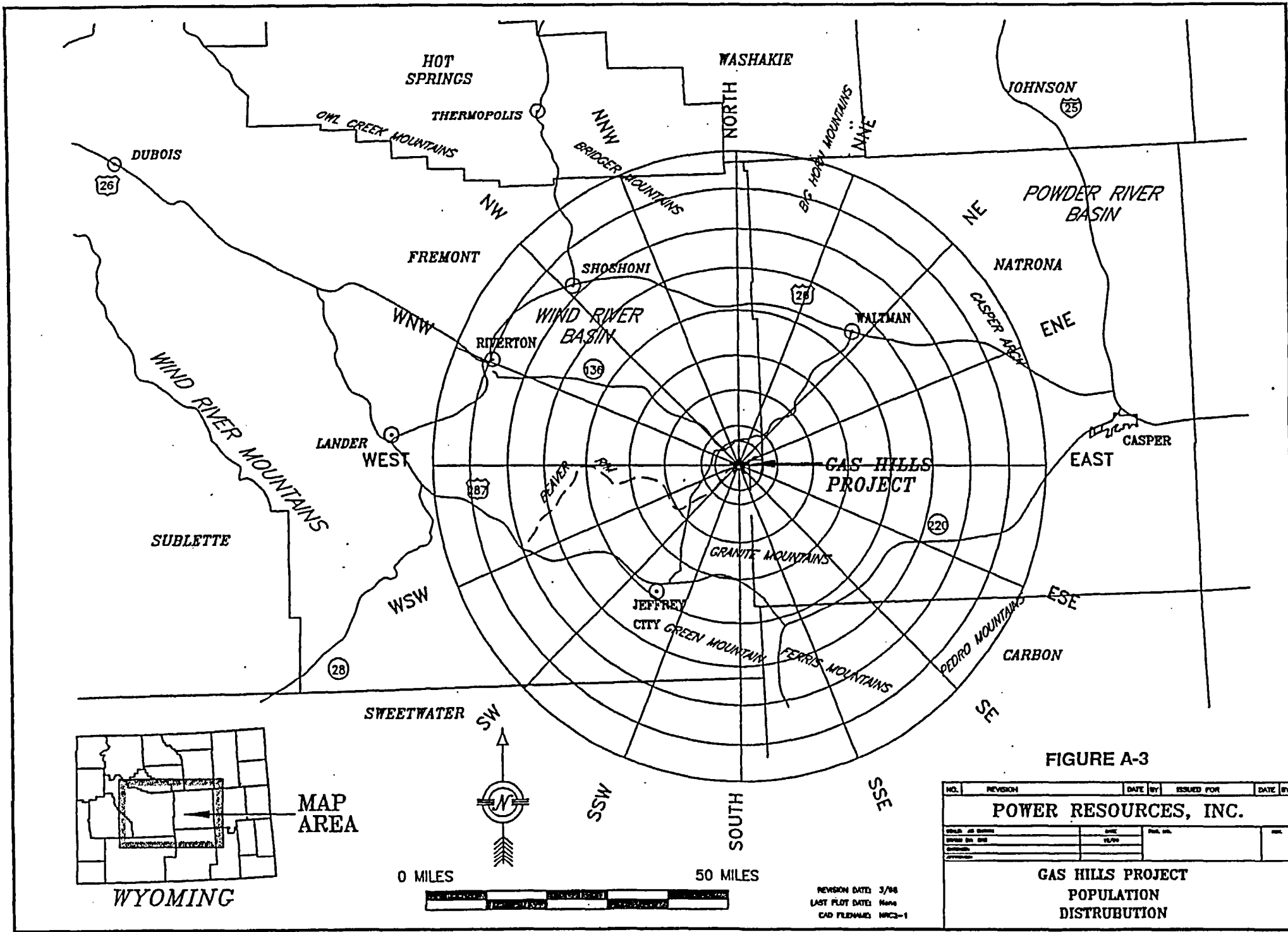
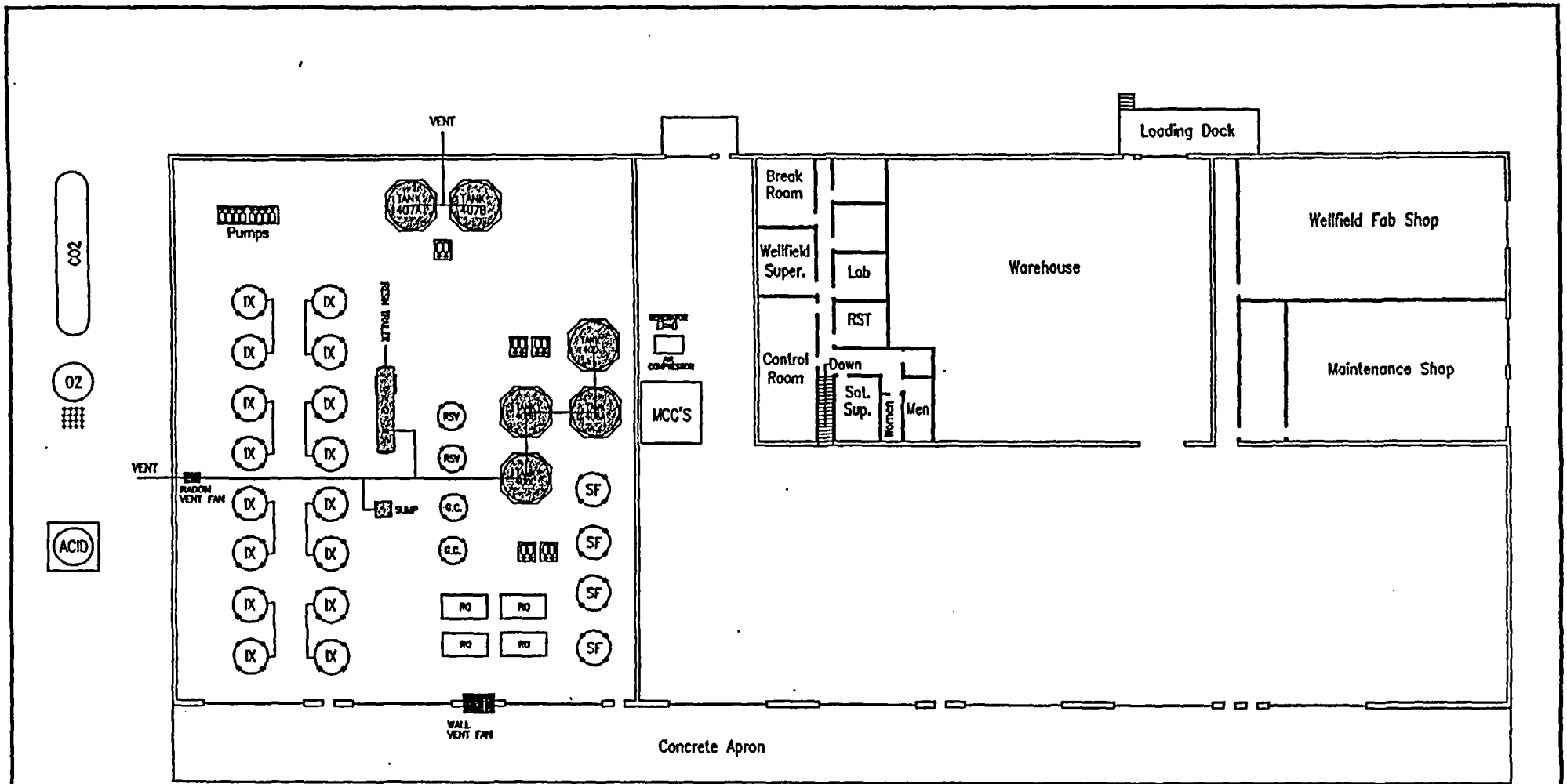

FIGURE A-3

NO.	REVISION	DATE BY	ISSUED FOR	DATE BY
POWER RESOURCES, INC.				
DATE AS ORDERED	DATE	PRICE PER		
ORDER BY NO.	12/79			
ORDER NO.				

**GAS HILLS PROJECT
POPULATION
DISTRIBUTION**

REVISION DATE: 3/88
LAST PLOT DATE: None
CAD FILENAME: WRC3-1



KEY

- IX ION EXCHANGE COLUMN
- SF SAND FILTER
- RO REVERSE OSMOSIS UNIT
- RSV RESIN STORAGE VESSEL
- GC GUARD COLUMN

POTENTIAL RADON SOURCE LOCATIONS

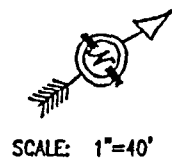

REVISION DATE: 3/98
 LAST PLOT DATE:
 CAD FILENAME: MWCS-2

FIGURE A-4

NO.	REVISION	DATE (BY)	ISSUED FOR	DATE (BY)
POWER RESOURCES, INC.				
GAS HILLS PROJECT CAROL SHOP NATRONA & FREMONT COUNTIES, WY				

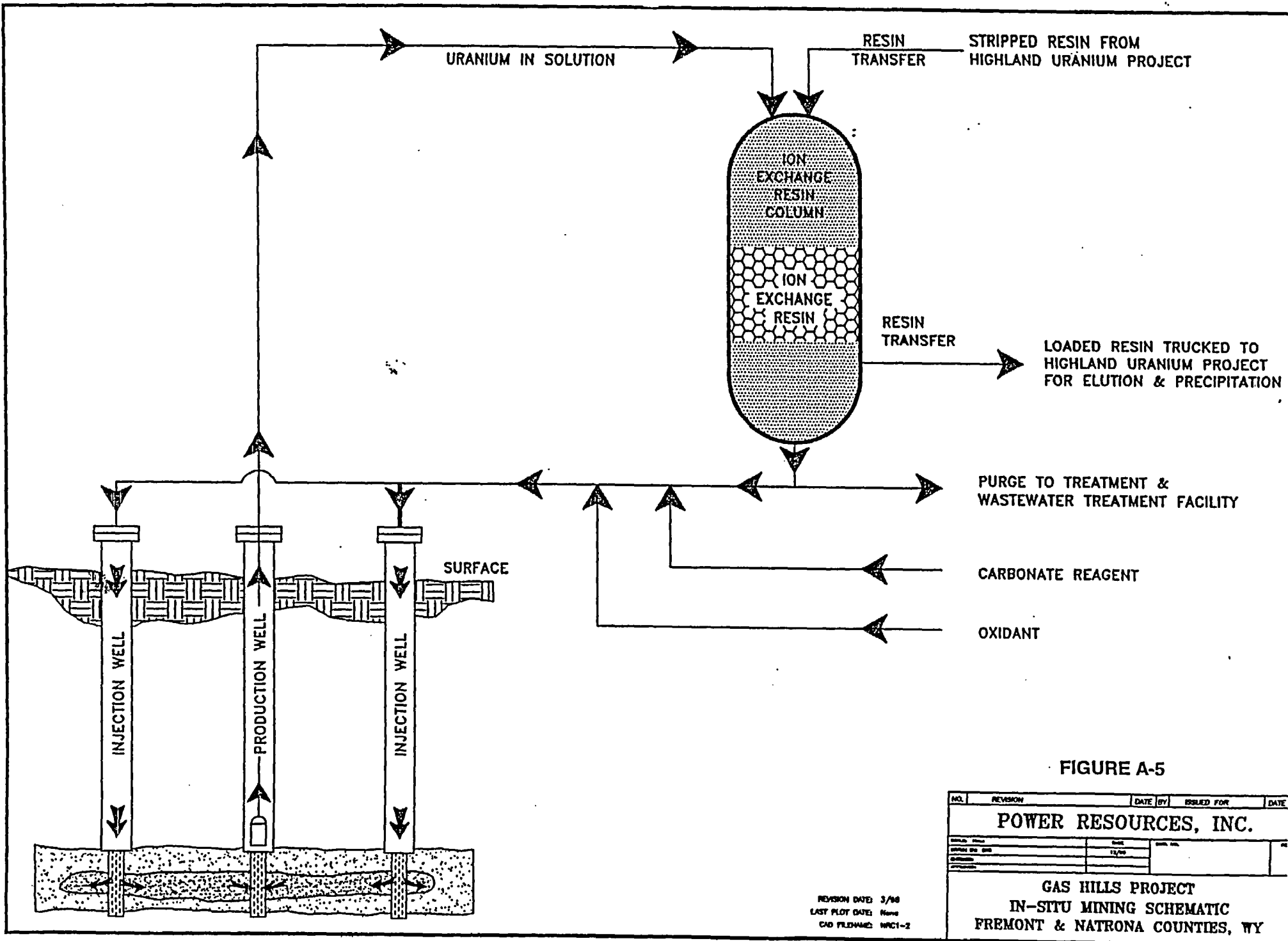

FIGURE A-5

NO.	REVISION	DATE	BY	ISSUED FOR	DATE
POWER RESOURCES, INC.					
GAS HILLS PROJECT IN-SITU MINING SCHEMATIC FREMONT & NATRONA COUNTIES, WY					

REVISION DATE: 3/98
 LAST PLOT DATE: None
 CAD FILENAME: WRC1-2