

BEEJAY INC.

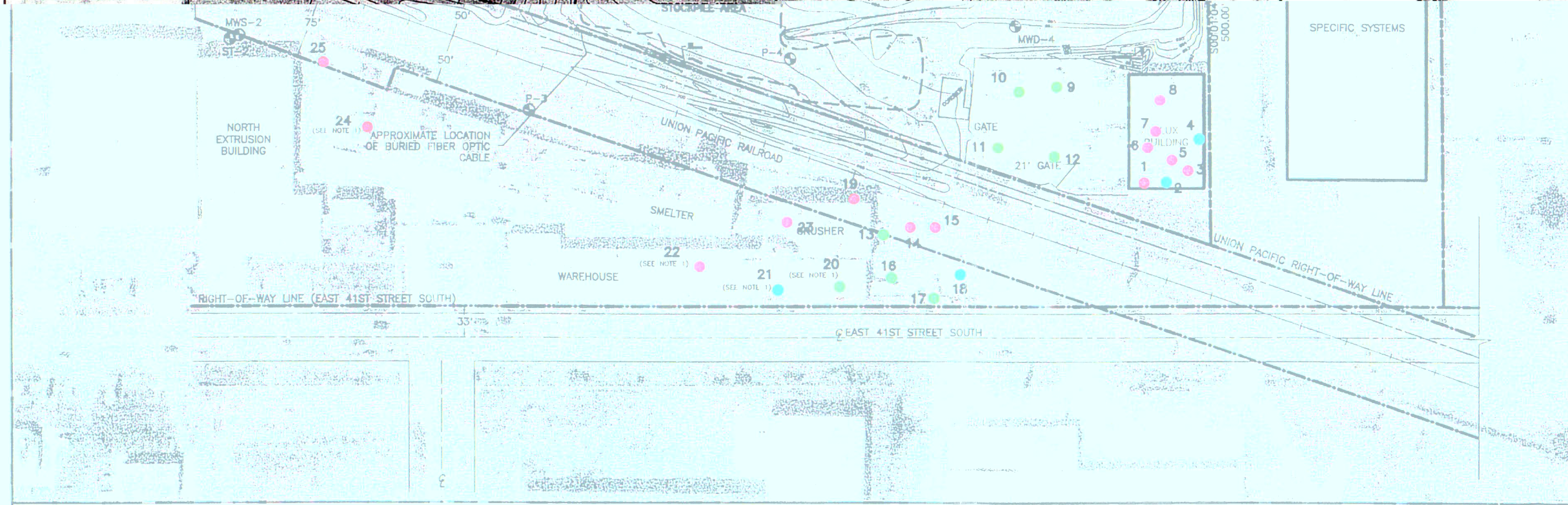

NOTE
 1. CORING OF AREA WAS LIMITED DUE TO CONCRETE OR SIMILAR MATERIAL AT DEPTH.

- LEGEND**
- RCP REINFORCED CONCRETE PIPE
 - OVERHEAD UTILITIES
 - POWER POLE
 - MONITORING WELL
 - FENCE LINE
 - PROPERTY LINE
 - RIGHT-OF-WAY
 - SAMPLE POINT WITH Th-232 ACTIVITY CONCENTRATION \leq ESTABLISHED SITE BACKGROUND OF 1.1 pCi/g TH-232
 - SAMPLE POINT WITH Th-232 ACTIVITY CONCENTRATION $>$ BACKGROUND OR $<$ 3.0 pCi/g
 - SAMPLE POINT WITH Th-232 ACTIVITY CONCENTRATION \geq 3.0 pCi/g



REFERENCES

1. THE RIGHT-OF-WAY AND PROPERTY LINES WERE OBTAINED FROM PLAT OF SURVEY PREPARED BY DENTON & WHITE SURVEYING COMPANY SEALED ON FEBRUARY 14, 1954
2. TOPOGRAPHIC INFORMATION WAS OBTAINED FROM TOPOGRAPHIC SURVEY OF PART OF THE SE1/4 OF SECTION 23 TOWNSHIP 19 NORTH RANGE 13 EAST OF THE 10TH & 11TH TULSA COUNTY STATE OF OKLAHOMA ACCORDING TO THE U.S. GOVERNMENT SURVEY THEREOF AND KNOWN AS 7311 EAST 41ST STREET SOUTH. (FILE: NFSK003.DWG REV. A)
3. 1991 AERIAL PHOTOGRAPH USED TO ALIGN CULTURAL FEATURES WITH KAISER PROPERTY LINES.
4. THE STOCKPILE AREA WAS OBTAINED FROM A TOPOGRAPHICAL SURVEY BY DIGITAL MAPPING ASSOCIATES, INC., AUG. 18, 2001.

REVISION	DATE	DESCRIPTION
FIGURE A-7 PHOTO PROGRESSION DATE 3/23/91 ADDITIONAL SITE CHARACTERIZATION FORMER KAISER ALUMINUM SPECIALTY PRODUCTS FACILITY TULSA, OKLAHOMA		
PREPARED FOR KAISER ALUMINUM & CHEMICAL CORPORATION BATON ROUGE, LOUISIANA		
APPROVED	BY	DATE
CHECKED	BY	DATE
DRAWN	BY	DATE
DRAWING NUMBER		
5427A428		Earth Sciences Consultants, Inc.

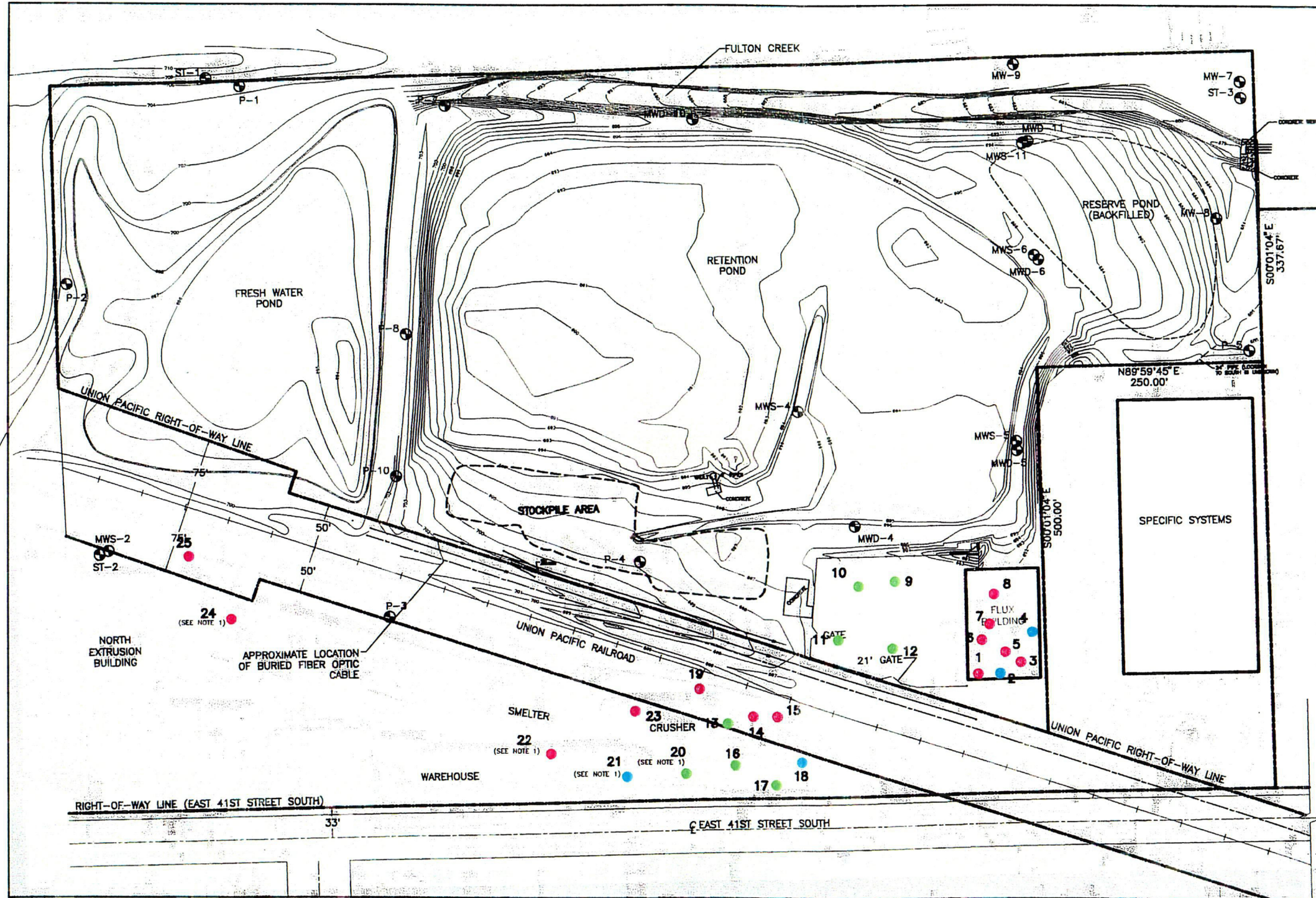

NOTE
 1. CORING OF AREA WAS LIMITED DUE TO CONCRETE OR SIMILAR MATERIAL AT DEPTH.

- LEGEND**
- RCP REINFORCED CONCRETE PIPE
 - OVERHEAD UTILITIES
 - POWER POLE
 - ⊕ MONITORING WELL
 - FENCE LINE
 - PROPERTY LINE
 - RIGHT-OF-WAY
- SAMPLE POINT WITH Th-232 ACTIVITY CONCENTRATION \leq ESTABLISHED SITE BACKGROUND OF 1.1 pCi/g TH-232
 - SAMPLE POINT WITH Th-232 ACTIVITY CONCENTRATION $>$ BACKGROUND OR $<$ 3.0 pCi/g
 - SAMPLE POINT WITH Th-232 ACTIVITY CONCENTRATION \geq 3.0 pCi/g

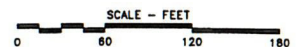

REFERENCES

1. THE RIGHT-OF-WAY AND PROPERTY LINES WERE OBTAINED FROM PLAT OF SURVEY PREPARED BY DENTON & WHITE SURVEYING COMPANY SIGNED ON FEBRUARY 14, 1964.
2. TOPOGRAPHIC INFORMATION WAS OBTAINED FROM TOPOGRAPHIC SURVEY OF PART OF THE SE 1/4 OF SECTION 23 TOWNSHIP 18 NORTH RANGE 13 EAST, OF THE 18th & 19th TULSA COUNTY, STATE OF OKLAHOMA, ACCORDING TO THE U.S. GOVERNMENT SURVEY "TRIGON", AND KNOWN AS 7311 EAST 41st STREET SOUTH, (FILE: H390003.DWG REV. A)
3. 1922 AERIAL PHOTOGRAPH USED TO ALIGN CULTURAL FEATURES WITH KAISER PROPERTY LINES.
4. THE STOCKPILE AREA WAS OBTAINED FROM A TOPOGRAPHICAL SURVEY BY DIGITAL MAPPING ASSOCIATES, INC.; AUG. 16, 2001

REVISION	DATE	DESCRIPTION

FIGURE A-8
 PHOTO PROGRESSION DATE 8/16/01
 ADDITIONAL SITE CHARACTERIZATION
 FORMER KAISER ALUMINUM
 SPECIALTY PRODUCTS FACILITY
 TULSA, OKLAHOMA

PREPARED FOR
KAISER ALUMINUM & CHEMICAL CORPORATION
 BATON ROUGE, LOUISIANA

APPROVED <i>[Signature]</i> 12/7/01
CHECKED <i>[Signature]</i> 12/7/01
DRAWN GJA 8/8/01
DRAWING NUMBER 5427A438

Earth Sciences Consultants, Inc. *[Logo]*

013