

**LEGEND**

- 1958 BUILDING FOOTPRINT
  - SAMPLE POINT WITH Th-232 ACTIVITY CONCENTRATION  $\leq$  ESTABLISHED SITE BACKGROUND OF 1.1 pCi/g TH-232
  - SAMPLE POINT WITH Th-232 ACTIVITY CONCENTRATION  $>$  BACKGROUND OR  $<$  3.0 pCi/g
  - SAMPLE POINT WITH Th-232 ACTIVITY CONCENTRATION  $\geq$  3.0 pCi/g
- (2.3300-1') TH-232 CONCENTRATION (pCi/g) AT SAMPLE DEPTH (FEET)

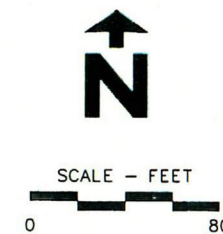

FIGURE 6  
CHANGES TO BUILDINGS BETWEEN  
1958 AND 1964  
FORMER KAISER ALUMINUM  
SPECIALTY PRODUCTS FACILITY  
TULSA, OKLAHOMA

PREPARED FOR  
KAISER ALUMINUM & CHEMICAL CORPORATION  
BATON ROUGE, LOUISIANA

APPROVED *KAD* 12/01  
CHECKED *AD* 12/01  
DRAWN *GJA* 10/18/01  
DRAWING NUMBER  
5427A253

*CO3*  
Earth Sciences Consultants, Inc.



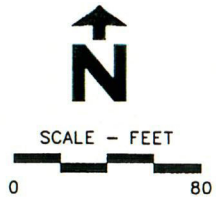
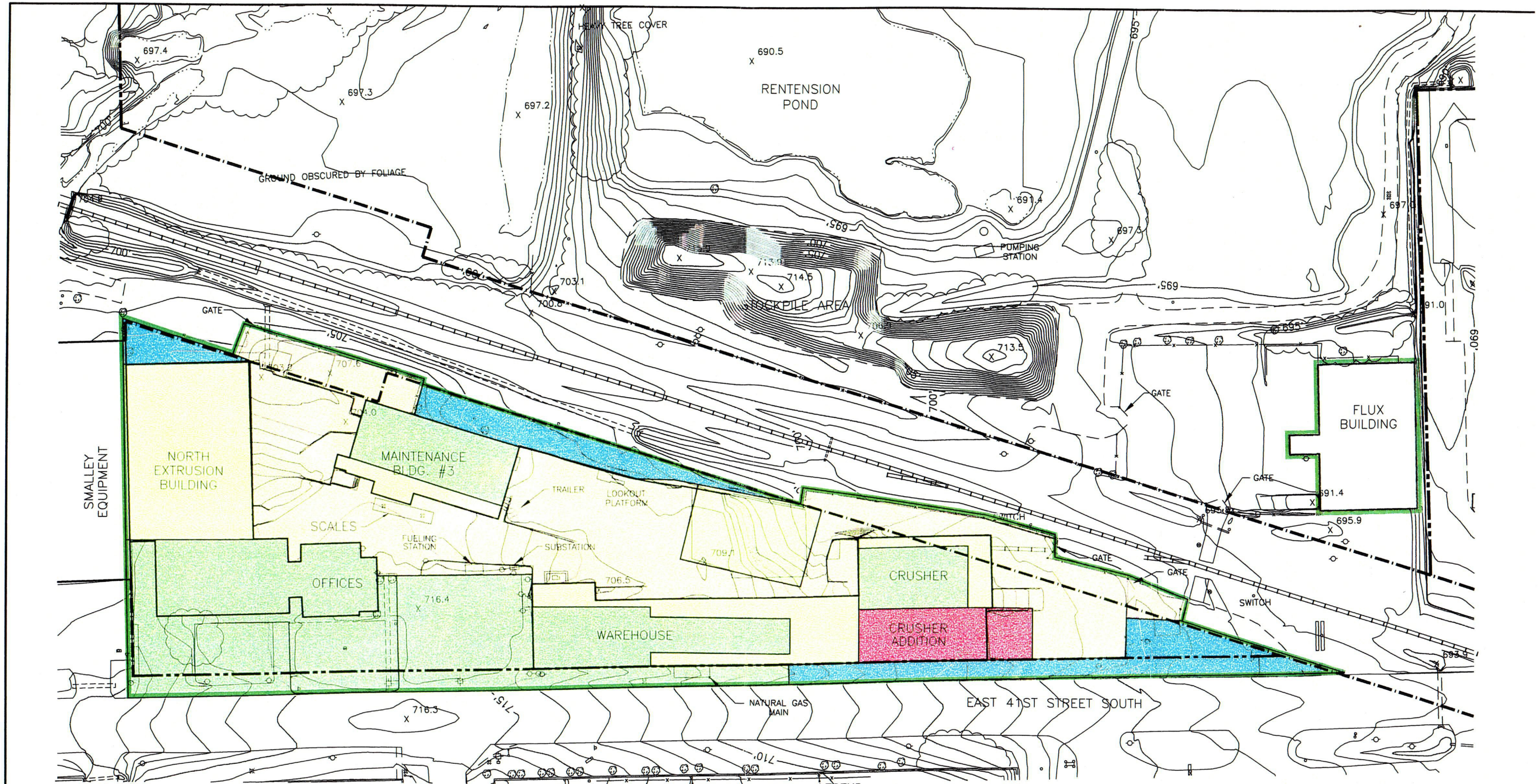









**REFERENCES**

1. DIGITAL MAPPING ASSOCIATES, INC.; AUG. 16, 2001
2. THE RIGHT-OF-WAY AND PROPERTY LINES WERE OBTAINED FROM A PLAT PREPARED BY DENTON AND WHITE SURVEYING COMPANY ON FEBRUARY 14, 1964.

**LEGEND**

-  FORMER OPERATIONAL AREA
-  APPROXIMATE PROPERTY LINE
-  APPROXIMATE RIGHT-OF-WAY
-  AREAS REMEDIATED DURING ALRP
-  NON-IMPACTED AREAS
-  POTENTIALLY IMPACTED AREAS DUE TO HISTORICAL PLANT OPERATIONS
-  POTENTIALLY IMPACTED AREAS DUE TO BUILDING RENOVATION BETWEEN 1958-1964
-  POTENTIALLY IMPACTED AREAS DUE TO CONCRETE PAVING POST 1958

**FIGURE 8**  
**CONCEPTUAL MODEL OF LAND AREAS**  
**FORMER KAISER ALUMINUM**  
**SPECIALTY PRODUCTS FACILITY**  
**TULSA, OKLAHOMA**

PREPARED FOR  
**KAISER ALUMINUM & CHEMICAL CORPORATION**  
**BATON ROUGE, LOUISIANA**

APPROVED <i>RFO 12/01</i>	
CHECKED <i>SB 12/01</i>	
DRAWN <i>GJA 12/3/01</i>	
DRAWING NUMBER	
5427275	





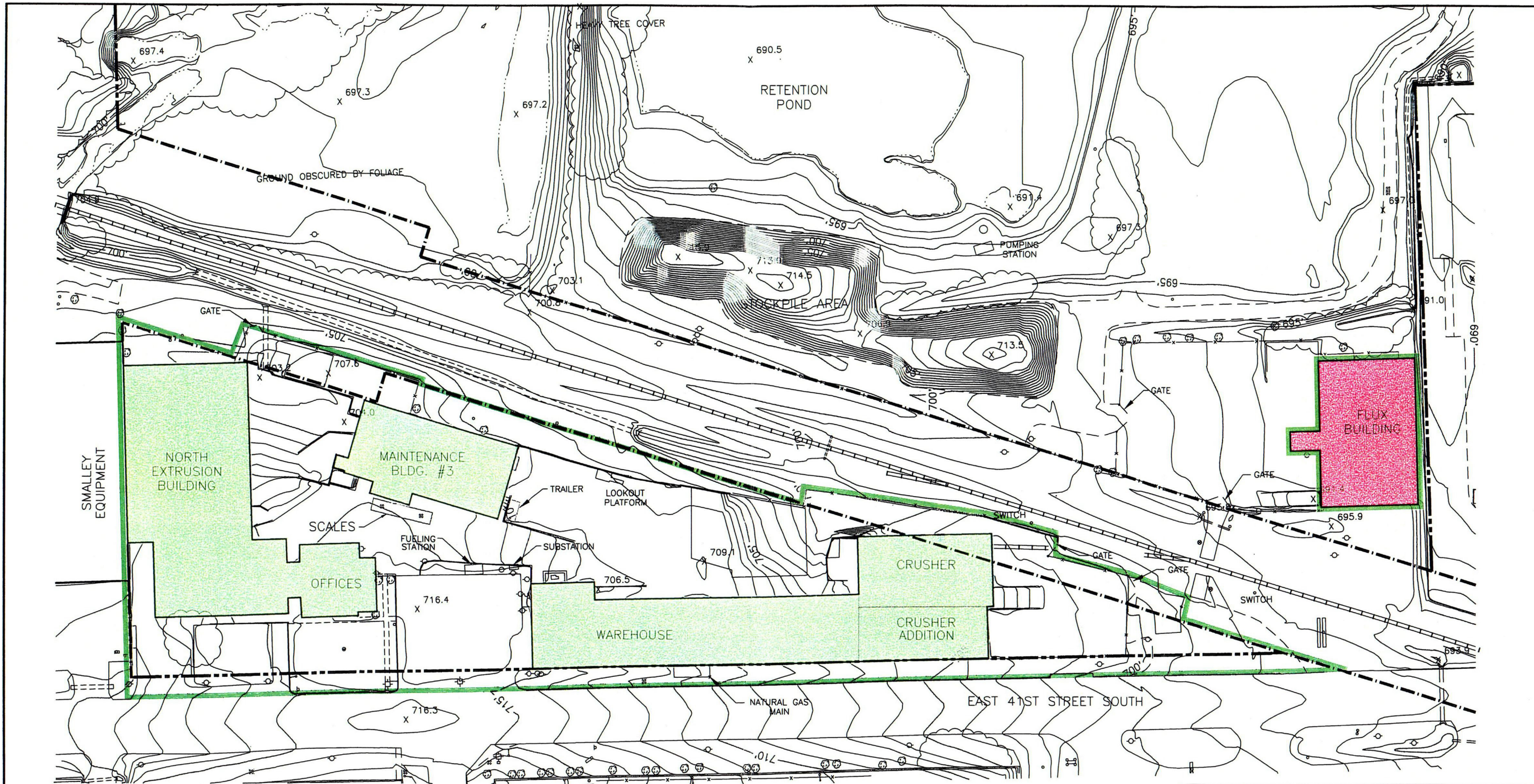

**Earth Sciences Consultants, Inc.**



**REFERENCES**

1. DIGITAL MAPPING ASSOCIATES, INC.; AUG. 16, 2001
2. THE RIGHT-OF-WAY AND PROPERTY LINES WERE OBTAINED FROM A PLAT PREPARED BY DENTON AND WHITE SURVEYING COMPANY ON FEBRUARY 14, 1964.

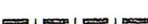
**LEGEND**

-  FORMER OPERATIONAL AREA
-  APPROXIMATE PROPERTY LINE
-  APPROXIMATE RIGHT-OF-WAY
-  NON-IMPACTED STRUCTURES
-  STRUCTURE IMPACTED DUE TO CURRENT SITE ACTIVITIES

**FIGURE 9**  
**CONCEPTUAL MODEL OF STRUCTURES**  
**FORMER KAISER ALUMINUM**  
**SPECIALTY PRODUCTS FACILITY**  
**TULSA, OKLAHOMA**

PREPARED FOR  
**KAISER ALUMINUM & CHEMICAL CORPORATION**  
**BATON ROUGE, LOUISIANA**

APPROVED *RFD 12/01*  
 CHECKED *ASL 12/01*  
 DRAWN *GJA 12/3/01*  
 DRAWING NUMBER  
**5427276**



Earth Sciences Consultants, Inc.

C05