

- A. POWER PANEL #1
- B. MAIN BREAKER SECONDARY
- C. 600 AMP BREAKER - "DISCONNECTED"
- D. TIE BREAKER SUBSTATION "B"
- E. POWER PANEL #2
- F. BIG BERTHA BLOWER MOTOR

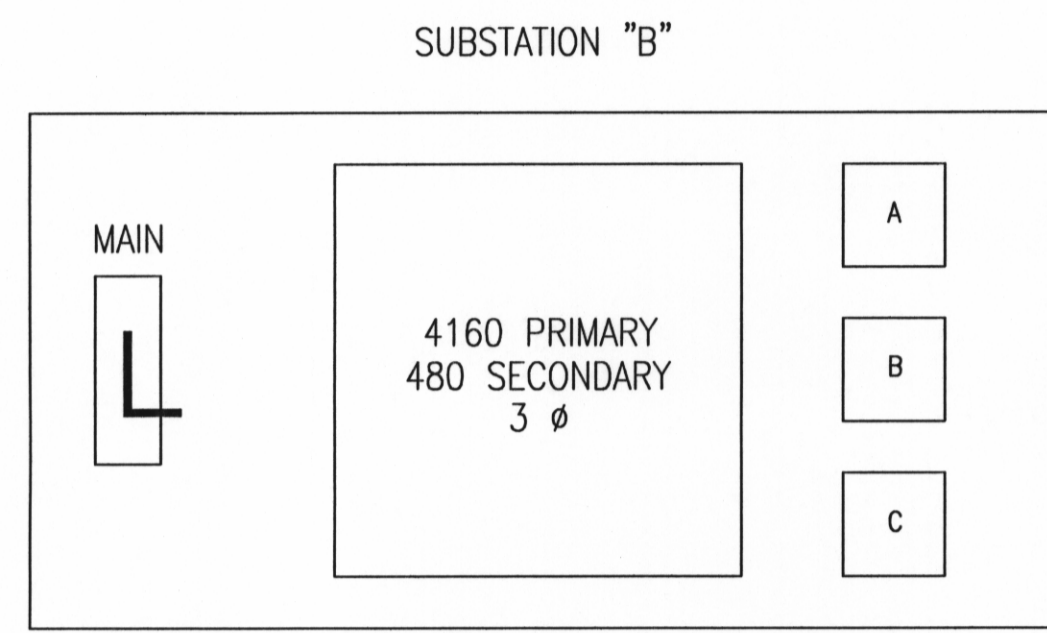

- A. MAIN BREAKER
- B. POWER PANEL #4
- C. POWER PANEL #3

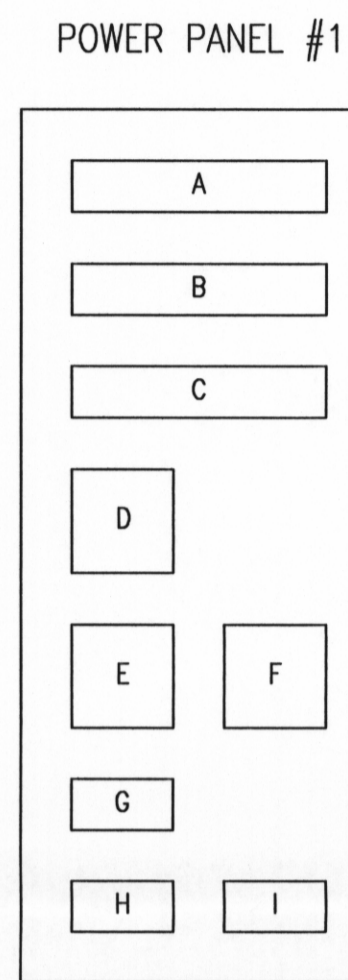

- A. 400 AMP
- B. 400 AMP LIGHTING PANELS
- C. 400 AMP EB FURN. PANEL WEST SIDE
- D. 200 AMP
- E. 200 AMP BY BOILER ROOM TO CHEM C
- G. OUSTSIDE LIGHTS TOP OF CHEM A
- I. EXHAUST FAN & WELDING RECEPT.

POWER PANEL #2

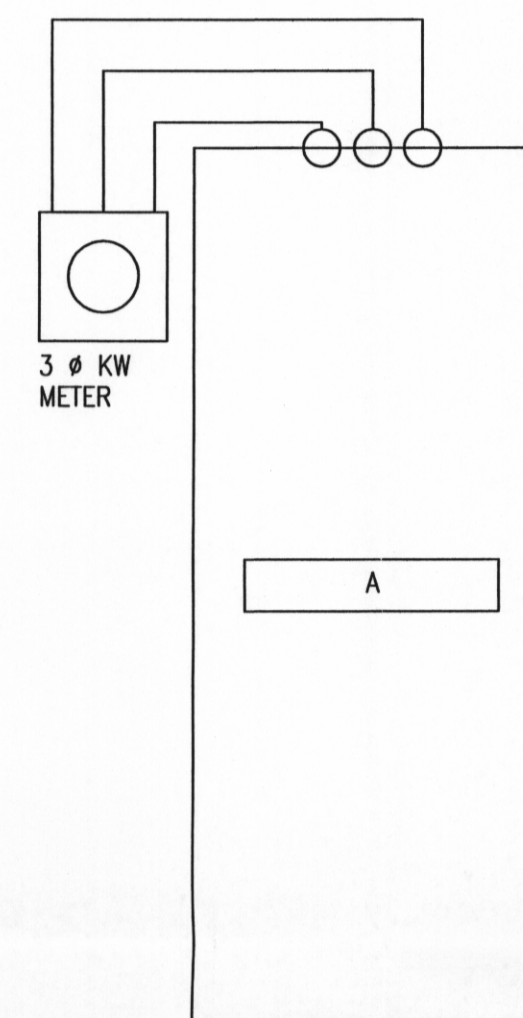

- A. 400 AMP POWDER WASH

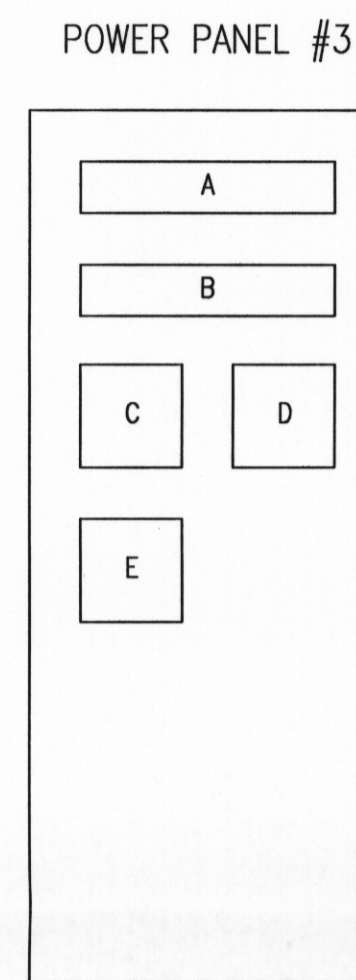

- A. 800 AMP HOT OIL DRYER
- B. 400 AMP EB EAST WALL
- C. 200 AMP
- D. 150 AMP
- E. 100 AMP

POWER PANEL #4

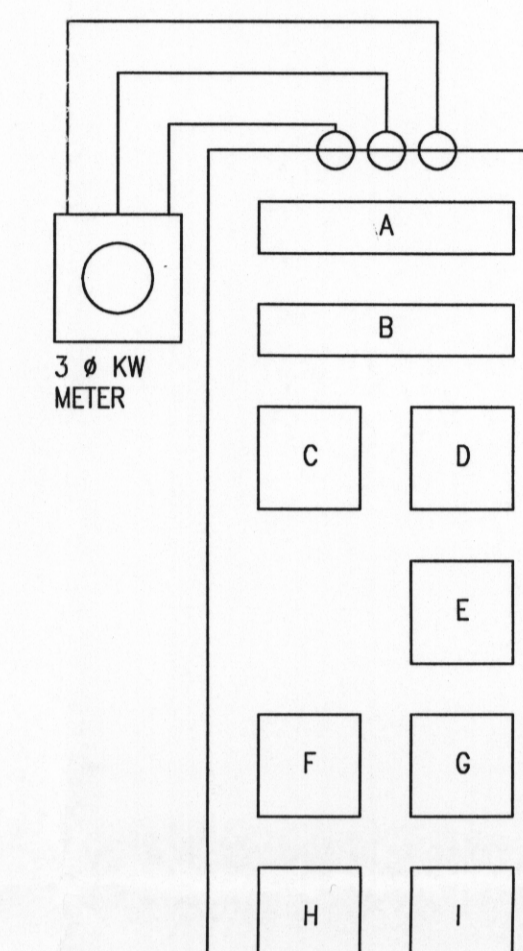

- A. 800 AMP MIX BASINS, BOILER RM, 1ST FLOOR, ELEVATOR
- B. 400 AMP
- C. POWDER WASH TUBS
- D. DISTILLED WATER LEVEL
- E. 125 AMP POWDER WASH SCRUBBER
- F. TAC EQUIPMENT
- G. P.W. SCRUBBER
- H. PANG BORNE
- I. PANG BORNE

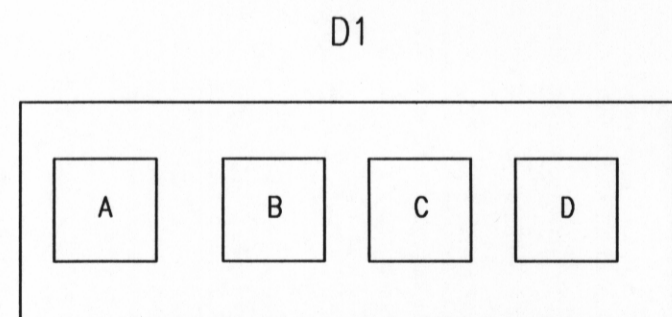
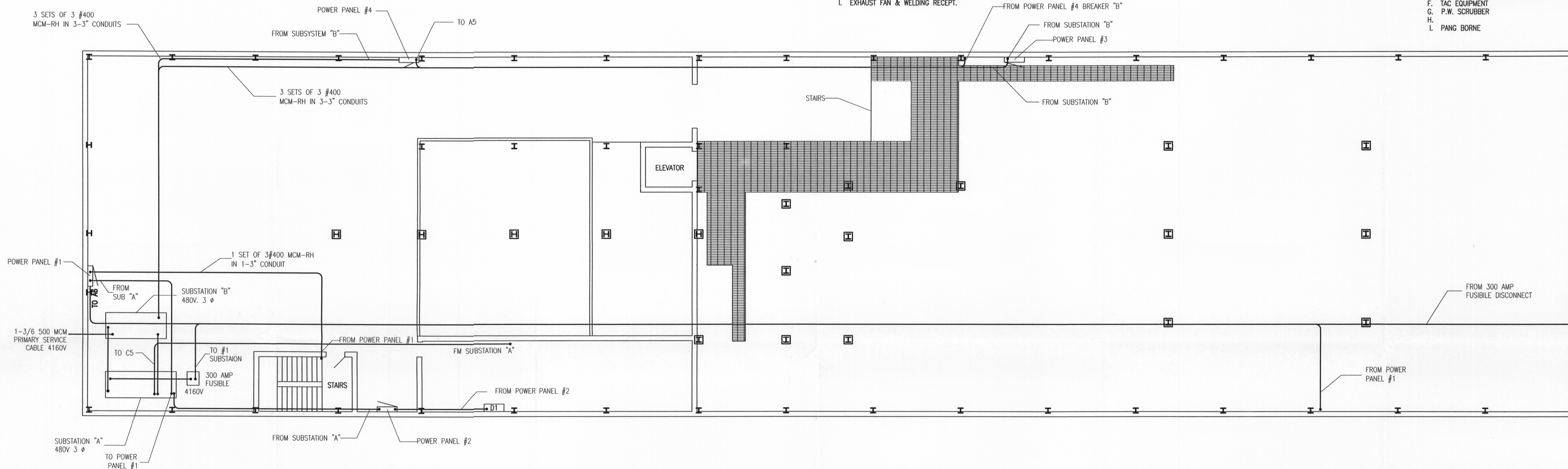

- A. NO. 13 A0 SMITH UNIT
- B. STARTING UNIT
- C. SOUTH ROOF FAN
- D. NORTH ROOF FAN

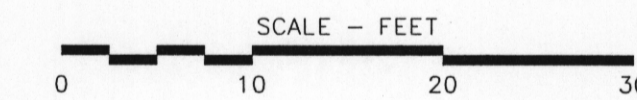

REVISION	DATE	DESCRIPTION
FIGURE 4-3D CHEM A BUILDING 4th FLOOR DECOMMISSIONING PLAN FANSTEEL, INC. MUSKOGEE, OKLAHOMA		
PREPARED FOR FANSTEEL, INC. MUSKOGEE, OKLAHOMA		
APPROVED	<i>[Signature]</i>	
CHECKED	<i>[Signature]</i>	
DRAWN	DEB 08/16/02	
DRAWING NUMBER		
6473414		Earth Sciences Consultants, Inc.

REFERENCE
FANSTEEL DRAWING "CHEM-A-4TH-FLOOR.DWG".