

19-06915-03
22

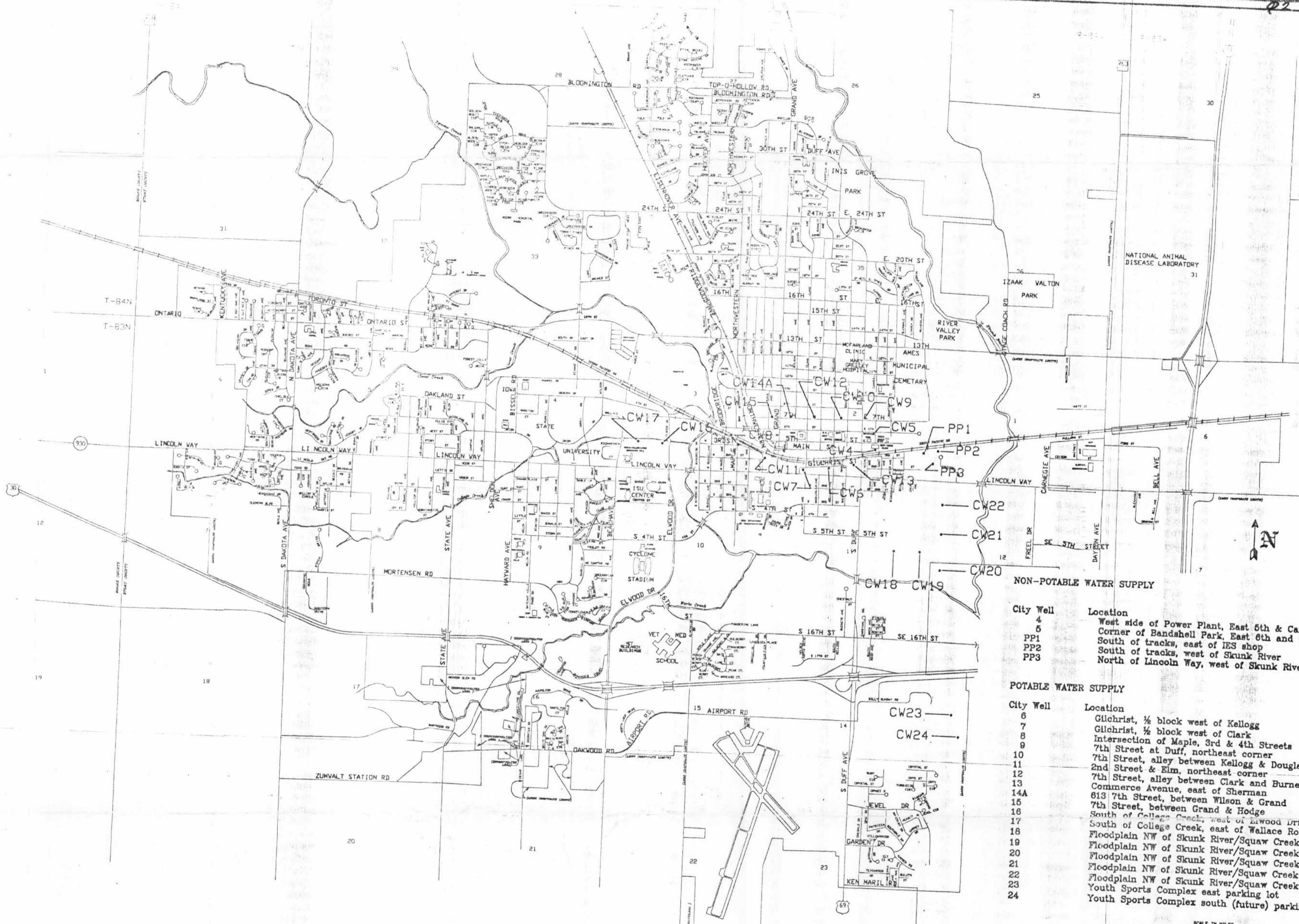

- NON-POTABLE WATER SUPPLY**
- | City Well | Location |
|-----------|--|
| 4 | West side of Power Plant, East 5th & Carroll |
| 6 | Corner of Bandshell Park, East 6th and Carroll |
| PP1 | South of tracks, east of IES shop |
| PP2 | South of tracks, west of Skunk River |
| PP3 | North of Lincoln Way, west of Skunk River |
- POTABLE WATER SUPPLY**
- | City Well | Location |
|-----------|---|
| 6 | Glichrist, 1/2 block west of Kellogg |
| 7 | Glichrist, 1/2 block west of Clark |
| 8 | Intersection of Maple, 3rd & 4th Streets |
| 9 | 7th Street at Duff, northeast corner |
| 10 | 7th Street, alley between Kellogg & Douglas |
| 11 | 2nd Street & Elm, northeast corner |
| 12 | 7th Street, alley between Clark and Burnett |
| 13 | Commerce Avenue, east of Sherman |
| 14A | 613 7th Street, between Wilson & Grand |
| 15 | 7th Street, between Grand & Hodge |
| 16 | South of College Creek, west of Lwood Drive |
| 17 | South of College Creek, east of Wallace Road |
| 18 | Floodplain NW of Skunk River/Squaw Creek confluence |
| 19 | Floodplain NW of Skunk River/Squaw Creek confluence |
| 20 | Floodplain NW of Skunk River/Squaw Creek confluence |
| 21 | Floodplain NW of Skunk River/Squaw Creek confluence |
| 22 | Floodplain NW of Skunk River/Squaw Creek confluence |
| 23 | Youth Sports Complex east parking lot |
| 24 | Youth Sports Complex south (future) parking lot |

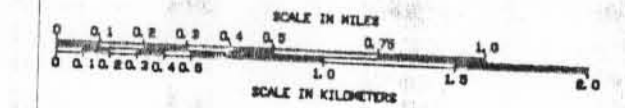

CITY WELL MAP
OF
**AMES
IOWA**

131983
NMSS/RGNI MATERIALS-002
Submitted with ITC dtd 9/11/02
Report dtd 08/14/02.

Figure 5

File: D:\actwin\working\wells\Public_Well_Map.dwg
Last Update: March 29, 1999

D-01

Revisions	Date	Scale: None	City of Ames, Iowa Water and Pollution Control Department Ames Water Treatment Plant Raw Water Supply System Downtown Well Field 300 East Fifth Street	DWG
Downtown wells added		Drawn By:		
		Checked By:		
		Approved By:		
		Date:		