

IT	DIM. 'A'
1	59
2	12

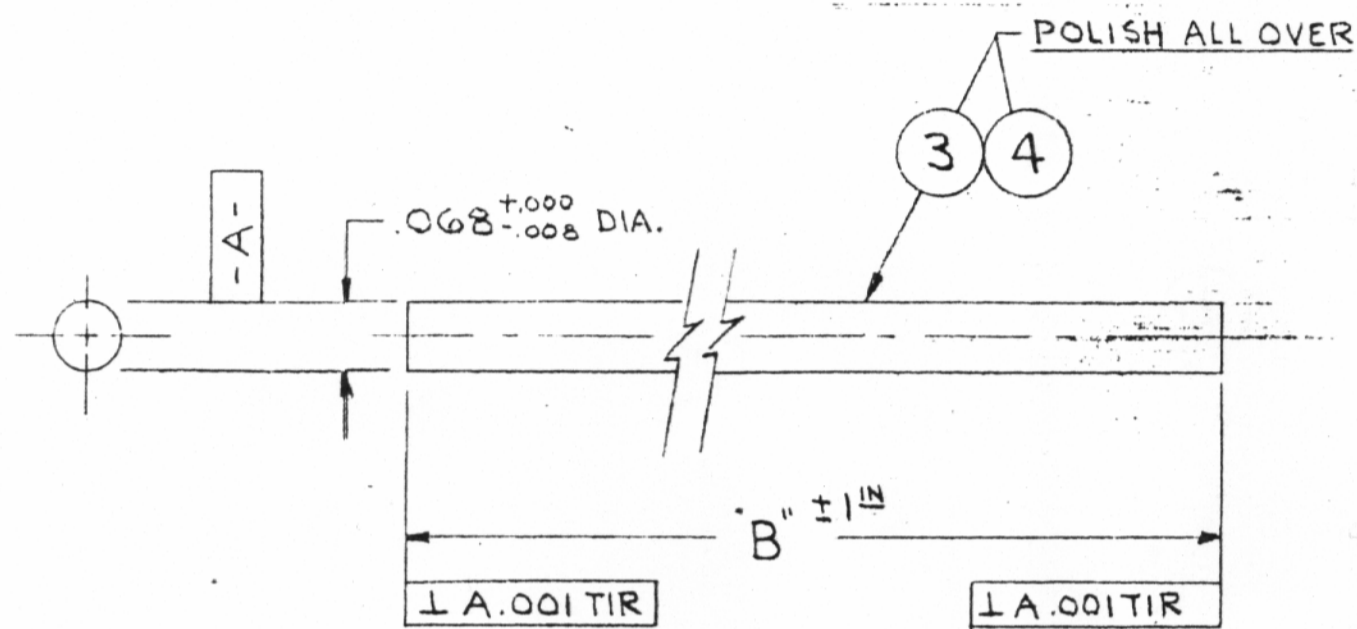

IT	DIM. 'B'
3	59
4	12

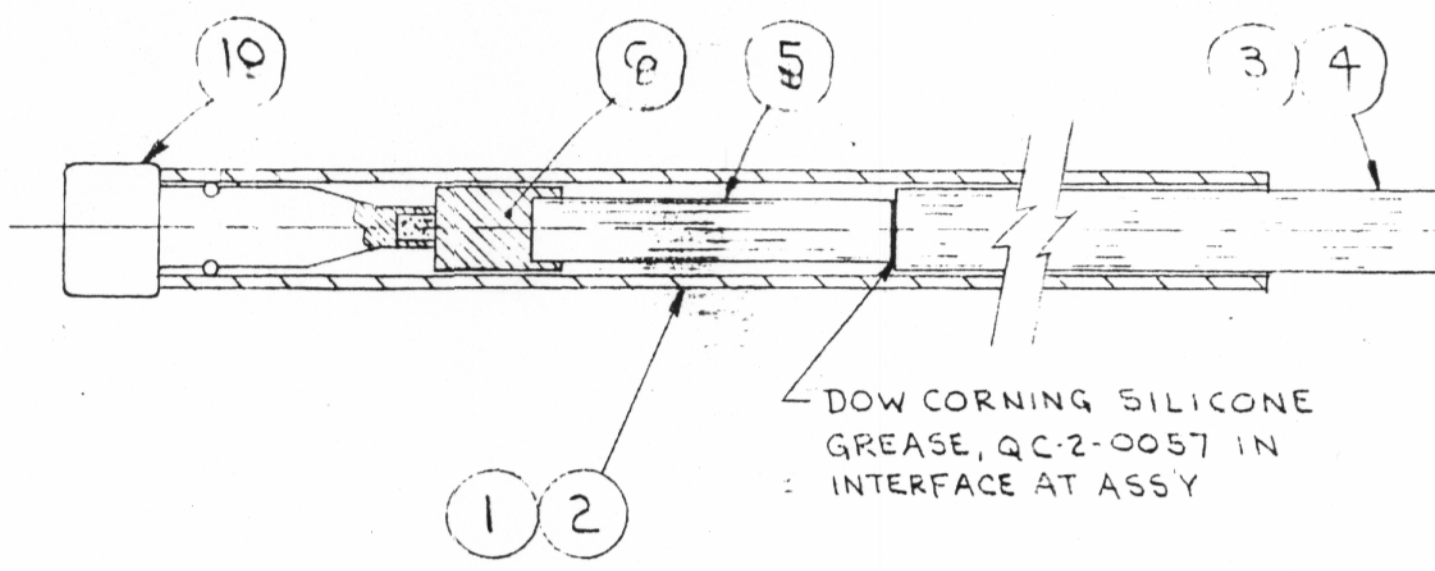
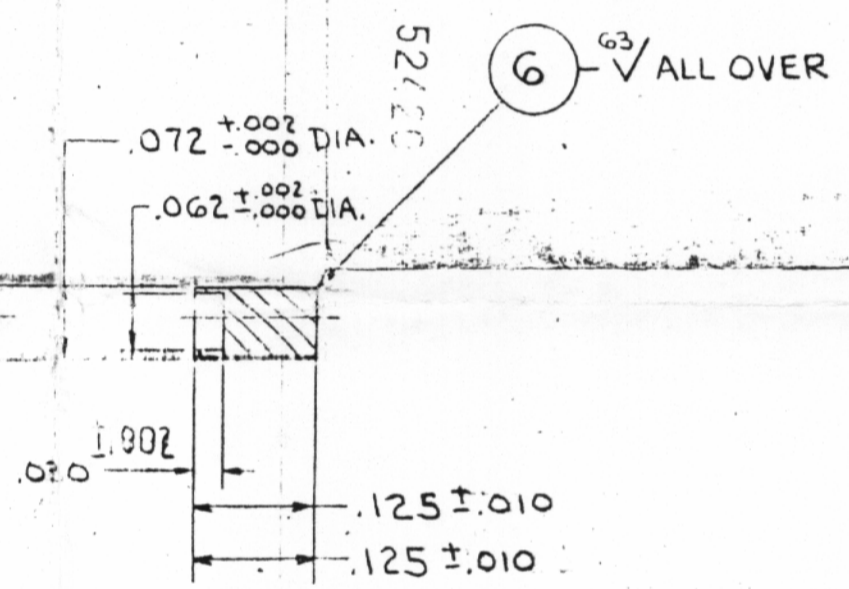
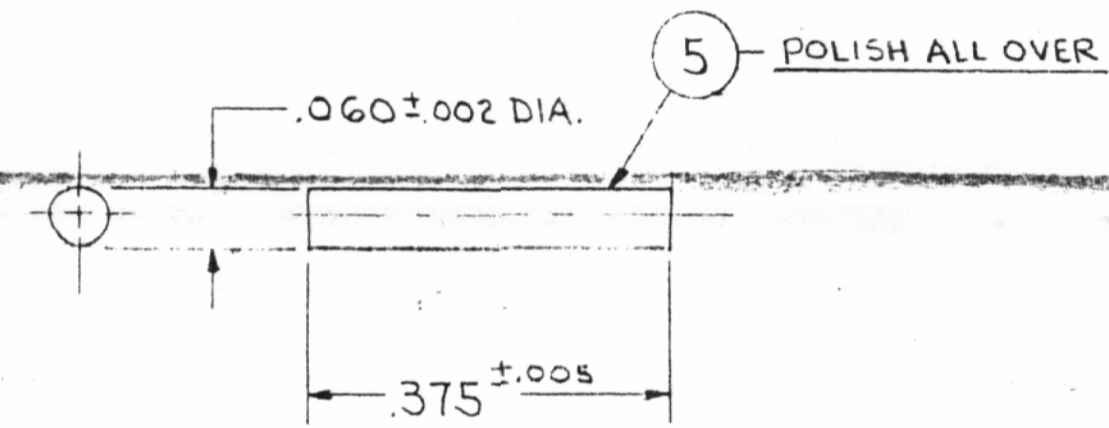

GROUP 1 LONG PROBE      GROUP 2 SHORT PROBE

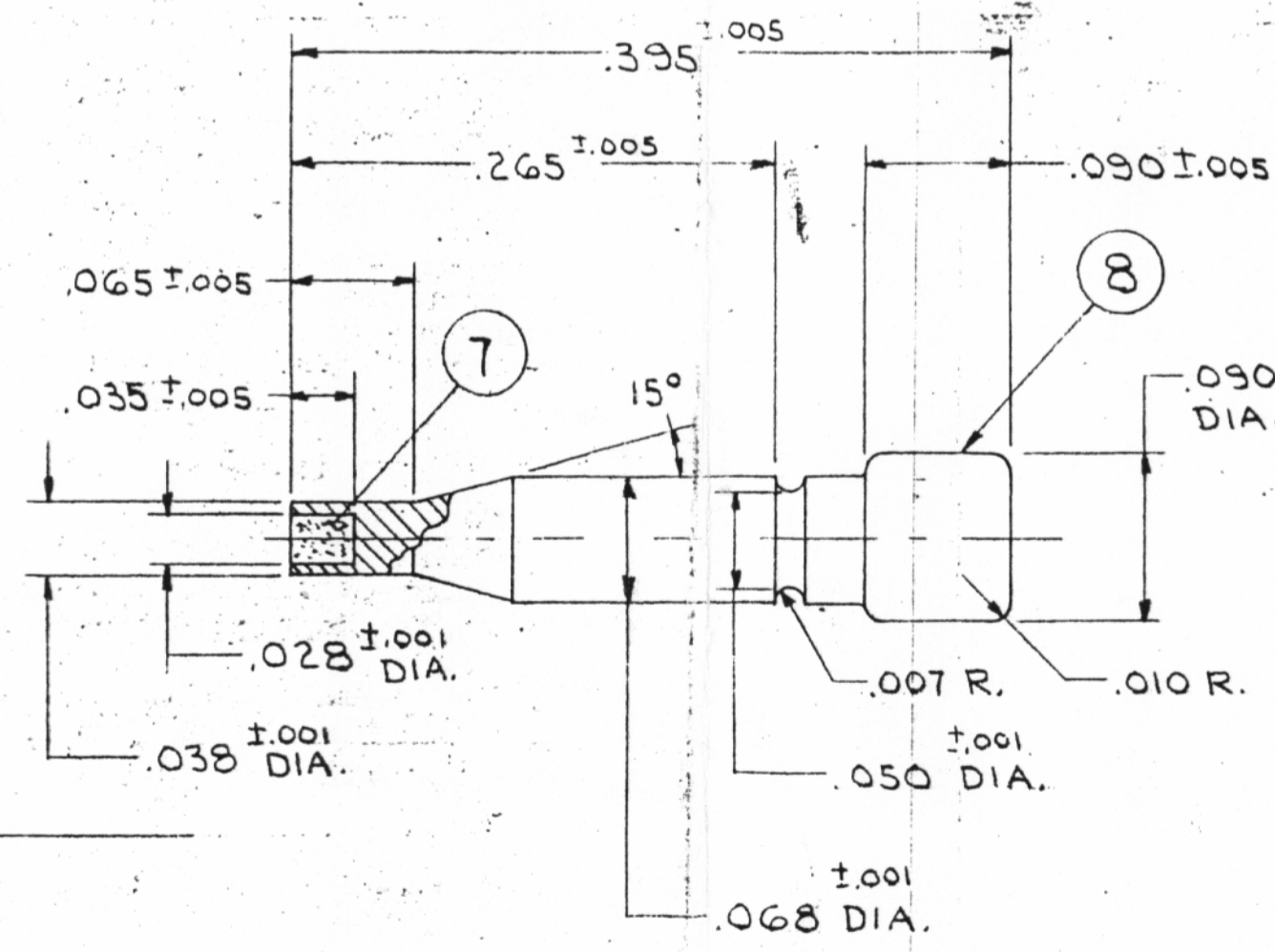
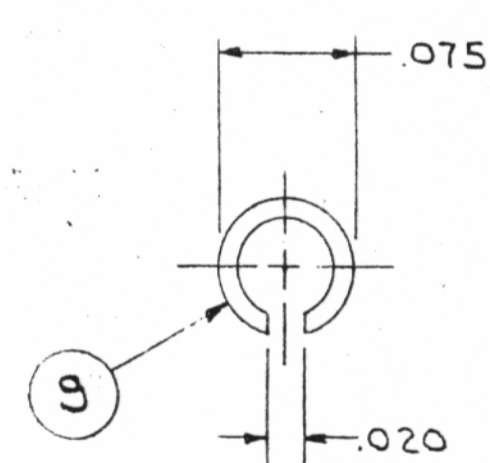

D - STRONTIUM 90 WILL BE INCORPORATED INTO 3M BRAND RADIATING MICROSPHERES. MICROSPHERES WILL BE NICKEL PLATED AND DEPOSITED IN THE MACHINED RECESS IN IT 8. THE MICROSPHERES WILL THEN BE ATTACHED TO THE AL. HOLDER BY ELECTRODEPOSITED NICKEL. AN ALTERNATE METHOD IS BY ATTACHMENT WITH SAUERISEN CEMENT. A LOADING TO BE 2-5 MC OF SR.90. SOURCE WILL WIPE TEST <0.005 μC OF REMOVABLE ACTIVITY. B.O. FR MINN. MINING & MFG. ST PAUL MINN.  
 C - CESIUM IODINE THALLIUM ACTIVATED. B.O. FR. HARSHAW CHEM. CO. CLEVELAND OHIO OR EQUAL.  
 B - B.O. FROM BAUSCH & LOMB, ROCHESTER, N.Y. OR EQUAL.  
 A - B.O. FROM JUDSON SMITH, BOYERTOWN, PENNA. OR EQUAL.

IT	CHANGE
1	ITS B-96 10
2	IT G WAS C BORE BOTH ENDS NOTE D CHANGED WELTZER G-28-63 J.S. HOPKINS

GROUP-3

SYM.	ITEM	NOMENCLATURE OR DESCRIPTION	MATERIAL	REMARKS	GR.	1	2	3	UNIT
D	10	SOURCE HOLDER GR.3 THIS DWG							
	9	LOCK RING FR. .010 DIA. PLANOWIRE	STEEL						
	8	SOURCE HOLDER	ALUMINUM						
D	7	SOURCE	SEE NOTED						
	6	SHIELD 1/2 OF 1/8 DIA. ROD	HALF HARD BRASS						
C	5	SCINTILLATOR	SEE NOTE C						
B	4	GLASS LIGHT PIPE (REFRACTIVE INDEX 1.63)	GLASS						
B	3	GLASS LIGHT PIPE (REFRACTIVE INDEX 1.63)	GLASS						
A	2	TUBE FR. 13 <sup>th</sup> OF .080 ± .004 O.D. X .004 WALL	ALUMINUM TUBE						
A	1	TUBE FR. 60 <sup>th</sup> OF .080 ± .004 O.D. X .004 WALL	ALUMINUM TUBE						

LIST OF MATERIALS		SUB. # 2
GEOMETRIC SYMBOLS (WHERE USED, ARE IN ACCORDANCE WITH MIL-STD-113)	TOLERANCE & MACHINING NOTES (UNLESS OTHERWISE INDICATED ON FACE OF DWG.)	WESTINGHOUSE ELECTRIC CORPORATION
STRAIGHTNESS	ALL UNTOLERANCED DIMENSIONS	<b>Astroluel Facility</b>
FLATNESS	ANGULAR MACHINED SURFACES	CHESWICK, PA
ANGULARITY	CHAMFERS & WELD PREPARATIONS	TITLE BETA BACK SCATTER
PERPENDICULARITY	SHARP EDGES TO BE REMOVED	GAGE PROBE
PARALLELISM	1/84 TO 1/32 RADIUS OR CHAMFER	CODE IDENT. NO.
CONCENTRICITY	MAX. MACHINED SURFACE ROUGHNESS	SCALE
TRUE POSITION	UNSPECIFIED GEOMETRIC TOLERANCES TO FALL WITHIN LIMITS OF SIZE DIMENSION TOLERANCE.	NTS
ROUNDNESS	THREADS - UNIFIED 2A-2B N.C. - 151 THREAD OF EXT. THREADS TO BE CHAMFERED 30° - 151 THREAD OF TAPPED HOLES TO BE CSK. (110°) TO MAJOR DIA.	ED-SK-307980-C
SYMMETRY	SYM. Δ DENOTES BASIC DIMENSION (ACTUAL TRUE LOCATION)	WT. ACT.
(MNC) MAXIMUM MAT'L. CONDITION	DRAWN W. ELTZER 4/4/63 APP. J.S. HOPKINS 7/7/63	WT. CALC.
(RFS) REGARDLESS OF FEATURE SIZE	CHKD. APP.	